

AT Dick Nimrod

RECEIVED

FEB 21 1988

STATE OF OREGON
WATER RESOURCES DEPARTMENT

WATER RESOURCES DEPT
SALEM, OREGON

REQUEST FOR WRITTEN APPROVAL TO USE CONSTRUCTION METHODS NOT
INCLUDED IN THE RULES AND REGULATIONS PRESCRIBING GENERAL STANDARDS
FOR THE CONSTRUCTION AND MAINTENANCE OF WELLS IN OREGON

Before approval can be considered the following questions must be answered.

Requests shall be submitted to the Watermaster Division, 3850 Portland Road,
NE, Salem, OR 97310.

Date: 2-19-88

Well Constructor: Pitches Pump & Drilling
87829 Green Hill rd Eugene OR 97402

(1) Location of Well: 1/4 1/4 of Section 5,
Township 16S, Range 4W, LANE County.

Address at well site or nearest known address: 73915 Prairie rd
Talent City OR 97448

(2) Name and address of Landowner: MADeline Brunkman +
Howard Donald
2237 Wisconsin ST
Eugene OR 97402

(3) The distance to the nearest well and septic drainfield: 80

(4) The unusual conditions existing at the well site: Cannot get pos'
from septic system & stay on property

(5) The proposed construction methods that the well constructor or landowner
constructing the well believes will be adequate for his particular well:
seal 6" casing two (2) or more ft into clay layer
occurring approx 28' to 30' as we have discussed

(6) A diagram showing the pertinent features of the proposed well design and construction (attach additional sheet if necessary):

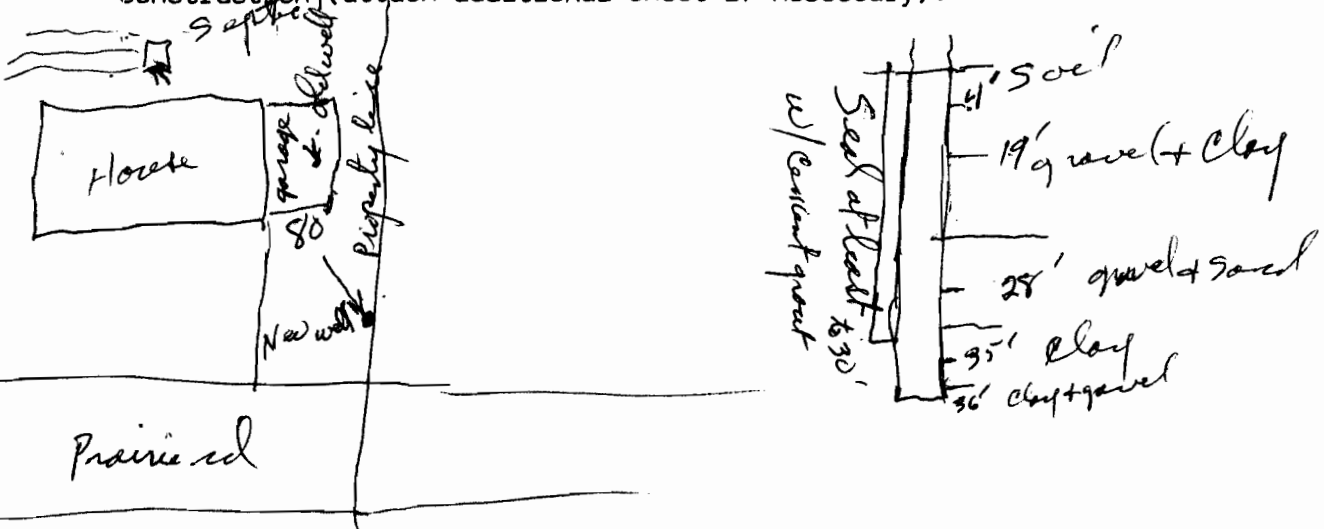

(Signed) Carl P. [Signature]
 (WELL CONSTRUCTOR)

For Water Resources Department Use Only

Date: 2-25-88
 Approved by: Dick Remick
 Denied by: _____

Remarks: As I explained on the phone, I am not comfortable approving this request will only two feet of clay cased and sealed. Try to get as deep as possible with casing and seal into the clay formation.

- NOTE:
- (1) If approval, all other phases of construction must be in compliance with State Well Construction Standards.
 - (2) If it should be determined at some future date that the well, due to its construction, is offering an avenue for pollution of the ground water body, it will be necessary for you to return to the site to correct any well deficiencies.