



# Oregon

Tina Kotek, Governor

Oregon Water Resources Dept  
725 Summer St NE, Ste A Salem, OR 97301  
Ph (503) 986-0900, Fax (503) 986-0904  
[www.oregon.gov/owrd](http://www.oregon.gov/owrd)

May 10, 2024

KYLE HUGHES WWC#1983  
NORM SEVEY WELL DRILLING  
5619 LELAND DR  
KLAMATH FALLS, OR 97603

## FINAL ORDER

Dear Mr. Hughes:

The Special Standards Request Form you submitted for landowner: Train Mountain Institute, Jerald Crane, Start Card number: 1073690, is hereby approved for the following: You may decommission this water supply well (KLAM 1219) as described on your Special Standards Request Form dated May 9, 2024. All other well abandonment standards apply as required under Oregon Administrative Rules 690-220. A copy of your Special Standards Request Form is enclosed.

Approval of this Special Standards Request was granted on May 10, 2024, due to the photo you provided showing the lack of access for a drilling machine to the well location.

The Well Construction Standards serve to protect ground water resources. By approving and issuing this special construction standard the Oregon Water Resources Department is not representing that a well constructed in accordance with this condition will maintain structural integrity or that it meets engineering standards. The well constructor/or landowner is responsible for ensuring that a well is constructed in a manner that protects ground water resources as required under Oregon Administrative Rules 690-200 through 690-240.

If you have any questions concerning this letter, I may be contacted at (503) 302-8618, or by e-mail at [Tommy.K.Laird@water.oregon.gov](mailto:Tommy.K.Laird@water.oregon.gov).

Sincerely,

Tommy Laird  
Well Construction Program Coordinator  
Well Construction Section

Enclosure

cc: Alyssa Witt, Well Inspector, Southcentral Region  
Dusten Lish, Well Inspector, Southcentral Region

**This is a FINAL ORDER other than contested case. This final order is subject to judicial review under ORS 183.484. Any petition for judicial review of the final order must be filed within the time specified by ORS 183.484(2). Pursuant to ORS 536.075 and OAR 137-004-0080 you may either petition for judicial review or petition the Director for reconsideration of this order. A petition for reconsideration may be granted or denied by the Director, and if no action is taken within 60 days following the date the petition was filed, the petition shall be deemed denied.**



## Special Standards Request Form

Request for written approval to use construction methods not included in Oregon Administrative Rules 690-200 through 690-240.

Before the request can be considered, this form must be completed. Requests shall be submitted to the Well Construction Program Coordinator. Requests may also be considered by the Well Construction Section Manager or Well Construction Compliance Coordinator.

**Special Standard Nbr:** 35491

Today's Date: 5/10/2024

**Primary Startcard Nbr:** 1073690

**Status:** PENDING REQUEST

**Request Date:** 5/9/2024

### Driller Information

License Number: 1983 Phone Number: 5418823504  
 Driller Name: KYLE HUGHES  
 Driller Company: NORM SEVEY WELL DRILLING  
 Driller Address: 5619 LELAND DR, KLAMATH FALLS, OR 97603

### Owner Information

Company: TRAIN MOUNTAIN INSTITUTE  
 First Name: JERALD Last Name: CRANE  
 Street1: 36941 S CHILOQUIN RD  
 Street2:  
 City: CHILOQUIN State: OR Zip: 97624  
 Phone(Primary): Phone(Secondary):  
 Email:

### Type of Work

Fee Required:  New  Conversion  Deepening  
 No Fee Required:  Alteration  Abandonment  
 Abandonment Method: OTHER

Original Start Card Nbr: Original Well Label:

Original Well Report: KLAM 1219

### Project Location

Street Address of Well: 36941 S CHILOQUIN RD, CHILOQUIN, OR 97624  
 County: KLAM Township: 35.00 S Range: 7.00 E Section: 9  
 QQ/Q: NE / NW Latitude: 42.55825386 Longitude: -121.88719564  
 Taxlot: 100

### Condition of Request

Type of Well: Water Well

The unusual conditions which necessitate this request: Lack of drilling machine access to the well location

The proposed construction methods that the well constructor believes will be adequate for this well: The old well is inside of an insulated side area of a building that they don't want to move or remove. (see attached picture). We propose simply backfilling the 6" casing from the bottom up with 3/8 Sodium Bentonite up to ground level.

DEQ Site Or Facility ID:  
*Applies to monitoring wells only, if available.*

### List of Related Start Cards:

Start Card	Dist. to closed sewage/storm drain system	Dist. to Septic	Dist. to Drain Field	Meets Min Setback Req.	County Code	wl_nbr	Orig. well Log	Type of Well	TRSQQ	Tax Lot	Lat./Long.	Street Of Well
1073690	1000	500	500	<input checked="" type="checkbox"/>			KLAM 1219	W	35,00S7,00E9NENW	100	42.55825386 -121.88719564	36941 S CHILOQUIN RD, CHILOQUIN, OR 97624

**Attachments:**

**Required Documents:**

- Diagram and written description showing the pertinent features of the proposed well design, construction or abandonment. Include any setback constraints.

Title	Type	Summary
Diagram of site	DIAGRAM	
Image Regarding Lack of Access	PHOTO	

**Note:**

- (1) The Well Construction Standards serve to protect ground water resources. By approving and issuing special construction standards, the Oregon Water Resources Department is not representing that a well constructed in accordance with this condition will maintain structural integrity or that it meets engineering standards. The well constructor or landowner is responsible for ensuring that a well is constructed in a manner that protects groundwater resources as required under Oregon Administrative Rules 690-200 through 690-240.
- (2) If it should be determined at some future date that the well, due to its construction, is allowing groundwater contamination, waste or loss of artesian pressure, the undersigned shall return to the site and rectify the problem.
- (3) If oral approval was granted, a written request must be submitted to the Department either within three (3) working days of the date of oral approval or prior to completion of the associated well work. Failure to submit a written request as described above may void prior oral approval.

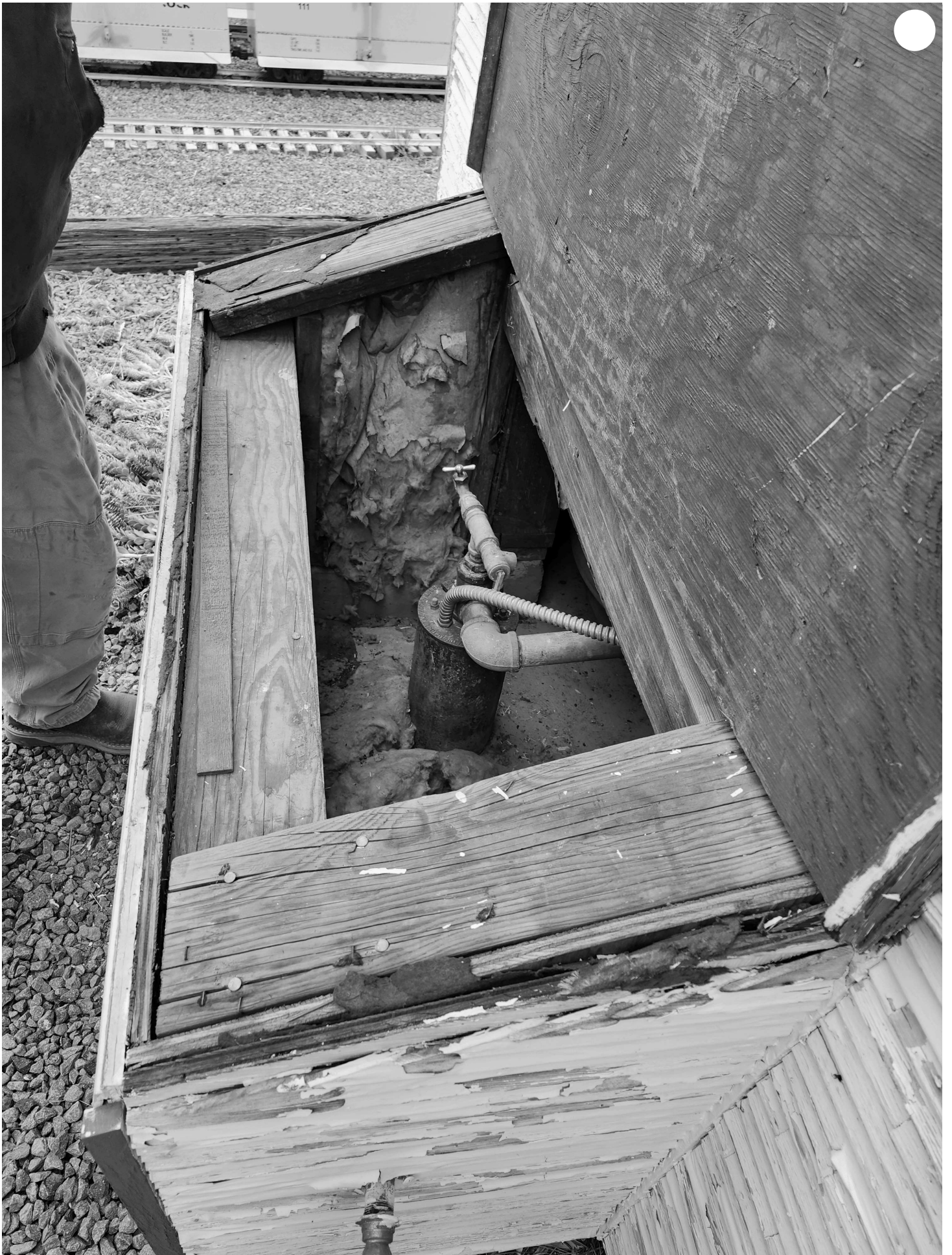

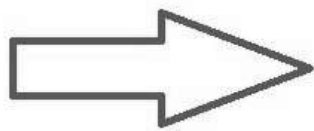

**Well Inside of  
this small area**

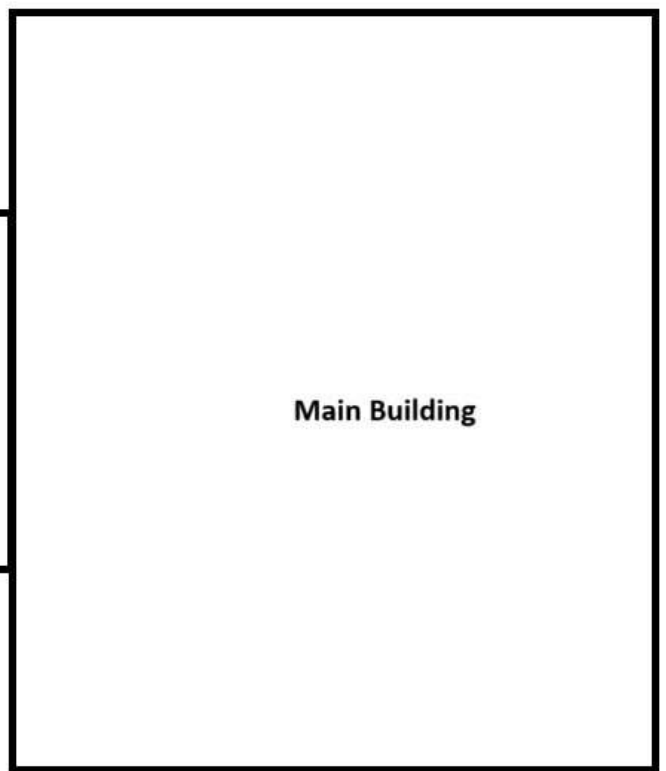

**Main Building**