



# Oregon

John A. Kitzhaber, MD, Governor

## Water Resources Department

North Mall Office Building  
725 Summer St. NE, Suite A  
Salem, OR 97301

Phone: 503-986-0900

FAX: 503-986-0904

[www.oregon.gov/owrd](http://www.oregon.gov/owrd)

September 26, 2012

STEPHEN J SCHNEIDER #649  
SCHNEIDER EQUIPMENT INC  
21881 RIVER RD NE  
ST PAUL OR 97137

### FINAL ORDER

Dear Steve:

The Special Standards Request Form you submitted for owner: City of Stanfield, Start Card number 208746, is hereby approved for the following: You may install this well within 25 feet from a closed sewage line in the location agreed upon with the Department's representative. A stipulation of this special standard is that the well must be continuously cased and continuously sealed to a minimum depth of 900 feet below ground surface as described on your Special Standards Request Form. A deeper seal must be placed, if required, based on the formations encountered while drilling. All other standards must be adhered to. Your Special Standards Request Forms is enclosed.

The Well Construction Standards serve to protect ground water resources. By approving and issuing this special construction standard the Oregon Water Resources Department is not representing that a well constructed in accordance with this condition will maintain structural integrity or that it meets engineering standards. The well constructor/or landowner is responsible for ensuring that a well is constructed in a manner that protects ground water resources as required under Oregon Administrative Rules 690-200 through 690-240.

If you have any questions concerning this letter, I may be contacted at (503) 986-0851, or by e-mail at [kristopher.r.byrd@wr.d.state.or.us](mailto:kristopher.r.byrd@wr.d.state.or.us).

Sincerely,

Kristopher Byrd, Coordinator  
Well Construction Program  
Well Construction and Compliance Section

enclosure

cc: Bill Ferber, W Region Manager  
File

This is a final order in other than contested case. This order is subject to judicial review under ORS 183.484. Any petition for judicial review must be filed within the 60 day time period specified by ORS 183.484(2). Pursuant to ORS 536.075 and OAR 137-004-0080 you may either petition for judicial review or petition the Director for reconsideration of this order. A petition for reconsideration may be granted or denied by the Director, and if no action is taken within 60 days following the date the petition was filed, the petition shall be deemed denied.





Oregon Water Resources Department  
725 Summer Street NE, Suite A  
Salem Oregon 97301-1266  
(503) 986-0900  
www.wrd.state.or.us

# Special Standards Request Form

## REQUEST FOR WRITTEN APPROVAL TO USE CONSTRUCTION METHODS NOT INCLUDED IN OREGON ADMINISTRATIVE RULES 690-200 THROUGH 690-240

Before the request can be considered, this form must be completed. Requests shall be submitted to the Well Construction Specialist, Water Resources Department, 725 Summer Street NE, Suite A, Salem OR 97301-1266. Requests may also be considered by the appropriate Regional Manager.

Date of request: 9/26/12 Oral approval date (if applicable): \_\_\_\_\_

Bonded Well Constructor (name, license #, and mailing address): Steve Schneider, WWC #649

21881 River Road NE, St. Paul, OR 97137

(1) Location of Well: SE 1/4 SE 1/4 Tax lot 1509 Section 5,  
Township 3 N, Range 29 E, Umatilla County  
Address at well site: \_\_\_\_\_ nearest: 2115 S. Hwy 395, Stanfield, OR 97875

(2) Start Card Number(s)(for work to be done): 208746

(3) Name and Address of Land Owner: City of Stanfield

160 South Main St, Stanfield, OR 97875

(4) Distance to the nearest septic tank, drainfield, closed sewage line (if water supply well)

closed sewage line: ~25'

(5) The unusual site conditions which necessitate this request: Site plan (see attached) to contain all facilities

(including reservoir, pump station, etc.), property boundaries, drill equipment requirements & layout, concern of well  
interference, and provisions for future well serviceability require well to be located less than 50' from existing closed sewage line.

(6) The proposed construction methods that the bonded well constructor believes will be adequate for this well: (attach additional pages if needed)

Well will be sealed from ground surface to approximately 900'. Sewage line is 'closed'. Nearby well

(UMAT 50189) on same taxlot is approximately 80' from closed sewage line has 82.5' seal & serves Pilot Travel

Center and RV park; it has no known contamination issue. New well will have >10X depth of UMAT 50189 seal.

- (7) Diagram showing the pertinent features of the proposed well design and construction:  
(attach additional pages if needed)

*see attached siteplan and  
new well anticipated construction*

---

PLEASE NOTE:

- (1) The Well Construction Standards serve to protect ground water resources. By approving and issuing this special construction standard the Oregon Water Resources Department is not representing that a well constructed in accordance with this condition will maintain structural integrity or that it meets engineering standards. The well constructor/or landowner is responsible for ensuring that a well is constructed in a manner that protects ground water resources as required under Oregon Administrative Rules 690-200 through 690-240.
- (2) If it should be determined at some future date that the well, due to its construction, is allowing ground water contamination, waste or loss of artesian pressure, the undersigned shall return to the site and rectify the problem.
- (3) If oral approval was granted, a written request must be submitted to the Department either within three (3) working days of the date of oral approval or prior to the completion of the associated well work. Failure to submit a written request as described above may void prior oral approval.

I have read and understand the above information. I further attest that the information provided is accurate to the best of my knowledge.

Bonded Constructor Signature: \_\_\_\_\_

*Stephen P. Schmidt*

CONTROL POINT TABLE				
NO.	NORTHING	EASTING	ELEVATION	DESCRIPTION
204	767599.75	853297.95	600.546	MP/L YPC
217	767599.14	853296.97	693.465	AP/L RPC
218	767491.11	853297.79	609.925	MP/L YPC
500	767563.17	853296.50	640.513	AP/L RPC
50000	767573.36	853253.50	640.000	RES. GEN

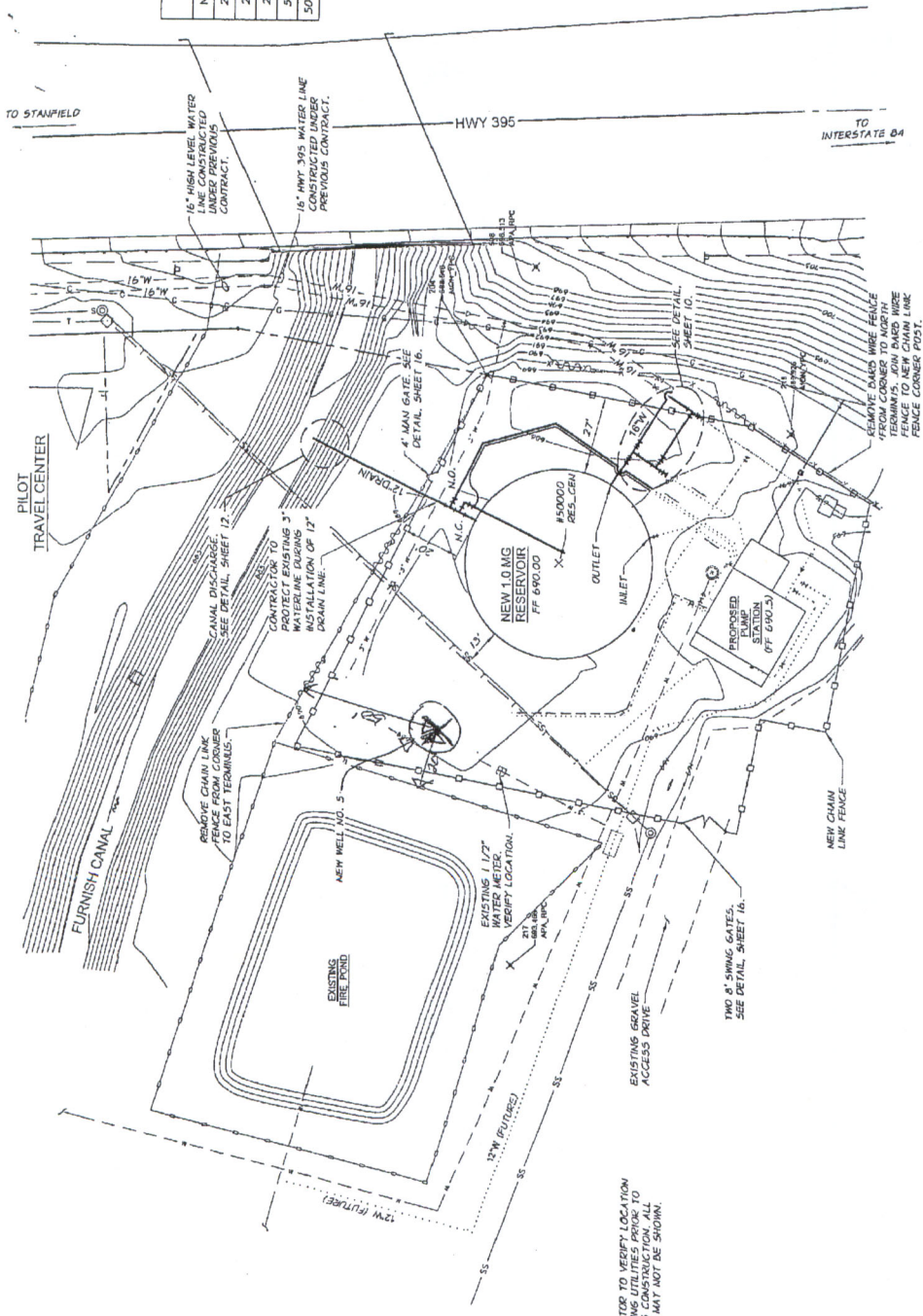

NOTE:  
CONTRACTOR TO VERIFY LOCATION  
OF EXISTING UTILITIES PRIOR TO  
CONSTRUCTION. EXISTING UTILITIES  
NOT SHOWN.

# RESERVOIR SITE SCALE: 1"=20'

<p><b>ANDERSON PERRY &amp; ASSOCIATES, INC.</b> 14000 E. WILLOW AVE., DENVER, CO. 80231</p>		<p><b>CITY OF STANFIELD</b> WATER SYSTEM IMPROVEMENTS RESERVOIR NO. 3 AND RECOATING OF RESERVOIR NO. 2 2012 PROJECT SITE PLAN</p>	<p>SHEET <b>4</b></p>
<p>THIS DRAWING HAS BEEN REFINED 50%. ADJUST SCALE ACCORDINGLY. BAR SCALE SHOWN IS ACCURATE.</p> <p><b>FOR REVIEW ONLY</b> NOT FOR CONSTRUCTION</p>		<p>DATE: 11/14/11 BY: E. ARNOLD CHECKED BY: A. BREE</p> <p>PROJECT NO.: 339-92 SHEET NO.: 4 DATE: 11/14/11</p> <p>COPYRIGHT 2011 BY ANDERSON-PERRY &amp; ASSOCIATES, INC.</p>	

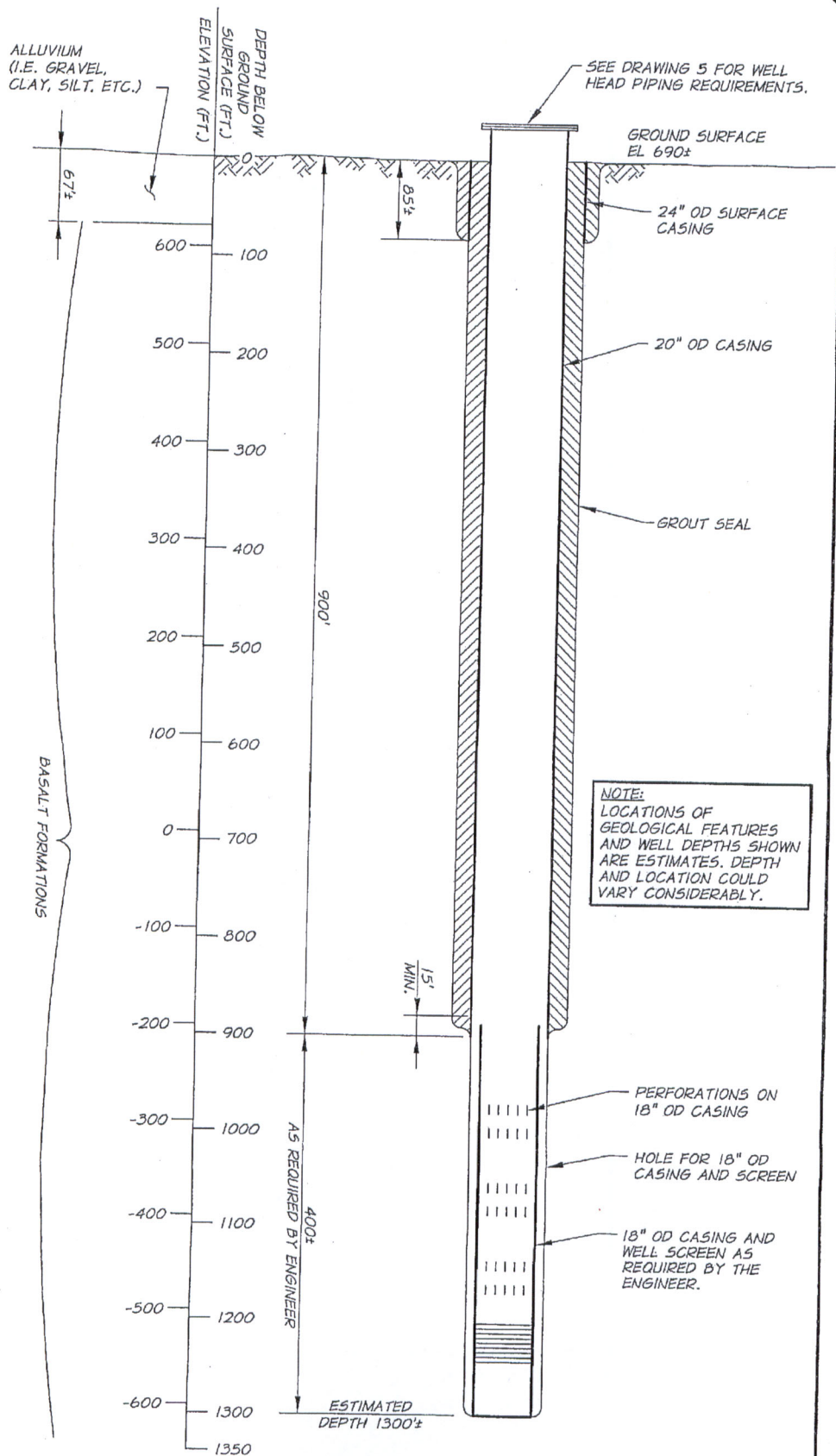

**Anderson**  
pertry  
Associates, Inc.

CITY OF  
STANFIELD, OREGON  
CITY WELL NO. 5  
ANTICIPATED WELL CONSTRUCTION

DRAWING  
3

## FOR WATER RESOURCES DEPARTMENT USE ONLY

Date Postmarked \_\_\_\_\_  
 Date Hand-Delivered \_\_\_\_\_  
 Date Region Office Rec'd \_\_\_\_\_

W 208746

OWRD Receipt \_\_\_\_\_  
 Date Fee Received \_\_\_\_\_  
 Check No. \_\_\_\_\_

## START CARD

NOTICE OF BEGINNING OF WELL CONSTRUCTION  
 (as required by ORS 537.762)

This form must be completed and the original mailed or delivered to the region office within which the well is being constructed, converted, altered, deepened, or abandoned using one of the following methods: (a) by regular mail no later than three (3) calendar days (72 hours) prior to commencement of work; (b) by hand delivery, during regular office hours before work is commenced; or (c) by FAX before work is commenced. If method (c) is used, a legible copy of the start card shall also be mailed or delivered to the region office no later than the day work is commenced. The fee required under ORS 537.762(5) for the construction of a new well, deepening of an existing well, conversion of a monitoring well, geotechnical hole, or other hole shall be submitted to the Water Resources Department, 725 Summer Street NE Suite A, Salem, OR 97301-1266 with a duplicate copy of the start card. The Water Resources Commission has authority to impose civil penalties for failure to submit the required \$225 fee with the start card, for failure to submit the \$225 fee in a timely manner, and for failure to timely submit start cards.

Owner's name: City of Stanfield  
 Home  
 Phone: ( ) \_\_\_\_\_ Mailing Address: 160 South Main Street  
 Work  
 Phone: ( ) \_\_\_\_\_ City, State Zip: Stanfield, OR 97875

Type of work: Fee ☒ New Construction No Fee ☐ Alteration (Repair/Recondition)  
 Required: ☐ Conversion Required: ☐ Abandonment Orig. Start  
☐ Deepening Orig. Start Card No. \_\_\_\_\_  
 Card No. \_\_\_\_\_

Proposed Commencement Date: 10/3/12

Existing or Proposed Well Depth: 1300 Diameter: 20 Original Well I.D. Label Number: \_\_\_\_\_

Use: ☐ Monitoring ☐ Domestic ☐ Irrigation ☒ Community (Public System) ☐ Industrial/Commercial  
☐ Livestock ☐ Dewatering ☐ Thermal ☐ Injection ☐ Other \_\_\_\_\_

Proposed Well Location:

County Umatilla Township 3N Range 29E Section 5 Tax Lot 1509  
 North or South East or West  
 1/4 SE 1/4 SE Or Latitude \_\_\_\_\_ Longitude \_\_\_\_\_

Street Address of well, if not assigned, nearest address:

2115 S. Hwy 395, Stanfield, OR 97875

We have read the back of this form and the information provided is accurate to the best of our knowledge.

Owner/Agent Name \_\_\_\_\_ Bonded Water Supply/Monitor Well Constructor Name Schneider Water Services License No. 649  
 Date Signed \_\_\_\_\_ Company \_\_\_\_\_ Date Signed 9/26/12

OWNER PLEASE NOTE: This is not a water right application. The owner is responsible for obtaining a water right through the Water Resources Department, if required. The Oregon Health Division requires plans to be submitted and approved prior to construction if the well is to be used as a public system.

ADDITIONAL IMPORTANT INFORMATION ON BACK.

## Kris Byrd

---

**From:** Steve Schneider <SteveS@seidc.com>  
**Sent:** Wednesday, September 26, 2012 11:30 AM  
**To:** Kris Byrd  
**Cc:** Troy Baker  
**Subject:** Stanfield  
**Attachments:** Start Card.pdf

Kris,

Not sure if you need this in reviewing the special standard request that I just sent to you, but attached is the Start Card that is being mailed today for the new well.

Regards,

*Steve Schneider* MGWC  
Vice President, Drilling Operations

**Schneider Water Services**

21881 River Road NE

St. Paul, OR 97137

ph 503-633-2666

fx 503-633-2668

[www.seidc.com](http://www.seidc.com)

Richland, WA location is now open  
to better serve Washington and Eastern Oregon.

## Kris Byrd

---

**From:** Steve Schneider <SteveS@seidc.com>  
**Sent:** Wednesday, September 26, 2012 11:26 AM  
**To:** Kris Byrd  
**Cc:** Troy Baker; Jim Thompson  
**Subject:** Stanfield Special Standard request attached  
**Attachments:** Special Standards request.pdf; UMAT 50189.pdf

**Importance:** High

Kris,

Attached is a Special Standard request for a new City of Stanfield Well No. 5.

Anderson Perry & Associates is the City's Engineer. They asked me to submit this request after we walked over the site yesterday along with the City and determined there is a setback issue with an existing small closed gravity feed sewage line.

We are mobilizing equipment to the site on Monday, 10/1/12, and want to make sure all is okay for setup at the proposed location as soon as possible. Accordingly, we'd appreciate your prompt review and approval.

If you have any questions or want to discuss, please do not hesitate to contact me.

Troy Baker is our contact at Anderson Perry if you want to verify any of this. He is copied on this email and his phone number is (541) 963-8309.

Thank you.

*Steve Schneider* MGWC  
Vice President, Drilling Operations

Schneider Water Services  
21881 River Road NE  
St. Paul, OR 97137  
ph 503-633-2666  
fx 503-633-2668  
[www.seidc.com](http://www.seidc.com)

Richland, WA location is now open  
to better serve Washington and Eastern Oregon.