

EXHIBIT B

MAP TO ACCOMPANY MINOR HYDROELECTRIC APPLICATION

KARUNA PROPERTY, LLC

JUNE 2013

Section 8, Township 37 South, Range 9 West, W.M.

Josephine County, Oregon

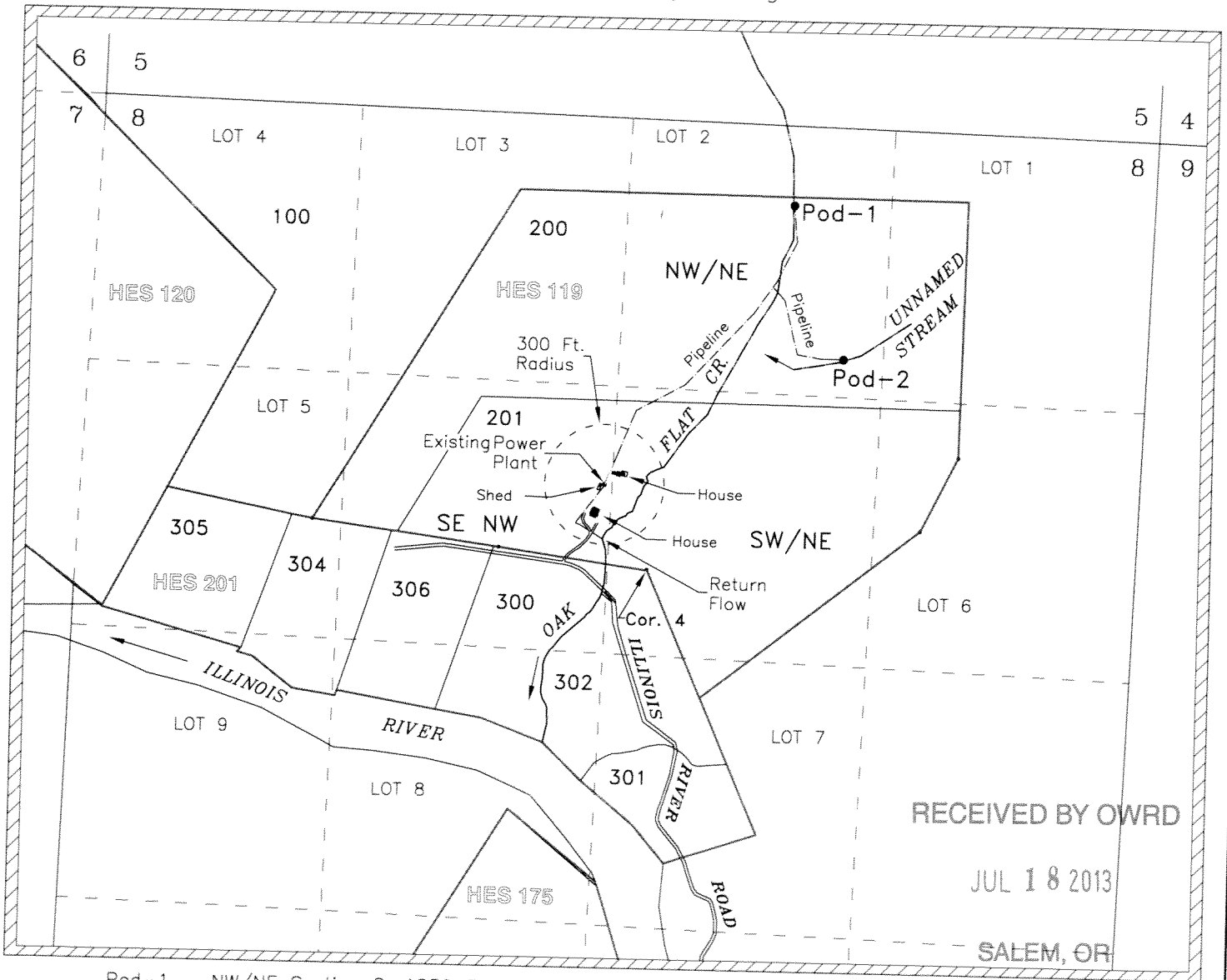

RECEIVED BY OWRD

JUL 18 2013

SALEM, OR

Pod-1 - NW/NE Section 8, 1850 Ft. N. & 635 Ft. E. of Corner 4 HES 119

Pod-2 - NW/NE Section 8, 1100 ft. N. & 925 ft. E. of Corner 4 HES 119

APPLICANT: KARUNA PROPERTY, LLC
3013 NE 9th AVENUE
PORTLAND, OR 97212

MAP PREPARED BY:
SUPERIOR WATER RIGHT CONSULTING, LLC
245 GLENOAK LANE
GRANTS PASS, OR 97526

Base Map: Josephine County GIS data
with 2005 FSA aerial photo overlay
adjusted using recorded Survey Map 020-2012
for assumed best fit

This map is not intended to provide legal
dimensions or locations of property ownership lines

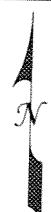

Scale
1 inch = 800 feet



Rev. 6/19/2013 n.e.d.