

GLAS COUNTY

1" = 400'

MAP T 20 R 10 S 5

75° 27' W 5257.7  
589° 47' W 79.30 CH.

200  
56.36 Ac.

Hancock

48A

RIVER

SMITH

500

105-00

PC 304+44.40

1314.43'

1314.43'

100  
40.00 Ac.

X Hancock  
point of diversion

Sec 8

1255.03'

N4° 14' 20" E 2510.06'  
(G.L.O. N4° 20' E 2510.04')

1255.03'

SEE M 74-3

MAP 20 10

RECEIVED

JUL 27 2020

OWRD

CANCELLED  
600

NOS

Exhibit B

ASSESSOR MAP  
T20S R10W SEC 5/8

TRAIN

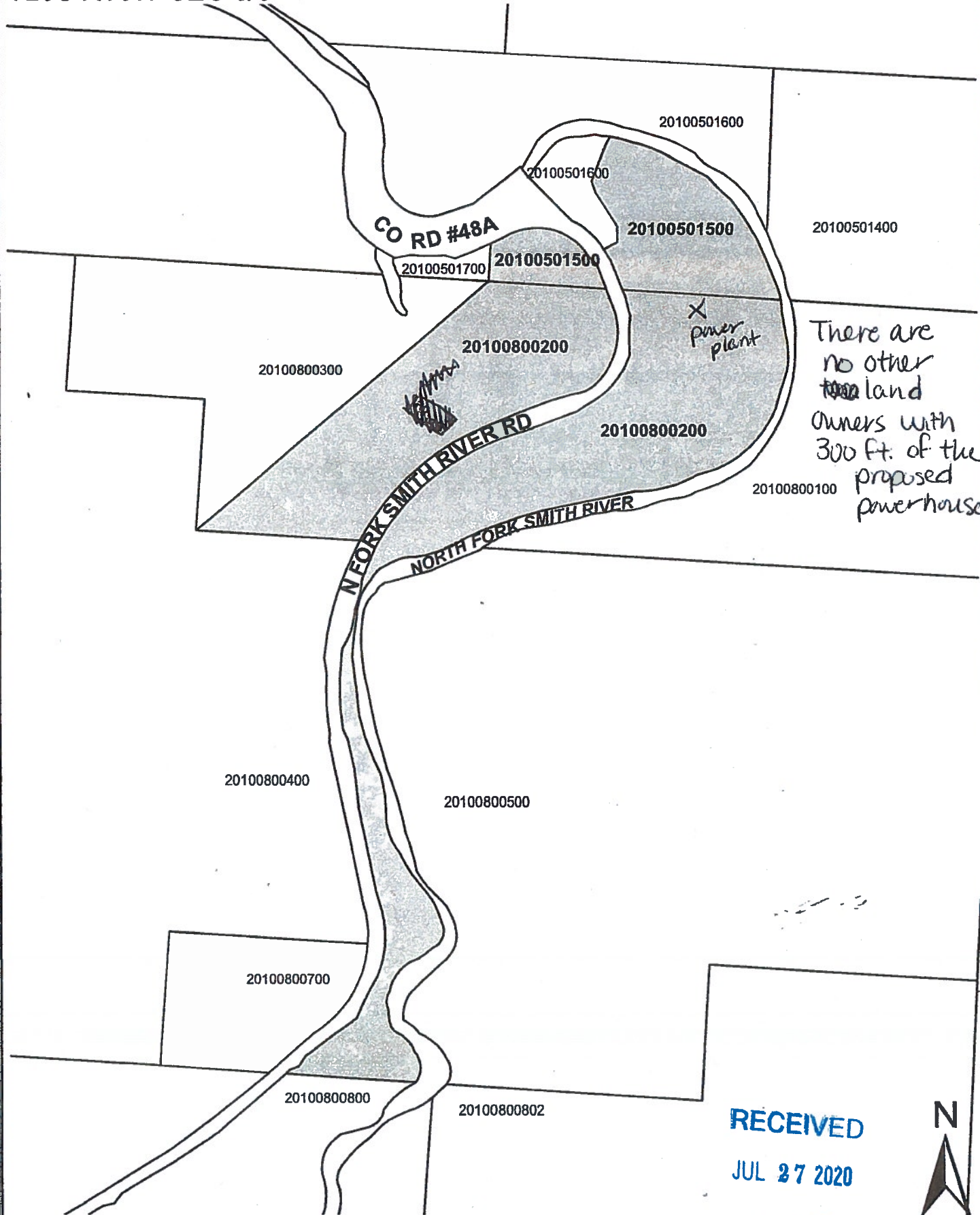

There are no other ~~to~~ land owners with 300 ft. of the proposed powerhouse

RECEIVED  
JUL 27 2020  
OWRD



1" = 600'