

A - 20' section line - 380' N. and 90° E. of the SW corner of section 2, township 12 S., range 2 W., WM.
 B - 16' section line - 230' N. and 100° E. of the SW corner of section 2, township 12 S., range 2 W., WM.
 C - Two 10' section lines - 45' N. and 225° E. of the SW corner of section 2, township 12 S., range 2 W., WM.

0.0593 CFS - WATER USAGE FOR IRRIGATION - TOTAL
 9,946 GFS - WATER USAGE FOR MANUFACTURING - S.W. QUARTER - QUARTER - SECTION 2
 10,000 CFS - TOTAL WATER USAGE

SHOWERS IN SWAMPY AREAS TO SCRUB BLOW GASES.
 0.635 ACRES - S.W. QUARTER - QUARTER - SECTION 2 - LAWN & SHRUBS
 0.341 ACRES - S.E. QUARTER - QUARTER - SECTION 3 - LAWN & SHRUBS

STEAM PLANT INCLUDES (2) HOG FUEL BOILERS WITH CINDER COLLECTORS & SMOKE MONITORS, AND (1) GAS/OIL FIRED BOILER WITH O₂ ANALYZER.

CHIP STORAGE & SAWDUST STORAGE

SETTLING BASIN FOR MILL PROCESS WATER

PRIMARY SEDIMENT POND

SECONDARY TREATMENT PLANT
 POND #2 POND #1

RECEIVED
 MAR 2 1972
 STATE ENGINEER
 SALEM, OREGON

RECEIVED
 NOV 28 1972
 STATE ENGINEER
 SALEM, OREGON

Application No. 79831
 Permit No. 36696

GENERAL APP'T. AIR & WTR. QUALITY CONTROL FACILITY

REVISIONS			
NO.	DESCRIPTION	DATE	BY
1	Addition of water quality control facility		
2	Amendments to water quality control facility		

CROWN ZEPHERUS CORPORATION		CENTRAL ENGINEERING OFFICE	
SEATTLE, WASHINGTON		LEBANON, OREGON	
PROJECT NO. _____		JOB NO. _____	
DATE _____		SCALE _____	
DRAWN BY _____		CHECKED BY _____	
DATE _____		DATE _____	
2-26-71		1"=100'	



33.34 T 11S, R 2W of WM
4.3 T 12S, R 2W of WM

34.35
3.2

35.36
2.1

6.31
1.6

To Albany
U.S. Hwy 20
Canal

Two Mill Water Supply Pumps, Located
380 ft. N. and 90 ft. E. of SW Corner of
Sect. 2, T 12S, R 2W of WM

Emergency Cooling Water Pump, Located
230 ft. N. and 100 ft. E. of SW Corner of
Sect. 2, T 12S, R 2W of WM

Two Fire Pumps, Emergency Use Only
Located 45 ft. N. and 225 ft. E. of the SW
Corner of Sect. 2, T 12S, R 2W of WM

So Pac. Co.
Settling Basin

4.3
9.0

3.2
10.1

2.1
11.2

6.31
12.7

9.0

LEBANON

So Pac. Co.

1.1
12.2

13.7
3.18

12S,
T 12S,
R 2W of WM
R 1W of WM

Point of Diversion is 1430 ft. N.
and 1050 ft. E. of SW Corner
of NW 1/4 of Sec. 19, Tsp. 12S,
R 1W of WM.

5.14
22.23

14.13
23.24

13.18
24.19

SOUTH SANTIAM RIVER

Co Rd. 719

Dam

O.E. RR

Canal

Co Rd 717

22.23
27.26

23.24
26.25

24.19
25.30

U.S. Hwy 20

To Sweet Home

Application No. 49031
Permit No. 36696

GENERAL PLAN MILL WATER SUPPLY	
AFE NO.	DWG. NO. M-131
DRAWN BY	DEPT.
CHECKED	SCALE 1" = 1600'
APPROVED	DATE FEBR. 2, 1972
CROWN ZELLERBACH CORPORATION	
LEBANON DIVISION	LEBANON, OREGON

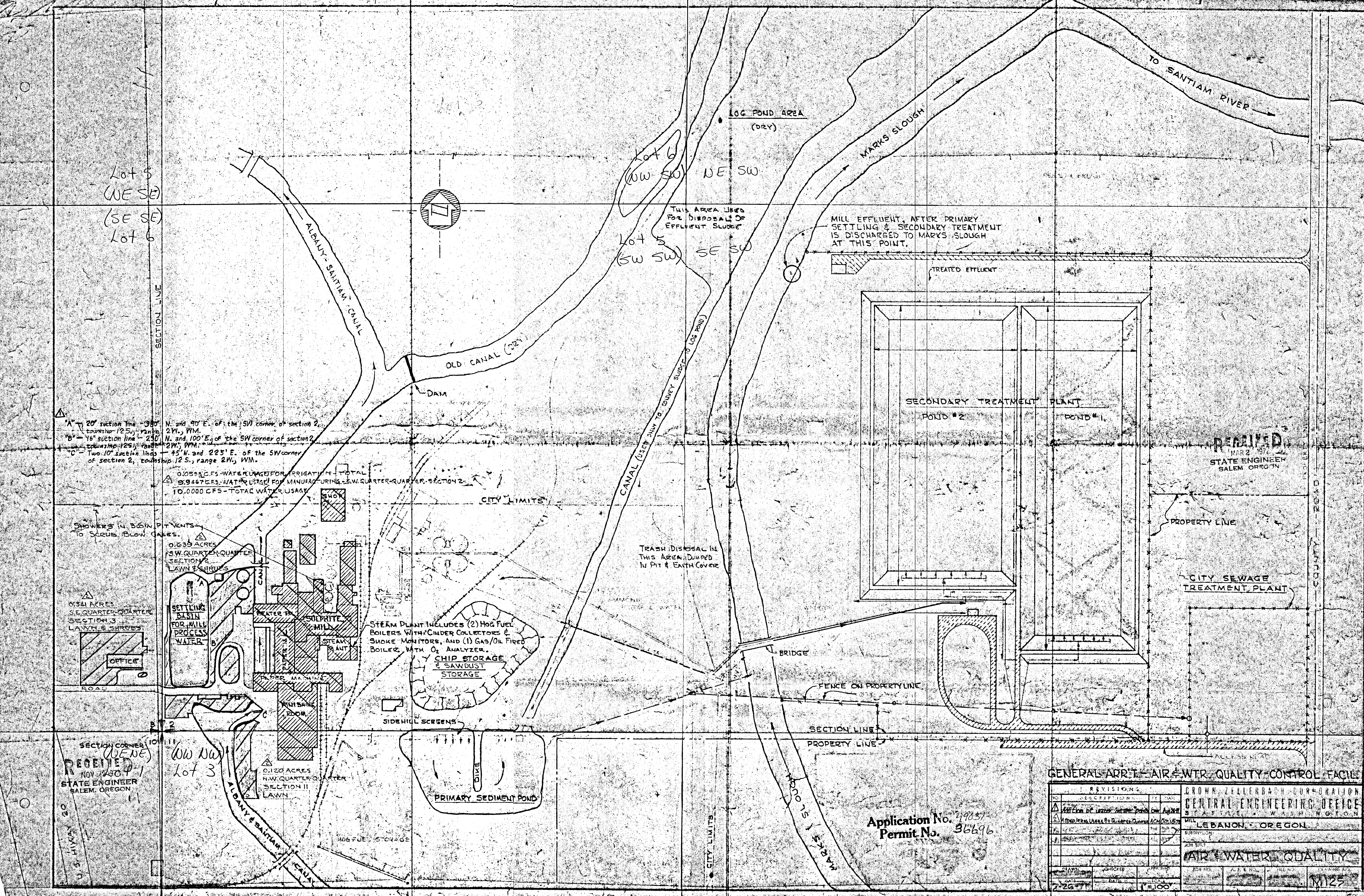

Lot 5
(WE SE)
(SE SE)
Lot 6

Lot 6
(W SW) NE SW
Lot 5
(S SW) SE SW

SECTION LINE

ALBANY-SANTIAM CANAL

OLD CANAL (DRY)

LOG POND AREA
(DRY)

MARKS SLOUGH

TO SANTIAM RIVER

THIS AREA USED FOR DISPOSAL OF EFFLUENT SLUDGE

MILL EFFLUENT, AFTER PRIMARY SETTLING & SECONDARY TREATMENT IS DISCHARGED TO MARKS SLOUGH AT THIS POINT.

TREATED EFFLUENT

SECONDARY TREATMENT PLANT

POND #2

POND #1

RECEIVED
MAR 2 1974
STATE ENGINEER
SALEM, OREGON

PROPERTY LINE

CITY SEWAGE TREATMENT PLANT

TRASH DISPOSAL IN THIS AREA DUMPED IN PIT & EARTH COVER

BRIDGE

FENCE ON PROPERTY LINE

SECTION LINE

PROPERTY LINE

0.0593 CFS WATER USAGE FOR IRRIGATION - TOTAL
0.9467 CFS WATER USAGE FOR MANUFACTURING - S.W. QUARTER QUARTER, SECTION 2
10.0000 CFS - TOTAL WATER USAGE

0.639 ACRES S.W. QUARTER QUARTER SECTION 2 LAWN & SHRUBS

0.541 ACRES S.E. QUARTER QUARTER SECTION 3 LAWN & SHRUBS

SETTLING BASIN FOR MILL PROCESS WATER

STEAM PLANT

SOLPRITE MILL

STEAM PLANT INCLUDES (2) HOG FUEL BOILERS WITH CINDER COLLECTORS & SMOKE MONITORS, AND (1) GAS/OIL FIRED BOILER WITH O₂ ANALYZER.

CHIP STORAGE & SAWDUST STORAGE

SIDEHILL SCRIBERS

PRIMARY SEDIMENT POND

0.120 ACRES N.W. QUARTER QUARTER SECTION II LAWN

RECEIVED
NOV 29 1970
STATE ENGINEER
SALEM, OREGON

Lot 3
(W NW)

Application No. 7983
Permit No. 36296

GENERAL ADPT. AIR & WTR. QUALITY CONTROL FACILE

NO.	REVISIONS	DATE
1	Initial Plan of Mill	Aug 22 1971
2	Approved License By Oregon State Dept. of Geology	Dec 10 1971
3	Submittal	
4	Final Plan	

CROWN ZELLERBACH CORPORATION
GENERAL ENGINEERING OFFICE
SEATTLE, WASHINGTON
LEBANON, OREGON
AIR & WATER QUALITY
SCALE 1"=100'

'A' - 20' section line - 310' N. and 90' E. of the SW corner of section 2, township 12 S., range 2 W., 11 W.
 'B' - 16' section line - 210' N. and 100' E. of the SW corner of section 2, township 12 S., range 2 W., 11 W.
 'C' - Two 10' section lines - 45' N. and 225' E. of the SW corner of section 2, township 12 S., range 2 W., 11 W.

0.0522 ACRE - WATER USAGE FOR PAPER MILL
 9.9467 CFS - NATURAL GAS FOR MANUFACTURING - SINGLE PHASE
 10.0000 CFS - TOTAL WATER USAGE

SHOWERS IN BLOW PIT VENTS TO SCRUB BLOW GASES.

0.033 ACRES S.W. QUARTER-QUARTER SECTION 2 LAWN & SHRUBS

0.341 ACRES S.E. QUARTER-QUARTER SECTION 3 LAWN & SHRUBS

SETTLING BASIN FOR MILL PROCESS WATER

BENTER BY
 PAPER MILL
 STEAM PLANT
 PAPER MILL

STEAM PLANT INCLUDES 2 HO. FULL BOILERS WITH COILS, COLLECTOR, SMOKE MONITOR, AND 1 (S.A./D.) FIRED BOILER WITH 2 ANALYZERS.
 CHIP STORAGE
 WOOD WASTE STORAGE

SIDEHILL SCREENS

PRIMARY SEDIMENT POND

RECEIVED
 STATE ENGINEER
 SALEM, OREGON

Application No. 49031
 Permit No. 36696

GENERAL ARR'T. - AIR & WTR. QUALITY CONTROL FACIL.

RECEIVED STATE ENGINEER SALEM, OREGON		RECEIVED FEB 2 1972 STATE ENGINEER SALEM, OREGON	
ADDITION OF WATER INTAKE POINT ON AUG 22 1971 ADDED BRIG MASS BY QUARTER QUARTER ACQ OCT 10 1971		CENTRAL ENGINEERING OFFICE MILL LEBANON, OREGON	
AIR & WATER QUALITY		AIR & WATER QUALITY	
2-26-71		1" = 100'	
M125		M125	

