

**BEAVER SLOUGH DRAINAGE DISTRICT**

P.O. #1 - China Creek - N 40°00' W; 2895 ft  
 P.O. #2 - Coquille River - S 87°30' W; 8140 ft  
 both from the S 1/4 cor. Sec 27  
 Tp 27 S R 13 W W.M.  
 Unless otherwise noted, irrigated land  
 within district boundaries

Application No. 54080  
 Permit No. 30791

7.75 miles

77S  
 R13W  
 28S  
 R13W

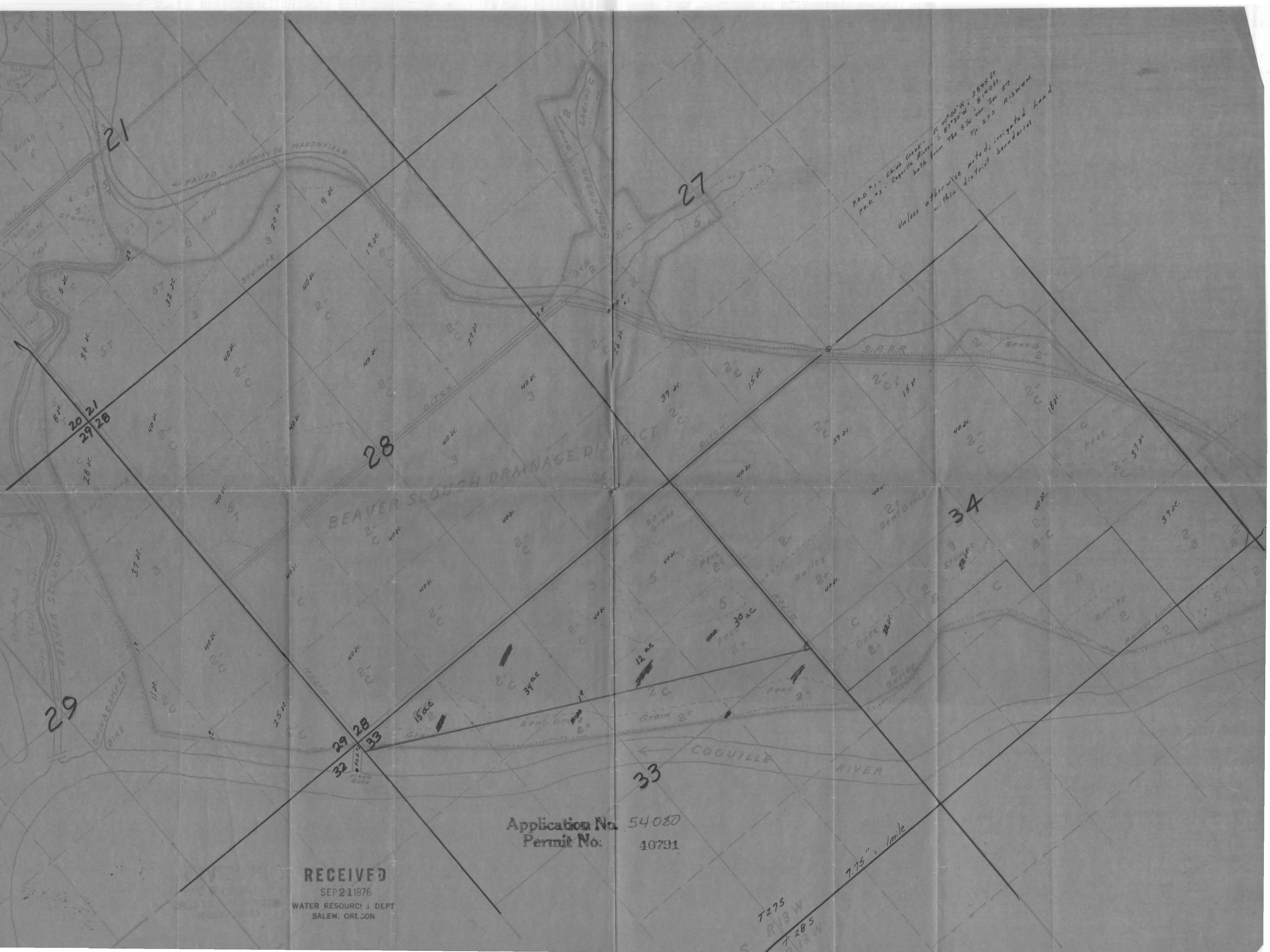

P.O.D. #1 - Chico Creek - N 40°00'W; 2885ft.  
 P.O.D. #2 - Coquille River - S 87°30'W; 8140ft.  
 both from The S 1/4 Sec 27  
 Tp. 27S R.13W.4E.  
 Unless otherwise noted irrigated land  
 within district boundaries.

Application No. 54080  
 Permit No. 40791

**RECEIVED**  
 SEP 21 1976  
 WATER RESOURCES DEPT  
 SALEM, OREGON

T27S  
 R13W  
 T28S