

11
20
RECEIVED
AUG 15 1978
WATER RESOURCES DEPT.
SALEM, OREGON

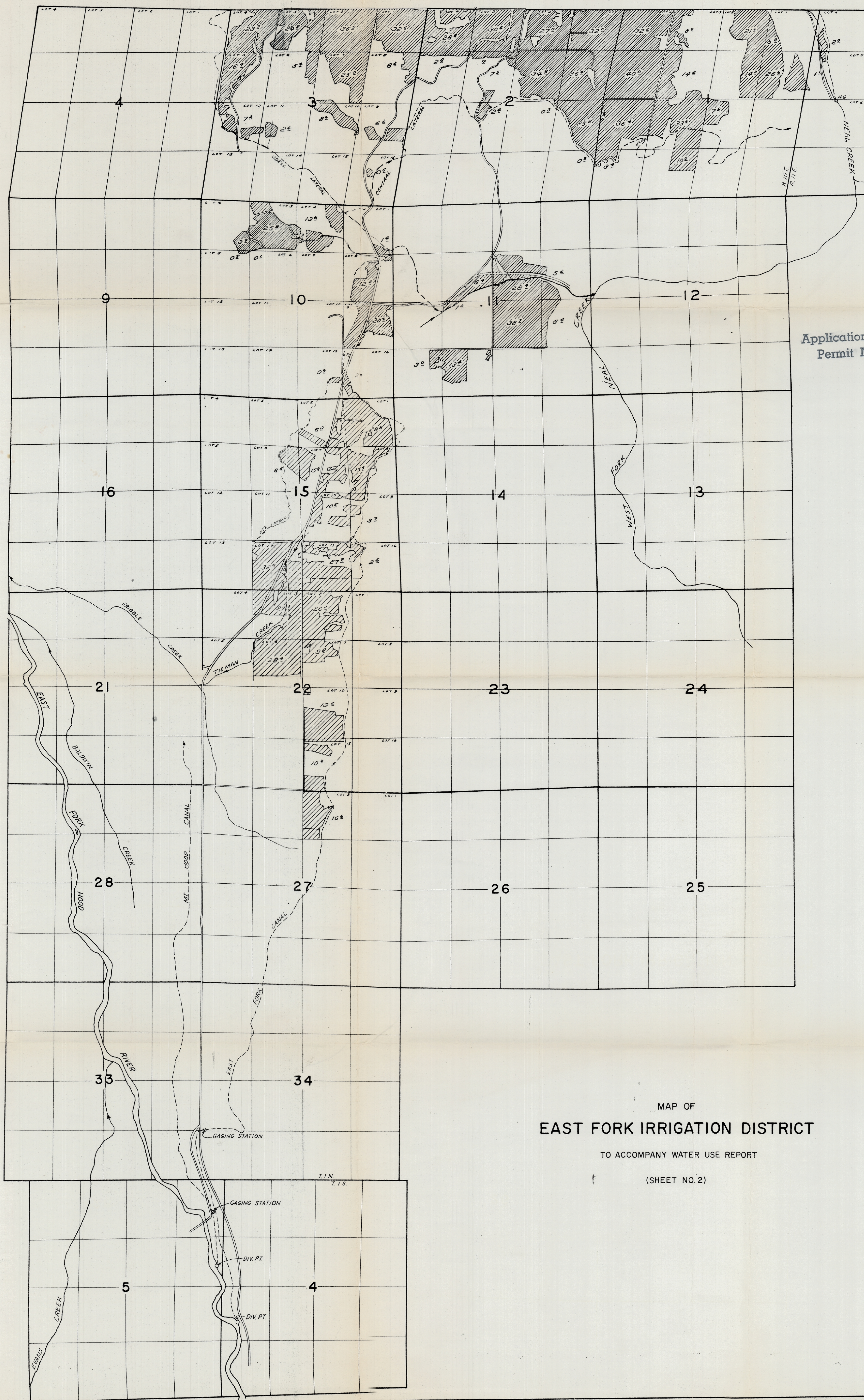

Application No. 55336
Permit No. 43393

MAP OF
EAST FORK IRRIGATION DISTRICT

TO ACCOMPANY WATER USE REPORT

(SHEET NO. 2)

T.1N.R.10&11E., T.1S.R.10E. W.M.

202
1X1



Application No. 55336
Permit No. 43393

MAP OF
EAST FORK IRRIGATION DISTRICT

TO ACCOMPANY WATER USE REPORT

(SHEET NO. 2)

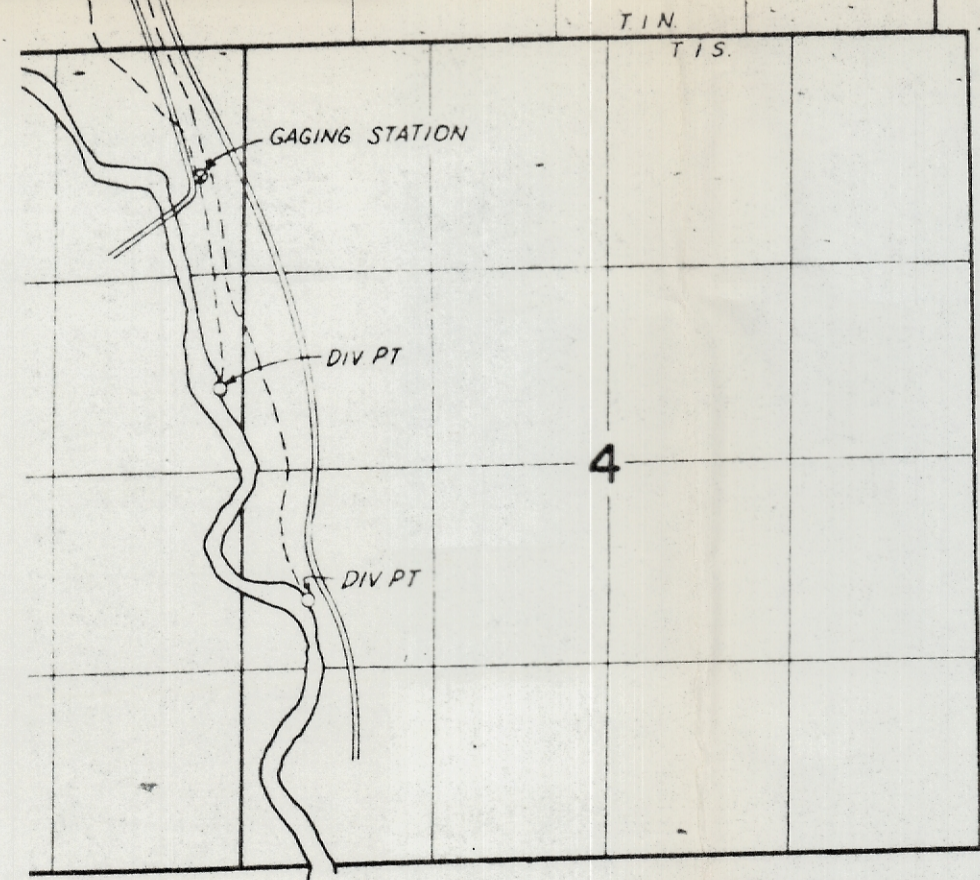



RECEIVED
AUG 15 1978
WATER RESOURCES DEPT.
SALEM, OREGON

MAP OF EAST FORK IRRIGATION DISTRICT

TO ACCOMPANY WATER USE REPORT
PREPARED BY

CHRIS L. WHEELER
STATE ENGINEER

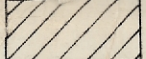
LEGEND:

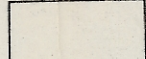
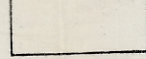
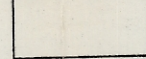
-  IRRIGATED LANDS
-  LANDS UTILIZING SOLID SET SPRINKLER SYSTEMS FOR FROST CONTROL
-  VESTED RIGHTS NO LONGER IRRIGATED
-  VESTED RIGHTS NO LONGER IRRIGATED EXACT LOCATION UNKNOWN
-  ADDITIONAL LANDS CLAIMED BY DISTRICT AFTER 1963-65 SURVEY

SCALE: 4" = MILE
(SHEET OF 2)

Application No. 55336
Permit No. 43393

