

RECEIVED

OCT 4 1982

WATER RESOURCES DEPT.  
SALEM, OREGON

T. 8S. R. 39E. W. M.

Application No. R-64410 +  
64411  
Permit No. R 8554 47283

RECEIVED

DEC 9 1982

WATER RESOURCES DEPT.  
SALEM, OREGON

RECEIVED  
DEC 29 1982  
WATER RESOURCES DEPT.  
SALEM, OREGON

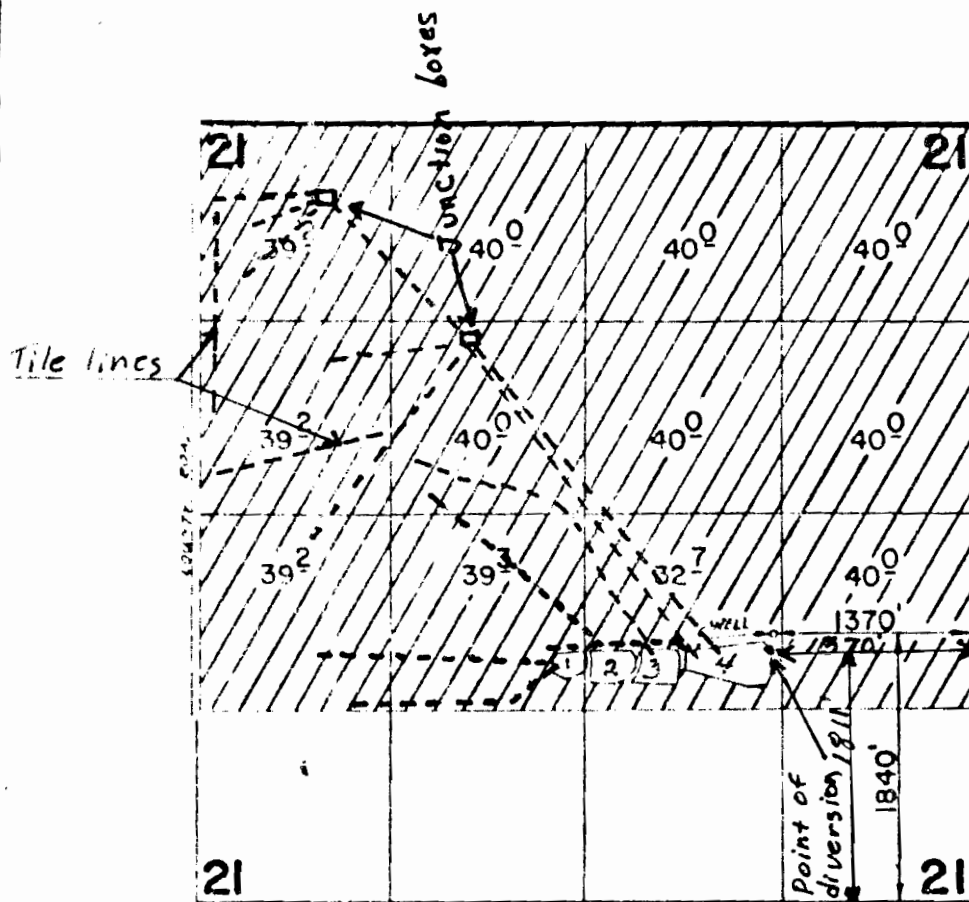

Sec 21 T8S R39EW M

Pond #	Location	Distance from SE Corner sec. 21
1	NE <sup>4</sup> SW <sup>4</sup>	1652' N, 2675' W
2	NW <sup>4</sup> SE <sup>4</sup>	1652' N 2325' W
3	NW <sup>4</sup> SE <sup>4</sup>	1652' N 2025' W
4	NW <sup>4</sup> SE <sup>4</sup>	1652' N 1400' W