

T1S., R. 11W., W.M.

T1S. & T2S., R. 10 W., W.M.
TILLAMOOK COUNTY

R. 11W.
R. 10W.

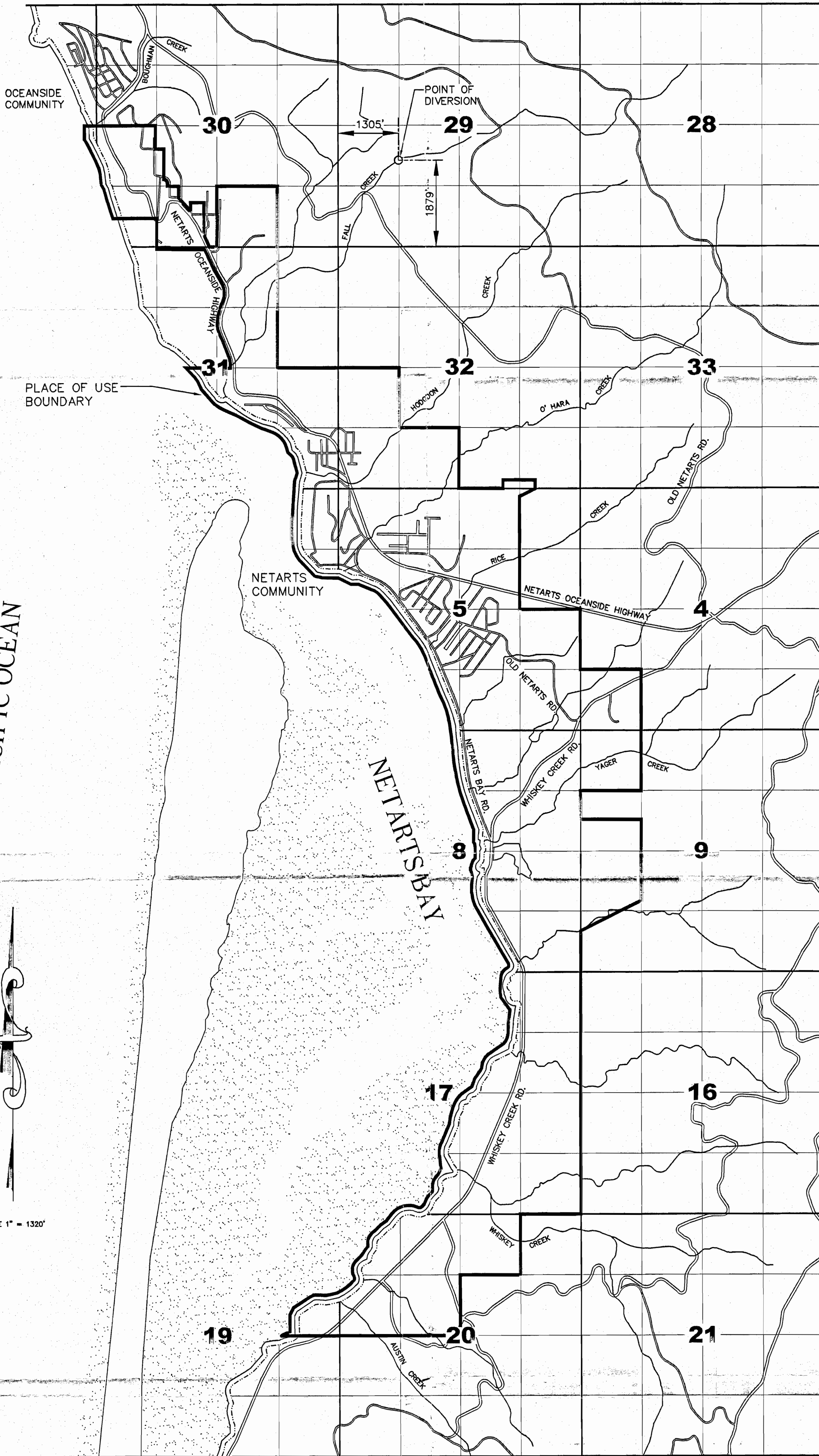

RECEIVED
OCT 19 2006
WATER RESOURCES DEPT
SALEM, OREGON

PACIFIC OCEAN

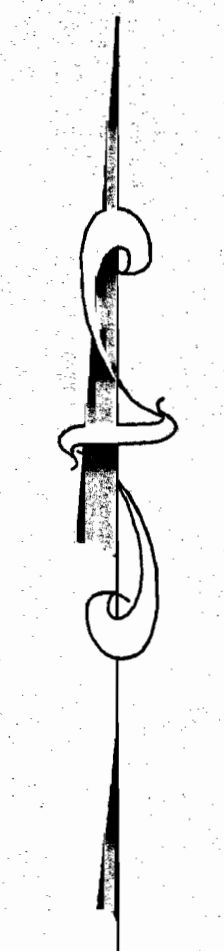

SCALE 1" = 1320'

T. 1S.
T. 2S.

THE PURPOSE OF THIS MAP IS TO IDENTIFY THE LOCATION OF THE WATER RIGHT. IT IS NOT INTENDED TO PROVIDE INFORMATION RELATIVE TO THE LOCATION OF PROPERTY OWNERSHIP BOUNDARY LINES.

WATER RIGHT APPLICATION MAP
IN THE NAME OF
NETARTS WATER DISTRICT
(QUASI-MUNICIPAL USE)
TILLAMOOK COUNTY, OREGON
SEPTEMBER 18, 2006

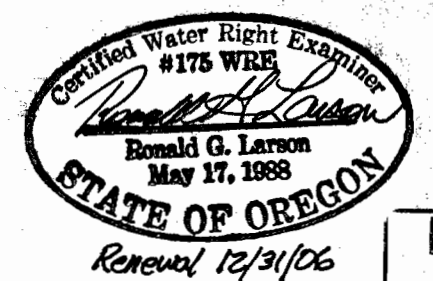

RECEIVED
OCT 19 2006
WATER RESOURCES DEPT
SALEM, OREGON

NO.	DATE	DESCRIPTION	BY

SHEET

1

NETARTS WATER DISTRICT
WATER RIGHT APPLICATION MAP

JOB NO. M05,244
DATE SEPT. 18, 2006
DESIGNED KMS
DRAWN KMS/SBM
CHECKED RGL

HLB & Associates
INCORPORATED
Surveying • Civil Engineering • Planning • Water Rights • Wetlands Consulting

CLATSOP COUNTY 4253A HWY 101 N. GEARHART, OR 97138 (503) 738-3425 FAX: (503) 738-7455	PACIFIC COUNTY 1715B N. PACIFIC AVE. LONG BEACH, WA 98631 (360) 642-4454 FAX: (360) 642-4054	TILLAMOOK COUNTY 160 LANEDA AVE. MANZANITA, OR 97130 (503) 368-5394 FAX: (503) 368-5844
--	---	--