

STATE OF OREGON
COUNTY OF KLAMATH
CERTIFICATE OF WATER RIGHT

THIS CERTIFICATE ISSUED TO

VICKI L. MILLER
HC 63, BOX 894-A
SPRAGUE RIVER, OREGON 97639

confirms the right to use the waters of A WELL in the WHISKY CREEK BASIN for the purpose of IRRIGATING 19.8 ACRES.

The right has been perfected under Permit G-9533. The date of priority is MARCH 14, 1980. The right is limited to not more than 0.25 CUBIC FOOT PER SECOND or its equivalent in case of rotation, measured at the well.

The well is located as follows:

NE 1/4 SW 1/4, SECTION 25, T 36 S, R 11 E, W.M.; 2330 FEET NORTH AND 130 FEET WEST FROM THE S 1/4 CORNER OF SECTION 25.

The amount of water used for irrigation, together with the amount secured under any other right existing for the same lands, shall be limited to ONE-EIGHTIETH of one cubic foot per second per acre, or its equivalent for each acre irrigated and shall be further limited to a diversion of not to exceed 3.0 acre-feet per acre for each acre irrigated during the irrigation season of each year.

The right shall conform to such reasonable rotation system as may be ordered by the proper state officer.

A description of the place of use under the right, and to which such right is appurtenant, is as follows:

NE 1/4 SW 1/4 14.0 ACRES
SE 1/4 SW 1/4 5.8 ACRES
SECTION 25
TOWNSHIP 36 SOUTH, RANGE 11 EAST, W.M.

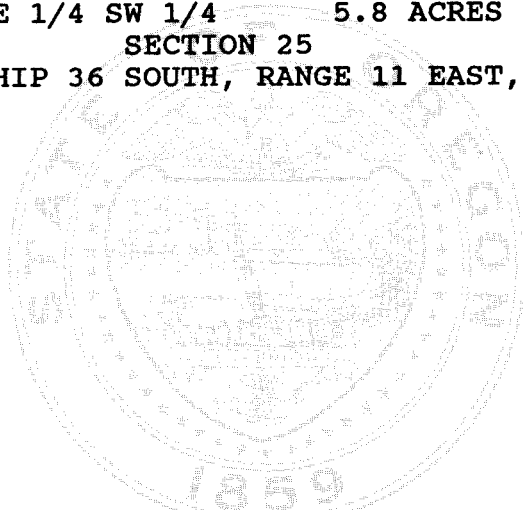

The right to the use of the water for the above purpose is restricted to beneficial use on the lands or place of use described.

WITNESS the signature of the Water Resources Director, affixed
JUNE 12, 1991.

/s/ WILLIAM H. YOUNG
William H. Young

Recorded in State Record of Water Right Certificates numbered 66013.

G-9616.JCL