

STATE OF OREGON  
COUNTY OF BAKER  
CERTIFICATE OF WATER RIGHT

THIS CERTIFICATE ISSUED TO

U.S. BUREAU OF RECLAMATION  
BOX 043-055 W FORT ST  
BOISE, ID 83724

confirms the right to use the waters of POWDER RIVER AND 64,400 ACRE-FEET FROM PHILLIPS LAKE RESERVOIR constructed under PERMIT R-5083, a tributary of SNAKE RIVER for IRRIGATION of 2998.7 acres of land and SUPPLEMENTAL IRRIGATION of 14,343.8 acres.

This right was perfected under Permit 32932. The date of priority is JUNE 19, 1958. This right is limited to 74.35 CUBIC FEET PER SECOND, or its equivalent in case of rotation, and measured at the point of diversion from the source.

The points of diversion are located as follows:

- POINT 0 (MASON DAM): NW 1/4 NE 1/4, SECTION 25, T 10 S, R 38 E, W.M.; 50 FEET SOUTH & 1500 FEET WEST FROM NE CORNER, SECTION 25.
- POINT 1 (MILES): NW 1/4 SW 1/4, SECTION 28, T 10 S, R 39 E, W.M.; 1590 FEET NORTH & 540 FEET EAST FROM SW CORNER, SECTION 28.
- POINT 2 (BOWMAN): NE 1/4 SW 1/4, SECTION 35, T 10 S, R 39 E, W.M.; 2700 FEET SOUTH & 2240 FEET EAST FROM NW CORNER, SECTION 35.
- POINT 3 (J. MARTIN 1): SW 1/4 NE 1/4, SECTION 35, T 10 S, R 39 E, W.M.; 2640 FEET SOUTH & 1640 FEET WEST FROM NE CORNER, SECTION 35.
- POINT 3A (J. MARTIN 2): NE 1/4 SE 1/4, SECTION 35, T 10 S, R 39 E, W.M.; 270 FEET SOUTH & 90 FEET WEST FROM W 1/4 CORNER, SECTION 36.
- POINT 4 (D. MARTIN): NE 1/4 NE 1/4, SECTION 36, T 10 S, R 39 E, W.M.; 500 FEET SOUTH & 300 FEET WEST FROM NE CORNER, SECTION 36.
- POINT 5 (LONG): SW 1/4 SW 1/4, SECTION 30, T 10 S, R 40 E, W.M.; 750 FEET NORTH & 1140 FEET EAST FROM SW CORNER, SECTION 30.
- POINT 6 (SMITH): NW 1/4 NE 1/4, SECTION 19, T 10 S, R 40 E, W.M.; 945 FEET SOUTH & 1865 FEET WEST FROM NE CORNER, SECTION 19
- POINT 7 (SHAW-STEWART): NW 1/4 NE 1/4, SECTION 19, T 10 S, R 40 E, W.M.; 570 FEET SOUTH & 1900 FEET WEST FROM NE CORNER, SECTION 19
- POINT 8 (CURRY): NW 1/4 NW 1/4, SECTION 17, T 10 S, R 40 E, W.M.; 1270 FEET SOUTH & 1170 FEET EAST FROM NW CORNER, SECTION 17

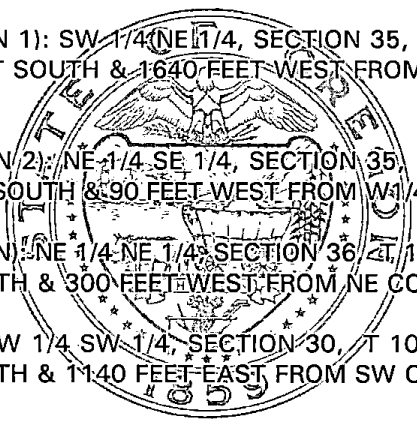

T-11060 v.81 p.454  
T-8995 APOD V58 p391  
T-8906 APOD V57 p.1194  
T-8697 V104 P122 POD  
T-8697 V70 P272  
T-8446  
T-8087

T-7791 APOD V56 p 205  
73610 vault

- POINT 8A (McKITTRICK PUMP): NE 1/4 NW 1/4, SECTION 17, T 10 S, R 40 E, W.M.; 10 FEET SOUTH & 1570 FEET EAST FROM NW CORNER, SECTION 17
- POINT 9 (MARSH-DICKINSON): NE 1/4 SW 1/4, SECTION 5, T 10 S, R 40 E, W.M.; 1600 FEET NORTH & 2350 FEET EAST FROM SW CORNER, SECTION 5
- POINT 10 (BAMBERGER): NE 1/4 SE 1/4, SECTION 32, T 9 S, R 40 E, W.M.; 2650 FEET SOUTH & 690 FEET WEST FROM NE CORNER, SECTION 32
- POINT 11 (SETTLERS SLOUGH): NW 1/4 SW 1/4, SECTION 21, T 9 S, R 40 E, W.M.; 2160 FEET NORTH & 30 FEET EAST FROM SW CORNER, SECTION 21
- POINT 12 (FERGERSON WEST 1): SW 1/4 NW 1/4, SECTION 16, T 9 S, R 40 E, W.M.; 1760 FEET SOUTH & 390 FEET EAST FROM NW CORNER, SECTION 16
- POINT 13 (BALDOCK): SW 1/4 NW 1/4, SECTION 16, T 9 S, R 40 E, W.M.; 1700 FEET SOUTH & 400 FEET EAST FROM NW CORNER, SECTION 16
- POINT 14 (SATTEBURG EAST): NE 1/4 SE 1/4, SECTION 8, T 9 S, R 40 E, W.M.; 1560 FEET NORTH & 240 FEET WEST FROM SE CORNER, SECTION 8
- POINT 15 (SATTEBURG WEST): NE 1/4 SE 1/4, SECTION 8, T 9 S, R 40 E, W.M.; 1560 FEET NORTH & 290 FEET WEST FROM SE CORNER, SECTION 8
- POINT 16 (EPPINGER): NE 1/4 SE 1/4, SECTION 8, T 9 S, R 40 E, W.M.; 40 FEET SOUTH & 2640 FEET EAST FROM CENTER, SECTION 8
- POINT 17 (CORRAL): SW 1/4 NW 1/4, SECTION 9, T 9 S, R 40 E, W.M.; 50 FEET NORTH & 2720 FEET EAST FROM Center 1/4 CORNER, SECTION 8
- POINT 18 (ESTES WEST): NE 1/4 NE 1/4, SECTION 8, T 9 S, R 40 E, W.M.; 110 FEET SOUTH & 600 FEET WEST FROM NE CORNER, SECTION 8
- POINT 19 (ESTES EAST): NE 1/4 NE 1/4, SECTION 8, T 9 S, R 40 E, W.M.; 100 FEET SOUTH & 550 FEET WEST FROM NE CORNER, SECTION 8
- POINT 20 (MCENROE EAST): NE 1/4 SE 1/4, SECTION 5, T 9 S, R 40 E, W.M.; 2250 FEET NORTH & 320 FEET WEST FROM SE CORNER, SECTION 5
- POINT 21 (MCENROE WEST): NE 1/4 SE 1/4, SECTION 5, T 9 S, R 40 E, W.M.; 2250 FEET NORTH & 360 FEET WEST FROM SE CORNER, SECTION 5
- POINT 22 (COMPANY EAST): SE 1/4 NE 1/4, SECTION 5, T 9 S, R 40 E, W.M.; 1600 FEET SOUTH & 280 FEET WEST FROM NE CORNER, SECTION 5
- POINT 23 (COMPANY WEST): SE 1/4 NE 1/4, SECTION 5, T 9 S, R 40 E, W.M.; 1600 FEET SOUTH & 320 FEET WEST FROM NE CORNER, SECTION 5
- POINT 24 (WENDT EAST): SW 1/4 SW 1/4, SECTION 33, T 8 S, R 40 E, W.M.; 1000 FEET NORTH & 600 FEET EAST FROM SW CORNER, SECTION 33

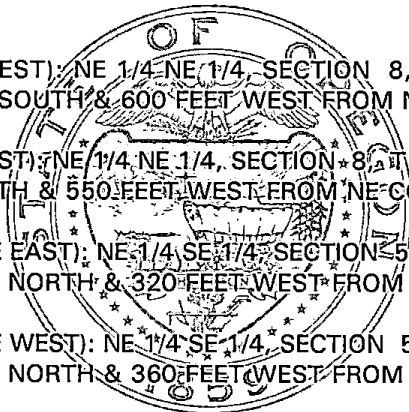

- POINT 25 (WENDT WEST): SW 1/4 SW 1/4, SECTION 33, T 8 S, R 40 E, W.M.; 1010 FEET NORTH & 560 FEET EAST FROM SW CORNER, SECTION 33
- POINT 26 (POWERS EAST 2): NW 1/4 SW 1/4, SECTION 33, T 8 S, R 40 E, W.M.; 2640 FEET NORTH & 850 FEET EAST FROM SW CORNER, SECTION 33
- DITCH 27 (POWERS EAST 1): NW 1/4 SW 1/4, SECTION 33, T 8 S, R 40 E, W.M.; 2650 FEET NORTH & 850 FEET EAST FROM SW CORNER, SECTION 33
- POINT 28 (POWERS WEST 1): SW 1/4 NW 1/4, SECTION 33, T 8 S, R 40 E, W.M.; 2650 FEET NORTH & 800 FEET EAST FROM SW CORNER, SECTION 33
- POINT 28A (POWERS WEST 2): SW 1/4 NW 1/4, SECTION 33, T 8 S, R 40 E, W.M.; 2650 FEET NORTH & 800 FEET EAST FROM SW CORNER, SECTION 33
- POINT 29 (TAGGART WEST): SE 1/4 NW 1/4, SECTION 28, T 8 S, R 40 E, W.M.; 2650 FEET NORTH & 1650 FEET EAST FROM SW CORNER, SECTION 28
- POINT 30 (TAGGART EAST): SE 1/4 NW 1/4, SECTION 28, T 8 S, R 40 E, W.M.; 2650 FEET NORTH & 1690 FEET EAST FROM SW CORNER, SECTION 28
- POINT 31 (PERKINS EAST 2): NE 1/4 SE 1/4, SECTION 20, T 8 S, R 40 E, W.M.; 2660 FEET SOUTH & 140 FEET WEST FROM NE CORNER, SECTION 20
- POINT 32 (PERKINS WEST): SE 1/4 NE 1/4, SECTION 20, T 8 S, R 40 E, W.M.; 60 FEET NORTH & 420 FEET WEST FROM E 1/4 CORNER, SECTION 20
- POINT 33 (PERKINS EAST 1): SE 1/4 NE 1/4, SECTION 20, T 8 S, R 40 E, W.M.; 110 FEET NORTH & 390 FEET WEST FROM E 1/4 CORNER, SECTION 20
- POINT 34 (HARRISON WEST 4): NE 1/4 NE 1/4, SECTION 20, T 8 S, R 40 E, W.M.; 20 FEET SOUTH & 1130 FEET WEST FROM NE CORNER, SECTION 20
- POINT 35 (WELLMAN WEST 3): SW 1/4 SE 1/4, SECTION 17, T 8 S, R 40 E, W.M.; 30 FEET NORTH & 1050 FEET WEST FROM SE CORNER, SECTION 17
- POINT 36 (WELLMAN EAST 2): SE 1/4 SE 1/4, SECTION 17, T 8 S, R 40 E, W.M.; 840 FEET NORTH & 950 FEET WEST FROM SE CORNER, SECTION 17
- POINT 37 (WELLMAN WEST 2): SE 1/4 SE 1/4, SECTION 17, T 8 S, R 40 E, W.M.; 490 FEET NORTH & 980 FEET WEST FROM SE CORNER, SECTION 17
- POINT 38 (WELLMAN EAST 1): SE 1/4 SE 1/4, SECTION 17, T 8 S, R 40 E, W.M.; 30 FEET NORTH & 970 FEET WEST FROM SE CORNER, SECTION 17

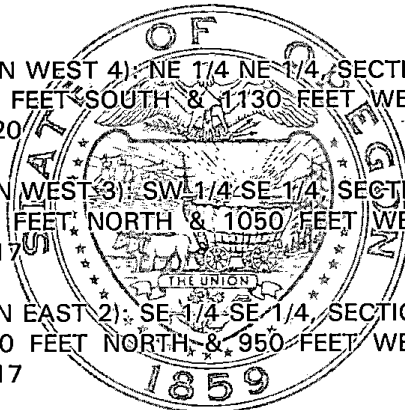

- POINT 39 (WELLMAN WEST 1): SE 1/4 SE 1/4, SECTION 17, T 8 S, R 40 E, W.M.; 850 FEET NORTH & 1000 FEET WEST FROM SE CORNER, SECTION 17
- POINT 40 (GRIER EAST): SE 1/4 NE 1/4, SECTION 17, T 8 S, R 40 E, W.M.; 3750 FEET NORTH & 490 FEET WEST FROM SE CORNER, SECTION 17
- POINT 41 (GRIER WEST): NE 1/4 NE 1/4, SECTION 17, T 8 S, R 40 E, W.M.; 4460 FEET NORTH & 920 FEET WEST FROM SE CORNER, SECTION 17
- POINT 42 (GRIER EAST 1): NE 1/4 NE 1/4, SECTION 17, T 8 S, R 40 E, W.M.; 4470 FEET NORTH & 880 FEET WEST FROM SE CORNER, SECTION 17
- POINT 43 (GRIER EAST 2): NE 1/4 NE 1/4, SECTION 17, T 8 S, R 40 E, W.M.; 4475 FEET NORTH & 880 FEET WEST FROM SE CORNER, SECTION 17
- POINT 47 (ISON WEST 2): NE 1/4 SW 1/4, SECTION 8, T 8 S, R 40 E, W.M.; 1700 FEET NORTH & 2050 FEET EAST FROM SW CORNER, SECTION 8
- POINT 48 (ISON EAST 2): NE 1/4 SW 1/4, SECTION 8, T 8 S, R 40 E, W.M.; 1740 FEET NORTH & 2070 FEET EAST FROM SW CORNER, SECTION 8
- POINT 49 (ISON WEST 1): SE 1/4 NW 1/4, SECTION 8, T 8 S, R 40 E, W.M.; 2660 FEET NORTH & 1390 FEET EAST FROM SW CORNER, SECTION 8
- POINT 50 (ISON EAST 1): SE 1/4 NW 1/4, SECTION 8, T 8 S, R 40 E, W.M.; 2670 FEET NORTH & 1430 FEET EAST FROM SW CORNER, SECTION 8
- POINT 51 (ELLIOTT WEST 2): SE 1/4 NE 1/4, SECTION 7, T 8 S, R 40 E, W.M.; 1470 FEET SOUTH & 40 FEET WEST FROM NE CORNER, SECTION 7
- POINT 52 (ELLIOTT WEST 1): NW 1/4 NE 1/4, SECTION 7, T 8 S, R 40 E, W.M.; 420 FEET SOUTH & 1240 FEET WEST FROM NE CORNER, SECTION 7
- POINT 53 (ELLIOTT EAST 2): NE 1/4 NE 1/4, SECTION 7, T 8 S, R 40 E, W.M.; 390 FEET SOUTH & 1200 FEET WEST FROM NE CORNER, SECTION 7
- POINT 54 (ELLIOTT EAST 1): NE 1/4 NE 1/4, SECTION 7, T 8 S, R 40 E, W.M.; 390 FEET SOUTH & 1200 FEET WEST FROM NE CORNER, SECTION 7
- POINT 56 (LILLEY PUMPS): NE 1/4 NE 1/4, SECTION 11, T 8 S, R 39 E, W.M.; 270 FEET SOUTH & 340 FEET WEST FROM NE CORNER, SECTION 11

The amount of water used for irrigation, together with the amount secured under any other right existing for the same lands, is limited to a diversion of ONE-FORTIETH of one cubic foot per second per acre, or its equivalent from direct flow, and 3.5 acre-feet per acre for each acre irrigated during the irrigation season of each year from both direct flow and stored water, provided further that the right allowed herein shall limit the use of stored water only on the lands described as Supplemental Irrigation from storage.

The use shall conform to such reasonable rotation system as may be ordered by the proper state officer.

A description of the place of use to which this right is appurtenant is as follows:

**PRIMARY IRRIGATION from Powder River, Supplemental from storage**

ACRES	¼	¼	SEC	T(S)	R(E)
38.50	NW	NW	29	7	40
21.00	SE	NW	29	7	40
37.80	SW	NW	29	7	40
39.60	NW	SW	29	7	40
39.40	SW	SW	29	7	40
40.30	NE	NE	30	7	40
9.90	NW	NE	30	7	40
39.30	SE	NE	30	7	40
36.00	SW	NE	30	7	40
22.60	NE	NW	30	7	40
36.70	NW	NW	30	7	40
40.70	SE	NW	30	7	40
38.80	NE	SE	30	7	40
37.40	NW	SE	30	7	40
39.50	SE	SE	30	7	40
42.70	SW	SE	30	7	40
40.40	NE	SW	30	7	40
39.60	SE	SW	30	7	40
39.90	NE	NE	31	7	40
42.50	NW	NE	31	7	40
40.20	SE	NE	31	7	40
41.40	SW	NE	31	7	40
0.90	NW	NW	31	7	40
40.60	NE	SE	31	7	40
39.90	NW	SE	31	7	40
16.10	SE	SE	31	7	40
21.20	SW	SE	31	7	40
38.90	NE	SW	31	7	40
27.20	SE	SW	31	7	40
30.20	NE	NE	32	7	40
40.00	NW	NE	32	7	40
40.00	SE	NE	32	7	40
34.00	NW	NW	32	7	40
37.60	SW	NW	32	7	40
38.00	NW	SW	32	7	40
12.50	SE	NW	33	7	40
40.00	SW	NW	33	7	40
24.80	NE	SE	33	7	40
27.90	NW	SE	33	7	40
3.00	SE	SE	33	7	40
28.80	SE	SE	33	7	40
6.70	NE	SW	33	7	40
1.00	NE	NE	1	8	39
1.00	SW	NW	1	8	39
2.50	SE	NW	11	8	39
22.50	NW	NW	24	8	39
23.40	SE	SW	2	8	40
21.20	SW	SW	2	8	40
26.80	NW	NW	3	8	40

ACRES	¼	¼	SEC	T(S)	R(E)
40.00	SW	NW	3	8	40
23.60	SE	SE	3	8	40
31.60	SW	SE	3	8	40
40.00	NW	SW	3	8	40
39.00	NE	NE	4	8	40
33.70	NW	NE	4	8	40
34.20	NE	NW	4	8	40
37.60	NW	NW	4	8	40
39.00	SW	NW	4	8	40
37.00	SE	NW	4	8	40
2.00	NW	SW	4	8	40
37.60	NE	NE	5	8	40
13.30	NW	NE	5	8	40
22.70	SE	NE	5	8	40
2.40	SW	NE	5	8	40
1.30	NE	SE	5	8	40
1.40	SW	SE	5	8	40
6.20	SE	SW	5	8	40
0.50	SW	SW	6	8	40
2.50	NE	NE	8	8	40
2.80	SE	NE	8	8	40
1.60	SW	NW	8	8	40
40.00	NE	NE	10	8	40
40.00	NW	NE	10	8	40
22.50	SE	NE	10	8	40
22.50	SW	NE	10	8	40
39.90	NW	NE	11	8	40
40.00	SW	NE	11	8	40
40.00	NE	NW	11	8	40
40.00	NW	NW	11	8	40
22.40	SE	NW	11	8	40
22.40	SW	NW	11	8	40
7.10	NE	SE	11	8	40
40.00	NW	SE	11	8	40
0.80	SE	NW	16	8	40
0.40	SW	NW	16	8	40
6.20	NE	SW	16	8	40
0.40	NW	SW	16	8	40
19.50	SE	SW	16	8	40
2.10	SW	SW	16	8	40
40.00	NW	NW	21	8	40
15.80	SW	SE	25	8	40
6.40	NE	NW	28	8	40
9.60	SE	NW	28	8	40
8.00	NW	SW	32	8	40
4.70	NW	NE	33	8	40
31.60	NE	SE	33	8	40
33.20	SE	SE	33	8	40
2.00	SE	SE	36	8	40
5.90	SW	SE	36	8	40
4.30	NE	SW	31	8	41
1.00	NE	NW	1	9	39

ACRES	¼	¼	SEC	T(S)	R(E)
6.00	SE	NW	1	9	39
6.10	SW	SE	12	9	39
11.90	NE	NE	1	9	40
0.30	SE	NE	1	9	40
7.90	SW	NE	1	9	40
2.40	NE	NW	1	9	40
1.60	NW	NW	1	9	40
14.00	NW	NW	1	9	40
24.80	SE	NW	1	9	40
7.70	SW	NW	1	9	40
0.90	NE	SW	1	9	40
18.40	NE	NW	4	9	40
2.00	SW	SW	7	9	40
7.40	SW	NE	10	9	40
0.80	SW	SE	10	9	40
4.60	NE	SE	11	9	40
5.40	NW	SE	11	9	40
1.40	NW	NE	12	9	40
30.80	SE	NE	12	9	40
38.00	SW	NE	12	9	40
32.80	NE	NW	12	9	40
18.00	NW	NW	12	9	40
15.80	SE	NW	12	9	40
28.60	NE	SE	12	9	40
6.40	NW	SE	12	9	40
2.00	SE	SE	12	9	40
2.20	SW	SE	12	9	40
10.90	SE	NW	15	9	40
1.20	NW	NW	18	9	40
1.00	NW	NE	21	9	40
1.20	SE	SE	21	9	40
24.40	SW	SE	21	9	40
7.70	NE	NW	22	9	40
13.60	NW	NW	22	9	40
30.30	SE	NW	23	9	40
30.40	SW	NW	23	9	40
28.40	NE	SW	23	9	40
28.40	NW	SW	23	9	40
1.50	SE	SE	29	9	40
0.50	SW	SE	29	9	40
0.70	SE	NE	32	9	40
2.30	NW	SW	4	10	40
3.20	NE	NW	8	10	40
6.80	NW	SE	8	10	40
4.80	SW	SE	8	10	40
0.30	NE	SW	8	10	40
5.10	SE	SW	8	10	40
4.00	NE	NW	17	10	40
0.20	NW	NW	17	10	40
6.80	NE	NE	19	10	40
17.20	NW	NW	20	10	40

ACRES	¼	¼	SEC	T(S)	R(E)
2998.70	Primary Irrigation from Powder River and storage				

**SUPPLEMENTAL IRRIGATION from Storage**

ACRES	¼	¼	SEC	T(S)	R(E)
28.00	NW	NE	30	7	40
6.00	SW	NE	30	7	40
15.00	NE	NW	30	7	40
38.40	SW	NW	30	7	40
5.00	NW	SE	30	7	40
25.60	NW	SW	30	7	40
39.00	SW	SW	30	7	40
39.20	NE	NW	31	7	40
39.10	NW	NW	31	7	40
37.20	SE	NW	31	7	40
36.80	SW	NW	31	7	40
35.20	NW	SW	31	7	40
30.40	SW	SW	31	7	40
40.00	SW	NE	32	7	40
39.80	NE	NW	32	7	40
5.00	NW	NW	32	7	40
39.90	SE	NW	32	7	40
40.00	NE	SE	32	7	40
40.00	NW	SE	32	7	40
39.30	SE	SE	32	7	40
39.40	SW	SE	32	7	40
40.00	NE	SW	32	7	40
39.40	SE	SW	32	7	40
6.90	NW	SE	33	7	40
2.20	SE	SE	33	7	40
4.00	SE	SE	33	7	40
3.20	SW	SE	33	7	40
28.30	SW	SE	33	7	40
26.50	NE	SW	33	7	40
40.00	NW	SW	33	7	40
6.70	SE	SW	33	7	40
24.90	SE	SW	33	7	40
39.00	SW	SW	33	7	40
10.50	NE	NE	1	8	39
24.00	SE	NE	1	8	39
12.40	SW	NE	1	8	39
18.00	SE	NW	1	8	39
11.00	SW	NW	1	8	39
0.50	NW	SE	1	8	39
25.70	NE	SW	1	8	39
27.20	NW	SW	1	8	39
22.80	SW	SW	1	8	39
18.00	NW	NE	2	8	39
26.00	SW	NE	2	8	39
2.20	NE	NW	2	8	39
27.60	SE	NW	2	8	39
12.40	NW	SE	2	8	39
2.40	SE	SE	2	8	39



ACRES	¼	¼	SEC	T(S)	R(E)
18.80	SW	SE	2	8	39
27.40	NE	SW	2	8	39
0.50	NE	NE	11	8	39
24.70	SE	NE	11	8	39
25.50	SW	NE	11	8	39
6.00	SE	NW	11	8	39
38.30	NE	SE	11	8	39
39.80	SE	SE	11	8	39
11.10	NE	NE	12	8	39
38.40	SW	NE	12	8	39
1.40	NE	NW	12	8	39
40.00	SE	NW	12	8	39
36.30	SW	NW	12	8	39
39.60	NW	SE	12	8	39
39.80	SW	SE	12	8	39
39.60	NE	SW	12	8	39
39.60	NW	SW	12	8	39
39.80	SE	SW	12	8	39
39.80	SW	SW	12	8	39
1.20	NE	NE	13	8	39
40.00	NW	NE	13	8	39
40.00	NE	NW	13	8	39
20.00	NW	NW	13	8	39
24.00	SW	NW	13	8	39
39.00	NW	SW	13	8	39
40.00	SW	SW	13	8	39
40.00	NE	NE	14	8	39
7.60	NW	NE	14	8	39
3.90	SE	NE	14	8	39
40.00	SE	NW	36	8	39
40.00	SW	NW	36	8	39
37.80	NE	SE	36	8	39
39.30	NW	SE	36	8	39
40.00	NE	SW	36	8	39
40.00	SE	SW	36	8	39
12.00	SW	SW	4	8	40
14.80	NW	SE	5	8	40
32.70	SE	SE	5	8	40
36.40	SW	SE	5	8	40
24.00	NE	SW	5	8	40
26.40	NW	SW	5	8	40
31.80	SE	SW	5	8	40
37.10	SW	SW	5	8	40
4.80	SE	NE	6	8	40
14.80	SW	NE	6	8	40
20.80	NW	NW	6	8	40
15.20	SE	NW	6	8	40
39.00	NE	SE	6	8	40
13.60	NW	SE	6	8	40
24.00	NW	SE	6	8	40

ACRES	¼	¼	SEC	T(S)	R(E)
40.00	SE	SE	6	8	40
40.00	SW	SE	6	8	40
39.70	NE	SW	6	8	40
9.20	NW	SW	6	8	40
40.00	SE	SW	6	8	40
40.00	SW	SW	6	8	40
0.60	NE	NE	7	8	40
25.00	NE	NE	7	8	40
15.20	NW	NE	7	8	40
40.00	SW	NE	7	8	40
26.20	NE	NW	7	8	40
30.00	NW	NW	7	8	40
32.70	SE	NW	7	8	40
11.00	NE	SE	7	8	40
10.30	SE	SE	7	8	40
40.00	NE	NE	8	8	40
32.70	NW	NE	8	8	40
40.00	SE	NE	8	8	40
18.50	SW	NE	8	8	40
37.20	NW	NW	8	8	40
40.00	SW	NW	8	8	40
15.00	NE	SE	8	8	40
22.40	NE	SE	8	8	40
5.60	NW	SE	8	8	40
28.10	NW	SE	8	8	40
15.40	SE	SE	8	8	40
7.90	SW	SE	8	8	40
18.40	SW	SE	8	8	40
3.60	NE	SW	8	8	40
13.20	NE	SW	8	8	40
18.80	NE	SW	8	8	40
40.00	NW	SW	8	8	40
0.20	SE	SW	8	8	40
17.70	SE	SW	8	8	40
40.00	SW	SW	8	8	40
3.00	NW	NW	9	8	40
22.40	SE	NW	9	8	40
0.40	SW	NW	9	8	40
29.10	SW	NW	9	8	40
4.80	NW	NE	16	8	40
10.00	SW	NE	16	8	40
10.70	NE	NW	16	8	40
40.00	SE	NW	16	8	40
40.00	SW	NW	16	8	40
32.00	NE	SW	16	8	40
40.00	NW	SW	16	8	40
18.80	SE	SW	16	8	40
37.00	SW	SW	16	8	40
9.60	NE	NE	17	8	40
10.80	NE	NE	17	8	40

ACRES	¼	¼	SEC	T(S)	R(E)
18.40	NE	NE	17	8	40
0.10	NW	NE	17	8	40
5.20	NW	NE	17	8	40
33.20	NW	NE	17	8	40
2.20	SE	NE	17	8	40
8.60	SE	NE	17	8	40
26.40	SE	NE	17	8	40
40.00	SW	NE	17	8	40
36.40	SE	NW	17	8	40
0.30	NE	SE	17	8	40
3.70	NE	SE	17	8	40
32.80	NE	SE	17	8	40
6.80	NW	SE	17	8	40
33.10	NW	SE	17	8	40
2.80	SE	SE	17	8	40
3.30	SE	SE	17	8	40
4.70	SE	SE	17	8	40
9.90	SE	SE	17	8	40
10.40	SE	SE	17	8	40
1.10	SW	SE	17	8	40
6.20	SW	SE	17	8	40
27.80	SW	SE	17	8	40
40.00	NE	SW	17	8	40
40.00	NW	SW	17	8	40
39.40	SE	SW	17	8	40
39.20	SW	SW	17	8	40
2.20	NW	NE	18	8	40
34.80	SE	NE	18	8	40
40.00	SW	NE	18	8	40
40.00	NE	SE	18	8	40
33.20	NW	SE	18	8	40
39.20	SE	SE	18	8	40
21.60	SW	SE	18	8	40
31.00	NE	NE	19	8	40
13.00	NW	NE	19	8	40
24.00	SE	NE	19	8	40
25.50	NE	SE	19	8	40
6.00	NE	NE	20	8	40
29.60	NE	NE	20	8	40
39.60	NW	NE	20	8	40
13.60	SE	NE	20	8	40
22.40	SE	NE	20	8	40
40.00	SW	NE	20	8	40
39.60	NE	NW	20	8	40
12.40	NW	NW	20	8	40
26.80	NW	NW	20	8	40
0.70	SE	NW	20	8	40
39.30	SE	NW	20	8	40
1.50	SW	NW	20	8	40
37.30	SW	NW	20	8	40

ACRES	¼	¼	SEC	T(S)	R(E)
37.20	NE	SE	20	8	40
40.00	NW	SE	20	8	40
34.80	SE	SE	20	8	40
38.80	SW	SE	20	8	40
40.00	NE	SW	20	8	40
40.00	NW	SW	20	8	40
40.00	SE	SW	20	8	40
29.50	SW	SW	20	8	40
31.10	NE	NW	21	8	40
31.10	SE	NW	21	8	40
40.00	NE	SE	21	8	40
8.70	NW	SE	21	8	40
17.90	NW	SE	21	8	40
40.00	SE	SE	21	8	40
8.30	SW	SE	21	8	40
18.20	SW	SE	21	8	40
26.40	NE	SW	21	8	40
18.80	NW	SW	21	8	40
39.60	SE	SW	21	8	40
32.40	SW	SW	21	8	40
9.60	NE	SE	22	8	40
2.00	SE	SE	22	8	40
10.40	SE	SE	22	8	40
38.20	SW	SE	22	8	40
14.00	SE	NE	25	8	40
39.80	SW	NE	25	8	40
30.40	NE	SE	25	8	40
31.20	NW	SE	25	8	40
2.70	SE	SE	25	8	40
22.40	SE	SE	25	8	40
5.00	SW	CSE	25	8	40
10.00	NE	NE	27	8	40
37.40	NW	NE	27	8	40
10.00	SE	NE	27	8	40
37.00	SW	NE	27	8	40
25.00	NE	NW	27	8	40
37.60	NW	NW	27	8	40
38.70	SE	NW	27	8	40
19.00	SW	NW	27	8	40
20.00	NW	SE	27	8	40
11.00	SE	SE	27	8	40
33.00	SW	SE	27	8	40
14.40	NW	NE	28	8	40
18.30	SW	NE	28	8	40
13.40	NE	NW	28	8	40
25.00	NW	NW	28	8	40
12.90	SE	NW	28	8	40
25.10	SW	NW	28	8	40
39.60	NW	SW	28	8	40
22.80	SW	SW	28	8	40

ACRES	¼	¼	SEC	T(S)	R(E)
28.00	NW	SE	29	8	40
5.80	SE	SE	29	8	40
40.00	SW	SE	29	8	40
14.80	NE	SW	29	8	40
5.20	SE	SW	29	8	40
24.30	SE	SW	29	8	40
19.00	SW	SW	29	8	40
14.10	NE	NW	31	8	40
17.80	SE	NW	31	8	40
40.00	NE	SE	31	8	40
37.00	NW	SE	31	8	40
8.40	SE	SE	31	8	40
31.60	SE	SE	31	8	40
1.10	SW	SE	31	8	40
33.10	SW	SE	31	8	40
5.50	NE	SW	31	8	40
0.50	NW	SW	31	8	40
21.20	SE	SW	31	8	40
17.20	NE	NE	32	8	40
40.00	NW	NE	32	8	40
12.00	SE	NE	32	8	40
40.00	SW	NE	32	8	40
40.00	NE	SE	32	8	40
40.00	NW	SE	32	8	40
38.40	SE	SE	32	8	40
40.00	SW	SE	32	8	40
40.00	NE	SW	32	8	40
32.00	NW	SW	32	8	40
40.00	SE	SW	32	8	40
40.00	SW	SW	32	8	40
21.60	SW	NW	33	8	40
15.60	NE	NW	33	8	40
21.80	NW	NW	33	8	40
38.80	SE	NW	33	8	40
14.00	SW	NW	33	8	40
21.60	SW	NW	33	8	40
2.20	NW	SE	33	8	40
0.20	SW	SE	33	8	40
5.80	NW	SW	33	8	40
13.20	NW	SW	33	8	40
0.60	SW	SW	33	8	40
6.40	SW	SW	33	8	40
10.00	SW	SW	33	8	40
16.00	SW	SW	33	8	40
24.40	NW	NW	34	8	40
40.00	NE	SE	34	8	40
39.20	NW	SE	34	8	40
30.60	SW	SE	34	8	40
26.00	SE	SW	34	8	40
17.50	SW	SW	34	8	40

ACRES	¼	¼	SEC	T(S)	R(E)
27.60	NW	NE	35	8	40
24.00	SW	NE	35	8	40
40.00	NE	SW	35	8	40
34.10	NE	NE	36	8	40
15.10	SE	NE	36	8	40
11.30	SW	NE	36	8	40
40.00	NE	SE	36	8	40
34.80	NW	SE	36	8	40
34.00	SE	SE	36	8	40
34.10	SW	SE	36	8	40
6.20	NE	SW	36	8	40
38.70	SE	SW	36	8	40
20.10	SW	SW	36	8	40
10.60	SW	NW	31	8	41
17.70	NE	SW	31	8	41
40.00	NW	SW	31	8	41
4.10	SE	SW	31	8	41
29.10	SW	SW	31	8	41
39.90	NE	NE	1	9	39
20.00	NW	NE	1	9	39
40.00	SE	NE	1	9	39
40.00	SW	NE	1	9	39
40.00	NE	NW	1	9	39
34.00	SE	NW	1	9	39
21.70	SW	NW	1	9	39
40.00	NW	SE	1	9	39
26.90	SE	SE	1	9	39
17.90	SW	SE	1	9	39
36.00	NE	SW	1	9	39
17.00	NW	SW	1	9	39
0.40	SE	SW	1	9	39
38.60	NE	SE	12	9	39
38.60	NW	SE	12	9	39
39.70	SE	SE	12	9	39
18.30	SW	SE	12	9	39
1.00	NW	NE	10	9	40
39.00	NW	NE	10	9	40
16.10	NE	NW	1	9	40
20.00	NE	NW	1	9	40
21.70	NW	NW	1	9	40
19.60	SW	NW	1	9	40
34.70	NW	SW	1	9	40
13.60	SW	SW	1	9	40
8.00	NE	NE	2	9	40
9.00	NE	NE	2	9	40
30.00	NE	SW	2	9	40
1.70	SW	SW	2	9	40
33.00	NE	NE	3	9	40
15.20	NW	NE	3	9	40
7.90	SE	NE	3	9	40

ACRES	¼	¼	SEC	T(S)	R(E)
22.80	SW	NE	3	9	40
5.90	NE	NW	3	9	40
9.00	NE	NW	3	9	40
19.80	NE	NW	3	9	40
33.60	SE	NW	3	9	40
38.20	SW	NW	3	9	40
35.00	NE	SE	3	9	40
38.40	NW	SE	3	9	40
38.80	SE	SE	3	9	40
35.10	SW	SE	3	9	40
10.00	NE	SW	3	9	40
12.90	NE	SW	3	9	40
39.20	NW	SW	3	9	40
7.80	SE	SW	3	9	40
8.00	SW	SW	3	9	40
19.60	SW	SW	3	9	40
26.80	NW	NE	4	9	40
20.00	NE	NW	4	9	40
2.40	NW	NW	4	9	40
26.00	NW	NW	4	9	40
40.00	SW	NW	4	9	40
27.00	NE	SE	4	9	40
22.70	NW	SE	4	9	40
17.50	SE	SE	4	9	40
16.80	SW	SE	4	9	40
18.20	SW	SE	4	9	40
13.90	NE	SW	4	9	40
25.30	NE	SW	4	9	40
38.80	NW	SW	4	9	40
14.40	SE	SW	4	9	40
25.60	SE	SW	4	9	40
40.00	SW	SW	4	9	40
1.00	NE	NE	5	9	40
37.20	NE	NE	5	9	40
39.80	NW	NE	5	9	40
9.60	SE	NE	5	9	40
26.40	SE	NE	5	9	40
39.80	SW	NE	5	9	40
22.20	NW	NW	5	9	40
17.60	SW	NW	5	9	40
11.20	NE	SE	5	9	40
24.40	NE	SE	5	9	40
39.40	NW	SE	5	9	40
17.60	SE	SE	5	9	40
20.00	SE	SE	5	9	40
40.00	SW	SE	5	9	40
12.50	NE	SW	5	9	40
27.10	NE	SW	5	9	40
39.00	NW	SW	5	9	40
17.00	SE	SW	5	9	40

ACRES	¼	¼	SEC	T(S)	R(E)
23.00	SE	SW	5	9	40
35.20	NE	NE	6	9	40
3.00	NW	NE	6	9	40
10.60	NW	NE	6	9	40
16.40	NW	NE	6	9	40
13.20	SE	NE	6	9	40
23.80	SE	NE	6	9	40
38.80	SW	NE	6	9	40
40.00	SE	NW	6	9	40
10.00	SW	NW	6	9	40
38.00	NE	SE	6	9	40
40.00	NW	SE	6	9	40
37.50	SE	SE	6	9	40
40.00	SW	SE	6	9	40
30.50	NE	SW	6	9	40
37.60	SE	SW	6	9	40
39.00	NE	NE	7	9	40
36.70	NW	NE	7	9	40
28.40	SE	NE	7	9	40
35.30	SW	NE	7	9	40
39.40	NE	NW	7	9	40
38.60	NW	NW	7	9	40
40.00	SE	NW	7	9	40
40.00	SW	NW	7	9	40
39.10	NW	SE	7	9	40
39.80	SW	SE	7	9	40
6.00	NE	NE	8	9	40
31.20	NE	NE	8	9	40
38.20	NW	NE	8	9	40
38.60	SE	NE	8	9	40
38.60	SW	NE	8	9	40
35.80	NE	NW	8	9	40
14.50	NW	NW	8	9	40
35.70	SE	NW	8	9	40
32.00	NE	SE	8	9	40
9.20	NW	SE	8	9	40
27.60	SE	SE	8	9	40
0.50	SW	SE	8	9	40
21.60	SW	SE	8	9	40
3.10	NE	NE	9	9	40
3.50	NW	NE	9	9	40
5.60	NW	NE	9	9	40
12.40	NW	NE	9	9	40
6.20	SE	NE	9	9	40
0.30	SW	NE	9	9	40
10.30	SW	NE	9	9	40
14.80	SW	NE	9	9	40
11.00	NE	NW	9	9	40
14.90	NE	NW	9	9	40
39.50	NW	NW	9	9	40



ACRES	¼	¼	SEC	T(S)	R(E)
0.70	SE	NW	9	9	40
34.50	SE	NW	9	9	40
34.30	SW	NW	9	9	40
0.50	SW	SE	9	9	40
0.80	SW	SE	9	9	40
0.90	SW	SE	9	9	40
1.00	SW	SE	9	9	40
6.80	SW	SE	9	9	40
8.20	SW	SE	9	9	40
1.00	NE	SW	9	9	40
10.00	NE	SW	9	9	40
12.00	NE	SW	9	9	40
16.80	NW	SW	9	9	40
4.00	SE	SW	9	9	40
31.50	SE	SW	9	9	40
24.40	SW	SW	9	9	40
30.00	NE	NE	10	9	40
37.20	NW	NE	10	9	40
21.00	SE	NE	10	9	40
32.00	SW	NE	10	9	40
39.60	NE	SE	10	9	40
39.20	NW	SE	10	9	40
38.90	SE	SE	10	9	40
37.50	SW	SE	10	9	40
40.00	SE	NE	11	9	40
40.00	SW	NE	11	9	40
39.30	NE	NW	11	9	40
27.80	NW	NW	11	9	40
40.00	SE	NW	11	9	40
26.10	SW	NW	11	9	40
35.00	NE	SE	11	9	40
34.20	NW	SE	11	9	40
40.00	NE	SW	11	9	40
40.00	NW	SW	11	9	40
39.80	SE	SW	11	9	40
39.80	SW	SW	11	9	40
22.00	NW	NW	12	9	40
24.00	SE	NW	12	9	40
40.00	SW	NW	12	9	40
8.00	NE	SE	12	9	40
30.00	NW	SE	12	9	40
33.20	NE	SW	12	9	40
38.00	NW	SW	12	9	40
9.50	SW	SW	12	9	40
25.20	NE	NW	14	9	40
40.00	NW	NW	14	9	40
27.90	SE	NW	14	9	40
40.00	SW	NW	14	9	40
3.20	NE	SW	14	9	40
11.60	NW	SW	14	9	40

ACRES	¼	¼	SEC	T(S)	R(E)
36.60	SW	SW	14	9	40
38.70	NE	NE	15	9	40
9.20	SE	NE	15	9	40
12.00	SE	NW	15	9	40
7.70	NE	SE	15	9	40
19.40	NW	SE	15	9	40
38.40	SE	SE	15	9	40
40.00	SW	SE	15	9	40
36.90	NE	SW	15	9	40
40.00	SE	SW	15	9	40
7.60	SW	SW	15	9	40
39.00	NE	NE	18	9	40
24.30	NW	NE	18	9	40
25.50	SE	NE	18	9	40
38.70	SW	NE	18	9	40
40.00	NE	NW	18	9	40
40.00	NW	NW	18	9	40
4.70	SE	NW	18	9	40
28.10	SE	NW	18	9	40
38.70	SW	NW	18	9	40
38.40	NW	SE	18	9	40
23.00	SW	SE	18	9	40
21.20	NE	NE	22	9	40
23.20	NW	NE	22	9	40
10.30	NE	NW	22	9	40
16.40	NW	NW	23	9	40
13.60	NE	NW	28	9	40
12.80	NW	NW	28	9	40
0.10	NW	NW	4	10	40
15.20	SW	NW	4	10	40
14.10	NW	SW	4	10	40
26.70	NE	NW	5	10	40
15.40	SW	NW	5	10	40
35.60	NE	SE	5	10	40
18.50	NW	SE	5	10	40
32.40	SE	SE	5	10	40
20.60	SW	SE	5	10	40
26.80	NW	SW	5	10	40
1.60	SE	SW	5	10	40
29.60	SW	SW	5	10	40
20.80	SE	NE	7	10	40
23.60	NE	NE	8	10	40
14.80	NW	NE	8	10	40
5.40	SE	NE	8	10	40
16.80	SW	NE	8	10	40
12.90	NW	NW	8	10	40
10.50	SE	SW	8	10	40
22.70	NE	NW	17	10	40
0.20	NW	NW	17	10	40
36.80	SE	NW	17	10	40

ACRES	¼	¼	SEC	T(S)	R(E)
0.50	SW	NW	17	10	40
19.20	SW	NW	17	10	40
34.00	SW	SW	17	10	40
14.80	NE	NE	18	10	40
5.20	NW	NE	18	10	40
6.10	SE	NE	18	10	40
21.70	SE	NE	18	10	40
11.60	SW	NE	18	10	40
17.20	NE	SE	18	10	40
18.30	NW	SE	18	10	40
0.10	SW	SE	18	10	40
11.40	SW	SE	18	10	40
13436.70	Supplemental Irrigation from Storage				

**SUPPLEMENTAL IRRIGATION from Powder River and storage**

ACRES	¼	¼	SEC	T(S)	R(E)
40.00	SW	SE	29	7	40
39.00	NE	SW	29	7	40
39.00	SE	SW	29	7	40
29.20	NE	SE	12	8	39
39.80	SE	SE	12	8	39
20.00	NW	NW	13	8	39
16.00	SW	NW	13	8	39
24.00	SE	NE	14	8	39
9.50	NW	NW	24	8	39
24.80	SW	NW	7	8	40
40.00	NW	SE	7	8	40
23.50	SW	SE	7	8	40
40.00	NE	SW	7	8	40
7.20	NW	SW	7	8	40
23.50	SE	SW	7	8	40
3.00	SW	SW	7	8	40
26.40	NW	NE	25	8	40
10.00	NE	SW	2	9	40
38.10	NE	SW	7	9	40
10.10	NW	SW	7	9	40
40.00	SE	SW	7	9	40
40.00	SW	SW	7	9	40
19.20	NW	SW	9	9	40
17.00	SW	SE	18	9	40
10.00	SE	NE	32	9	40
18.80	NE	SE	9	32	40
6.40	NW	SE	32	9	40
6.80	NW	SE	32	9	40
11.40	SE	SE	32	9	40
20.40	SE	SE	32	9	40
16.80	SW	SE	32	9	40
18.20	SW	SE	32	9	40
2.40	NE	SW	32	9	40
16.00	SE	SW	32	9	40
1.60	NW	SW	4	10	40

ACRES	¼	¼	SEC	T(S)	R(E)
30.40	NE	NE	5	10	40
0.70	NW	NE	5	10	40
21.50	NW	NE	5	10	40
0.20	SE	NE	5	10	40
36.70	SE	NE	5	10	40
4.10	SW	NE	5	10	40
16.40	SW	NE	5	10	40
0.60	SE	NW	5	10	40
18.00	SE	NW	5	10	40
15.00	NW	SE	5	10	40
1.40	NE	SW	5	10	40
14.00	NE	SW	5	10	40
907.10	Supplemental Irrigation from Powder River and storage				

This certificate describes that portion of the water right confirmed by certificate 52008 State Record of Water Right Certificates, NOT modified by the provisions of an order of the Water Resources Director entered on FEB 25 1997 approving a petition by the Baker Valley Irrigation District under ORS 541.329.

Transfers T 5282, T5718 AND T5920 have been proved up in the Baker Valley Irrigation District Petition and are under separate certificate.

The issuance of this superseding certificate does not confirm the status of the water right in reference to ORS 540.610 pertaining to forfeiture or abandonment.

The right to the use of the water for the above purposes is restricted to beneficial use on the lands or place of use described. The use confirmed herein may be made only at times when sufficient water is available to satisfy all prior rights, including rights for maintaining instream water rights.

Witness the signature of the Water Resources Director, affixed FEB 25 1997.

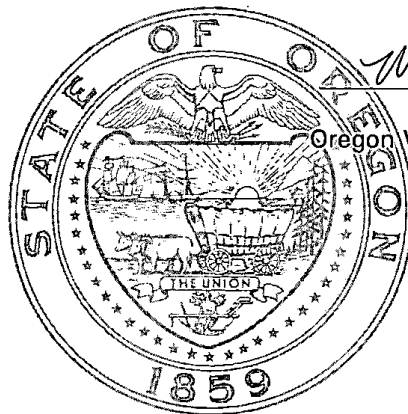

*Martha O. Pagel*  
 Martha O. Pagel  
 Oregon Water Resources Director

Recorded in State Record of Water Right Certificates numbered 73610.

52008RR2.BV