

STATE OF OREGON

COUNTY OF JEFFERSON

CERTIFICATE OF WATER RIGHT

THIS CERTIFICATE ISSUED TO

COLUMBIA EMPIRE FARMS, INC.  
(R-2 RANCH)  
31461 NE BELL ROAD  
SHERWOOD, OR 97140

**SUPERSEDED BY**  
**CERT. NO. 86850**

confirms the right to use the waters of TROUT CREEK, a tributary of the DESCHUTES RIVER, for IRRIGATION of 22.02 ACRES, DOMESTIC AND STOCK USE.

This right was confirmed by decree of the Circuit Court of the State of Oregon for JEFFERSON County. The decree is of record at Salem, in the Order Record of the WATER RESOURCES DIRECTOR, in Volume 5, at Page 57. The date of priority is 1880.

The amount of water to which this right is entitled is limited to an amount actually beneficially used and shall not exceed 1.5 ACRE FEET PER ACRE DURING ANY PERIOD OF 30 DAYS OR 6 ACRE FEET PER ACRE DURING ANY IRRIGATION SEASON (IF AVAILABLE AT THE ORIGINAL POINT OF DIVERSION AT THE EAST AND WEST BOLTER DITCH'S) or its equivalent in case of rotation, measured at the point of diversion from the source.

The points of diversion are located as follows:

JOHNSON GALLERY - SW 1/4 NW 1/4 SECTION 3 TOWNSHIP 9 SOUTH, RANGE 15 EAST, W.M.; 2622 FEET SOUTH AND 399 FEET EAST FROM THE NW CORNER OF SECTION 3; AND

CLARABELLE GALLERY - SE 1/4 NW 1/4 SECTION 9 TOWNSHIP 9 SOUTH, RANGE 15 EAST, W.M.; 1931 FEET SOUTH AND 1975 FEET EAST FROM THE NW CORNER OF SECTION 9.

A description of the place of use to which this right is appurtenant is as follows:

**LAND IRRIGATED FROM JOHNSON GALLERY**

NE 1/4 NE 1/4 \*\*\*\*\* 9.92 ACRES  
SE 1/4 NE 1/4 **1859** .80 ACRE  
NE 1/4 SE 1/4 5.90 ACRES

SECTION 4  
TOWNSHIP 9 SOUTH, RANGE 15 EAST, W.M.

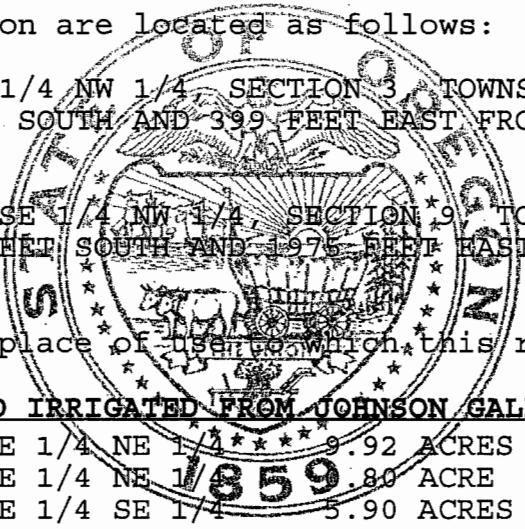

This is a final order in other than contested case. This order is subject to judicial review under ORS 183.484. Any petition for judicial review of the order must be filed within the 60 days of the date of service.

T-6851A.SB

Cancelled due to  
T-9153; Sp. Or.  
Vol. 60 p. 481

Superseded by  
Cert. No. **86672**

Certificate Number 79645

LAND IRRIGATED FROM CLARABELLE GALLERY

SE 1/4 SW 1/4            0.40 ACRE  
SW 1/4 SE 1/4            5.00 ACRES

SECTION 4

TOWNSHIP 9 SOUTH, RANGE 15 EAST, W.M.

This certificate is issued to confirm a change in POINT OF DIVERSION AND PLACE OF USE approved by an order of the Water Resources Director entered JANUARY 19, 1999, and together with Certificate 75966, supersedes Certificate 2227, State Record of Water Right Certificates.

The issuance of this superseding certificate does not confirm the status of the water right in regard to the provisions of ORS 540.610 pertaining to forfeiture or abandonment.

When required by the Department, the water user shall install and maintain headgates, in-line flow meters, weirs, or other suitable devices for measuring and recording the quantity of water diverted. The types and plans of the headgates and measuring devices must be approved by the Department prior to beginning construction and shall be installed under the general supervision of the Department.

The water user shall install and maintain fish screens or fish by-pass devices. The types and plans of the screens or by-pass devices must be approved by the Oregon Department of Fish and Wildlife prior to beginning of construction and shall be installed under the supervision of the Department of Fish and Wildlife.

The right to the use of the water for the above purpose is restricted to beneficial use on the lands or place of use described and is subject to all other conditions and limitations contained in said decree.

WITNESS the signature of the Water Resources Director, affixed September 25, 2002.

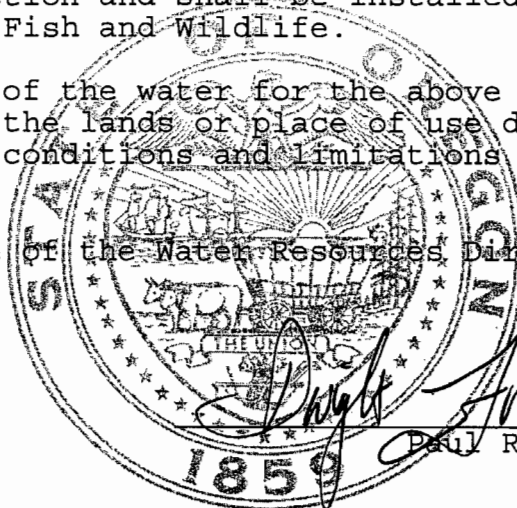

Paul R. Cleary

Recorded in State Record of Water Right Certificates Number 79645.

T-6851A.SB