

DC

STATE OF OREGON

COUNTY OF LINN

CERTIFICATE OF WATER RIGHT

THIS CERTIFICATE ISSUED TO

LAWRENCE WATER COMPANY
LAWRENCE SUBDIVISION WATER ASSOCIATION INC.
31754 LAWRENCE DRIVE
LEBANON, OREGON 97355

confirms the right to use the waters of WELLS NO.'S 1 AND 2 in the SOUTH SANTIAM RIVER BASIN for GROUP DOMESTIC USE.

This right was perfected under Permit G-5681. The date of priority is APRIL 27, 1973. This right is limited to 0.22 CUBIC FOOT PER SECOND or its equivalent in case of rotation, measured at the wells.

The wells are located as follows:

WELL NO. 1 - SW 1/4 NE 1/4, AS PROJECTED WITHIN DLC 86, SECTION 24, TOWNSHIP 12 SOUTH, RANGE 2 WEST, W.M.; 960 FEET NORTH AND 535 FEET EAST FROM THE CENTER 1/4 CORNER OF SECTION 24; AND

WELL NO. 2 - SW 1/4 NE 1/4, AS PROJECTED WITHIN DLC 86, SECTION 24, TOWNSHIP 12 SOUTH, RANGE 2 WEST, W.M.; 980 FEET NORTH AND 555 FEET EAST FROM THE CENTER 1/4 CORNER OF SECTION 24.

The use shall conform to such reasonable rotation system as may be ordered by the proper state officer.

A description of the place of use to which this right is appurtenant is as follows:

NE 1/4
AS PROJECTED WITHIN DLC 86
SECTION 24
TOWNSHIP 12 SOUTH, RANGE 2 WEST, W.M.

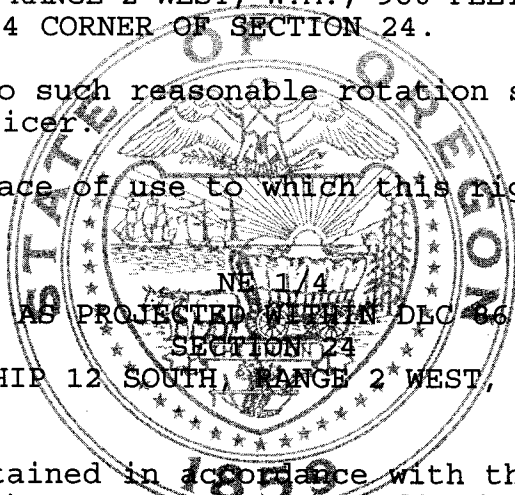

The well shall be maintained in accordance with the General Standards for the Construction and Maintenance of Water Wells in Oregon.

This is a final order in other than contested case. This order is subject to judicial review under ORS 183.484. Any petition for judicial review of the order must be filed within the 60 days of the date of service.

The right to use water for the above purpose is restricted to beneficial use on the lands or place of use described.

Issued April 25, 2003

Paul R. Cleary, Director
Water Resources Department

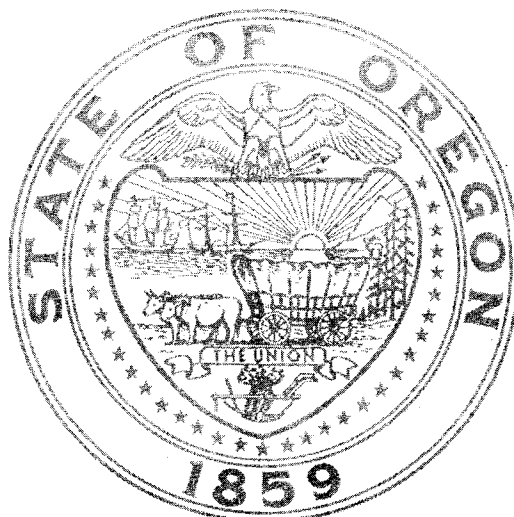

Recorded in State Record of Water Right Certificates Number 79998.

G-6094.SB