

This is a final order in other than a contested case. This order is subject to judicial review under ORS 183.484. Any petition for judicial review must be filed within the 60 day time period specified by ORS 183.484(2). Pursuant to ORS 536.075 and OAR 137-004-0080 you may either petition for judicial review or petition the Director for reconsideration of this order. A petition for reconsideration may be granted or denied by the Director, and if no action is taken within 60 days following the date the petition was filed, the petition shall be deemed denied.

STATE OF OREGON

COUNTY OF LAKE

CERTIFICATE OF WATER RIGHT

THIS CERTIFICATE ISSUED TO

SILVER LAKE IRRIGATION DISTRICT
c/o LAWRENCE IVERSON
SILVER LAKE, OREGON 97638

confirms the right to use the waters of EAST THOMPSON VALLEY RESERVOIR enlarged under Permit R-4461, a tributary of SILVER LAKE (DRY), for SUPPLEMENTAL IRRIGATION OF 2,551.1 ACRES.

This right was perfected under Permit 29955. The date of priority is AUGUST 24, 1964. The amount of water to which this right is entitled is limited to an amount actually beneficially used and shall not exceed 1950.54 ACRE-FEET OF STORED WATER ONLY, or its equivalent in case of rotation, measured at the point of diversion from the source.

The point of diversion is located as follows:

SE 1/4 SW 1/4, SECTION 17, T 30 S, R 14 E, W.M.; 600 FEET NORTH AND 1700 FEET EAST FROM THE SW CORNER, SECTION 17;

The amount of water used for irrigation, together with the amount secured under any other right existing for the same lands, is limited to a diversion of not to exceed 3.0 acre-feet per acre for each acre irrigated during the irrigation season of each year.

The use shall conform to such reasonable rotation system as may be ordered by the proper state officer.

S-40206(T-6871).LHN

CERTIFICATE NUMBER 81397

A description of the place of use to which this right is appurtenant is as follows:

PRIMARY AND SUPPLEMENTAL
BELL "A" LAND AND CATTLE COMPANY

IVERSON

SW $\frac{1}{4}$ NE $\frac{1}{4}$ 39.3 ACRES
SE $\frac{1}{4}$ NE $\frac{1}{4}$ 40.0 ACRES
NE $\frac{1}{4}$ SE $\frac{1}{4}$ 39.7 ACRES
NW $\frac{1}{4}$ SE $\frac{1}{4}$ 39.3 ACRES
SW $\frac{1}{4}$ SE $\frac{1}{4}$ 39.3 ACRES
SE $\frac{1}{4}$ SE $\frac{1}{4}$ 12.0 ACRES

SECTION 13

NE $\frac{1}{4}$ NE $\frac{1}{4}$ 12.7 ACRES
NW $\frac{1}{4}$ NE $\frac{1}{4}$ 36.7 ACRES
SE $\frac{1}{4}$ NE $\frac{1}{4}$ 0.5 ACRE

SECTION 24

TOWNSHIP 28 SOUTH,
RANGE 14 EAST, W.M.

NE $\frac{1}{4}$ NE $\frac{1}{4}$ 40.0 ACRES
NW $\frac{1}{4}$ NE $\frac{1}{4}$ 40.0 ACRES
SW $\frac{1}{4}$ NE $\frac{1}{4}$ 40.0 ACRES
SE $\frac{1}{4}$ NE $\frac{1}{4}$ 37.3 ACRES
NE $\frac{1}{4}$ NW $\frac{1}{4}$ 33.5 ACRES

LOT 1 (NW $\frac{1}{4}$ NW $\frac{1}{4}$) 7.4 ACRES
LOT 2 (SW $\frac{1}{4}$ NW $\frac{1}{4}$) 35.5 ACRES
SE $\frac{1}{4}$ NW $\frac{1}{4}$ 40.0 ACRES
NE $\frac{1}{4}$ SW $\frac{1}{4}$ 13.6 ACRES
LOT 3 (NW $\frac{1}{4}$ SW $\frac{1}{4}$) 20.4 ACRES
LOT 4 (SW $\frac{1}{4}$ SW $\frac{1}{4}$) 1.2 ACRES

SECTION 18

TOWNSHIP 28 SOUTH,
RANGE 15 EAST, W.M.

SE $\frac{1}{4}$ SW $\frac{1}{4}$ 20.2 ACRES
SE $\frac{1}{4}$ SE $\frac{1}{4}$ 12.0 ACRES
SECTION 12

SE $\frac{1}{4}$ NW $\frac{1}{4}$ 38.2 ACRES
NE $\frac{1}{4}$ SW $\frac{1}{4}$ 38.2 ACRES
NW $\frac{1}{4}$ SW $\frac{1}{4}$ 39.4 ACRES
SW $\frac{1}{4}$ SW $\frac{1}{4}$ 39.4 ACRES
SE $\frac{1}{4}$ SW $\frac{1}{4}$ 38.7 ACRES

SECTION 13

NE $\frac{1}{4}$ NW $\frac{1}{4}$ 28.6 ACRES
NW $\frac{1}{4}$ NW $\frac{1}{4}$ 40.0 ACRES

SECTION 24

TOWNSHIP 28 SOUTH,
RANGE 14 EAST, W.M.

O'LEARY

NE $\frac{1}{4}$ SW $\frac{1}{4}$ 38.5 ACRES
NW $\frac{1}{4}$ SW $\frac{1}{4}$ 38.5 ACRES
SW $\frac{1}{4}$ SW $\frac{1}{4}$ 36.7 ACRES
SE $\frac{1}{4}$ SW $\frac{1}{4}$ 38.5 ACRES
NE $\frac{1}{4}$ SE $\frac{1}{4}$ 38.5 ACRES
NW $\frac{1}{4}$ SE $\frac{1}{4}$ 38.5 ACRES
SW $\frac{1}{4}$ SE $\frac{1}{4}$ 38.5 ACRES
SE $\frac{1}{4}$ SE $\frac{1}{4}$ 38.5 ACRES

SECTION 14

TOWNSHIP 28 SOUTH,
RANGE 14 EAST, W.M.

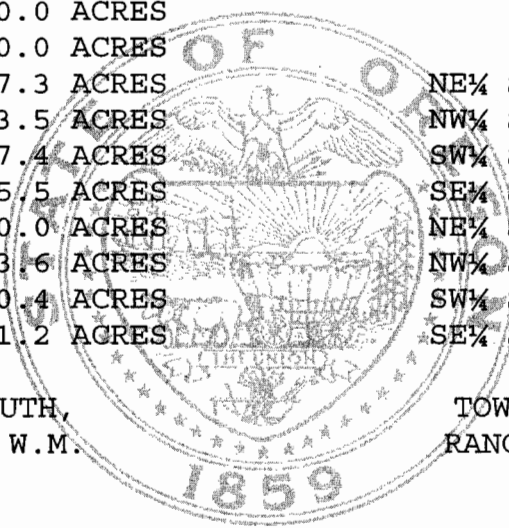

ZX RANCH

NE $\frac{1}{4}$ SW $\frac{1}{4}$	31.4 ACRES
NW $\frac{1}{4}$ SW $\frac{1}{4}$	31.5 ACRES
SW $\frac{1}{4}$ SW $\frac{1}{4}$	31.1 ACRES
SE $\frac{1}{4}$ SW $\frac{1}{4}$	30.8 ACRES
NE $\frac{1}{4}$ SE $\frac{1}{4}$	31.2 ACRES
NW $\frac{1}{4}$ SE $\frac{1}{4}$	31.3 ACRES
SW $\frac{1}{4}$ SE $\frac{1}{4}$	30.6 ACRES
SE $\frac{1}{4}$ SE $\frac{1}{4}$	30.6 ACRES

SECTION 23

SW $\frac{1}{4}$ SW $\frac{1}{4}$	38.9 ACRES
SE $\frac{1}{4}$ SW $\frac{1}{4}$	38.9 ACRES

SECTION 24

NE $\frac{1}{4}$ NW $\frac{1}{4}$	38.7 ACRES
NW $\frac{1}{4}$ NW $\frac{1}{4}$	37.5 ACRES
SW $\frac{1}{4}$ NW $\frac{1}{4}$	38.2 ACRES
SE $\frac{1}{4}$ NW $\frac{1}{4}$	38.2 ACRES
NE $\frac{1}{4}$ SW $\frac{1}{4}$	39.0 ACRES
NW $\frac{1}{4}$ SW $\frac{1}{4}$	39.0 ACRES
SW $\frac{1}{4}$ SW $\frac{1}{4}$	30.7 ACRES
SE $\frac{1}{4}$ SW $\frac{1}{4}$	37.0 ACRES

SECTION 25

NE $\frac{1}{4}$ NE $\frac{1}{4}$	37.5 ACRES
NW $\frac{1}{4}$ NE $\frac{1}{4}$	37.5 ACRES
SW $\frac{1}{4}$ NE $\frac{1}{4}$	29.3 ACRES
SE $\frac{1}{4}$ NE $\frac{1}{4}$	38.2 ACRES
NE $\frac{1}{4}$ NW $\frac{1}{4}$	37.5 ACRES
NW $\frac{1}{4}$ NW $\frac{1}{4}$	37.2 ACRES
SW $\frac{1}{4}$ NW $\frac{1}{4}$	29.9 ACRES
SE $\frac{1}{4}$ NW $\frac{1}{4}$	29.8 ACRES
NE $\frac{1}{4}$ SW $\frac{1}{4}$	30.5 ACRES
NW $\frac{1}{4}$ SW $\frac{1}{4}$	30.5 ACRES
NE $\frac{1}{4}$ SE $\frac{1}{4}$	33.5 ACRES
NW $\frac{1}{4}$ SE $\frac{1}{4}$	31.0 ACRES

SECTION 26

NE $\frac{1}{4}$ NE $\frac{1}{4}$	28.2 ACRES
NW $\frac{1}{4}$ NE $\frac{1}{4}$	29.1 ACRES
SW $\frac{1}{4}$ NE $\frac{1}{4}$	39.4 ACRES
SE $\frac{1}{4}$ NE $\frac{1}{4}$	38.8 ACRES
NE $\frac{1}{4}$ SE $\frac{1}{4}$	14.0 ACRES
NW $\frac{1}{4}$ SE $\frac{1}{4}$	13.3 ACRES

SECTION 27

TOWNSHIP 28 SOUTH,
RANGE 14 EAST, W.M.

THIS CERTIFICATE IS ISSUED TO CORRECTLY DESCRIBE THE LOCATION OF THE PLACE OF USE FOR IRRIGATION FOR THE ZX RANCH AND SUPERSEDES CERTIFICATE 76362.

The issuance of this superseding certificate does not confirm the status of the water right in regard to the provisions of ORS 540.610 pertaining to forfeiture or abandonment.

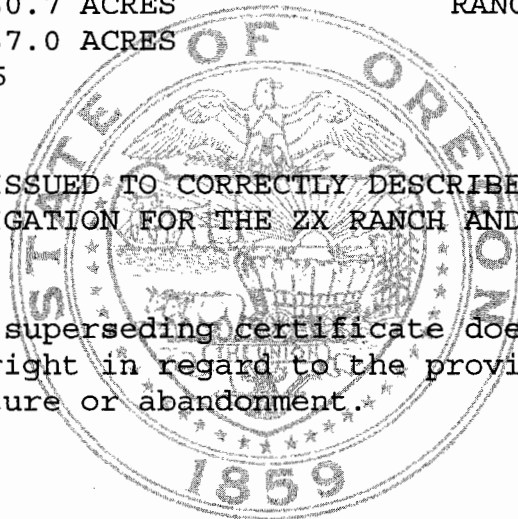

The right to the use of the water for the above purpose is restricted to beneficial use on the lands or place of use described. The use confirmed herein may be made only at times when sufficient water is available to satisfy all prior rights, including rights for maintaining instream flows.

Issued JUNE 30, 2005.

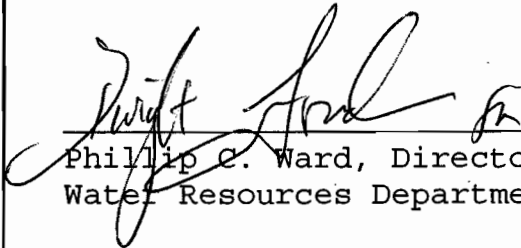
Phillip C. Ward, Director
Water Resources Department



Recorded in State Record of Water Right Certificates Number 81397

S-40206(T-6871).LHN