

STATE OF OREGON

COUNTY OF CROOK

CERTIFICATE OF WATER RIGHT

THIS CERTIFICATE ISSUED TO

LES SCHWAB TIRE CENTERS OF OREGON
P.O. BOX 667
PRINEVILLE, OREGON 97754

BIG SUMMIT PRAIRIES, INC.
P.O. BOX 663
PRINEVILLE, OREGON 97754

confirms the right to use the waters of ALLEN CREEK RESERVOIR
CONSTRUCTED UNDER PERMIT R-2000, a tributary of NORTH FORK CROOKED
RIVER, for IRRIGATION OF 4580.0 ACRES.

This right was perfected under Permit 24775. The date of priority is
MAY 10, 1956. The amount of water to which this right is entitled is
limited to an amount actually beneficially used and shall not exceed
1460.7 ACRE FEET STORED WATER ONLY, or its equivalent in case of
rotation, measured at the point of diversion from the source.

The points of diversion are located as follows:

ALLEN CREEK RESERVOIR - SE 1/4 SE 1/4, SECTION 2, TOWNSHIP 14 SOUTH,
RANGE 21 EAST, W.M.; 970 FEET NORTH AND 480 FEET WEST FROM THE SE
CORNER OF SECTION 2;

ALLEN CREEK RE-DIVERSION - NE 1/4 NE 1/4, SECTION 11, TOWNSHIP 14
SOUTH, RANGE 21 EAST, W.M.; 1120 FEET SOUTH AND 210 FEET WEST FROM THE
NE CORNER OF SECTION 11;

GILL RE-DIVERSION - SE 1/4 SECTION 11, TOWNSHIP 14 SOUTH,
RANGE 21 EAST, W.M.; 1280 FEET NORTH AND 1200 FEET WEST FROM THE SE
CORNER OF SECTION 11; AND

This is a final order in this appropriation case. This order is subject
to judicial review under ORS 183.484. Any petition for judicial review must
be filed within the 60 day time period specified by ORS 183.484(2).
Pursuant to ORS 536.075 and OAR 137-004-0080 you may either petition for
judicial review or petition the Director for reconsideration of this order.
A petition for reconsideration may be granted or denied by the Director,
and if no action is taken within 60 days following the date the petition
was filed, the petition shall be deemed denied.

In addition, under ORS 537.260 any person with an application, permit or
water right certificate subsequent in priority may jointly or severally
contest the issuance of the certificate at any time before it has issued,
and after the time has expired for the completion of the appropriation
under the permit, or within three months after issuance of the certificate.

MERRITT DITCH RE-DIVERSION - SE 1/4 NW 1/4, SECTION 14, TOWNSHIP 14 SOUTH, RANGE 21 EAST, W.M.; 1840 FEET SOUTH AND 2950 FEET WEST FROM THE NE CORNER OF SECTION 14.

The amount of water used for irrigation, together with the amount secured under any other right existing for the same lands, is limited to a diversion of not to exceed 4.0 acre-feet per acre for each acre irrigated during the irrigation season of each year from direct flow and storage.

The use shall conform to such reasonable rotation system as may be ordered by the proper state officer.

A description of the place of use to which this right is appurtenant is as follows:

Allen Creek Reservoir - supplemental to Allen Creek

SW 1/4 NW 1/4	0.9 ACRE
NE 1/4 SW 1/4	1.9 ACRES
NW 1/4 SW 1/4	13.8 ACRES
SW 1/4 SW 1/4	33.8 ACRES
SE 1/4 SW 1/4	9.6 ACRES
SW 1/4 SE 1/4	12.6 ACRES
SE 1/4 SE 1/4	11.7 ACRES

SECTION 2

NE 1/4 NE 1/4	0.0 ACRE
NW 1/4 NE 1/4	0.1 ACRE
SW 1/4 NE 1/4	11.8 ACRES
SE 1/4 NE 1/4	7.6 ACRES
NE 1/4 NW 1/4	1.2 ACRES
NE 1/4 SW 1/4	4.1 ACRES
SE 1/4 SW 1/4	2.8 ACRES
NW 1/4 SE 1/4	9.9 ACRES
NW 1/4 SE 1/4	9.9 ACRES
SW 1/4 SE 1/4	2.5 ACRES
SE 1/4 SE 1/4	5.5 ACRES

SECTION 3

NE 1/4 NE 1/4	29.6 ACRES
NW 1/4 NE 1/4	8.8 ACRES
SW 1/4 NE 1/4	40.6 ACRES
SE 1/4 NE 1/4	37.0 ACRES
NE 1/4 NW 1/4	2.1 ACRES
NW 1/4 NW 1/4	0.8 ACRE
SW 1/4 NW 1/4	21.1 ACRES
SE 1/4 NW 1/4	30.0 ACRES

SECTION 10

TOWNSHIP 14 SOUTH, RANGE 21 EAST, W.M.

NE 1/4 SW 1/4 41.0 ACRES
 NW 1/4 SW 1/4 41.0 ACRES
 SW 1/4 SW 1/4 40.4 ACRES
 SE 1/4 SW 1/4 40.4 ACRES
 NE 1/4 SE 1/4 41.0 ACRES
 NW 1/4 SE 1/4 41.0 ACRES
 SW 1/4 SE 1/4 40.4 ACRES
 SE 1/4 SE 1/4 40.4 ACRES

SECTION 10
 TOWNSHIP 14 SOUTH, RANGE 21 EAST, W.M.

NE 1/4 NE 1/4 12.4 ACRES
 NW 1/4 NE 1/4 22.6 ACRES
 SW 1/4 NE 1/4 40.6 ACRES
 SE 1/4 NE 1/4 37.7 ACRES
 NE 1/4 NW 1/4 14.9 ACRES
 NW 1/4 NW 1/4 30.3 ACRES
 SW 1/4 NW 1/4 31.0 ACRES
 SE 1/4 NW 1/4 38.5 ACRES
 NE 1/4 SW 1/4 41.0 ACRES
 NW 1/4 SW 1/4 41.0 ACRES
 SW 1/4 SW 1/4 40.4 ACRES
 SE 1/4 SW 1/4 40.4 ACRES
 NE 1/4 SE 1/4 40.3 ACRES
 NW 1/4 SE 1/4 41.0 ACRES
 SW 1/4 SE 1/4 40.3 ACRES
 SE 1/4 SE 1/4 40.8 ACRES

SECTION 11

SW 1/4 NW 1/4 1.9 ACRES
 NW 1/4 SW 1/4 6.6 ACRES
 SW 1/4 SW 1/4 38.9 ACRES
 SE 1/4 SW 1/4 29.2 ACRES
 SW 1/4 SE 1/4 10.4 ACRES
 NE 1/4 NW 1/4 1.4 ACRES
 NW 1/4 NW 1/4 11.8 ACRES
 SW 1/4 NW 1/4 11.5 ACRES

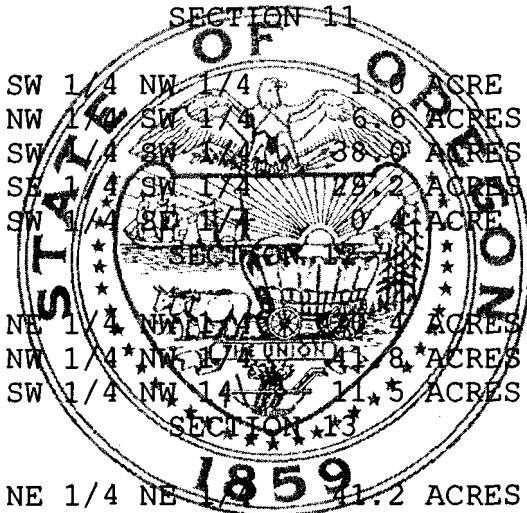

NE 1/4 NE 1/4 41.2 ACRES
 NW 1/4 NE 1/4 40.0 ACRES
 SW 1/4 NE 1/4 40.2 ACRES
 SE 1/4 NE 1/4 39.6 ACRES
 NE 1/4 NW 1/4 40.5 ACRES
 NW 1/4 NW 1/4 40.0 ACRES
 SW 1/4 NW 1/4 40.0 ACRES
 SE 1/4 NW 1/4 39.8 ACRES

SECTION 14
 TOWNSHIP 14 SOUTH, RANGE 21 EAST, W.M.

NE 1/4 SW 1/4 40.0 ACRES
 NW 1/4 SW 1/4 40.0 ACRES
 SW 1/4 SW 1/4 40.0 ACRES
 SE 1/4 SW 1/4 40.0 ACRES
 NE 1/4 SE 1/4 13.2 ACRES
 NW 1/4 SE 1/4 40.0 ACRES
 SW 1/4 SE 1/4 40.0 ACRES

SECTION 14

NE 1/4 NE 1/4 40.0 ACRES
 NW 1/4 NE 1/4 40.0 ACRES
 SW 1/4 NE 1/4 40.6 ACRES
 SE 1/4 NE 1/4 39.3 ACRES
 NE 1/4 NW 1/4 40.0 ACRES
 NW 1/4 NW 1/4 40.0 ACRES
 SW 1/4 NW 1/4 40.6 ACRES
 SE 1/4 NW 1/4 40.6 ACRES
 NE 1/4 SW 1/4 40.2 ACRES
 NW 1/4 SW 1/4 40.2 ACRES
 SW 1/4 SW 1/4 32.8 ACRES
 SE 1/4 SW 1/4 32.1 ACRES
 NE 1/4 SE 1/4 40.0 ACRES
 NW 1/4 SE 1/4 40.2 ACRES
 SW 1/4 SE 1/4 39.6 ACRES
 SE 1/4 SE 1/4 40.4 ACRES

SECTION 15

NE 1/4 NE 1/4 41.8 ACRES
 NW 1/4 NE 1/4 29.6 ACRES
 SW 1/4 NE 1/4 7.4 ACRES
 SE 1/4 NE 1/4 36.4 ACRES
 NE 1/4 SE 1/4 13.6 ACRES

SECTION 22

NW 1/4 NE 1/4 33.8 ACRES
 SW 1/4 NE 1/4 38.0 ACRES
 SE 1/4 NE 1/4 27.5 ACRES
 NE 1/4 NW 1/4 41.0 ACRES
 NW 1/4 NW 1/4 41.2 ACRES
 SW 1/4 NW 1/4 40.4 ACRES
 SE 1/4 NW 1/4 40.4 ACRES
 NE 1/4 SW 1/4 41.0 ACRES
 NW 1/4 SW 1/4 34.4 ACRES
 SW 1/4 SW 1/4 2.4 ACRES
 SE 1/4 SW 1/4 37.4 ACRES
 NE 1/4 SE 1/4 32.8 ACRES
 NW 1/4 SE 1/4 39.2 ACRES
 SW 1/4 SE 1/4 38.3 ACRES
 SE 1/4 SE 1/4 40.2 ACRES

SECTION 23

TOWNSHIP 14 SOUTH, RANGE 21 EAST, W.M.

SE 1/4 NW 1/4 5.4 ACRES
 NE 1/4 SW 1/4 38.0 ACRES
 NW 1/4 SW 1/4 16.4 ACRES
 SW 1/4 SW 1/4 40.0 ACRES
 SE 1/4 SW 1/4 4.8 ACRES
 NW 1/4 SE 1/4 10.8 ACRES

SECTION 24

NE 1/4 NW 1/4 0.1 ACRE
 NW 1/4 NW 1/4 4.0 ACRES

SECTION 25

NE 1/4 NE 1/4 17.8 ACRES
 NW 1/4 NE 1/4 23.4 ACRES
 NE 1/4 NW 1/4 5.0 ACRES
 NW 1/4 NW 1/4 0.2 ACRE

SECTION 26

TOWNSHIP 14 SOUTH, RANGE 21 EAST, W.M.

Allen Creek Reservoir -supplemental to E FK ELLIOT CR & ELLIOT CR

NE 1/4 NW 1/4 12.8 ACRES
 NW 1/4 NW 1/4 24.4 ACRES
 SW 1/4 NW 1/4 36.6 ACRES
 SE 1/4 NW 1/4 10.0 ACRES
 NE 1/4 SW 1/4 0.8 ACRES
 NW 1/4 SW 1/4 30.8 ACRES
 SW 1/4 SW 1/4 14.8 ACRES

SECTION 3

SE 1/4 NE 1/4 2.2 ACRES
 SE 1/4 SW 1/4 30.2 ACRES
 NE 1/4 SE 1/4 24.8 ACRES
 SW 1/4 SE 1/4 30.8 ACRES
 SE 1/4 SE 1/4 40.8 ACRES

NE 1/4 NE 1/4 69.4 ACRES
 NW 1/4 NE 1/4 40.0 ACRES
 SW 1/4 NE 1/4 43.4 ACRES
 SE 1/4 NE 1/4 43.7 ACRES
 NE 1/4 NW 1/4 40.8 ACRES
 SE 1/4 NW 1/4 43.0 ACRES
 NE 1/4 SW 1/4 42.0 ACRES
 SE 1/4 SW 1/4 33.8 ACRES
 NE 1/4 SE 1/4 41.6 ACRES
 NW 1/4 SE 1/4 41.6 ACRES
 SW 1/4 SE 1/4 40.8 ACRES
 SE 1/4 SE 1/4 40.8 ACRES

SECTION 9

TOWNSHIP 14 SOUTH, RANGE 21 EAST, W.M.

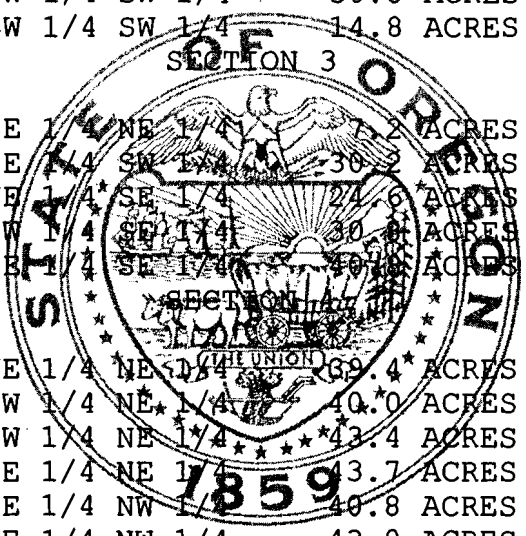

NW 1/4 NW 1/4 18.0 ACRES
 SW 1/4 NW 1/4 4.8 ACRES
 SECTION 10

NE 1/4 NE 1/4 40.4 ACRES
 NW 1/4 NE 1/4 40.4 ACRES
 SW 1/4 NE 1/4 30.8 ACRES
 SE 1/4 NE 1/4 40.4 ACRES
 NE 1/4 NW 1/4 20.4 ACRES
 SE 1/4 NW 1/4 0.1 ACRE
 NE 1/4 SE 1/4 40.6 ACRES
 NW 1/4 SE 1/4 26.2 ACRES
 SW 1/4 SE 1/4 7.0 ACRES
 SE 1/4 SE 1/4 25.5 ACRES

SECTION 16

TOWNSHIP 14 SOUTH, RANGE 21 EAST, W.M.

Allen Creek Reservoir -supplemental to FOX CR

SW 1/4 SW 1/4 20.8 ACRES
 SECTION 4

NE 1/4 SE 1/4 12.0 ACRES
 NW 1/4 SE 1/4 26.2 ACRES
 SW 1/4 SE 1/4 22.6 ACRES
 SE 1/4 SE 1/4 27.4 ACRES

SECTION 5

NE 1/4 NE 1/4 0.8 ACRE

SECTION 8

NW 1/4 NW 1/4 38.0 ACRES
 SW 1/4 NW 1/4 21.0 ACRES
 NW 1/4 SW 1/4 14.8 ACRES
 SW 1/4 SW 1/4 0.8 ACRE

TOWNSHIP 14 SOUTH, RANGE 21 EAST, W.M.



The right to the use of the water for the above purpose is restricted to beneficial use on the lands or place of use described. The use confirmed herein may be made only at times when sufficient water is available to satisfy all prior rights, including rights for maintaining instream flows.

Issued July 14, 2005.

Phillip C. Ward
 Phillip C. Ward, Director
 Water Resources Department

Recorded in State Record of Water Right Certificates Number 81420.