

This is a final order in other than a contested case. This order is subject to judicial review under ORS 183.484. Any petition for judicial review must be filed within the 60 day time period specified by ORS 183.484(2). Pursuant to ORS 536.075 and OAR 137-004-0080 you may either petition for judicial review or petition the Director for reconsideration of this order. A petition for reconsideration may be granted or denied by the Director, and if no action is taken within 60 days following the date the petition was filed, the petition shall be deemed denied.

STATE OF OREGON

COUNTY OF UNION

CERTIFICATE OF WATER RIGHT

THIS CERTIFICATE ISSUED TO

S. HAWKINS, INC.
57390 HAWKINS ROAD
LA GRANDE, OR 97850

ALLEN AND CHARLENE CHAPMAN
4476 S TIMBER TRAIL DRIVE
WOODBURN, OR 97901

JOHN HABBERSTAD, JAMES HABBERSTAD, AND CHARLES ROGERS
12314 E BROADWAY
SPOKANE, WA 99216

confirms the right to use the waters of THIRTEEN WELLS in the GRANDE RONDE RIVER BASIN for IRRIGATION OF 247.8 ACRES AND SUPPLEMENTAL IRRIGATION OF 1631.6 ACRES.

This right was perfected under Permit G-7339. The date of priority is JUNE 24, 1974. The amount of water to which this right is entitled is limited to an amount actually beneficially used and shall not exceed 23.04 CUBIC FEET PER SECOND (CFS); BEING 18.13 CFS FROM WELLS NO.'S 1 THROUGH 8 AND 4.91 CFS FROM WELLS NO.'S 11 THROUGH 15, or its equivalent in case of rotation, measured at the point of diversion from the source.

The wells are located as follows:

WELL NO. 1 - SW 1/4 SW 1/4, SECTION 25, TOWNSHIP 3 SOUTH, RANGE 39 EAST, WM, 1220 FEET NORTH AND 50 FEET EAST FROM THE SW CORNER, SECTION 25;

WELL NO. 2 - NW 1/4 NW 1/4, SECTION 36, TOWNSHIP 3 SOUTH, RANGE 39 EAST, WM, 210 FEET SOUTH AND 50 FEET EAST FROM THE SW CORNER, SECTION 25;

G-6578.LHN

CERTIFICATE NUMBER 81434

WELL NO. 3 - SW 1/4 NW 1/4, SECTION 36, TOWNSHIP 3 SOUTH,
RANGE 39 EAST, WM, 1680 FEET SOUTH AND 60 FEET EAST FROM THE SW
CORNER, SECTION 25;

WELL NO. 4 - NW 1/4 SW 1/4, SECTION 36, TOWNSHIP 3 SOUTH,
RANGE 39 EAST, WM, 2600 FEET SOUTH AND 70 FEET EAST FROM THE SW
CORNER, SECTION 25;

WELL NO. 5 - SW 1/4 SW 1/4, SECTION 36, TOWNSHIP 3 SOUTH,
RANGE 39 EAST, WM, 5100 FEET SOUTH AND 70 FEET EAST FROM THE SW
CORNER, SECTION 25;

WELL NO. 6 - NW 1/4 NW 1/4, SECTION 1, TOWNSHIP 4 SOUTH,
RANGE 39 EAST, WM, 1350 FEET NORTH AND 330 FEET EAST FROM THE W 1/4
CORNER, SECTION 1;

WELL NO. 7 - NW 1/4 SW 1/4, SECTION 1, TOWNSHIP 4 SOUTH,
RANGE 39 EAST, WM, 70 FEET SOUTH AND 70 FEET EAST FROM THE W 1/4
CORNER, SECTION 1;

WELL NO. 8 - NW 1/4 SW 1/4, SECTION 1, TOWNSHIP 4 SOUTH,
RANGE 39 EAST, WM, 1080 FEET SOUTH AND 80 FEET EAST FROM W 1/4
CORNER SECTION 1;

WELL NO. 11 - NW 1/4 SE 1/4, SECTION 27, TOWNSHIP 3
SOUTH, RANGE 39 EAST, WM, 2010 FEET NORTH AND 40 FEET EAST FROM THE
S 1/4 CORNER, SECTION 27;

WELL NO. 12 - SW 1/4 SE 1/4, SECTION 27, TOWNSHIP 3
SOUTH, RANGE 39 EAST, WM, 650 FEET NORTH AND 50 FEET EAST FROM THE
S 1/4, SECTION 27;

WELL NO. 13 - NW 1/4 NE 1/4, SECTION 34, TOWNSHIP 3
SOUTH, RANGE 39 EAST, WM, 710 FEET SOUTH AND 50 FEET EAST FROM THE
S 1/4, SECTION 27;

WELL NO. 14 - NW 1/4 SE 1/4, SECTION 34, TOWNSHIP 3
SOUTH, RANGE 39 EAST, WM, 2710 FEET SOUTH AND 60 FEET EAST FROM THE
S 1/4, SECTION 27; AND

WELL NO. 15 - NW 1/4 SE 1/4, SECTION 34, TOWNSHIP 3
SOUTH, RANGE 39 EAST, WM, 3910 FEET SOUTH AND 70 FEET EAST FROM THE
S 1/4, SECTION 27.

The amount of water used for irrigation, together with the amount secured under any other right existing for the same lands, is limited to ONE-EIGHTIETH of one cubic foot per second per acre, or its equivalent for each acre irrigated and shall be further limited to a diversion of not to exceed 3.0 acre-feet per acre for each acre irrigated during the irrigation season of each year. This right is limited to any deficiency in the available supply of any prior right existing for the same land.

The use shall conform to such reasonable rotation system as may be ordered by the proper state officer.

A description of the place of use to which this right is appurtenant is as follows:

**HABBERSTAD AND ROGERS
PRIMARY IRRIGATION WELLS NO.'S 1 THROUGH 8**

SW 1/4 NW 1/4	0.6 ACRE
SE 1/4 NW 1/4	0.6 ACRE
NE 1/4 SW 1/4	34.4 ACRES
NW 1/4 SW 1/4	34.7 ACRES
SW 1/4 SW 1/4	27.2 ACRES
SE 1/4 SW 1/4	26.7 ACRES

SECTION 25
TOWNSHIP 3 SOUTH, RANGE 39 EAST, W.M.

NE 1/4 NW 1/4	34.1 ACRES
NW 1/4 NW 1/4	33.2 ACRES
SW 1/4 NW 1/4	28.3 ACRES
SE 1/4 NW 1/4	28.0 ACRES

SECTION 36
TOWNSHIP 3 SOUTH, RANGE 39 EAST, W.M.

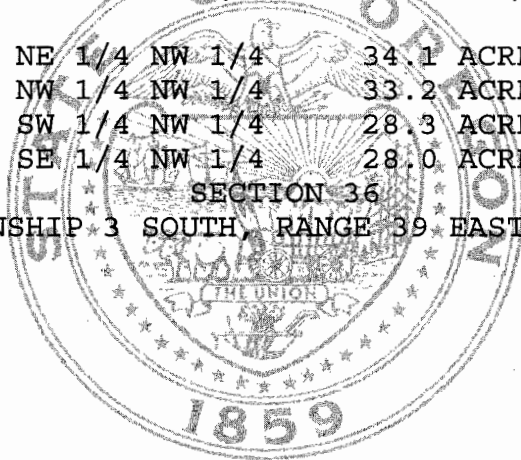

HABBERSTAD AND ROGERS
SUPPLEMENTAL IRRIGATION WELLS NO.'S 1 THROUGH 8

SW 1/4 NE 1/4	38.0 ACRES
SE 1/4 NE 1/4	37.2 ACRES
SW 1/4 NW 1/4	1.2 ACRES
SE 1/4 NW 1/4	1.4 ACRES
NE 1/4 SW 1/4	38.4 ACRES
NW 1/4 SW 1/4	38.2 ACRES
SW 1/4 SW 1/4	38.2 ACRES
SE 1/4 SW 1/4	37.8 ACRES
NE 1/4 SE 1/4	34.7 ACRES
NW 1/4 SE 1/4	34.1 ACRES
SW 1/4 SE 1/4	31.0 ACRES
SE 1/4 SE 1/4	31.0 ACRES

SECTION 26

NE 1/4 NE 1/4	32.7 ACRES
NW 1/4 NE 1/4	33.0 ACRES
SW 1/4 NE 1/4	32.3 ACRES
SE 1/4 NE 1/4	32.0 ACRES
NE 1/4 NW 1/4	33.2 ACRES
NW 1/4 NW 1/4	32.8 ACRES
SW 1/4 NW 1/4	31.7 ACRES
SE 1/4 NW 1/4	32.6 ACRES

SECTION 35

NE 1/4 SW 1/4	33.3 ACRES
NW 1/4 SW 1/4	33.3 ACRES
SW 1/4 SW 1/4	28.9 ACRES
SE 1/4 SW 1/4	28.9 ACRES

SECTION 36

TOWNSHIP 3 SOUTH, RANGE 39 EAST, W.M.

NW 1/4 NE 1/4	31.3 ACRES
SW 1/4 NE 1/4	31.3 ACRES
NE 1/4 NW 1/4	31.3 ACRES
NW 1/4 NW 1/4	29.9 ACRES
SW 1/4 NW 1/4	37.0 ACRES
SE 1/4 NW 1/4	31.3 ACRES

SECTION 1

TOWNSHIP 4 SOUTH, RANGE 39 EAST, W.M.

HABBERSTAD AND ROGERS (CONTINUED)

NE 1/4 NW 1/4	38.4 ACRES
NW 1/4 NW 1/4	40.0 ACRES
SW 1/4 NW 1/4	40.0 ACRES
SE 1/4 NW 1/4	39.4 ACRES

SECTION 2

TOWNSHIP 4 SOUTH, RANGE 39 EAST, W.M.

CHAPMAN**SUPPLEMENTAL IRRIGATION WELLS NO.'S 1 THROUGH 8**

NW 1/4 SW 1/4	39.3 ACRES
SW 1/4 SW 1/4	37.6 ACRES

SECTION 2

SW 1/4 SE 1/4	26.5 ACRES
SE 1/4 SE 1/4	39.9 ACRES

SECTION 3

TOWNSHIP 4 SOUTH, RANGE 39 EAST, W.M.

S. HAWKINS, INC.**SUPPLEMENTAL IRRIGATION WELLS NO.'S 11 THROUGH 15**

NE 1/4 SE 1/4	40.0 ACRES
NW 1/4 SE 1/4	40.0 ACRES
SW 1/4 SE 1/4	40.0 ACRES
SE 1/4 SE 1/4	40.0 ACRES

SECTION 27

TOWNSHIP 3 SOUTH, RANGE 39 EAST, W.M.

NW 1/4 NE 1/4	39.4 ACRES
SE 1/4 NW 1/4	27.2 ACRES
NE 1/4 SW 1/4	7.8 ACRES
SE 1/4 SW 1/4	0.1 ACRES
NE 1/4 SE 1/4	40.0 ACRES
NW 1/4 SE 1/4	39.2 ACRES
SW 1/4 SE 1/4	38.8 ACRES
SE 1/4 SE 1/4	40.0 ACRES

SECTION 34

TOWNSHIP 3 SOUTH, RANGE 39 EAST, W.M.

The wells shall be maintained in accordance with the General Standards for the Construction and Maintenance of Water Wells in Oregon.

THIS CERTIFICATE IS ISSUED TO CORRECTLY DESCRIBE THE TOTAL OF NUMBER OF SUPPLEMENTAL ACRES ALLOWED AND SUPERSEDES CERTIFICATE 80389.

The issuance of this superseding certificate does not confirm the status of the water right in regard to the provisions of ORS 540.610 pertaining to forfeiture or abandonment.

The right to use water for the above purpose is restricted to beneficial use on the lands or place of use described.

Issued JULY 14, 2005.



Phillip C. Ward, Director
Water Resources Department



Recorded in State Record of Water Right Certificates Number 81434.

G-6578.LHN