

STATE OF OREGON

COUNTY OF UMATILLA

CERTIFICATE OF WATER RIGHT

THIS CERTIFICATE ISSUED TO

CHESTER PRIOR, EAGLE RANCH
32327 OREGON TRAIL ROAD
ECHO, OREGON 97826

confirms part of the right to use the waters of the UMATILLA RIVER a tributary of the COLUMBIA RIVER, for PRIMARY IRRIGATION OF 72.6 ACRES AND SUPPLEMENTAL IRRIGATION OF 2863.8 ACRES.

This right was perfected under Permit 48450. The date of priority is AUGUST 3, 1981. This right is limited to 73.41 CUBIC FEET PER SECOND or its equivalent in case of rotation, measured at the point of diversion from the source. The use allowed herein may be made anytime between November 15 and June 15 of each year that water can be put to beneficial use by irrigation, either for immediate crop growth or for forecast requirements to raise the soil moisture to field capacity in the soil profile to be utilized by plant growth in the subsequent growing season.

The point of diversion is located as follows:

WESTLAND CANAL - SW 1/4 NE 1/4 OF SECTION 21, TOWNSHIP 3 NORTH, RANGE 29 EAST, W.M.; NORTH 76 DEGREES 45 MINUTES 56 SECONDS EAST 2913.19 FEET FROM THE WEST 1/4 CORNER, SECTION 21.

This is a final order in ~~an~~ ~~un~~ ~~contested~~ ~~case~~. This order is subject to judicial review under ORS 183.484. Any petition for judicial review must be filed within the 60 day time period specified by ORS 183.484(2). Pursuant to ORS 536.075 and OAR 1100.0100, you may either petition for judicial review or petition the Director for reconsideration of this order. A petition for reconsideration may be granted or denied by the Director, and if no action is taken within 60 days following the date the petition was filed, the petition shall be deemed denied.

In addition, under ORS 537.260 any person with an application, permit or water right certificate subsequent in priority may jointly or severally contest the issuance of the certificate at any time before it has issued, and after the time has expired for the completion of the appropriation under the permit, or within three months after issuance of the certificate.

The amount of water used for irrigation together with the amount secured under any other right existing for the same lands, is limited to a diversion of ONE-FORTIETH of one cubic foot per second (or its equivalent), and 1.5 acre-feet for each acre irrigated during the period from November 15 to the last day of February of each year, provided further that the right allowed herein, together with the amount secured under any other right existing for the same lands shall not exceed 4.5 acre-feet for each acre irrigated in any one year, provided further, that the part declared herein be for supplemental irrigation, the right allowed may, in the interest of conserving the ground water supplies, be exercised at times when water is available in the ground water supply provided the total quantity diverted from all sources of supply does not exceed the limitation allowed herein. The use of water during the period from November 15 to the last day of February of each year shall not establish priority of right as against future appropriations for beneficial uses or storage for such beneficial uses, other than similar rights for irrigation from November 15 to the last day of February.

The use shall conform to such reasonable rotation system as may be ordered by the proper state officer.

A description of the place of use to which this right is appurtenant is as follows:

PRIMARY

SE 1/4 NW 1/4 40.0 ACRES
 NE 1/4 SW 1/4 2.3 ACRES

SECTION 1
 TOWNSHIP 2 NORTH, RANGE 28 EAST, W. M.

SW 1/4 NE 1/4 5.3 ACRES
 SE 1/4 NW 1/4 5.3 ACRES
 NE 1/4 SW 1/4 5.4 ACRES
 SE 1/4 SW 1/4 9.1 ACRES
 NW 1/4 SE 1/4 8.2 ACRES

SECTION 3
 TOWNSHIP 3 NORTH, RANGE 28 EAST, W. M.

NE 1/4 NW 1/4 32.2 ACRES
 NW 1/4 NW 1/4 31.6 ACRES
 SW 1/4 NW 1/4 29.6 ACRES
 NE 1/4 SW 1/4 37.1 ACRES
 NW 1/4 SW 1/4 31.0 ACRES
 SW 1/4 SW 1/4 28.8 ACRES
 SE 1/4 SW 1/4 31.2 ACRES

SECTION 1

NE 1/4 NE 1/4 8.2 ACRES
 NW 1/4 NE 1/4 36.7 ACRES
 SW 1/4 NE 1/4 38.2 ACRES
 SE 1/4 NE 1/4 29.2 ACRES

SECTION 2

TOWNSHIP 2 NORTH, RANGE 28 EAST, W.M.



NE 1/4 NW 1/4	33.3 ACRES
NW 1/4 NW 1/4	32.2 ACRES
SW 1/4 NW 1/4	27.8 ACRES
SE 1/4 NW 1/4	30.0 ACRES
NE 1/4 SE 1/4	19.1 ACRES
NW 1/4 SE 1/4	30.0 ACRES
SW 1/4 SE 1/4	35.2 ACRES
SE 1/4 SE 1/4	22.8 ACRES

SECTION 2
TOWNSHIP 2 NORTH, RANGE 28 EAST, W.M.

NE 1/4 NE 1/4	31.8 ACRES
NW 1/4 NE 1/4	31.4 ACRES
SW 1/4 NE 1/4	33.9 ACRES
SE 1/4 NE 1/4	32.8 ACRES
NE 1/4 SE 1/4	31.9 ACRES
NW 1/4 SE 1/4	31.3 ACRES
SW 1/4 SE 1/4	32.7 ACRES
SE 1/4 SE 1/4	32.2 ACRES

SECTION 20

NE 1/4 NE 1/4	30.0 ACRES
NW 1/4 NE 1/4	30.4 ACRES
SW 1/4 NE 1/4	38.4 ACRES
SE 1/4 NE 1/4	32.4 ACRES
NE 1/4 NW 1/4	32.0 ACRES
NW 1/4 NW 1/4	30.4 ACRES
SW 1/4 NW 1/4	34.0 ACRES
SE 1/4 NW 1/4	38.4 ACRES
NE 1/4 SW 1/4	36.5 ACRES
NW 1/4 SW 1/4	29.6 ACRES
SW 1/4 SW 1/4	32.8 ACRES
SE 1/4 SW 1/4	31.6 ACRES
NE 1/4 SE 1/4	30.4 ACRES
NW 1/4 SE 1/4	35.2 ACRES
SW 1/4 SE 1/4	32.4 ACRES
SE 1/4 SE 1/4	32.8 ACRES

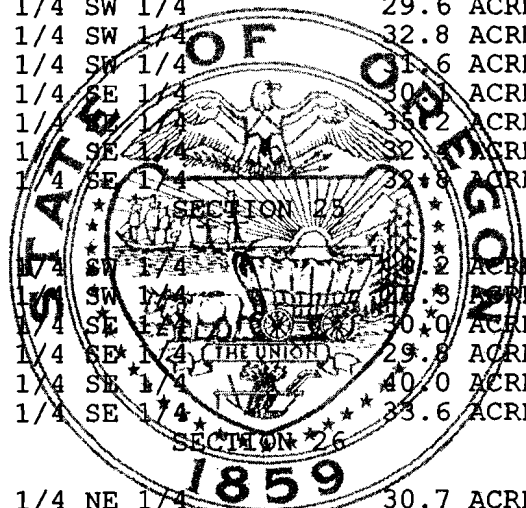

SW 1/4 SW 1/4	30.2 ACRES
SE 1/4 SW 1/4	30.3 ACRES
NE 1/4 SE 1/4	30.0 ACRES
NW 1/4 SE 1/4	29.8 ACRES
SW 1/4 SE 1/4	40.0 ACRES
SE 1/4 SE 1/4	33.6 ACRES

NE 1/4 NE 1/4	30.7 ACRES
NW 1/4 NE 1/4	29.9 ACRES
SW 1/4 NE 1/4	29.6 ACRES
SE 1/4 NE 1/4	30.0 ACRES
NE 1/4 NW 1/4	28.7 ACRES
NW 1/4 NW 1/4	33.1 ACRES
SW 1/4 NW 1/4	33.1 ACRES
SE 1/4 NW 1/4	28.5 ACRES

SECTION 29
TOWNSHIP 3 NORTH, RANGE 28 EAST, W. M.

NE 1/4 NE 1/4 0.2 ACRES
 SE 1/4 NE 1/4 0.3 ACRES

SECTION 30

NE 1/4 NE 1/4 30.5 ACRES
 NW 1/4 NE 1/4 40.0 ACRES
 SW 1/4 NE 1/4 36.4 ACRES
 SE 1/4 NE 1/4 34.4 ACRES
 NE 1/4 NW 1/4 32.6 ACRES
 NW 1/4 NW 1/4 31.2 ACRES
 SW 1/4 NW 1/4 32.8 ACRES
 SE 1/4 NW 1/4 38.1 ACRES
 NE 1/4 SW 1/4 36.3 ACRES
 NW 1/4 SW 1/4 33.2 ACRES
 SW 1/4 SW 1/4 31.8 ACRES
 SE 1/4 SW 1/4 28.1 ACRES
 NE 1/4 SE 1/4 29.0 ACRES
 NW 1/4 SE 1/4 37.6 ACRES
 SW 1/4 SE 1/4 39.8 ACRES
 SE 1/4 SE 1/4 30.2 ACRES

SECTION 35

NE 1/4 NE 1/4 31.8 ACRES
 NW 1/4 NE 1/4 40.0 ACRES
 SW 1/4 NE 1/4 31.8 ACRES
 SE 1/4 NE 1/4 31.5 ACRES
 NE 1/4 NW 1/4 40.0 ACRES
 NW 1/4 NW 1/4 31.1 ACRES
 SW 1/4 NW 1/4 31.6 ACRES
 SE 1/4 NW 1/4 31.5 ACRES
 NE 1/4 SW 1/4 31.1 ACRES
 NW 1/4 SW 1/4 30.1 ACRES
 SW 1/4 SW 1/4 31.5 ACRES
 SE 1/4 SW 1/4 31.2 ACRES
 NE 1/4 SE 1/4 31.7 ACRES
 NW 1/4 SE 1/4 31.7 ACRES
 SW 1/4 SE 1/4 32.0 ACRES
 SE 1/4 SE 1/4 31.2 ACRES

TOWNSHIP 3 NORTH, RANGE 28 EAST W. M.

The right to the use of the water for the above purpose is restricted to beneficial use on the lands or place of use described.

Issued July 14, 2005.

Phillip C. Ward
 Phillip C. Ward, Director
 Water Resources Department



Recorded in State Record of Water Right Certificates Number 81529.