

SECTION

28

9812

TOWNSHIP 15, RANGE 11E, W. M.

North

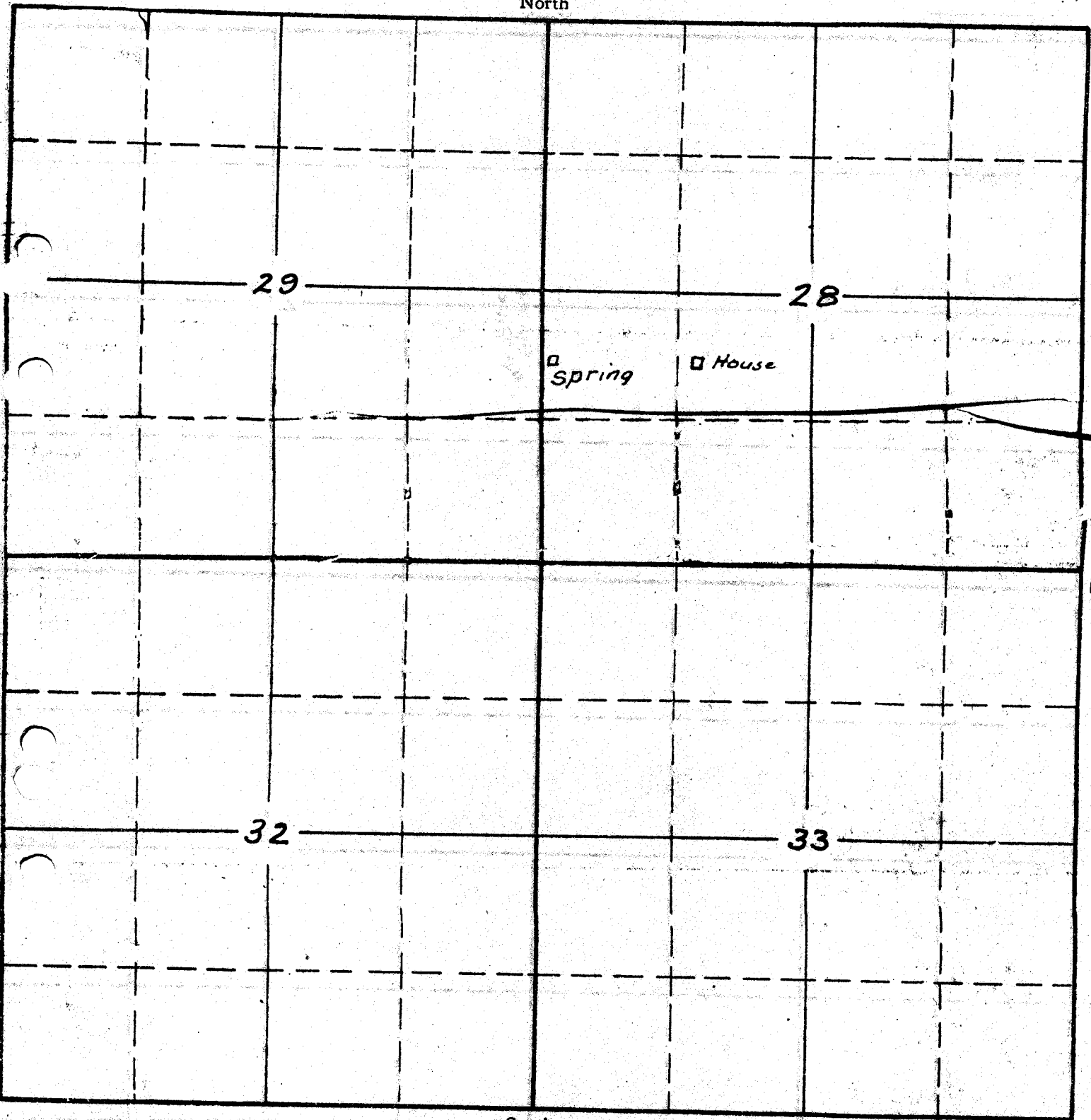

29

28

Spring

House

32

33

South

STATE ENGINEER  
RECEIVED

JUN 15 1935

SALEM, OREGON

APPLICATION No. 13669

PERMIT No. 9812

9812

SECTION

TOWNSHIP 15, RANGE 16, W. M.

North

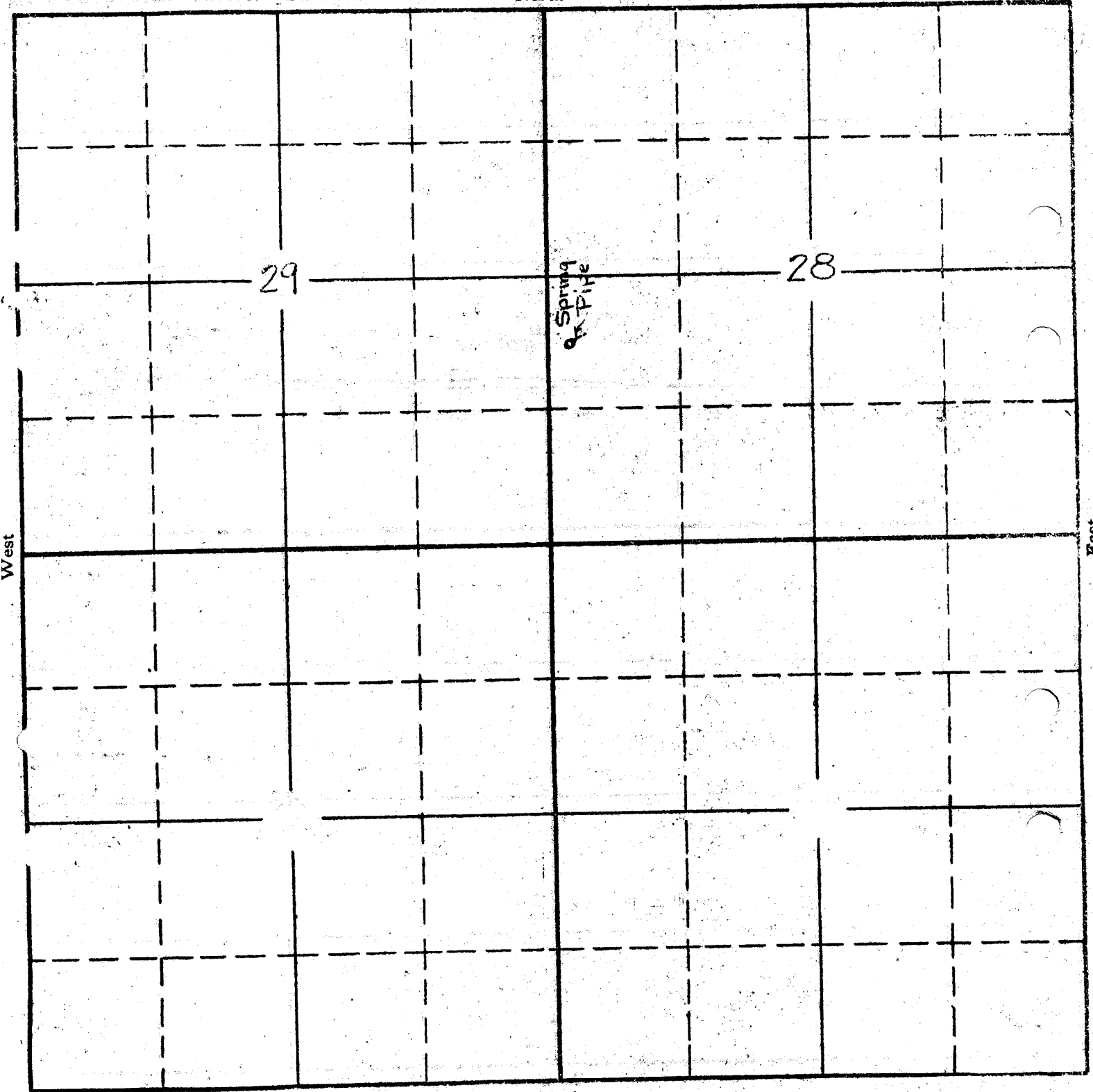

South

APPLICATION No. 13669  
PERMIT No. 9812