

297  
# 1025

Plat of R. B. Wilcox's Land, capable of irrigation  
situated in section 18, Tp. 1 S. R. 25 E.W.M.

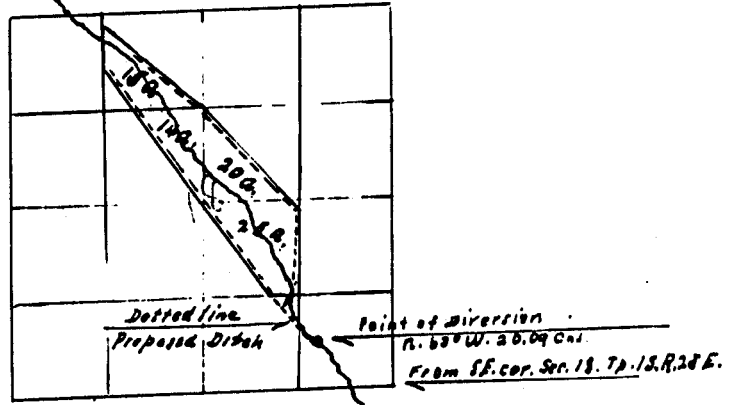

I, D. V. S. Reid, County Surveyor of Morrow County, Oregon  
do hereby certify that this map was made from notes taken during an  
actual survey made by me on March, 26, 1910, and that it correctly  
represents the works described in the accompanying application,  
together with the location of streams and other ditches in the  
immediate vicinity, and has written thereon the area in each  
smallest legal subdivision which it is proposed to irrigate.

*D. V. S. Reid,*

Surveyor.

Application No. 631,  
Permit No. 297.

RECEIVED  
JUN 12 1987  
BY