

HPD

Tp. 34 S. R. 6 E. W. M.

Application No. 694
Permit No. 311

726

Sec. 14

T. A. Swan.

40 a. . 40 a.
to be irrigated. to be irrigated.

Cor. Secs.
15 14.
22 28.

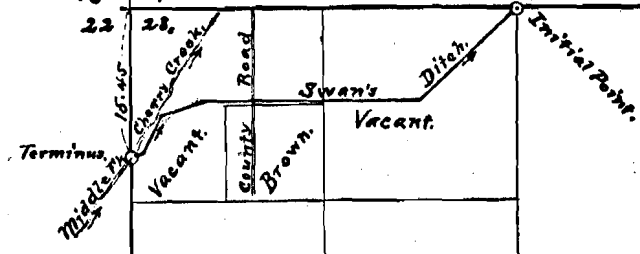

Sec. 23

Plat of Survey
for
T. A. Swan's Ditch.

Scale- 20 chs = 1 inch.

Geo. T. Cline
County Surveyor.

Surveyed April 21st 1910.

Cherry Creek

I, Geo. T. Cline, of Klamath Falls, Oregon, do hereby certify that this map was made from notes taken during an actual survey made by me on April 21st, 1910, and that it correctly represents the works described in the accompanying application, together with the location of streams and other ditches in the immediate vicinity, and has written thereon the area in each smallest local subdivision which it is proposed to irrigate.