

9039

Map of

SURVEY IN E. 1/4 SECT. 6 TWP. 2. S RANGE 10 EAST W. M.  
To accompany application for permit to appropriate water for domestic use  
FOR Jennie L. McMullen DATE April 27, 1929

31, 32

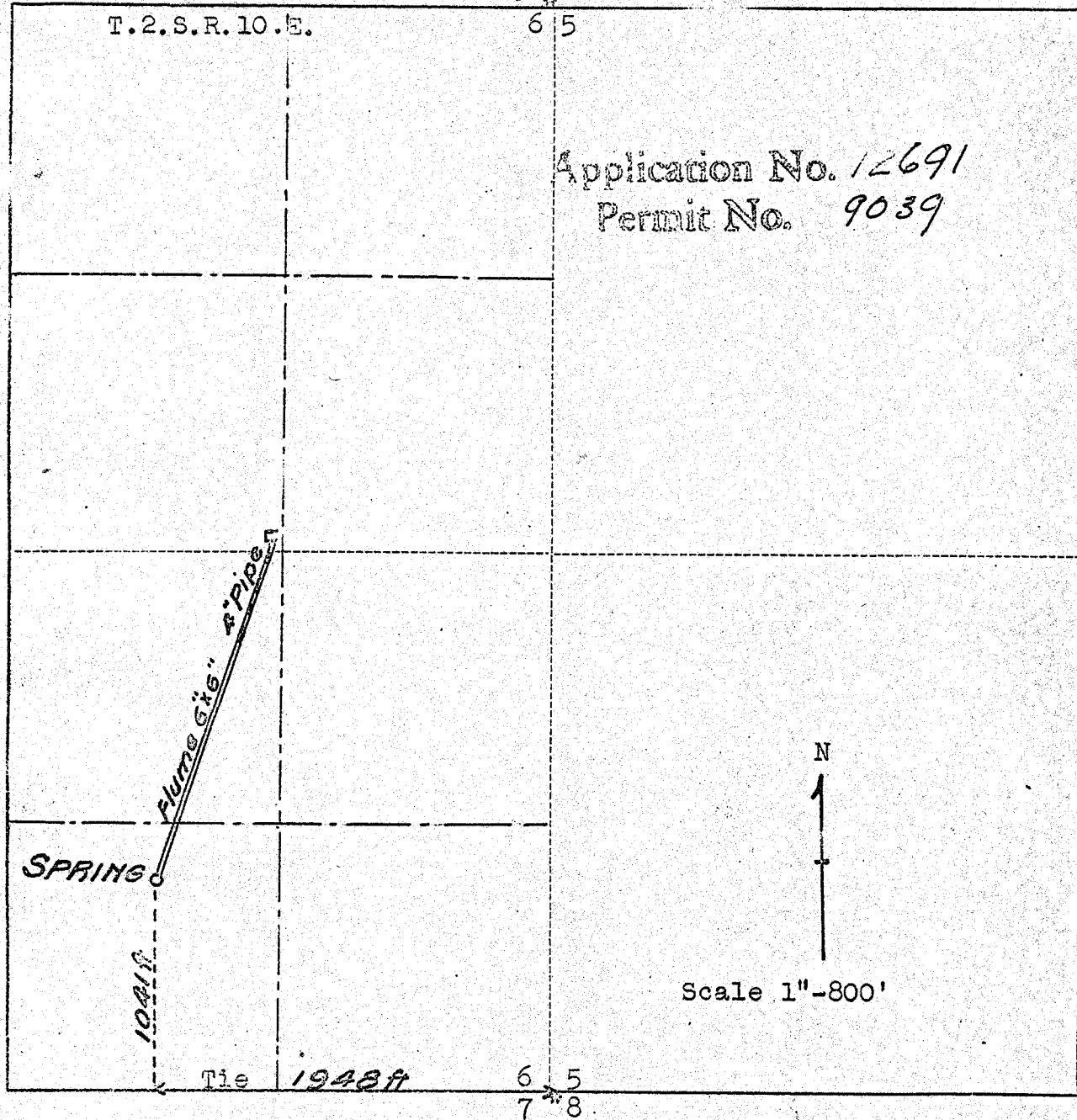

Application No. 12691  
Permit No. 9039

N



Scale 1"=800'

I do hereby certify that this sketch was made from notes taken during an actual survey made by me  
on April 27 1929, and that it correctly represents field work of said survey.

*C. M. Ballant*

County Surveyor  
Hood River County, Oregon

Helpers E. A. Brown