

# MAP OF PROPOSED TROUT CREEK DITCH

UNION AND BAKER COUNTY  
OREGON.

SCALE 2 IN. = 1 MI.

JULY, 6, 1930.  
ROSCOE NEAL, COUNTY SURVEYOR  
UNION COUNTY, OREGON.

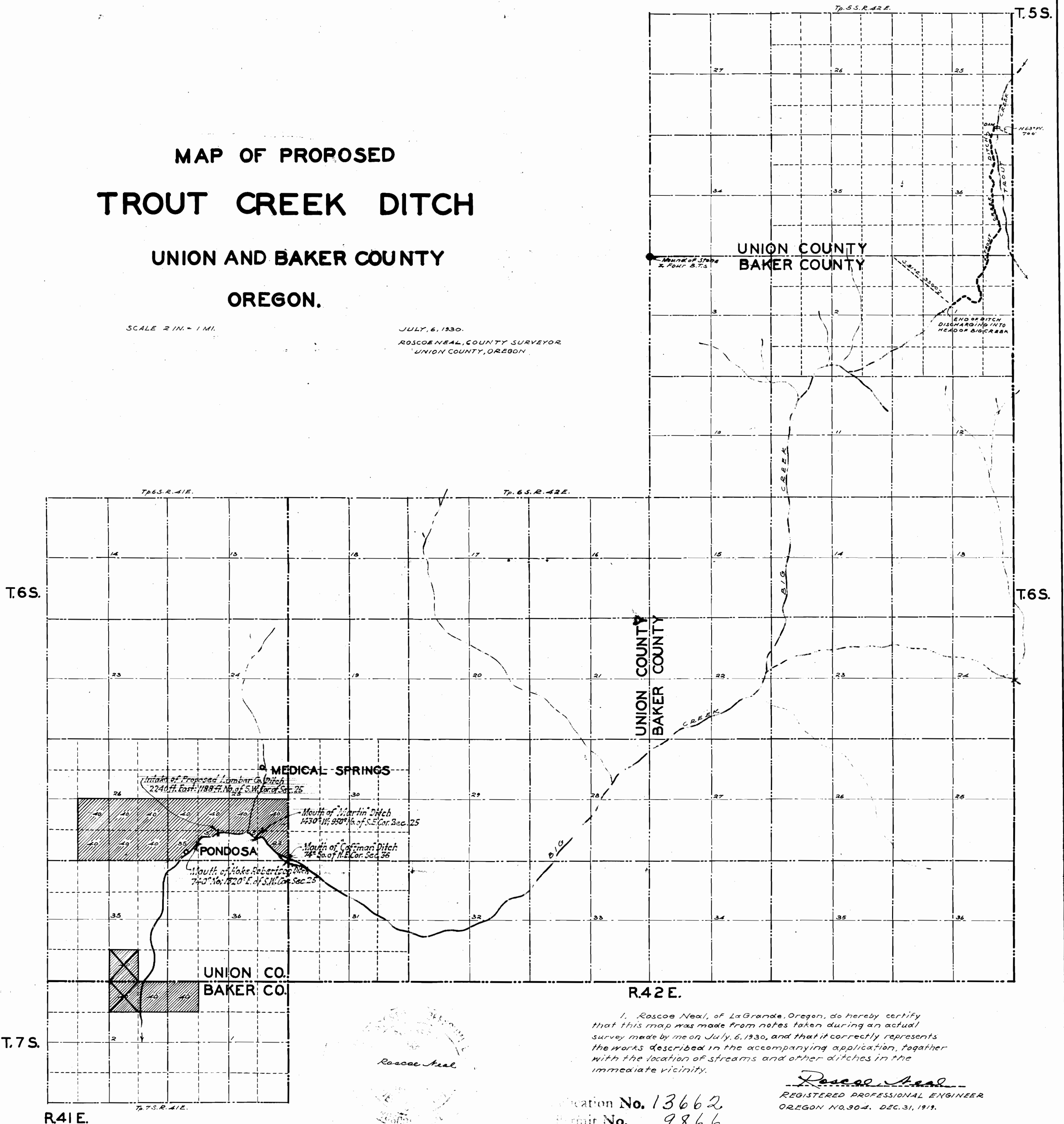

I, Roscoe Neal, of LaGrande, Oregon, do hereby certify that this map was made from notes taken during an actual survey made by me on July 6, 1930, and that it correctly represents the works described in the accompanying application, together with the location of streams and other ditches in the immediate vicinity.

*Roscoe Neal*

Application No. 13662  
Permit No. 9866

*Roscoe Neal*  
REGISTERED PROFESSIONAL ENGINEER  
OREGON NO. 904. DEC. 31, 1919.