

NOTE

Spring is located
in the S.W. 1/4 of the
SE 1/4 of Sec.

22. T3S. 11E. W.M.
at a point that is
70' North and

1730 FT. WEST
of the S.E. Corner
of Sec. 32.

RECORDER'S OFFICE
CITY OF CANBY
CANBY, OREGON

RECEIVED
FEB 10 1964

App. No. 15264
Rec. No. 11917

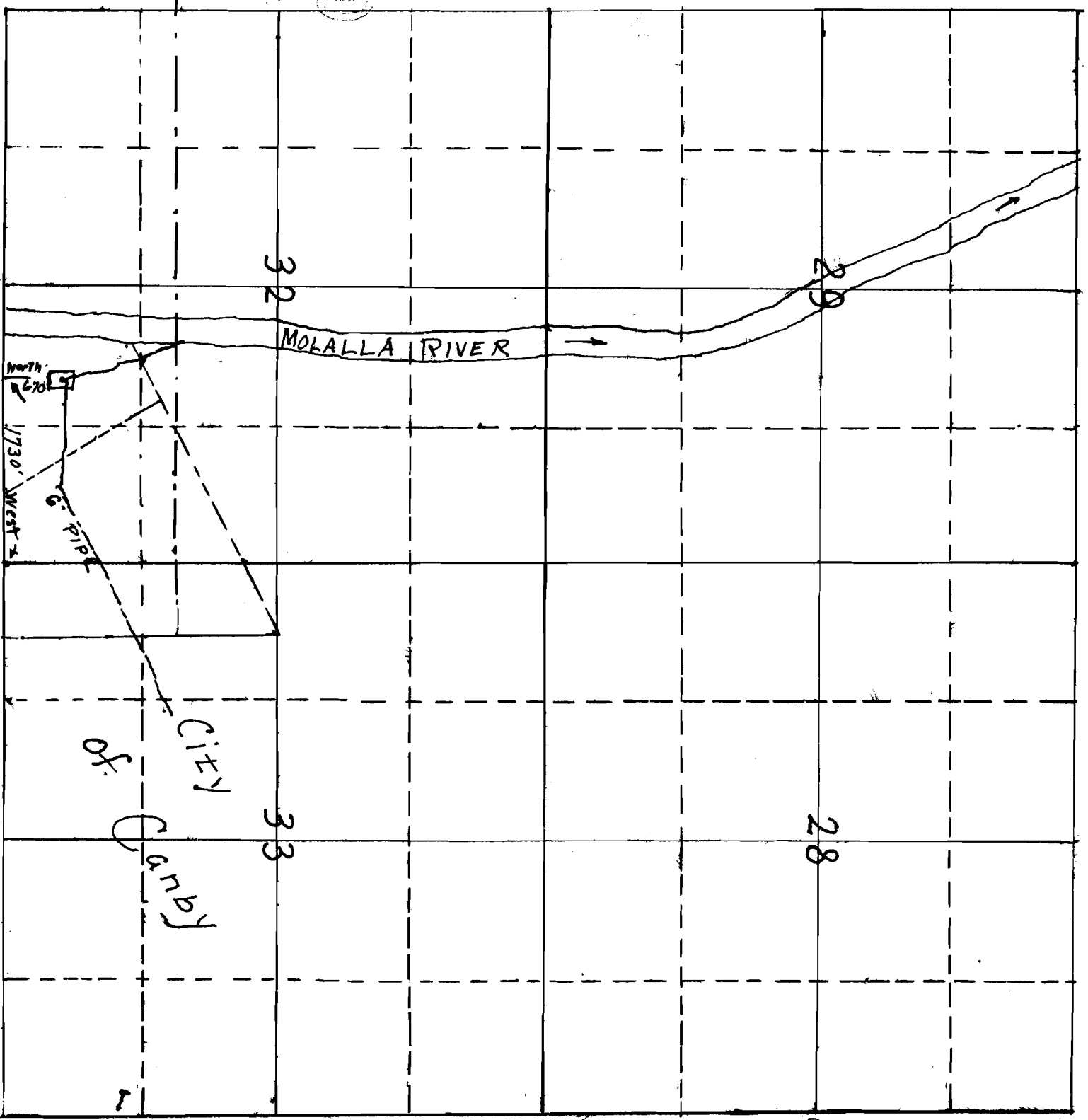

Sec. 32
SW 1/4 of
T3S
R11E