

SURVEY IN. N.W. 1/4, N.W. 1/4 SECT. 7 TWP. 2 N RANGE 8 EAST W. M.

FOR J.H. & LUCIA MARTINSEN
N.W. COR. SEC. 7.

DATE 3/17/30

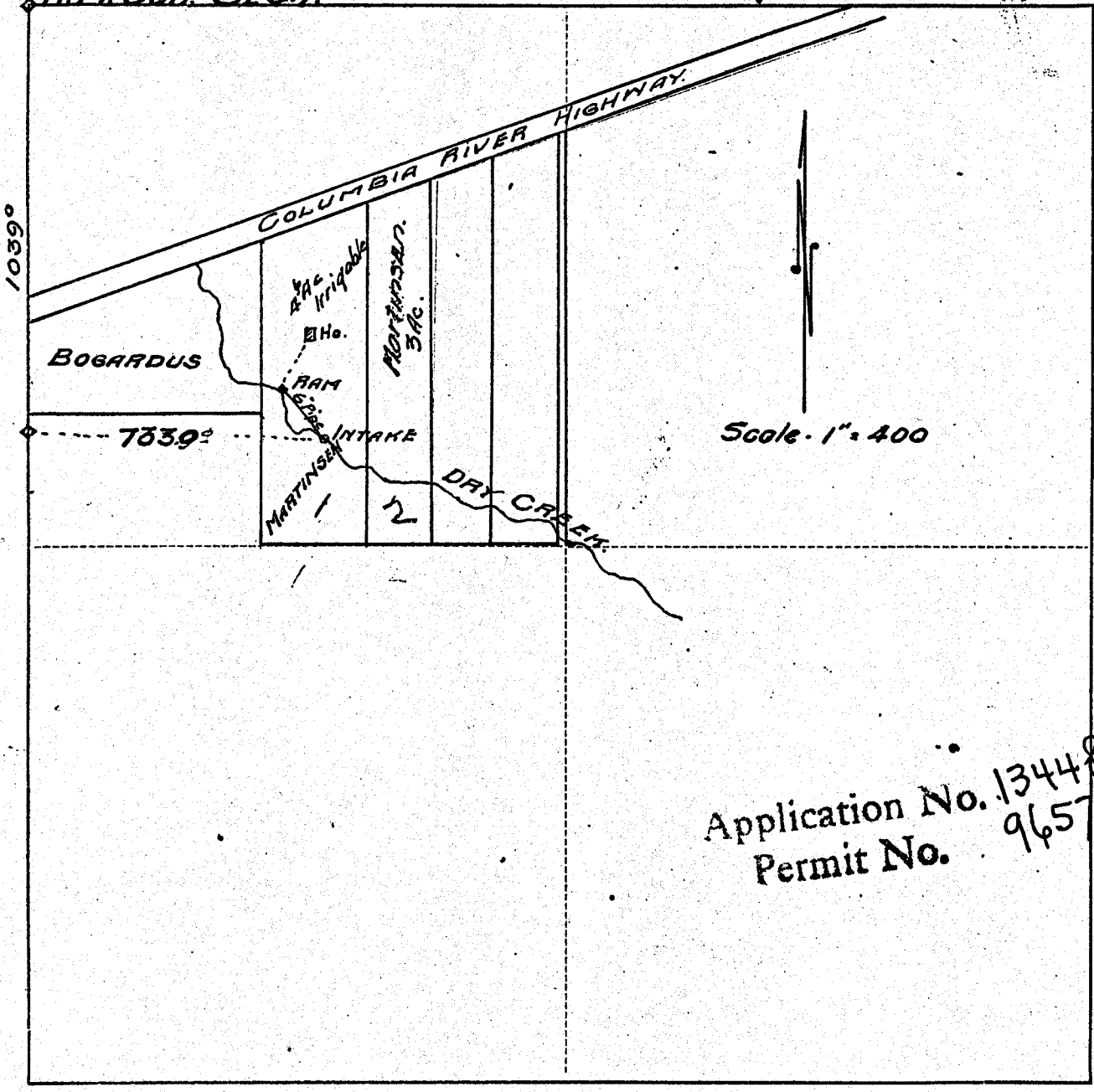

I do hereby certify that this sketch was made from notes taken during an actual survey made by me on March 17 1930, and that it correctly represents field work of said survey.

G.M. Hurlbert.
County Surveyor
Hood River County, Oregon

Helpers J.H. MARTINSEN