

STATE ENGINEER
RECEIVED

AUG 5 1933

SALEM, OREGON

MAP

To Accompany Application of Charles
E. Johnson for a permit to appropriate
Water in Section 1 of Twp 24 S. R. 13 W.
W. M., Coos County ORE.

I, D.L. Buckingham, of
MARSHFIELD, OREGON, do hereby
certify that this map was made
from notes taken during an actual
survey made by me Aug. 2 1933,
and that it correctly represents
the works described in the accom-
panying application, together
with the location of the
streams in the immediate vicinity.

D.L. Buckingham one inch = 1/2 mile.

D.L. Buckingham
ENGINEER
OREGON
DEC. 3, 1919
D.L. BUCKINGHAM

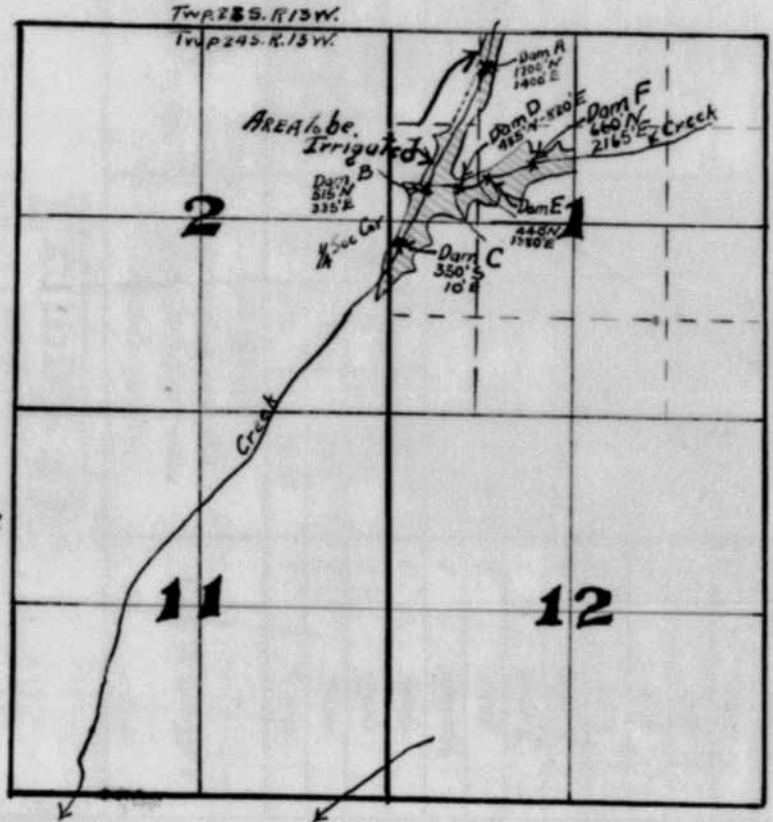
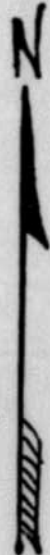

App. No. 15070
Per. No. 11007