

RECEIVED  
OCT 17 1933

STATE ENGINEER  
RECEIVED

JUN 8 1933

STATE ENGINEER  
SALEM, OREGON

SALEM, OREGON

MOLALLA

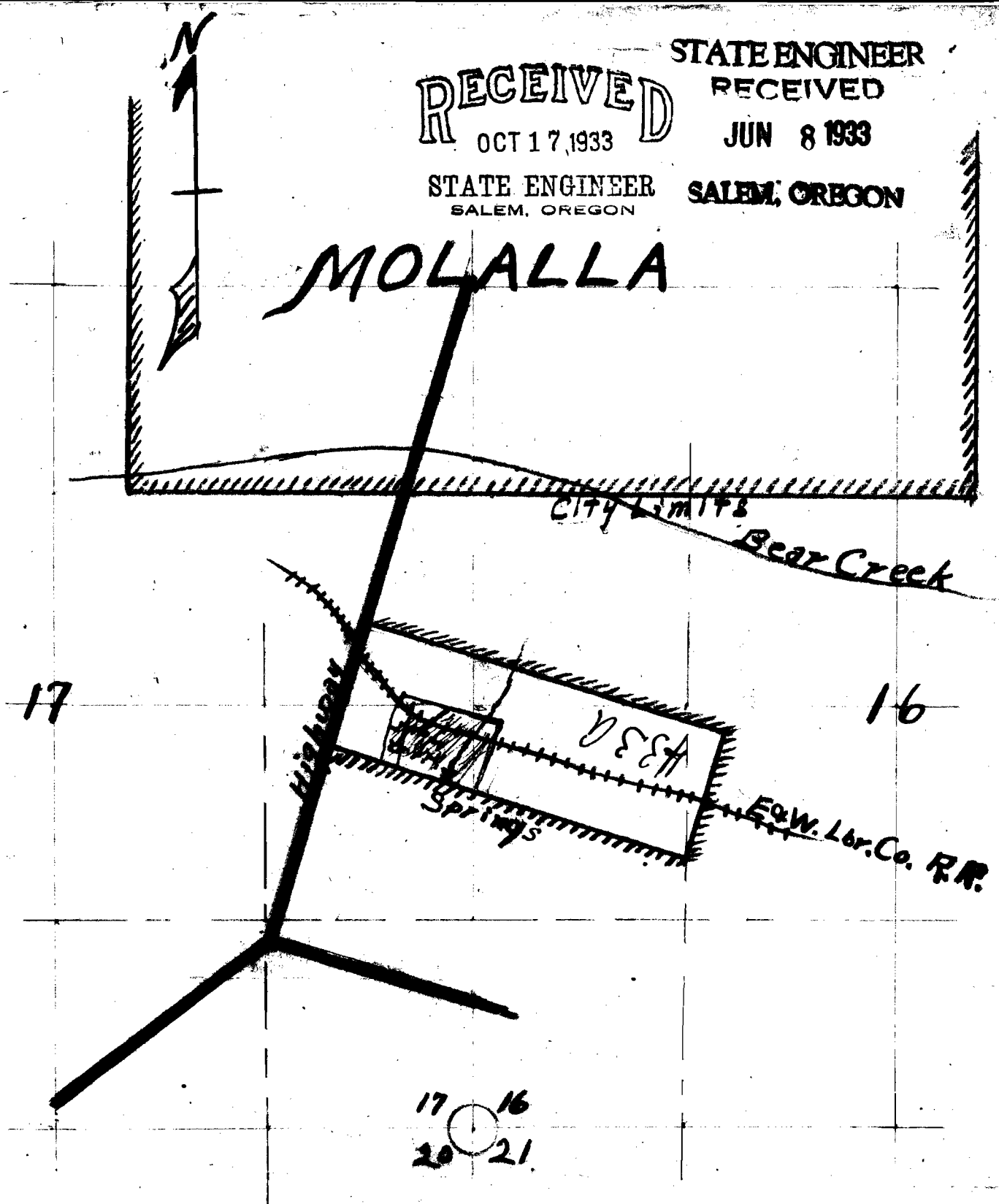

Township 5 S., Range 2 E.W.M.  
Clackamas County, Oregon.

Scale 6" to the mile.

J. M. Farr

APP. No. 15159

Per. No. 11080