

PROFILE OF METRO DAM
Scale: - 1" = 10 Ft.

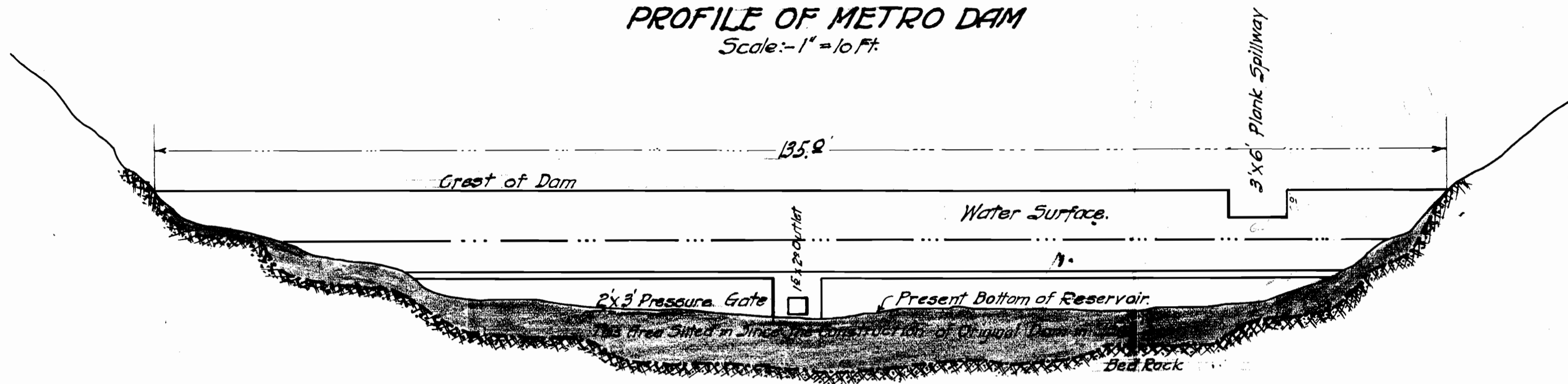

NOTE:-
Length of Reservoir 300ft.
Capacity 60,000 Cu.Ft.

PLAN OF METRO DAM
Scale: - 1" = 10 Ft.

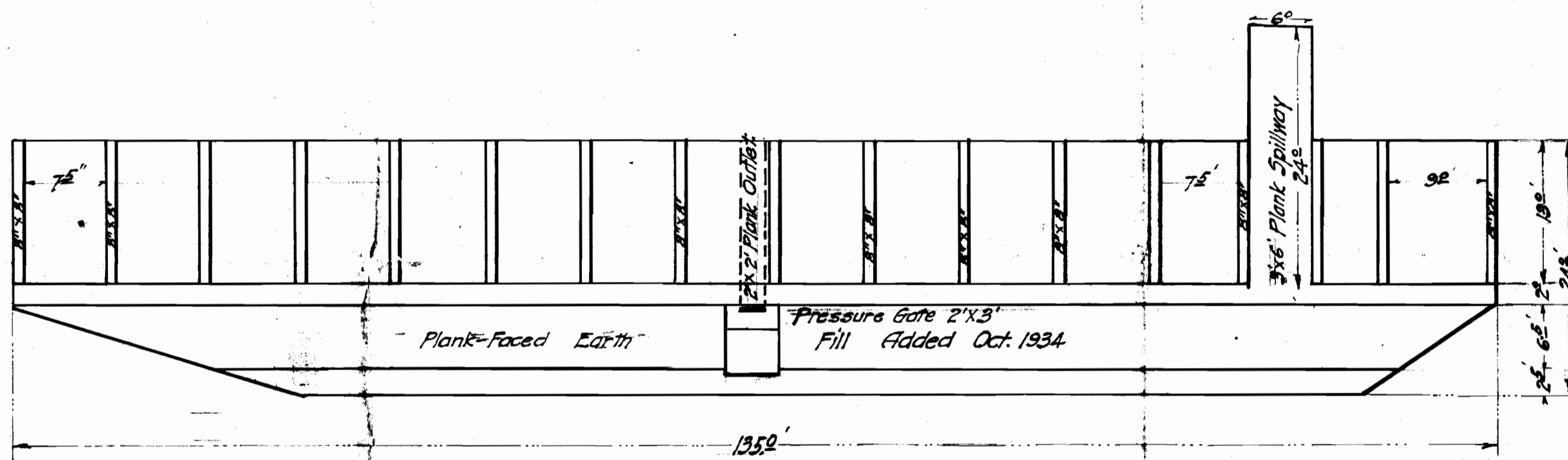

SECTION THRU OUTLET.
Scale: - 1" = 5 Ft.

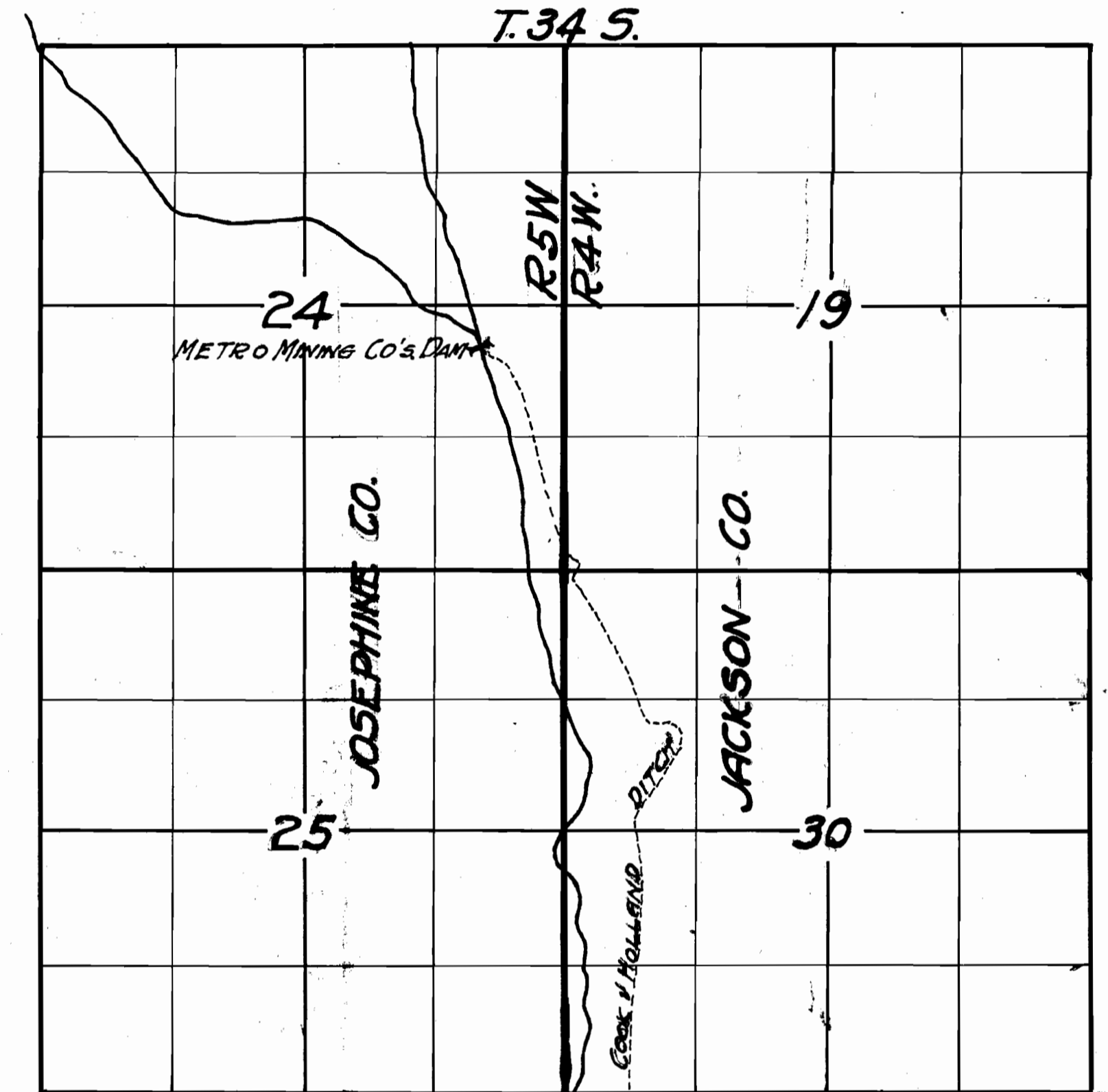
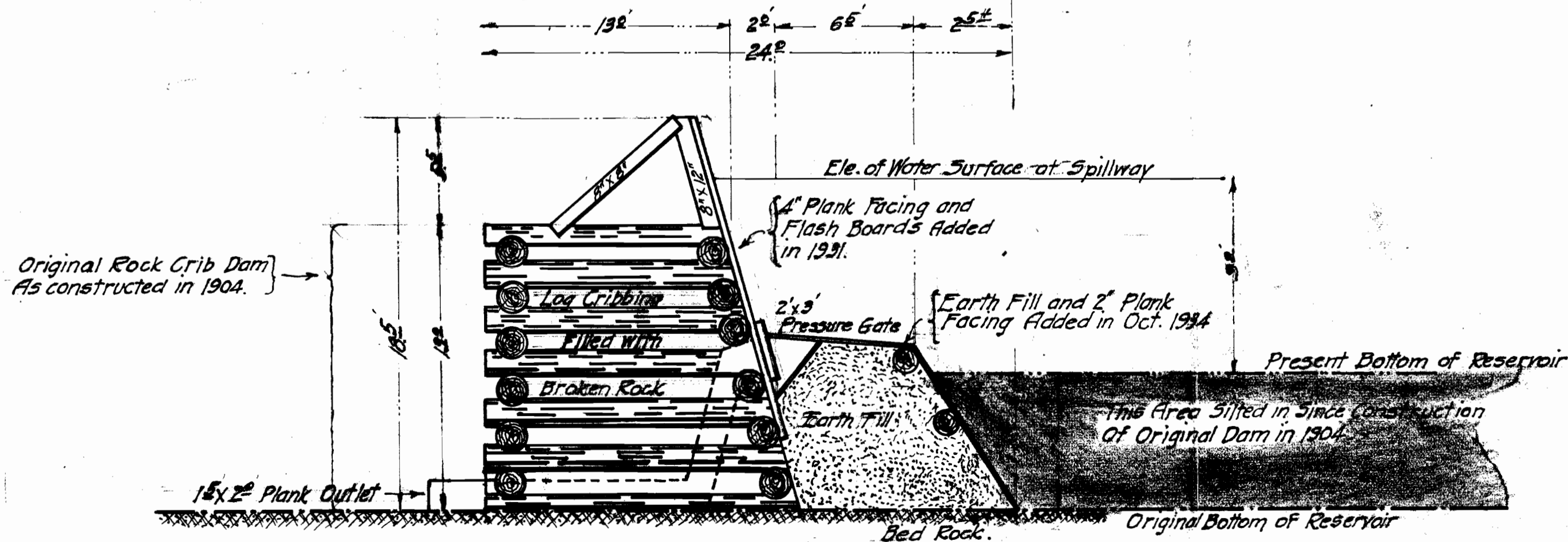

VICINITY MAP
Scale: - 4" = 1 MILE.

PLAN OF METRO MINING CO'S DAM ON JUMP-OFF JOE CR. JOSEPHINE COUNTY, ORE.
SCALE AS INDICATED.

OFFICE OF
T.O. RUSSELL

EUGENE, ORE.,
DEC. 29, 1933.

I hereby certify that this is a true and correct Plan of the METRO MINING Co's Dam on JUMP-OFF JOE Cr. in JOSEPHINE COUNTY, OREGON, made by me from measurements taken under my direction by H. ADYRHMANN, in December, 1934.

T.O. Russell
Registered Civil Engineer for Oregon.

A-12862
P-9/96