

I, L. R. STOCKMAN, OF BAKER, OREGON, DO HEREBY CERTIFY THAT THIS MAP WAS MADE FROM NOTES TAKEN DURING AN ACTUAL SURVEY MADE UNDER MY IMMEDIATE SUPERVISION ON AUGUST 4, 1933, AND THAT IT CORRECTLY REPRESENTS THE WORKS DESCRIBED IN THE ACCOMPANYING APPLICATION, TOGETHER WITH THE LOCATION OF STREAMS AND OTHER DITCHES IN THE IMMEDIATE VICINITY.

*L. R. Stockman*

REGISTERED PROFESSIONAL ENGINEER

DEC. 12. 1919

OREGON

DATE OF REGISTRATION.

OREGON NO. 315

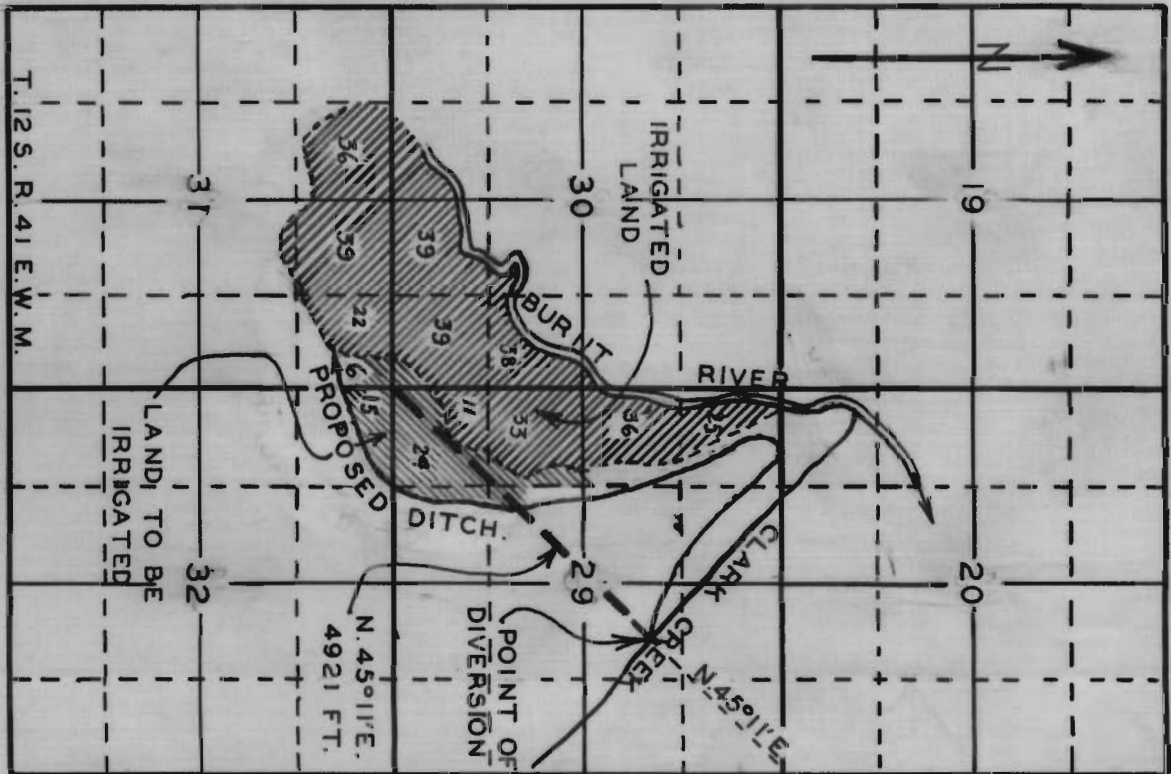

N. N. ELLIOTT LAND TO IRRIGATE.

*App. No. 15075  
Per. No. 10975*

STATE ENGINEER  
RECEIVED

AUG 8 1933

SALEM, OREGON