

E833

# EVANS DITCH NO. 3

CROOK COUNTY OREGON

Scale 2" = 1 Mile

I, R.L. Brewster of Prineville Oregon do hereby certify that this map was made from notes taken during an actual survey made by me in December 1913, and that it correctly represents the works described in the accompanying application together with the location of streams and other ditches in the immediate vicinity and has written the area in each smallest legal subdivision which is proposed to irrigate.

R. L. Brewster  
Surveyor

RECEIVED  
JAN 9 1914  
SALEM, OREGON,

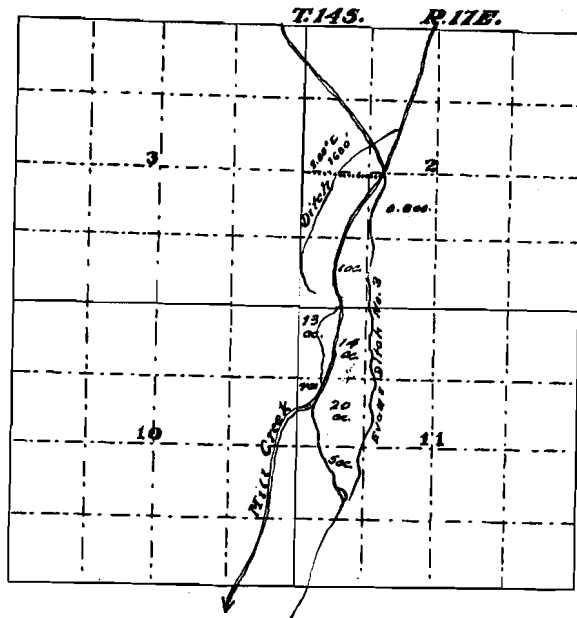

E833

3383  
1860

3383

C1173  
T 8732

Permit No: 1860