

SECTION

30

31

36

TOWNSHIP 385, RANGES 8-9, W. M.

North

I, Tom R. Pearce, of Grants Pass, Oregon do hereby certify that this map was made from notes taken during an actual survey made by me on July 26, 1936 and that it correctly represents the work described in the accompanying application.

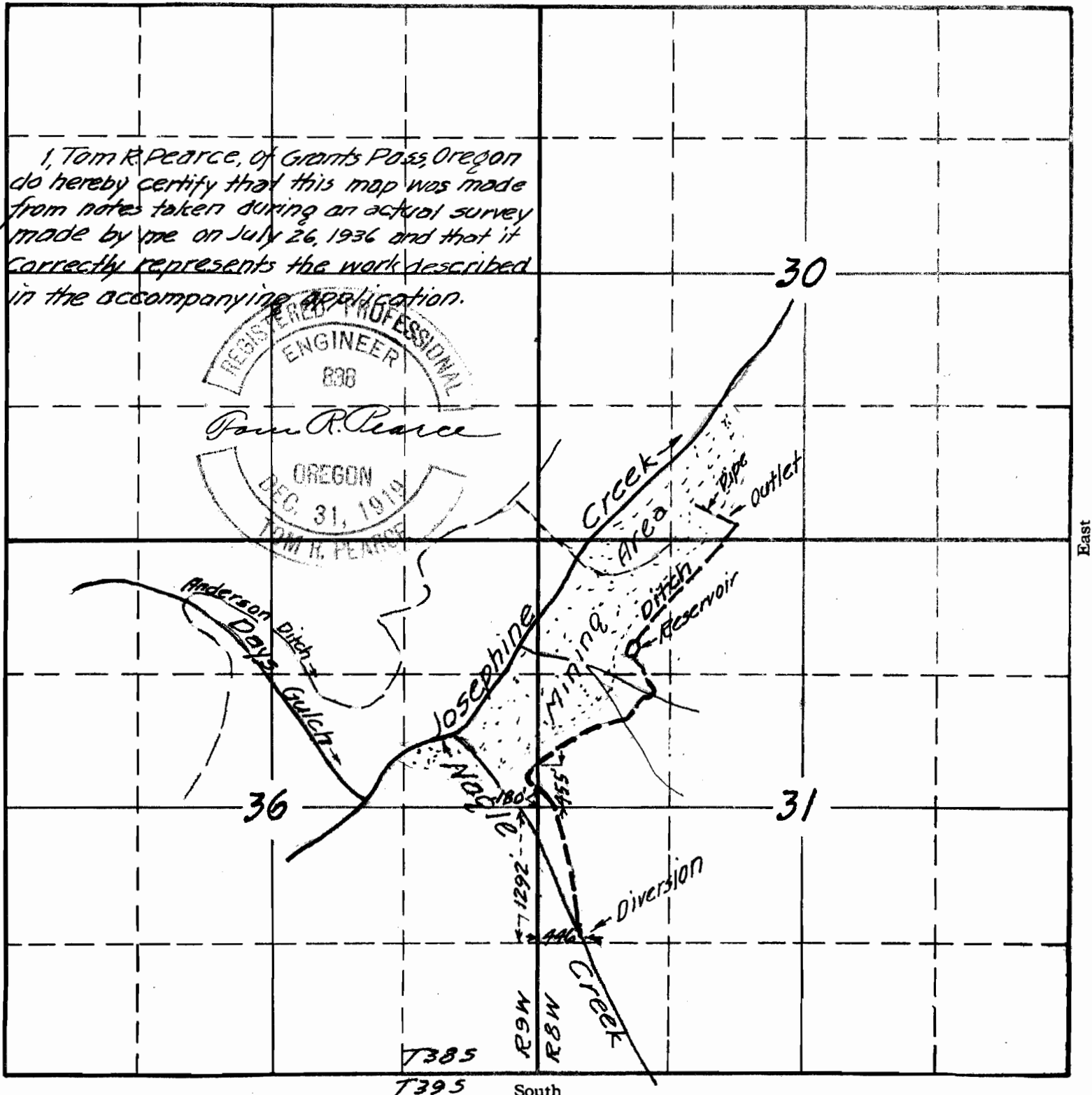
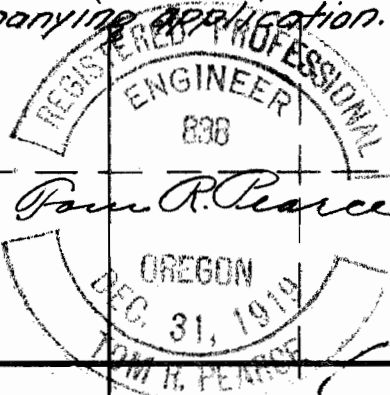

Golden Princess Mines Corp.
Scale 4"=1 Mile - July 1936

APPLICATION No. 16490
PERMIT No. 12291