

Proof Map

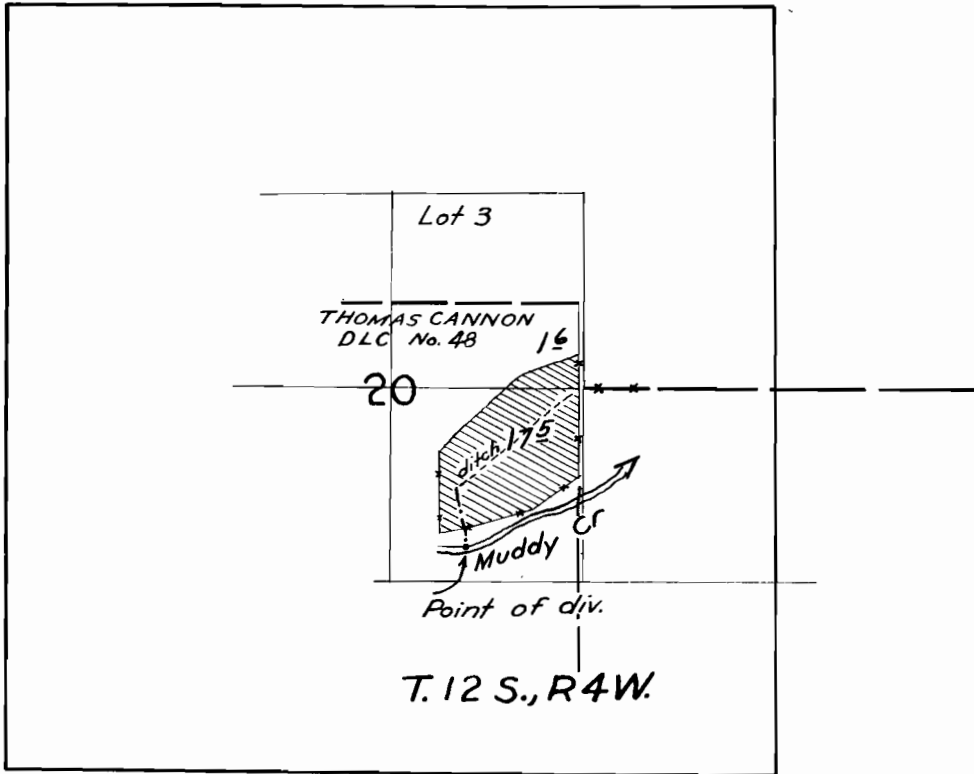

App. 16109

Per. 11999

SECTION 20, TOWNSHIP 12 S
RANGE 4 W. W.M.

RECEIVED
MAY 20 1953
STATE ENGINEER
SALEM, OREGON

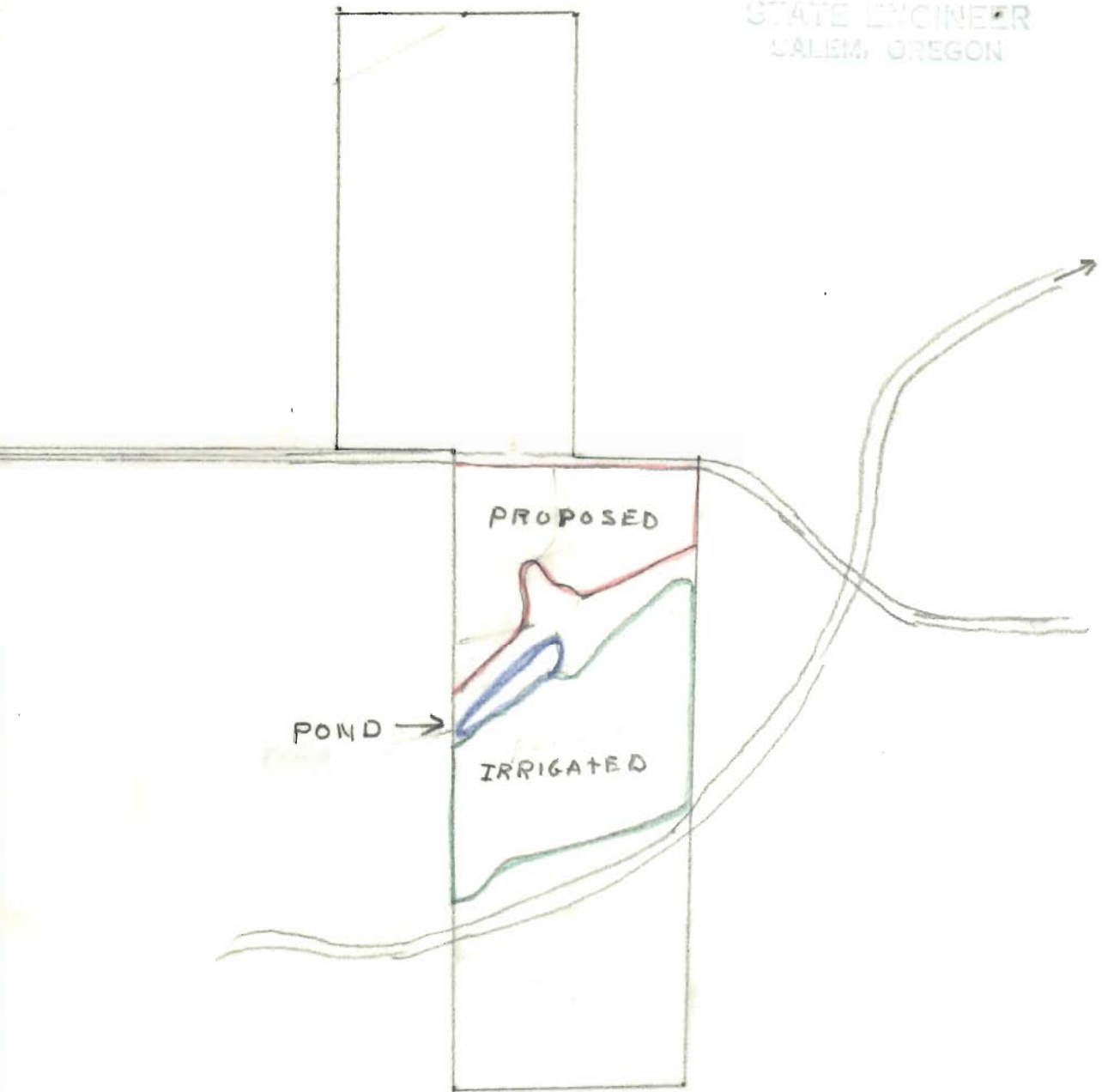

APPLICATION NO. 16109
PERMIT NO. 11999
CERTIFICATE NO. 11919