

T. 38 S. R. 8 W. W.M.

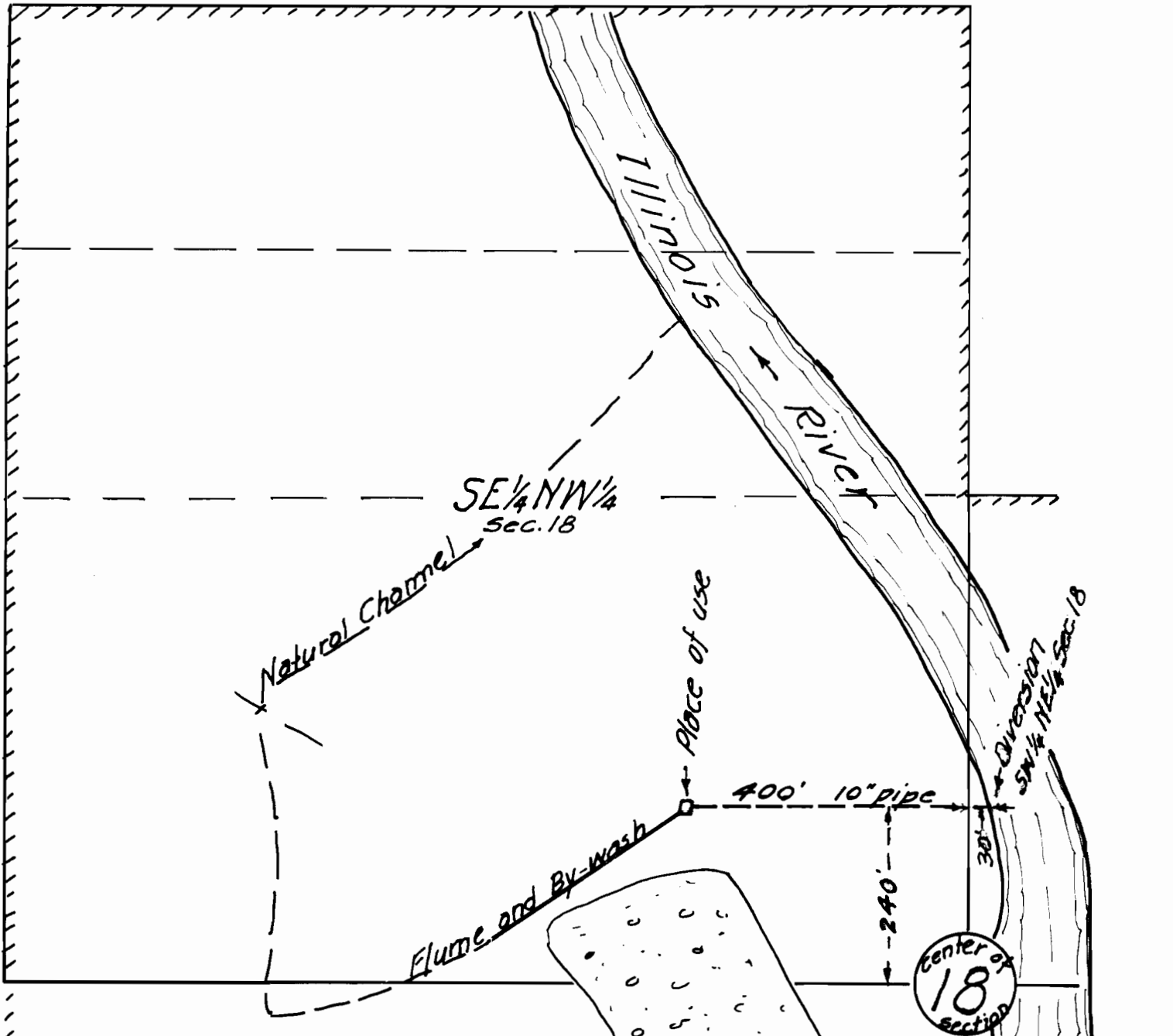

I, Tom R. Pearce, of Grants Pass, Oregon, do hereby certify that this map was made from notes taken during an actual survey, made by me during February 1938; and that it correctly represents the works described in this application together with streams and ditches, in the vicinity.

Application No. ....  
 Fred R. Hills.  
 July 1938.      Scale, 200 feet = 1 inch.

17398  
 1541  
 Application No. 17398  
 Permit No. 13097

