

SECTION 19 T.24 S.R.9 E.W.M.

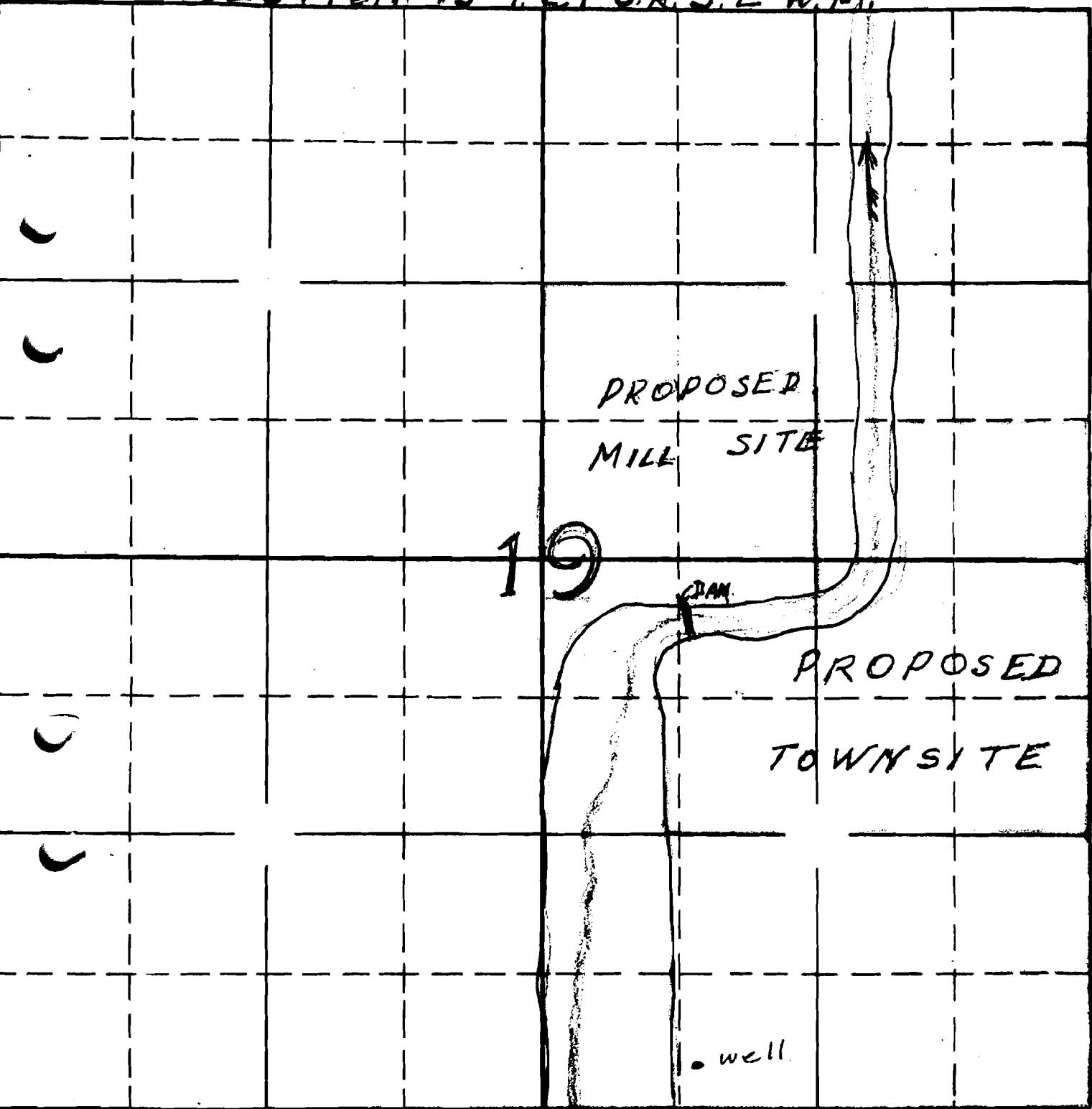

Map submitted 1/25/38 A. 12972  
to show change, P. 9240  
in point of diversion

C-12239

9240

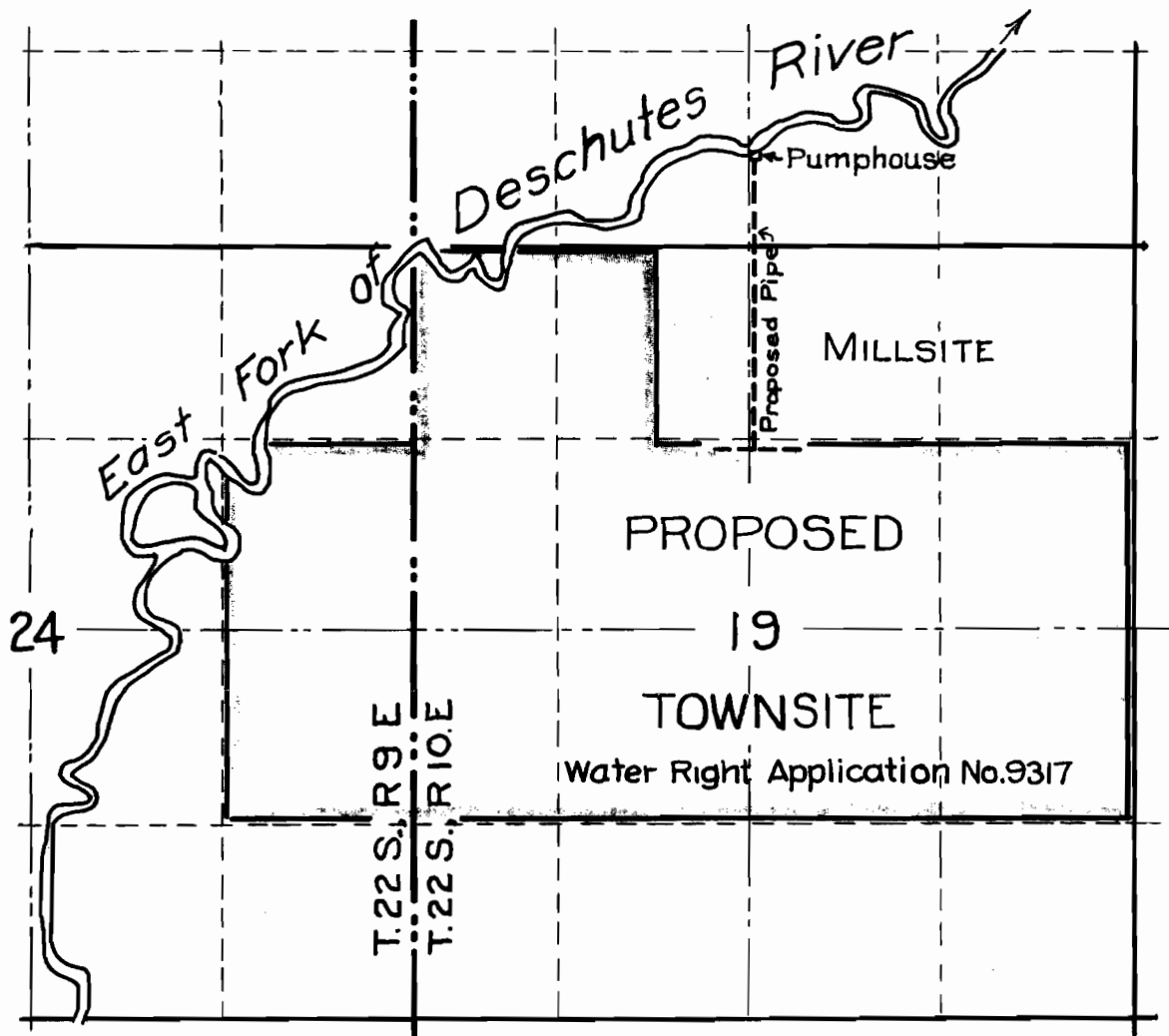

I hereby certify that this map was made from public and private data and that it correctly shows the location of the proposed works described in the accompanying application for permit to appropriate the public waters of the State of Oregon.

STATE ENGINEER RECEIVED

JAN 21 1924

STATE OF OREGON



MAP  
 To Accompany Application of  
**RALPH E. GILCHRIST**  
 to  
 STATE ENGINEER OF OREGON  
 For Permit to Appropriate Water

DECEMBER 1923

Application No. 9317 12972  
 Permit No. H-95 2240

*Approved - see transcripts filed 11/29/36  
 m 12971-*