

*PROPOSED
MILL SITE*

19

*PROPOSED
TOWN SITE*

SECTION-19, T-24, R-9, E.W.M.

SCALE - 1 INCH = 1/2 MILE.

MAP TO ACCOMPANY APPLICATION
OF

GILCHRIST TIMBER COMPANY.

SUCCESSORS TO RALPH E. GILCHRIST.

TO

STATE ENGINEER OF OREGON.

FOR PERMIT TO APPROPRIATE WATER
TO COMPLETE APPLICATION OF DEC. 1923.

Submitted
7 25 1938
version point
s changed

Application 12971.

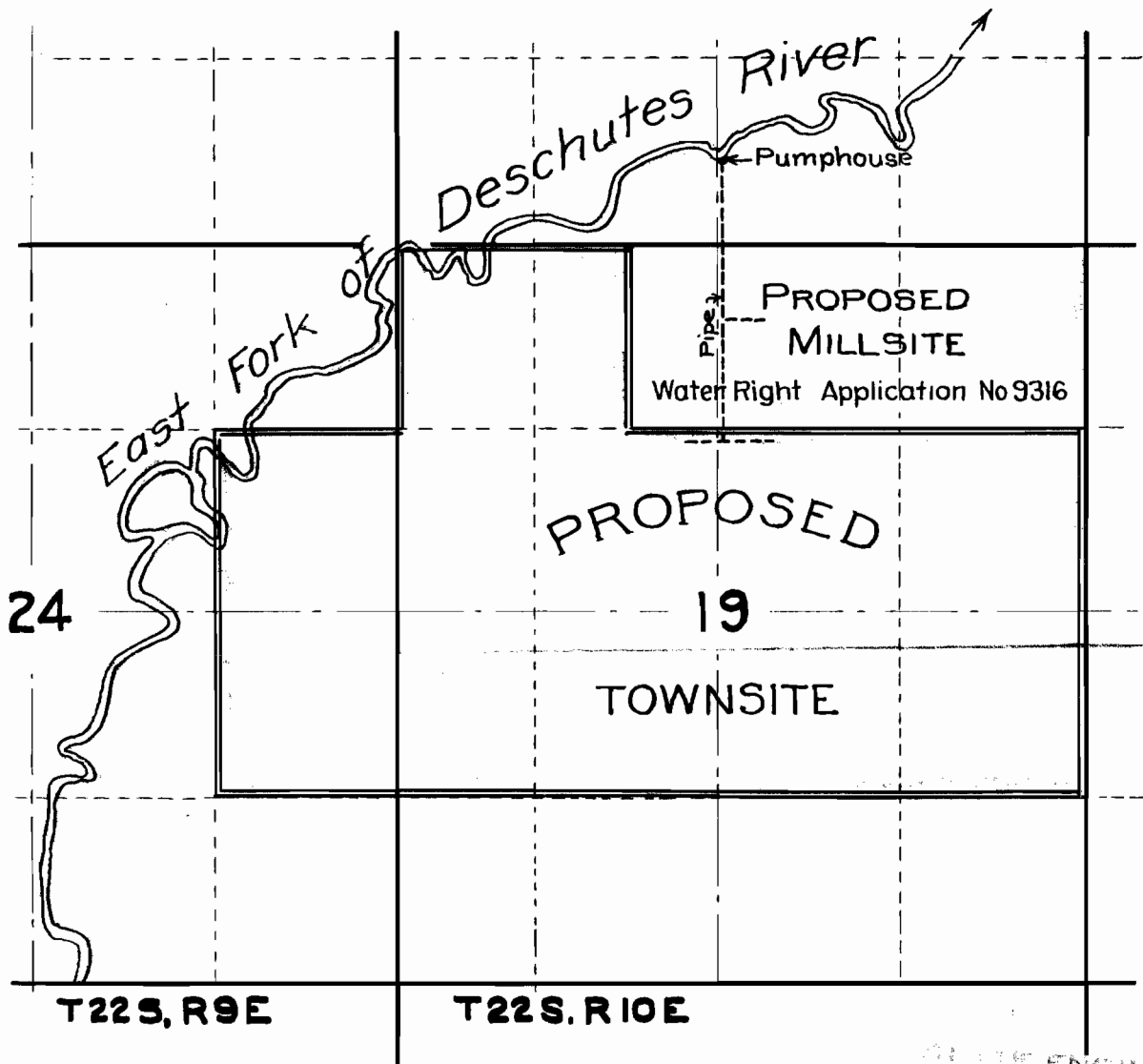

I hereby certify that this map was made from various public and private records, and that it correctly shows the location of the proposed works described in the accompanying application for permit to appropriate the public waters of the State of Oregon.

STATE ENGINEER RECEIVED

NOV 21 1924

STATE ENGINEER

MAP

To Accompany Application of
RALPH E. GILCHRIST
 TO
 STATE ENGINEER OF OREGON
 For Permit to appropriate Water

DECEMBER 1923

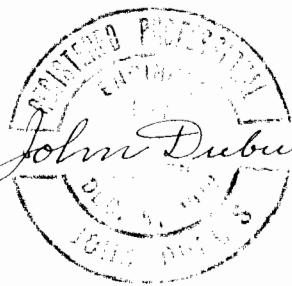

STATE ENGINEER

Suspended - see Application 12971 / 11/24/36
m 12971

Application No

7310 12971

Permit No

6694 9241