

MAP

Accompanying application for a water permit.

SURVEY IN SE $\frac{1}{4}$ SE $\frac{1}{4}$ SECT 27 TWP. 3 N RANGE 10 E EAST W. M.

FOR A. Kolstad

DATE March 25, 1938

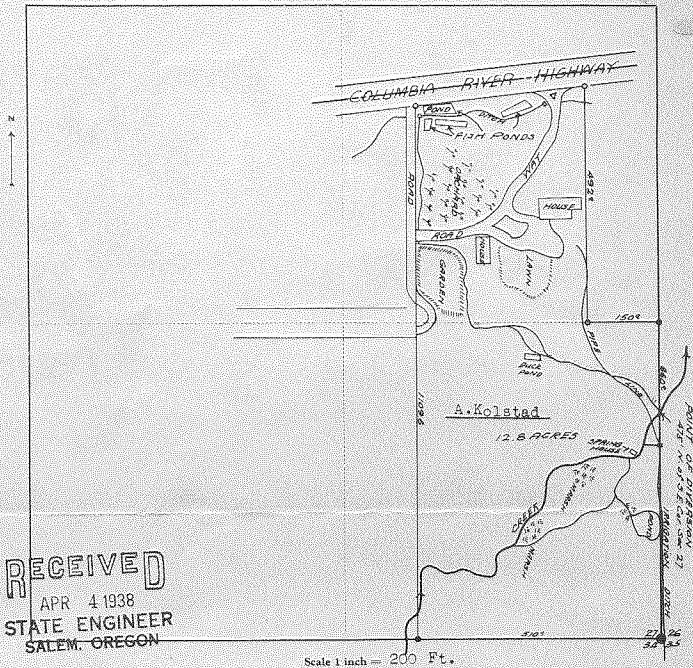

RECEIVED
APR 4 1938
STATE ENGINEER
SALEM, OREGON

I do hereby certify that this sketch was made from notes taken during an actual survey by me on March 21 1938, and that it correctly represents the field work of said survey.

Application No. 17283

C. M. Hurlburt

Permit No. 13011

County Surveyor
Hood River County, Oregon

Helpers H. Booth

17283 MS

A-6