

35

TOWNSHIP 37 S, RANGE 2 W, W. M.

North

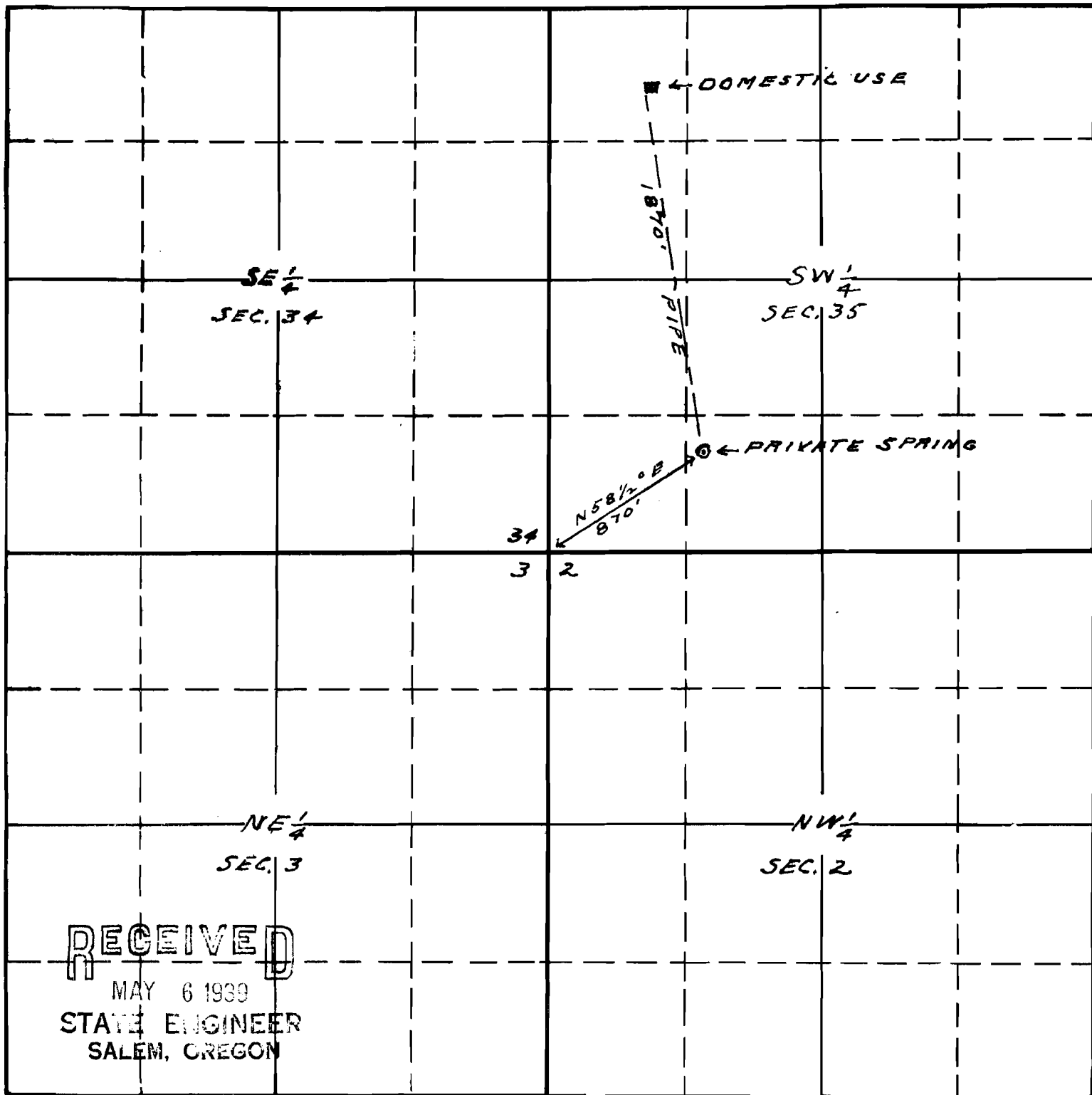

RECEIVED

MAY 6 1939
STATE ENGINEER
SALEM, OREGON

South

Map to accompany application of
E.L. Walz for use of private
spring for domestic use and
not more than 1/2 acre of garden.

17989 OK
15-23

APPLICATION No. 17989

PERMIT No. 13663