

MAP
 OF
JACK HORTON RESERVOIR and DITCH
 IN
Klamath County, Oregon.
 Surveyed March 15, 1914.
 Scale: 1" = 30 chs. Don J. Zumwalt
 Surveyor.

I, Don J. Zumwalt, of Klamath Falls, Oregon, do hereby certify that this map was made from notes taken during an actual survey made by me on March 15, 1914, and that it correctly represents the works described in the accompanying application, together with the location of streams and other ditches in the immediate vicinity, and has written thereon the area in each smallest legal subdivision which it is proposed to irrigate.

Don J. Zumwalt.
 Surveyor.

Field notes of Main Ditch.

Beginning at outlet of dam at a point N. 0° 28' W. distant 50.15 chs. from the SE. cor. of Sec. 11, T. 37 S. R. 11 1/2 E. W. M.; thence down a gulch or natural water course, as follows:

a.	S. 31° 57' W.	9.51 chs.
b.	S. 47° 15' W.	1.76 "
c.	S. 53° 19' W.	25.51 "
d.	S. 8° 58' W.	4.84 "
e.	S. 26° 55' W.	23.39 " To 1.47 chs. E. of 1/4 cor. on N. line Sec. 14.
f.	S. 53° 15' W.	11.70 "
g.	S. 71° 19' W.	11.10 "
h.	S. 56° 20' W.	5.00 "

Field Notes of Reservoir.

Beginning at Sec. Cor. Common to secs. 1, 2, 11 & 12, T. 37 S. R. 11 1/2 E. W. M. Thence following high water line of reservoir:

1.	N. 49° 57' E.	6.34 chs.
2.	S. 60° 07' E.	9.09 "
3.	S. 55° 34' E.	6.74 "
4.	S. 35° 15' E.	7.65 "
5.	S. 36° 38' E.	4.83 "
6.	S. 10° 35' E.	9.28 "
7.	S. 5° 16' W.	11.30 "
8.	S. 7° 28' W.	12.40 "
9.	S. 31° 19' W.	6.87 "
10.	N. 79° 52' W.	6.06 "
11.	N. 30° 04' W.	19.18 " To SE. end of dam
12.	N. 49° 26' W.	7.23 " To Sec. line, 49.79 chs. N. of SE. cor. 11.
		9.21 " To NW. end of dam.
13.	N. 20° 58' W.	7.01 "
14.	N. 12° 24' W.	10.67 "
15.	N. 41° 36' W.	9.19 "
16.	N. 2° 22' E.	2.00 "
17.	N. 74° 35' E.	12.78 " To beginning.

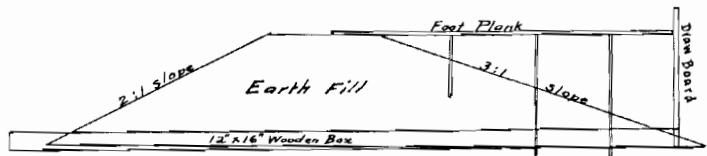

Cross Section of Dam at Outlet. Scale: 1" = 6'.

Record No. 3553
 Section No. 273
 Section No. 3554
 Permit No. 1982

Buck Ale : yonna valley

R-273
1251

2

1

T.37 S. R. 11 1/2 E.

Boundary Klamath

JAC

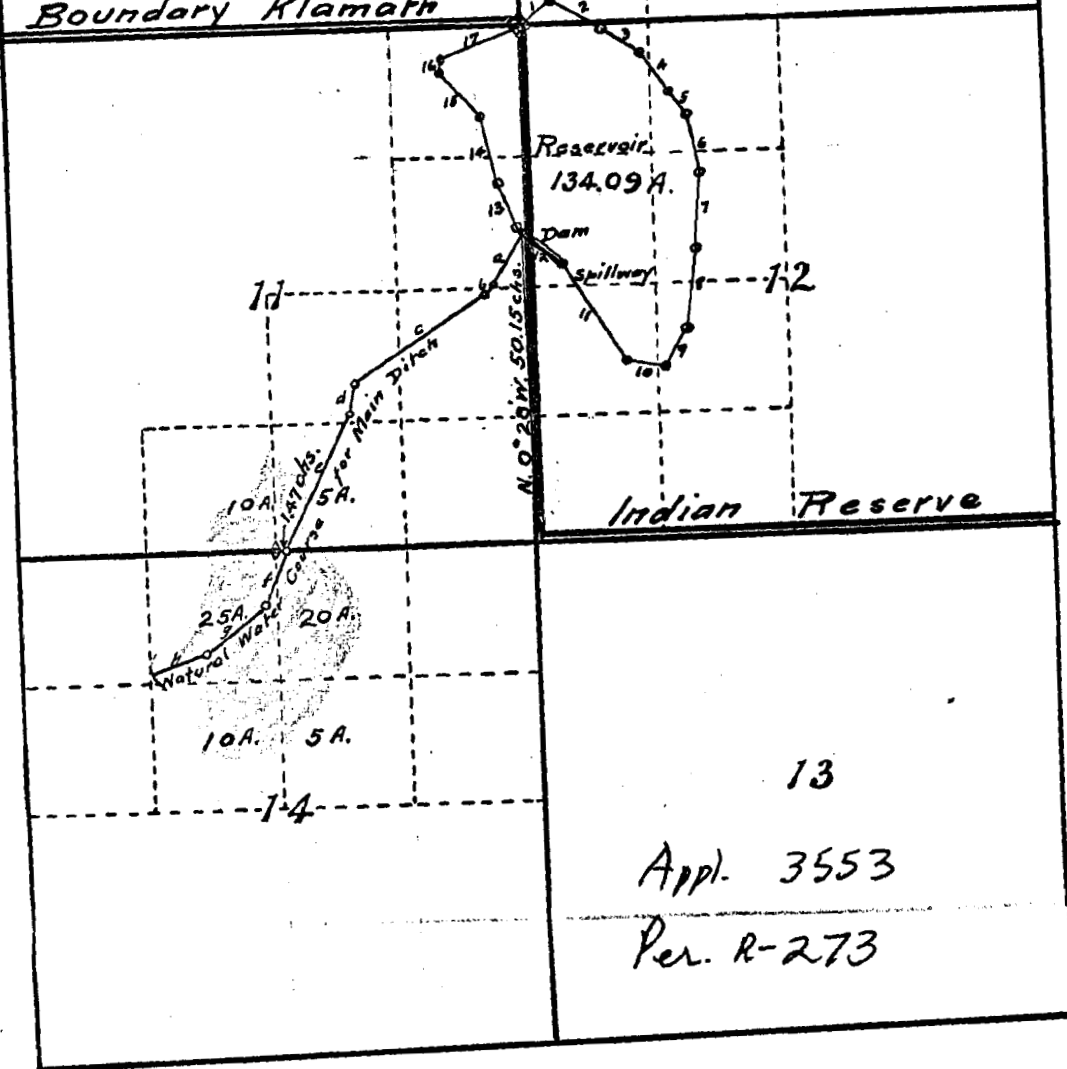

Indian Reserve

I, Don J. Zumwalt
from notes taken &
correctly repres
with the locati
and has writte
it is propose

13

Appl. 3553

Per. R-273

Field notes of Main Ditch.

Beginning at outlet of dam at a point N. 0° 28' W. distant 50.15 chs.
from the SE. cor. of Sec. 11, T. 37 S. R. 11 1/2 E. W. M.; thence down a
gully or natural water course, as follows:

- | | | |
|----|---------------|-----------|
| a. | S. 31° 57' W. | 9.51 chs. |
| b. | S. 47° 15' W. | 1.76 " |
| c. | S. 53° 19' W. | 25.51 " |
| d. | S. 8° 58' W. | 4.84 " |
| e. | S. 26° 55' W. | 23.39 " |
| f. | S. 53° 15' W. | 11.70 " |
| g. | S. 71° 19' W. | 11.10 " |
| h. | S. 56° 20' W. | 5.00 " |

To 1.47 chs. E. of 1/4 cor.
on N. line Sec. 14.



Cross S.

Field notes at Reservoir.

2

1

T.37 S R. 11 1/2 E.

Boundary Klamath

Reservoir
134.09

Dam

Spillway

11

12

N. 0° 28' W. 50.15 chs

11
1/2
Ditch

Indian Reserve



14

13

MAP
OF
JACK HORTON RESERVOIR and DITCH
IN
Klamath County, Oregon.

Surveyed March 15, 1914

Scale: 1" = 30^{chs.}

Don J. Zumwalt
Surveyor.

Reservoir Permit R. 273

Permit No. 1982