

FROM OFFICE OF THE STATE ENGINEER

Willow Creek Adjudication

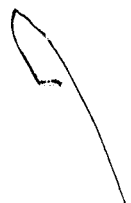

Part 3 S. 26
2 S. 26

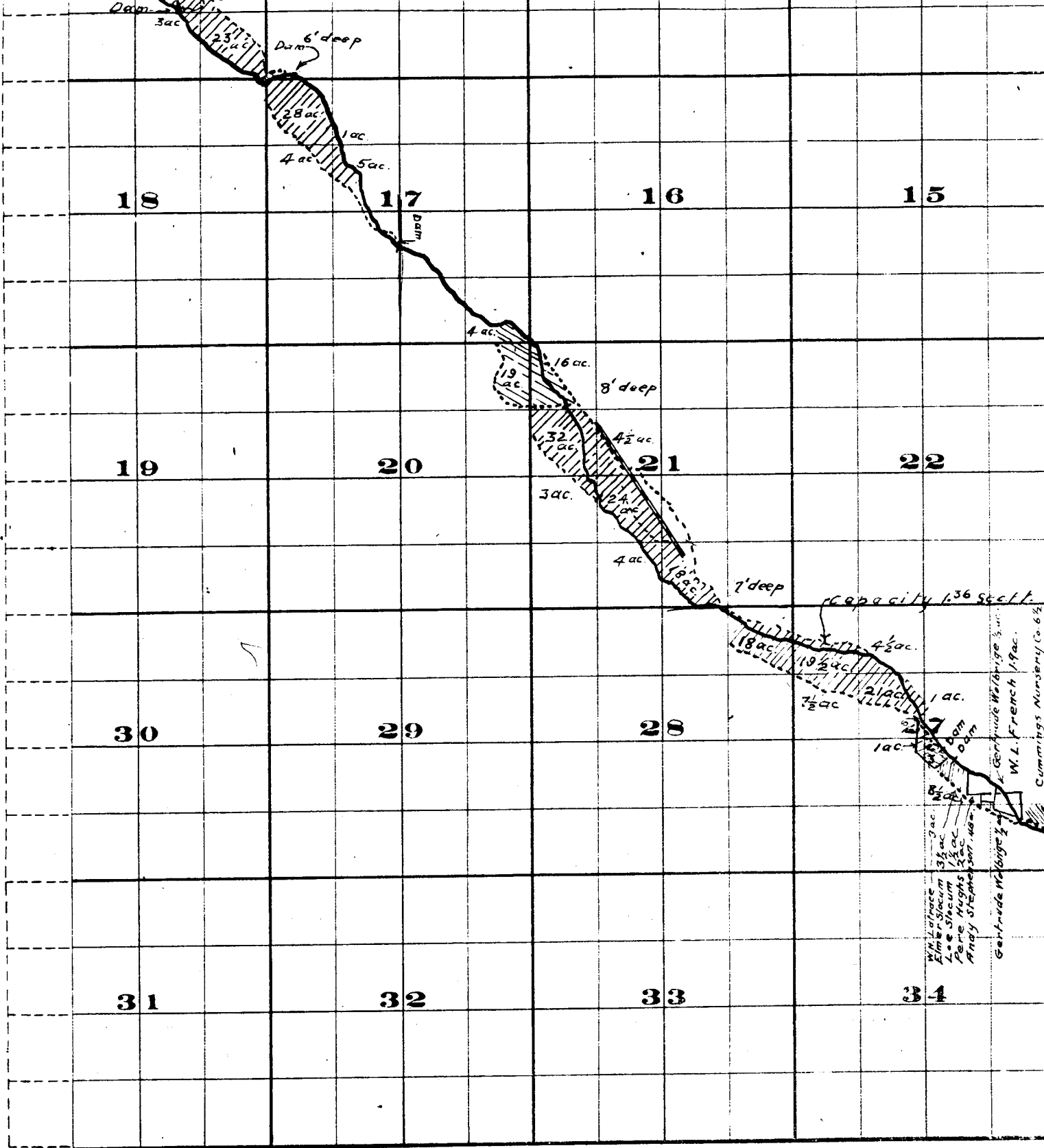

THE S & B BRISTOL CO., PRINTERS & BOUNDERS CHRYSTAL N.Y.

Surveyed by R.D. Cooper July 1909

John H. Lewis - State Engineer.

Examined July 14, 1909.



Township 2 S.

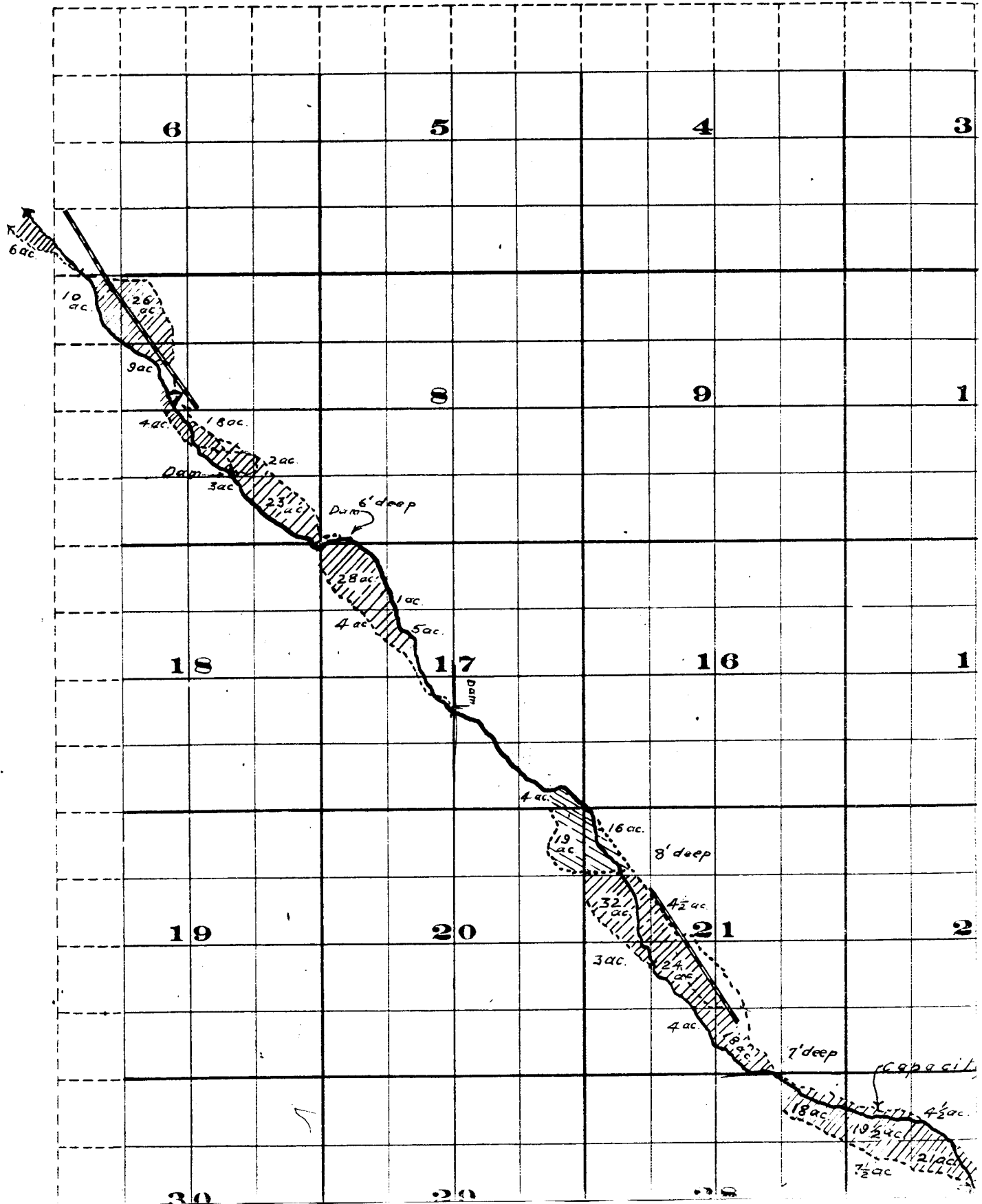

Range 26 E. W. M.

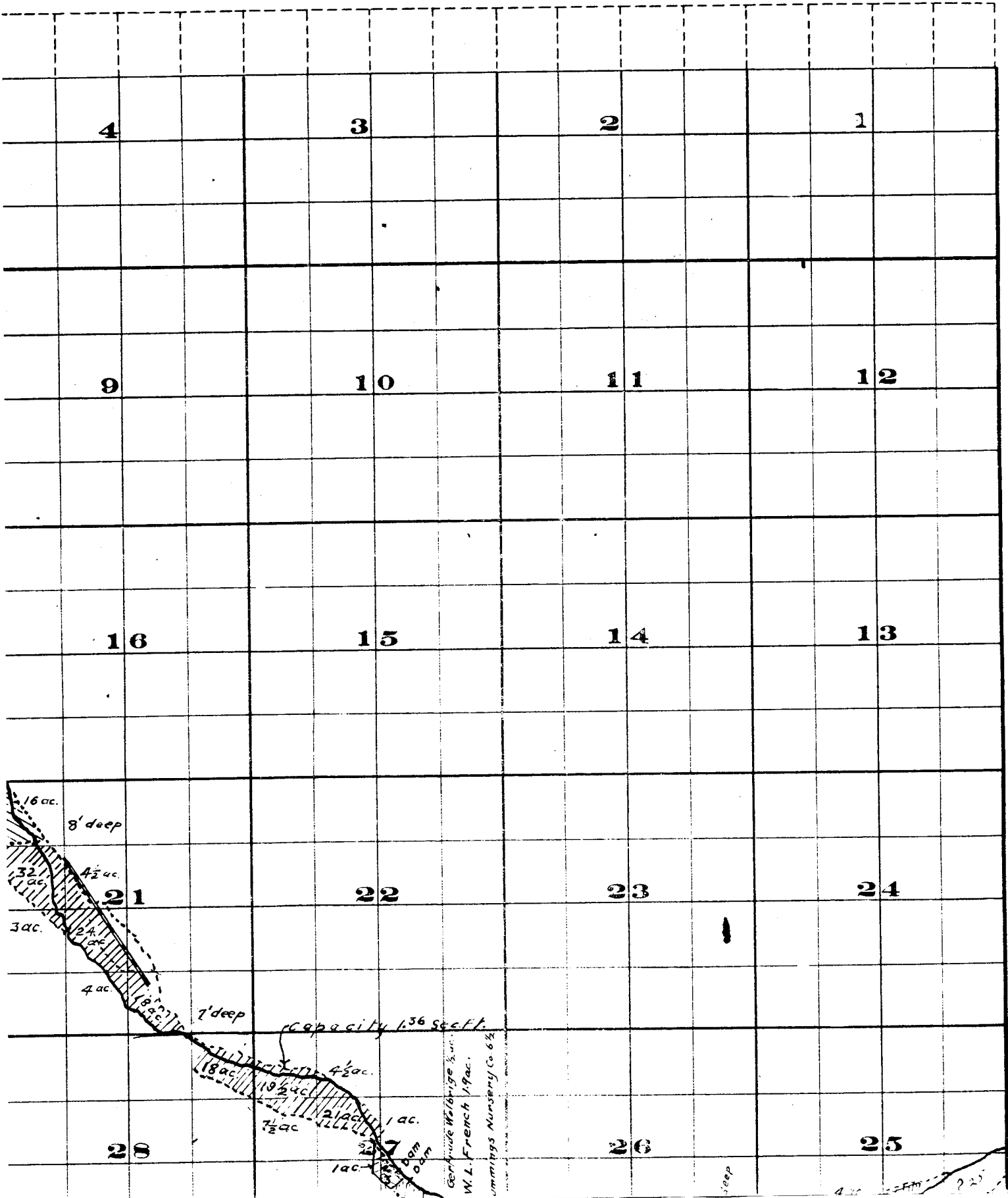

4

3

2

1

9

10

11

12

16

15

14

13

21

22

23

24

28

26

25

16 ac.
8' deep
3 1/2 ac.
4 1/2 ac.
3 ac.
2 1/2 ac.
4 ac.
7' deep
capacity 1.36 sec ft.
18 ac.
19 1/2 ac.
2 1/2 ac.
1 ac.
dam
1 ac.
Gertrude Walbridge
W.L. French 1900
Lummitgs Nursery Co 6 1/2

sleep
4 1/2 ac. 2 PM
2 25