

Range 23 E.W.M.

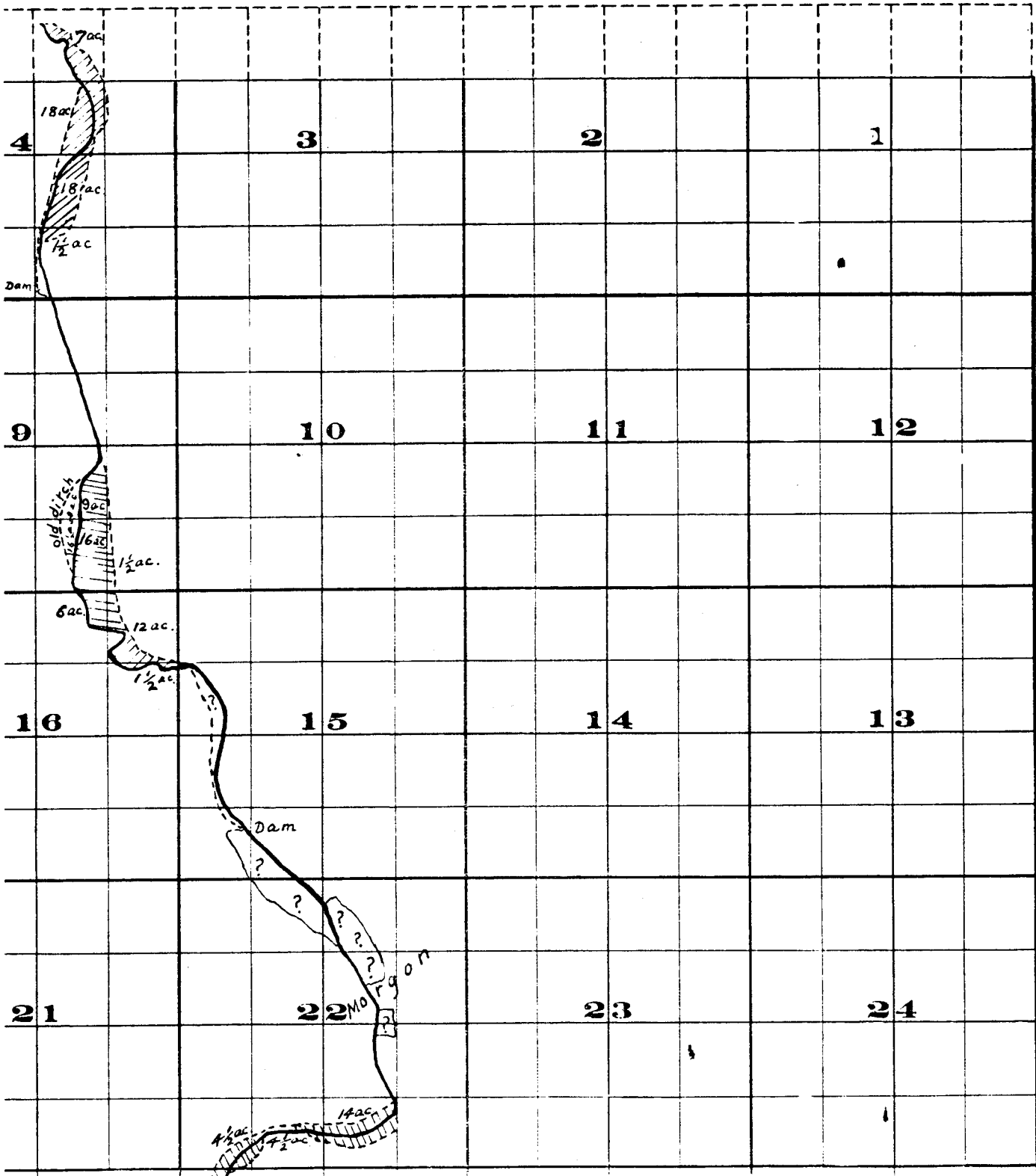

# Township 1 N.

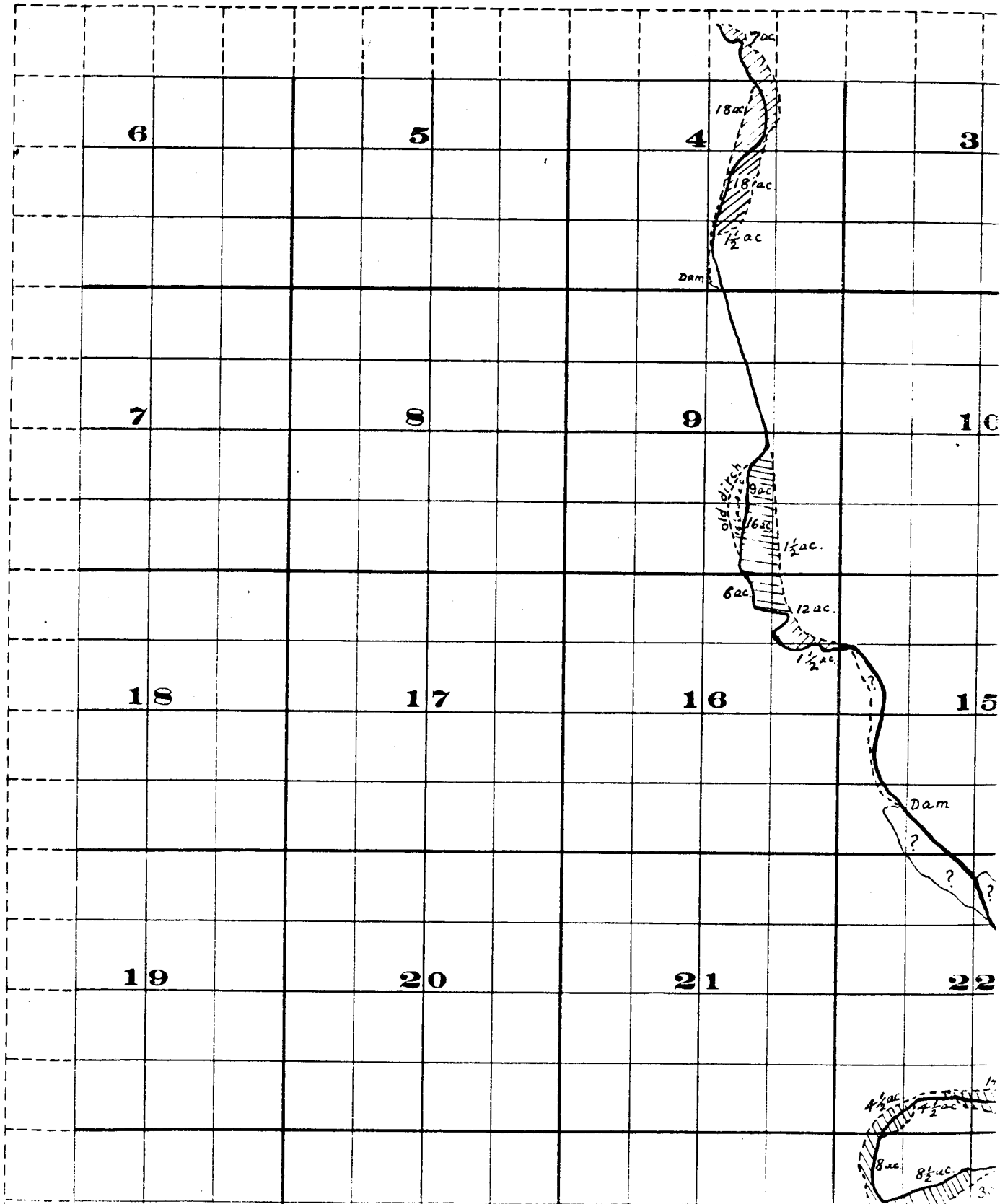

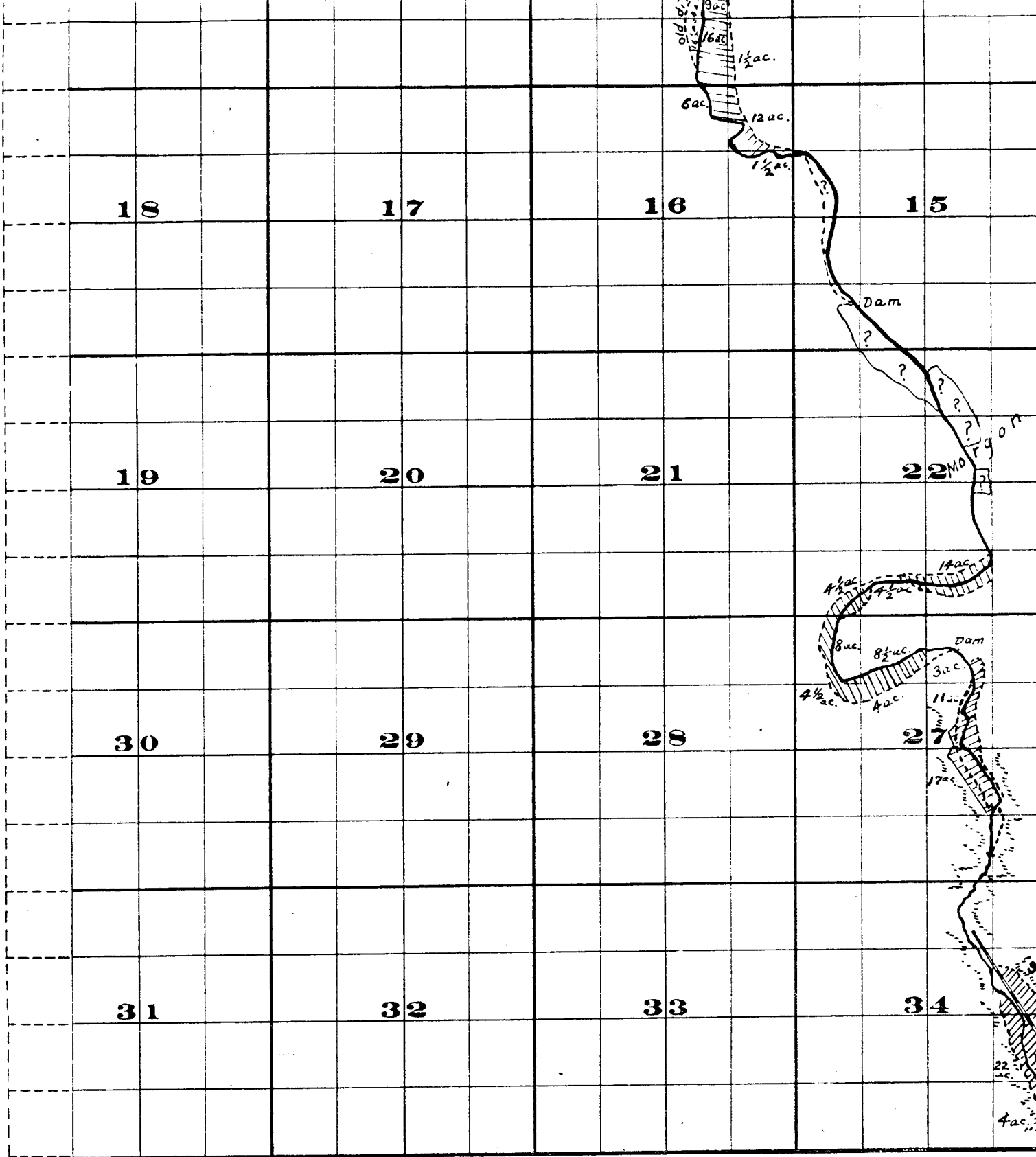

THE S.A. BRISTOL CO., PRINTERS & BOOKBINDERS, CHEYENNE WYO.

Surveyed by H. K. Donnelly July 1909, S. 27 North  
 Surveyed by R. D. Cooper July 1909, S. 27 South

John H. Lewis - State Engineer

Examined July 14, 1909.

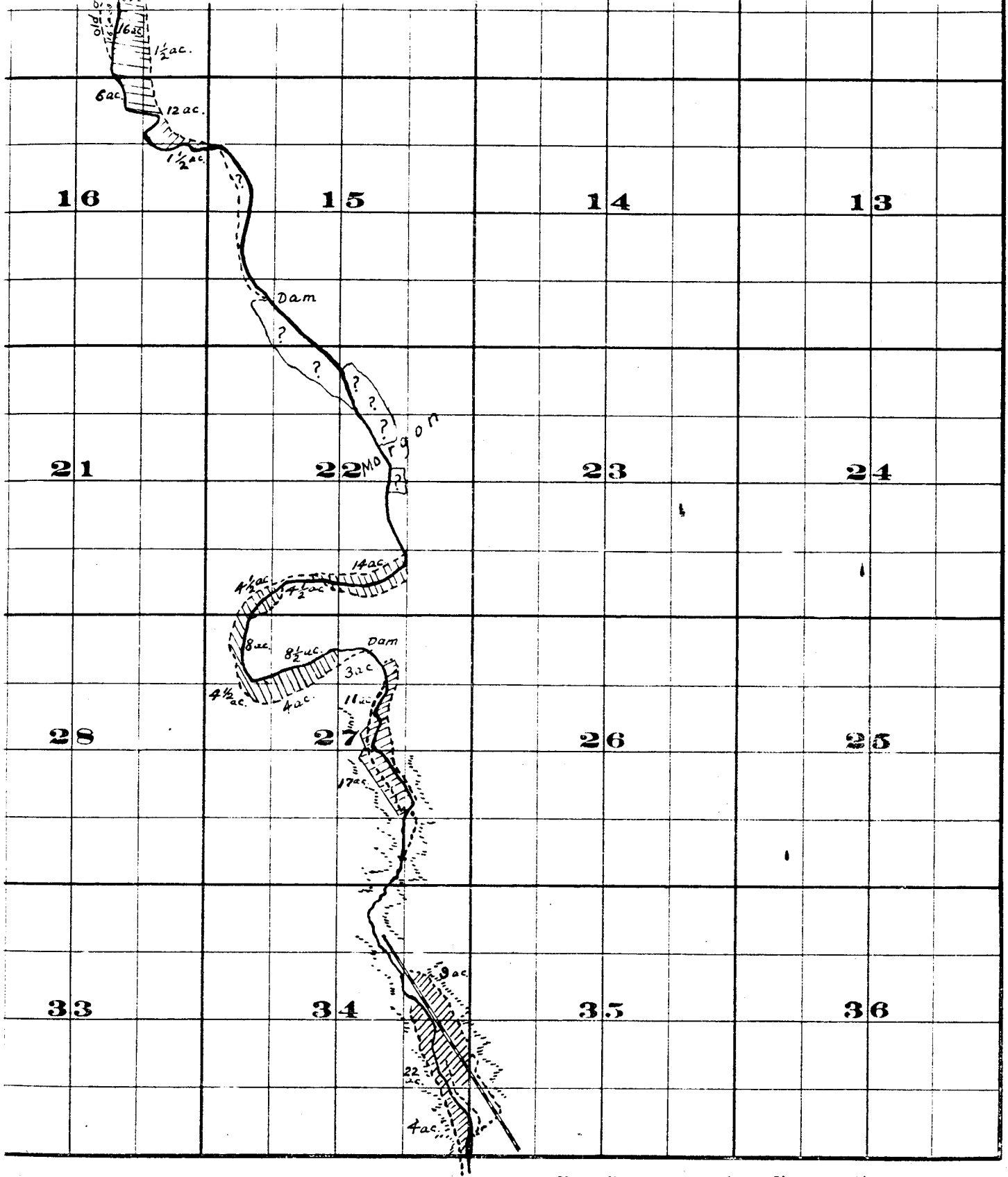

FROM OFFICE OF THE STATE ENGINEER, SALEM, OREGON

*Willow Creek Adjudication*

S. 27 North  
 S. 27 South  
 ineer  
 909.