

Cr. on Quad maps

Johnson
CRIDGE
CREEK



Greason and Shoemaker Ranch
 Surveyed Oct. 16, 17, 20
 05
 06
 07
 08
 09
 10
 11
 12
 13
 14
 15
 16
 17
 18
 19
 20
 21
 22
 23
 24
 25
 26
 27
 28
 29
 30
 31
 32
 33
 34
 35
 36
 37
 38
 39
 40
 41
 42
 43
 44
 45
 46
 47
 48
 49
 50
 51
 52
 53
 54
 55
 56
 57
 58
 59
 60
 61
 62
 63
 64
 65
 66
 67
 68
 69
 70
 71
 72
 73
 74
 75
 76
 77
 78
 79
 80
 81
 82
 83
 84
 85
 86
 87
 88
 89
 90
 91
 92
 93
 94
 95
 96
 97
 98
 99
 100

East Side Ditch
 15
 16
 17
 18
 19
 20
 21
 22
 23
 24
 25
 26
 27
 28
 29
 30
 31
 32
 33
 34
 35
 36
 37
 38
 39
 40
 41
 42
 43
 44
 45
 46
 47
 48
 49
 50
 51
 52
 53
 54
 55
 56
 57
 58
 59
 60
 61
 62
 63
 64
 65
 66
 67
 68
 69
 70
 71
 72
 73
 74
 75
 76
 77
 78
 79
 80
 81
 82
 83
 84
 85
 86
 87
 88
 89
 90
 91
 92
 93
 94
 95
 96
 97
 98
 99
 100

16

17

18

Surveyed Oct. 20, 1923.

15
 16
 17
 18
 19
 20
 21
 22
 23
 24
 25
 26
 27
 28
 29
 30
 31
 32
 33
 34
 35
 36
 37
 38
 39
 40
 41
 42
 43
 44
 45
 46
 47
 48
 49
 50
 51
 52
 53
 54
 55
 56
 57
 58
 59
 60
 61
 62
 63
 64
 65
 66
 67
 68
 69
 70
 71
 72
 73
 74
 75
 76
 77
 78
 79
 80
 81
 82
 83
 84
 85
 86
 87
 88
 89
 90
 91
 92
 93
 94
 95
 96
 97
 98
 99
 100

WOOD CAMP CREEK

12

20

61

Township 1

Creason and Shoemaker Ranch

4

5

8

9

6

7

X.E. Hall Ranch
Surveyed Nov. 6, 1923.

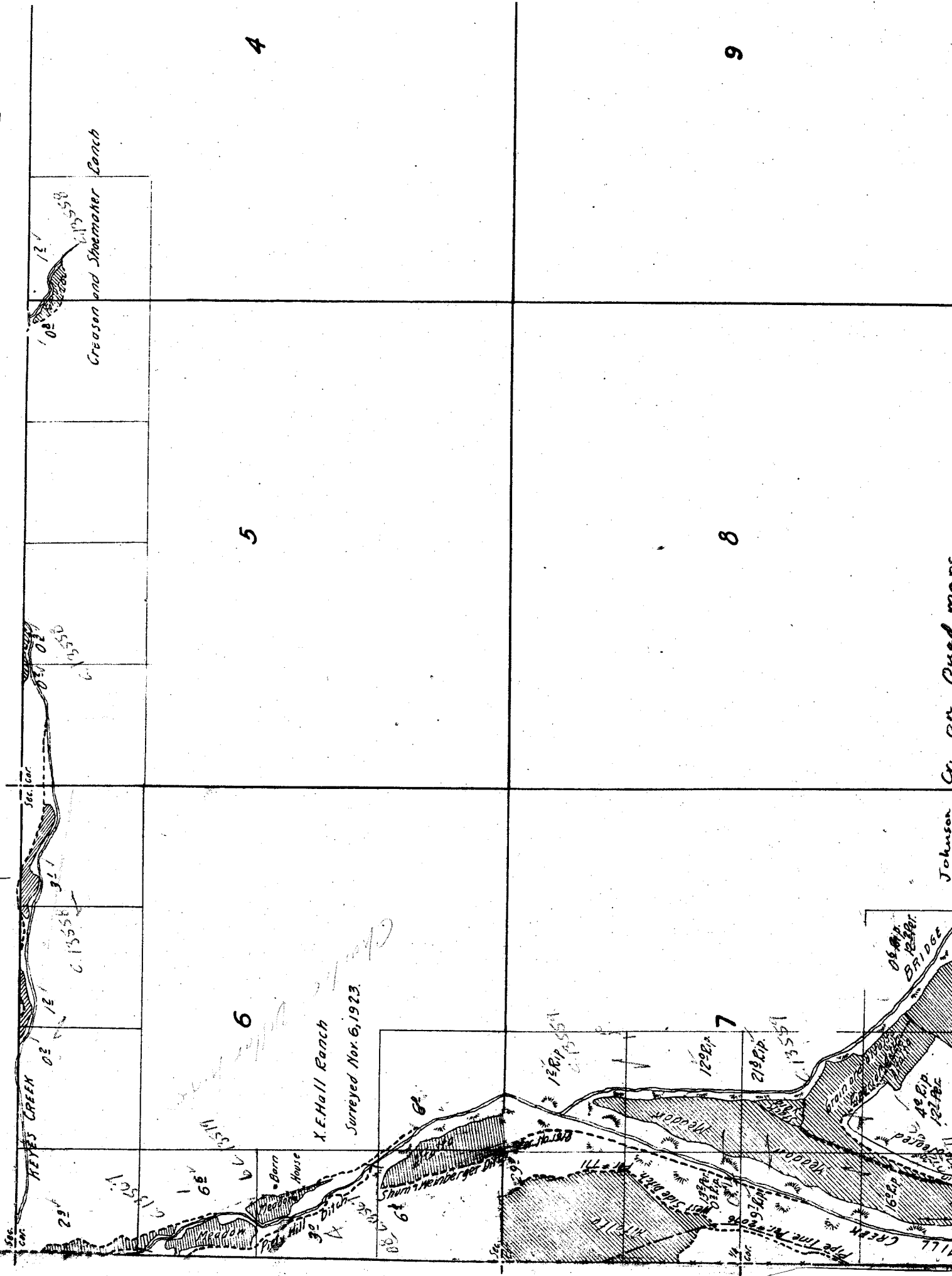

Johnson

MILL CREEK
FIRE TIME CREEK
MEADOW
BRIDGE
OLD BRIDGE

28

27

33

34



16

15

22

21

Surveyed Oct 20, 1923.

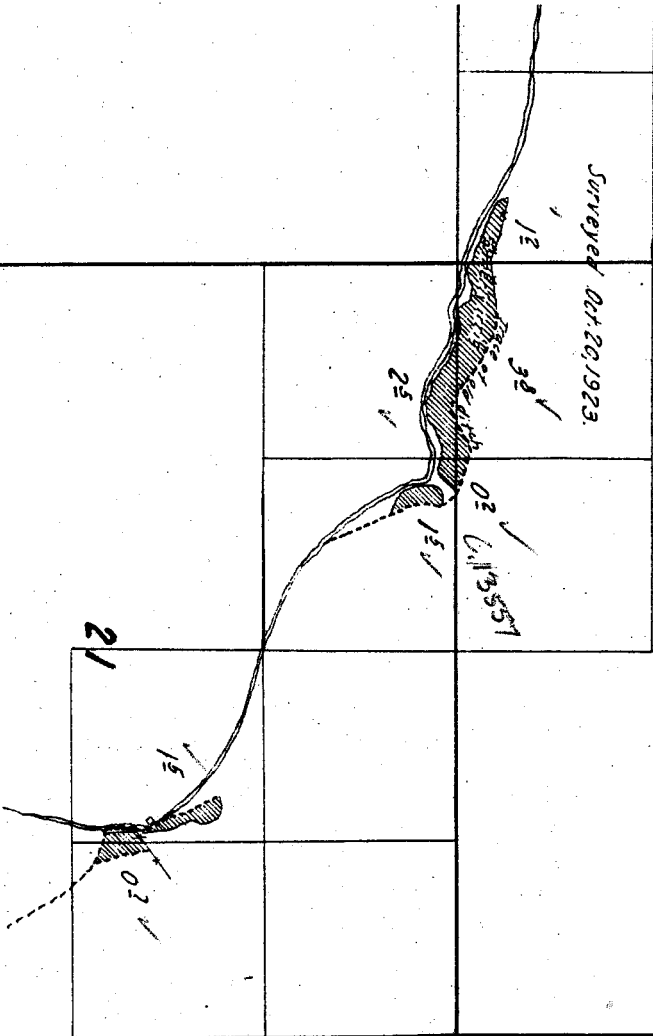

Range 22 E. 11-1-1

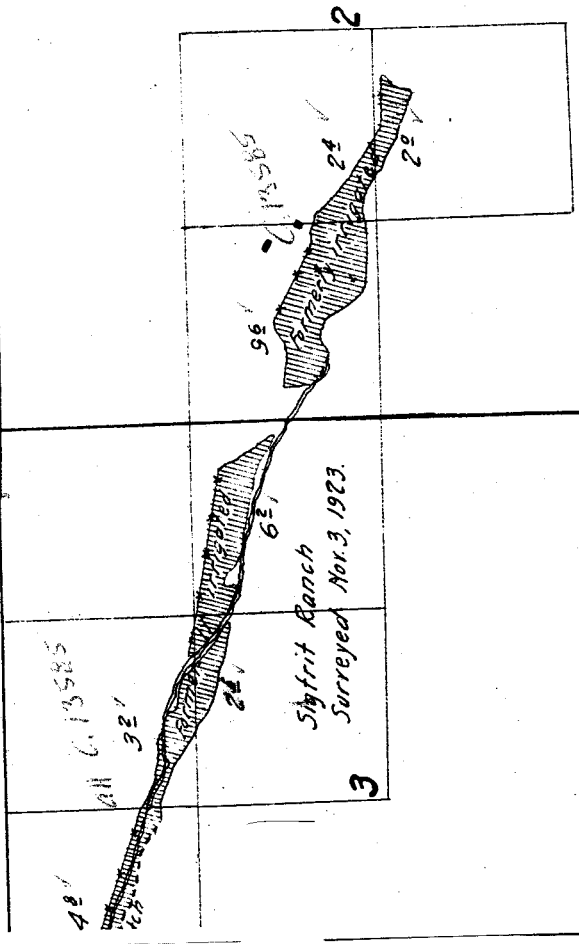

12

11

10

13

24

14

23

15

22

12
C. 13558
Shoemaker Ranch

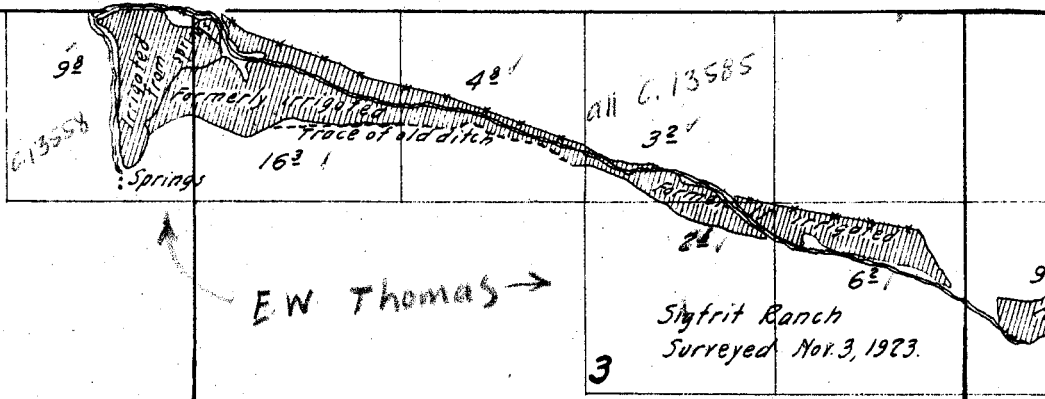

Styfrut Ranch
Surreyed Nov. 3, 1923.

4

3

9

10

16

15

19

20

30

29

31

32

23

24

26

25

35

36

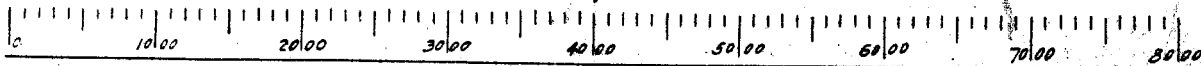

Scale of Feet.

26" x 27"

GM Nelson Reservoir
Pat 462

28

27

33

34

Maxwell Creek



12324

21

16

1/4 cor

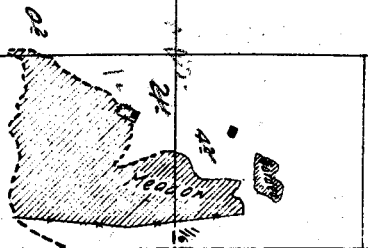

Nelson and Campbell Ranch Surveyed Oct 19, 1923

6 N. Nelson ditch Pat. #225

22

15

Cole Bros.

MEADOW

Survey of Oct 18

MEADOW

Maxwell Ditch Pat. #209

155

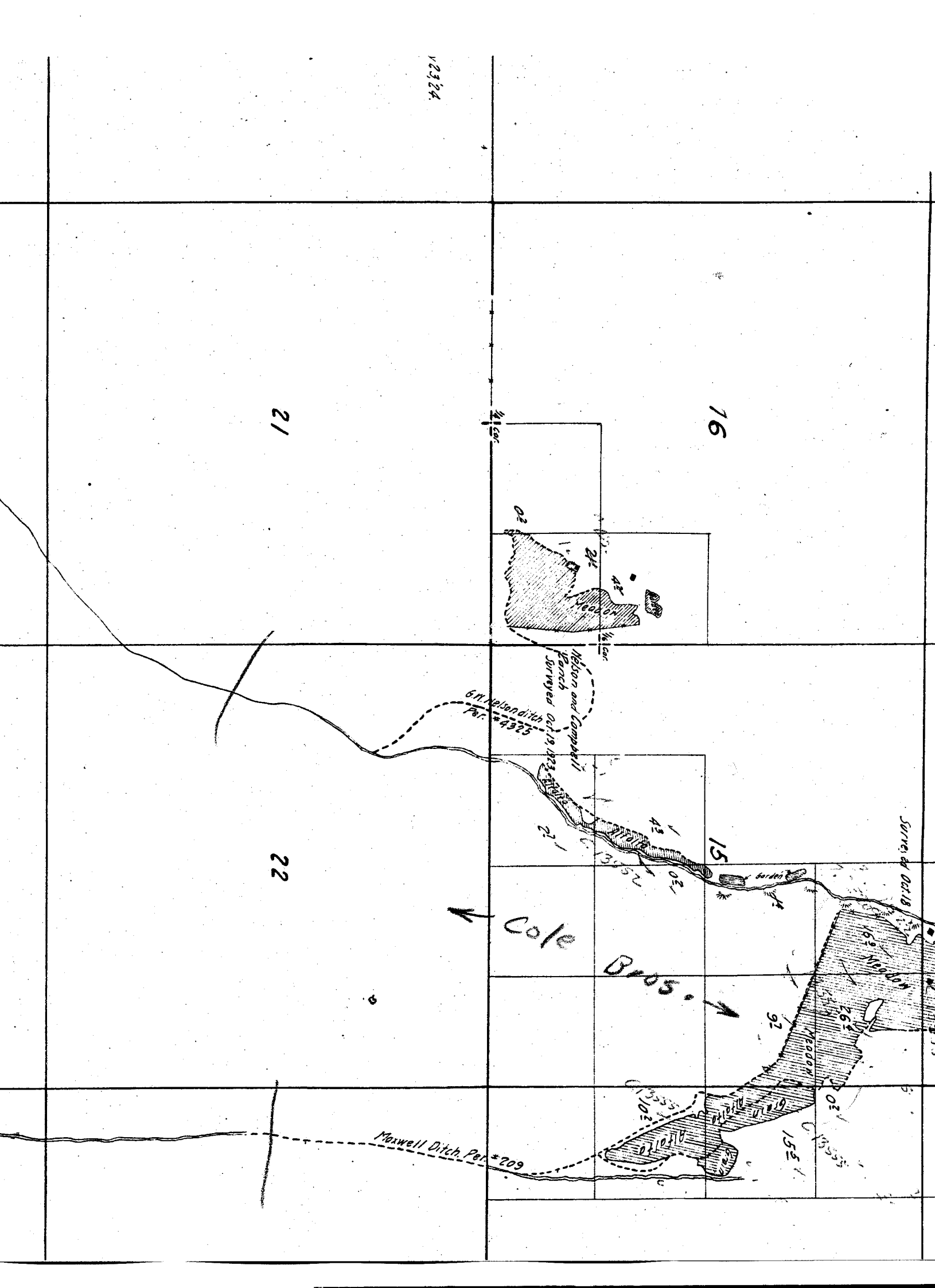

23

24

26

25

MILL CREEK

35

36

NOTE: - Creeks sketched in approximate location from U.S. Township plats or from Forest Service map except in vicinity of irrigated areas. Permit ditches plotted in approximate location from permit maps except in vicinity of irrigated areas.

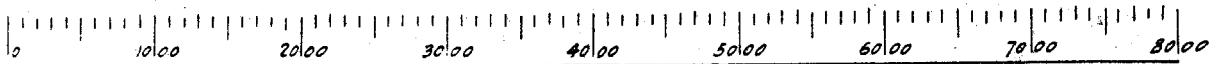

Scale of Feet.

19

20

Leach Creek

30

29

31

32

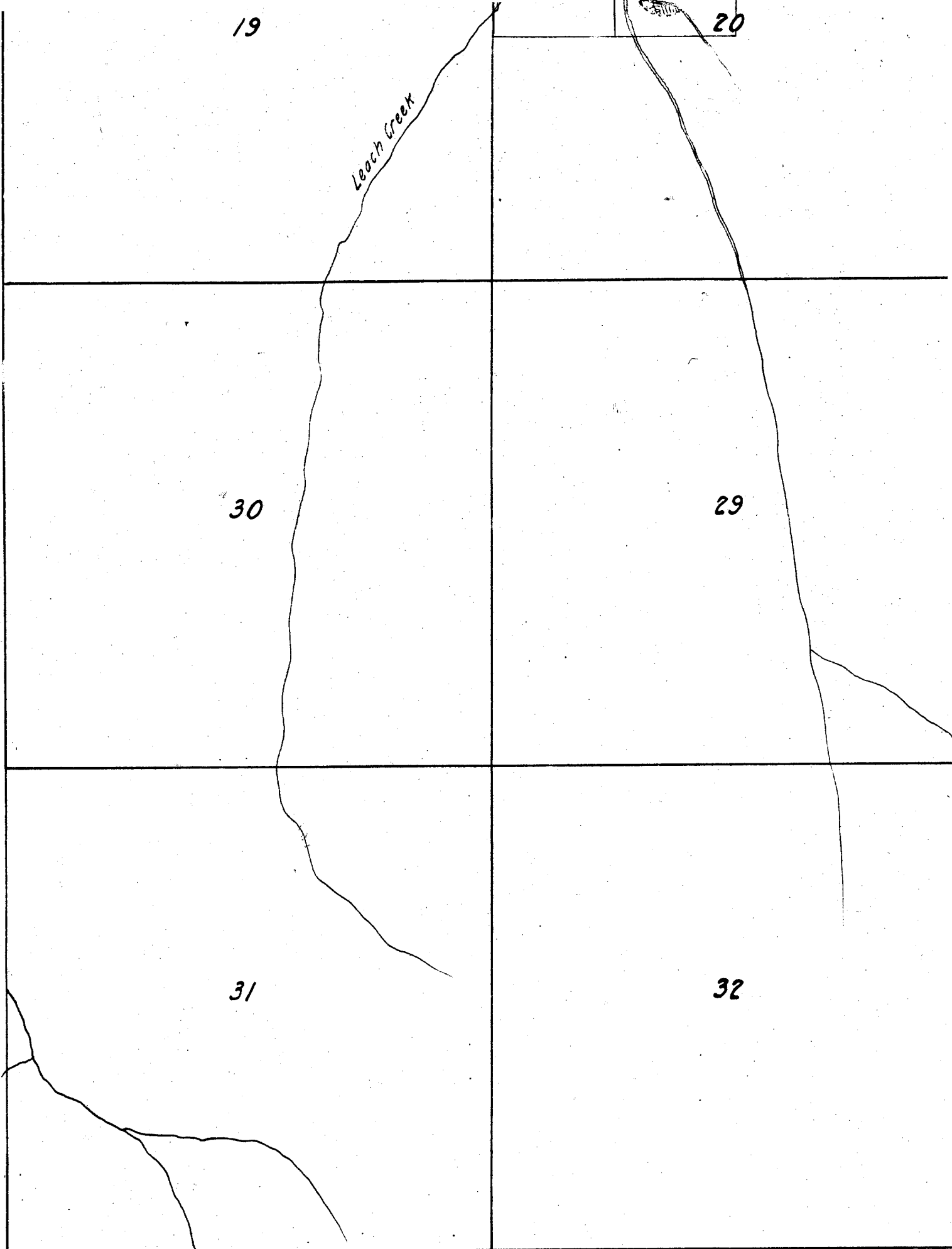

Township

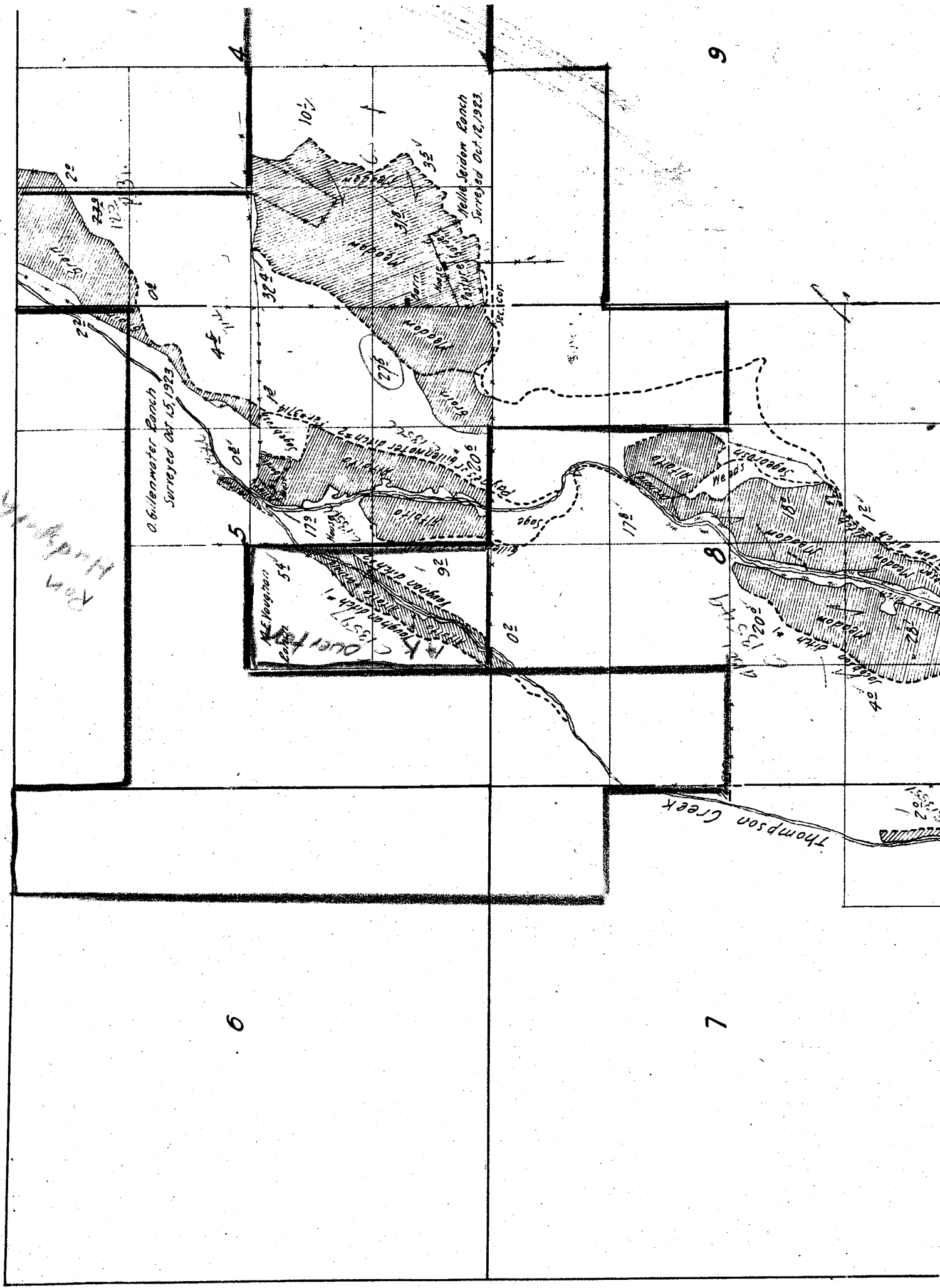

9

6

7

0.611enwater Ranch
Surveyed Oct 15, 1923

Helle Jordan Ranch
Surveyed Oct 12, 1923

Thompson Creek

M.E. Vaughan
54
M.A. C. Duetz
1937
17

RAV
HILLMAN

Sec. cor.

Sec. cor.

1/4 cor.

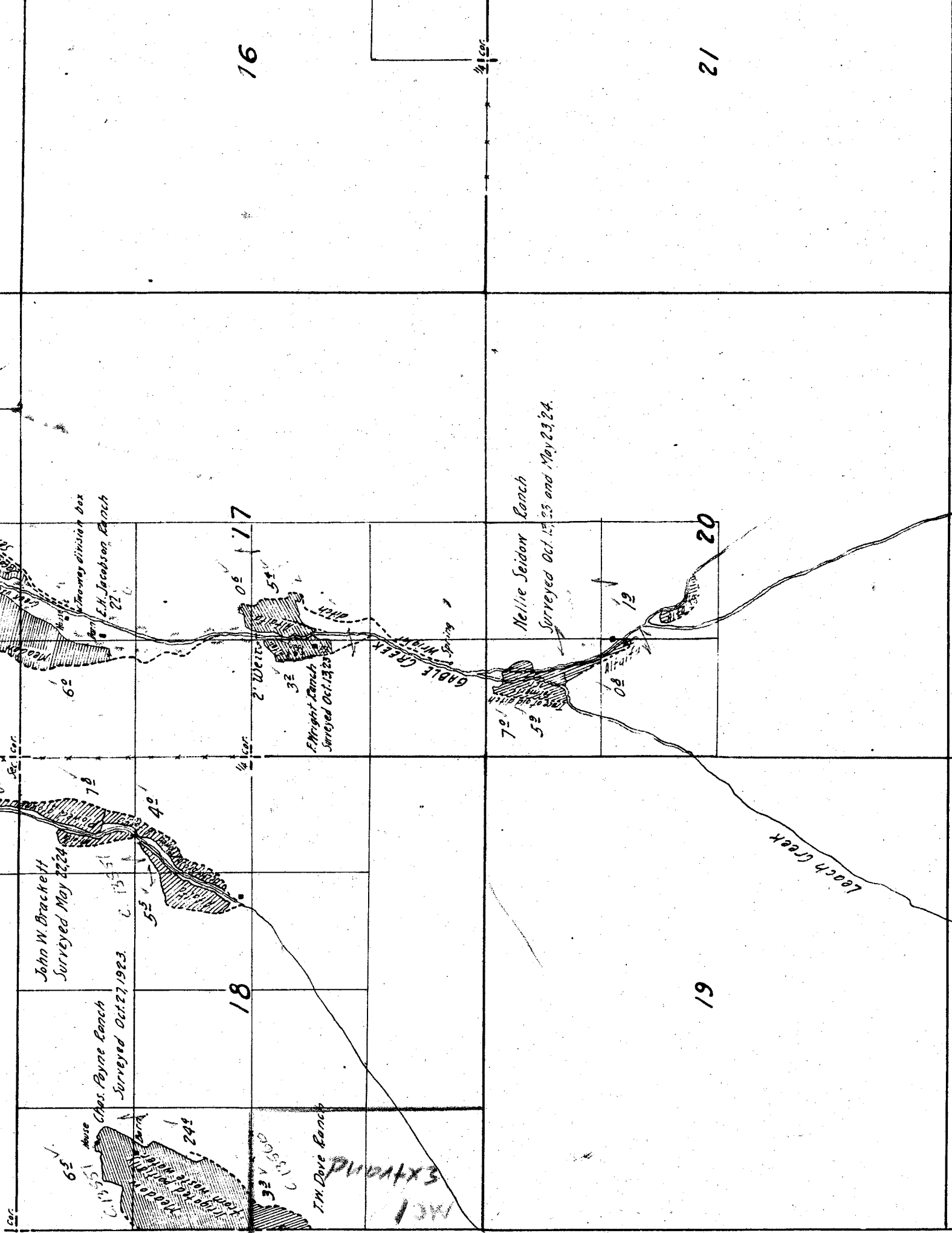

16

21

17

20

18

19

Range 21 E.

10-1-1

3

10

CM Dollarhide

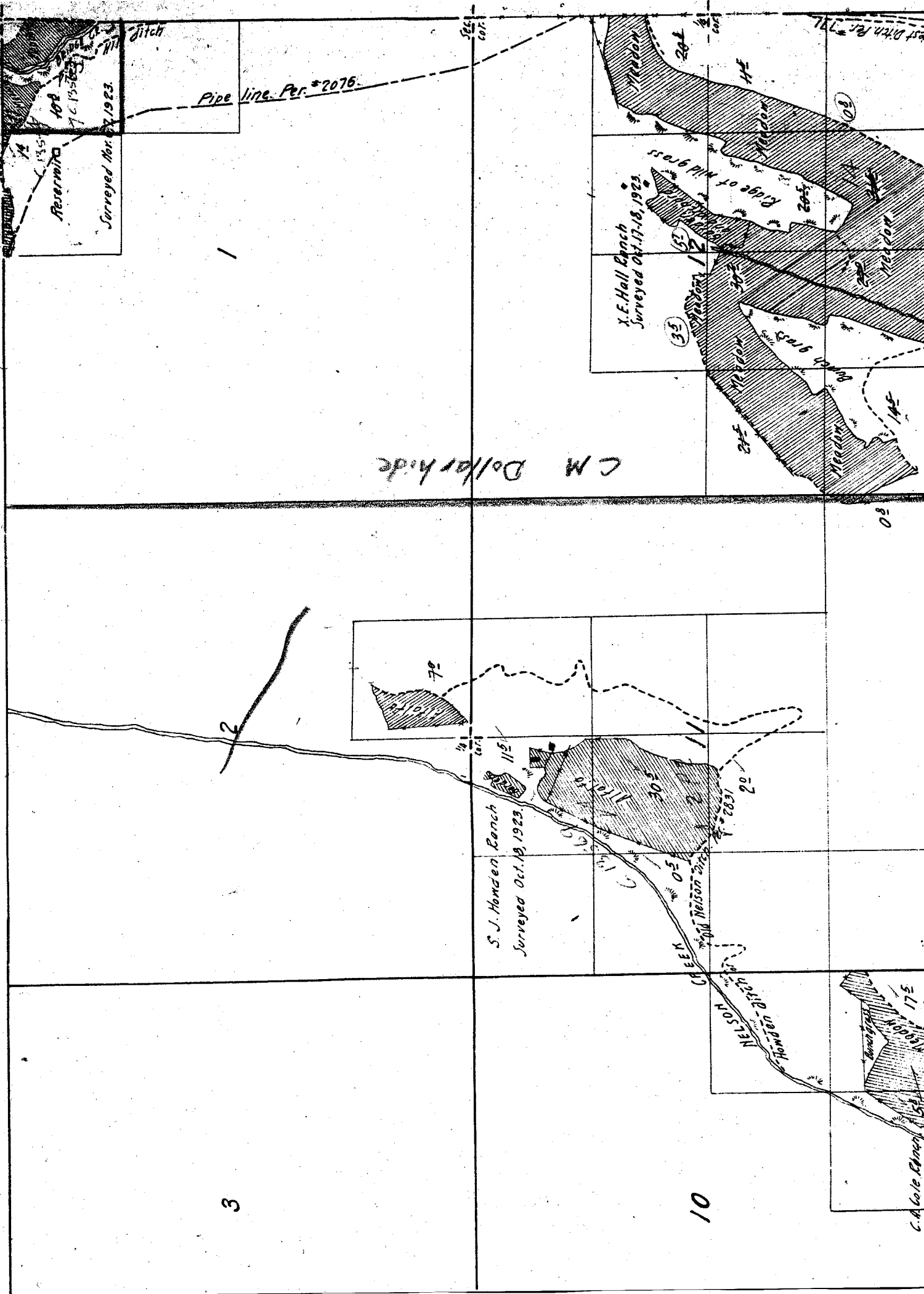

Reservoir No. 108
Surveyed Nov. 27, 1923.

Pipe line Per. #2076.

X. E. Hall Ranch
Surveyed Oct. 17-18, 1923.

S. J. Horden Ranch
Surveyed Oct. 18, 1923.

G. A. Gale Ranch

NELSON

MEADOW

MEADOW

MEADOW

MEADOW

MEADOW

MEADOW

MEADOW

MEADOW

MEADOW

MEADOW

MEADOW

MEADOW

MEADOW

MEADOW

MEADOW

MEADOW

MEADOW

MEADOW

MEADOW

MEADOW

MEADOW

MEADOW

MEADOW

MEADOW

MEADOW

MEADOW

MEADOW

MEADOW

MEADOW

MEADOW

MEADOW

MEADOW

MEADOW

MEADOW

MEADOW

MEADOW

MEADOW

MEADOW

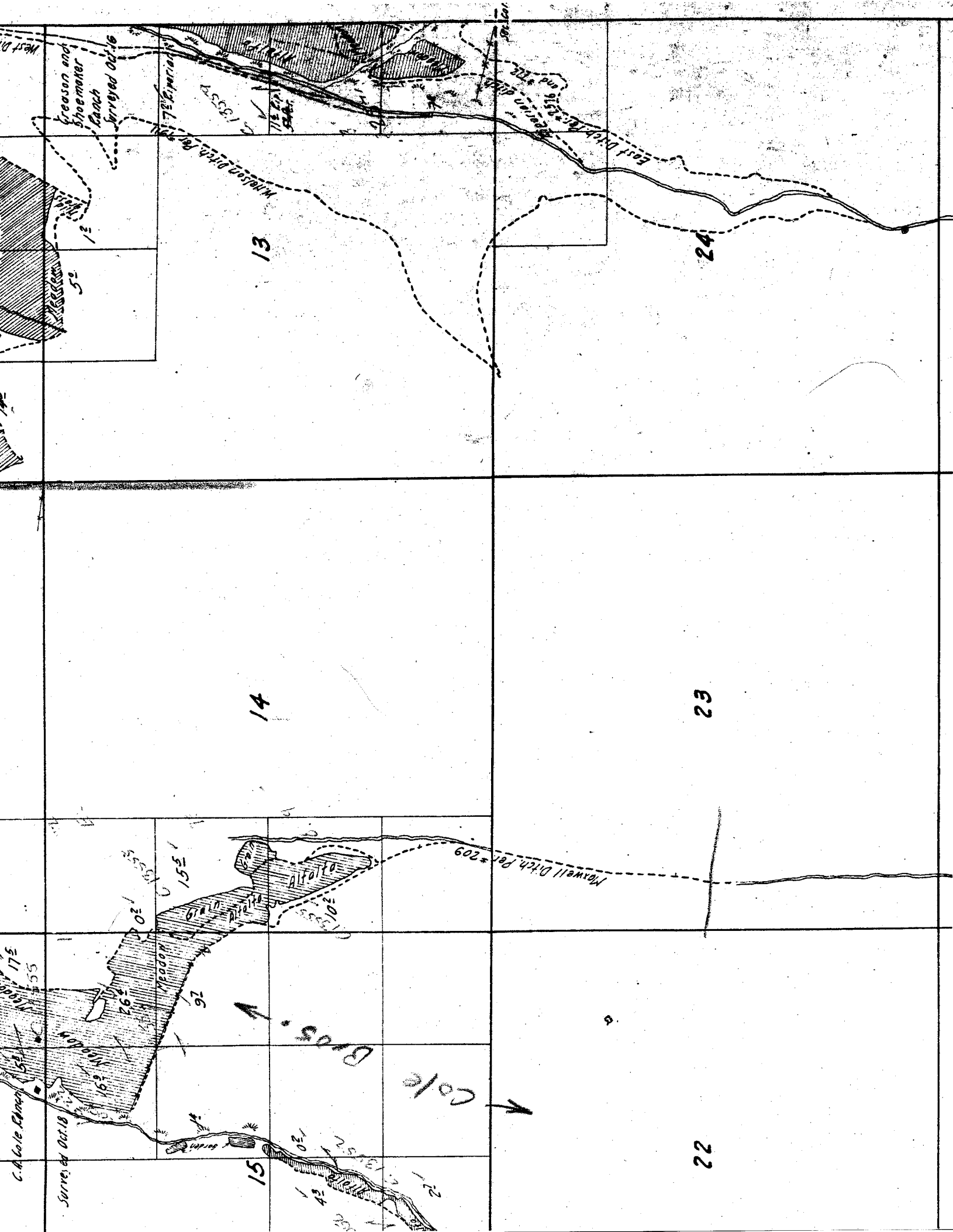

Gresson and Shoemaker Ranch Surveyed Oct. 16

C.A. Cole Ranch Surveyed Oct. 18

Wilson Ditch Per. 13537

Norwell Ditch Per. 209

Coke

Bloss

13

14

15

24

23

22

50

130

155

170

180

190

200

210

220

230

240

250

260

270

280

290

300

310

320

330

340

350

360

370

380

390

400

410

420

430

440

450

460

470

480

490

500

510

520

530

540

550

560

570

580

590

600

610

620

630

640

650

660

670

680

690

700

710

720

730

740

750

760

770

780

790

800

810

820

830

840

850

860

870

880

890

900

910

920

930

940

950

960

970

980

990

1000

Township 12 S, Range 21 E.

