

ownship

12 S,

Range

19 E.

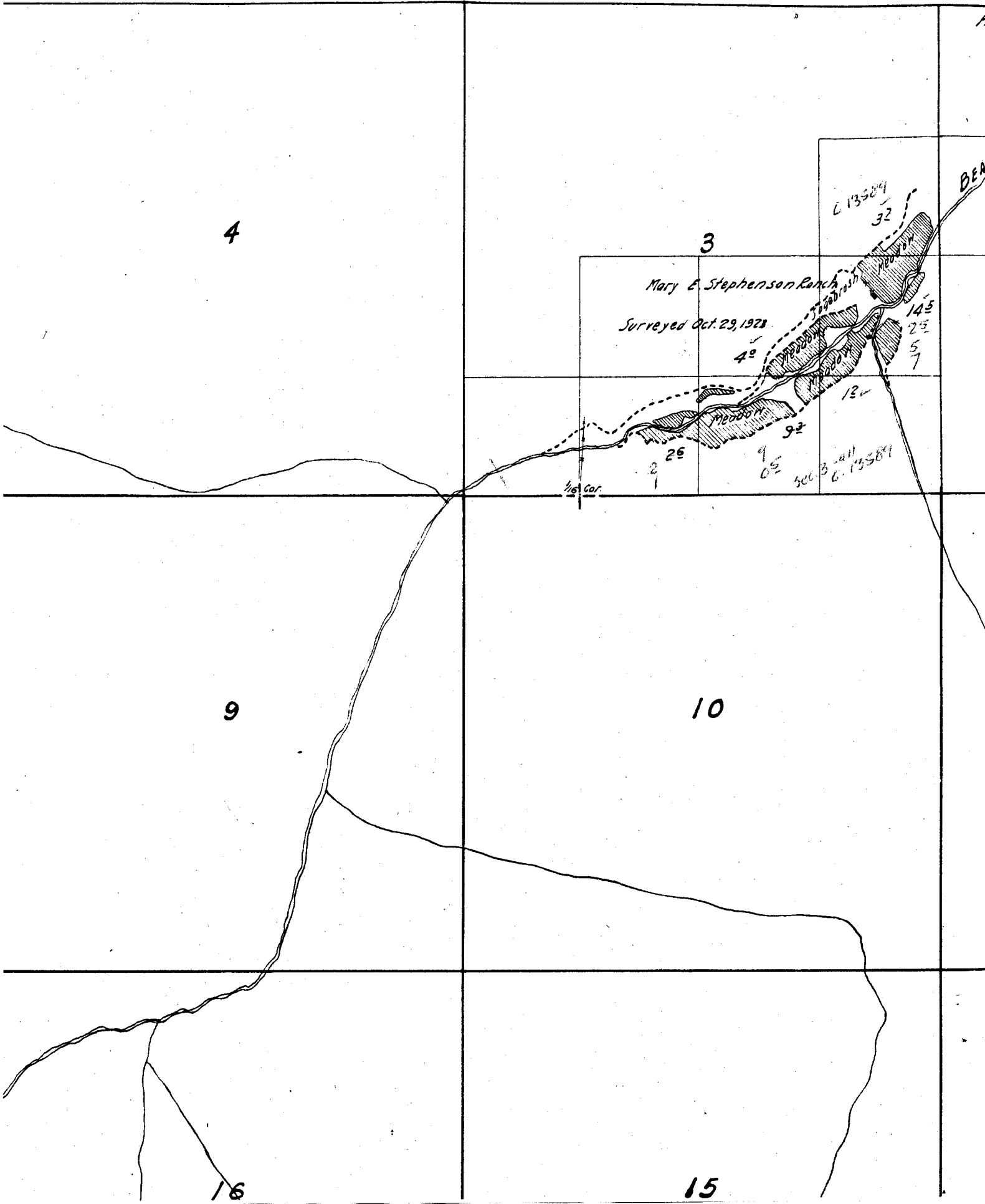

4

3

Mary E. Stephenson Ranch
Surreyed Oct. 29, 1923

C. 13584

32

DEA

40

145

25

57

12

92

25

905

sec 3 - all
C. 13584

1/4 Cor.

9

10

16

15

19

20

30

29

31

32

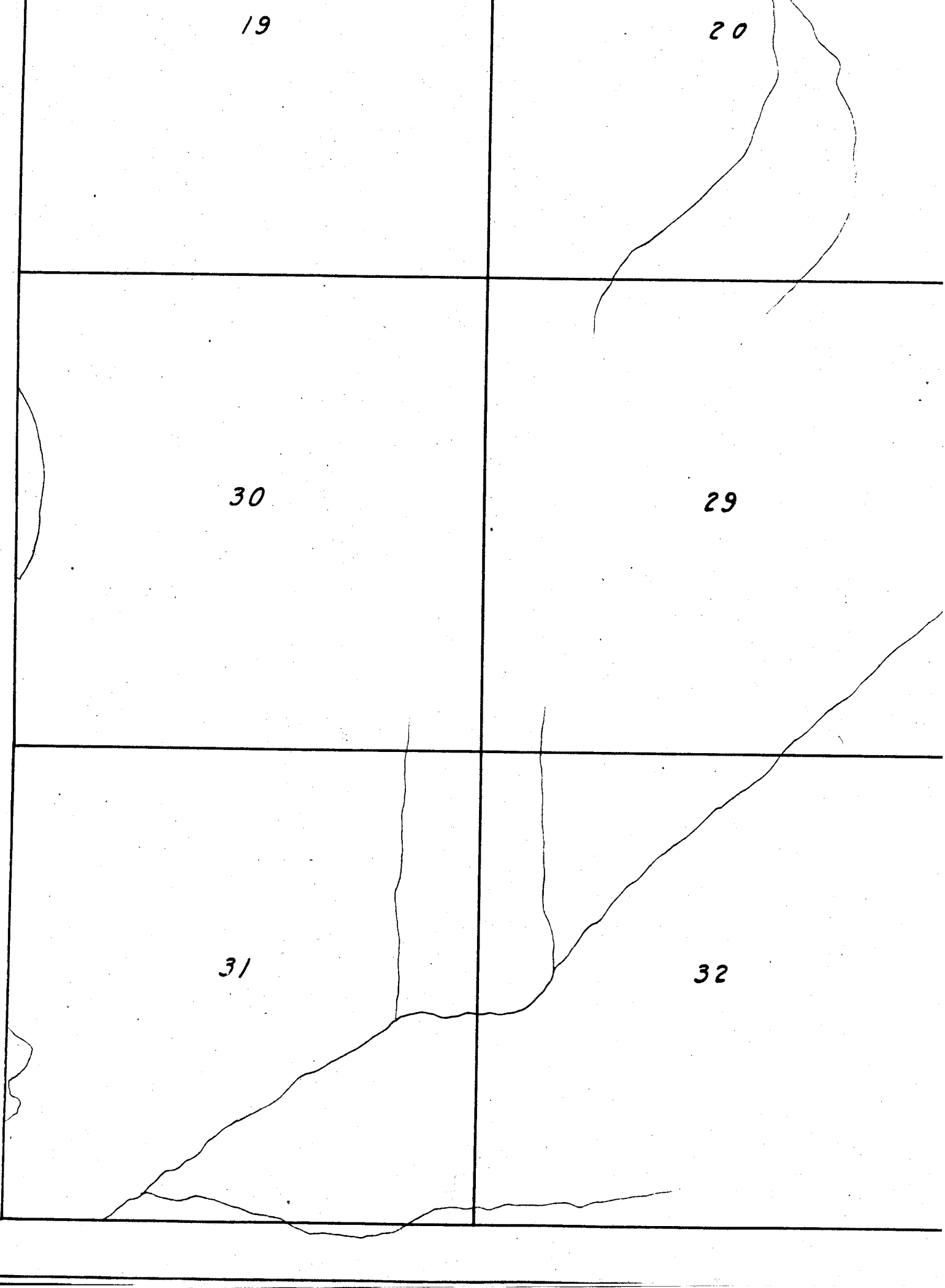

15

22

16

12

BEAR CREEK

17

20

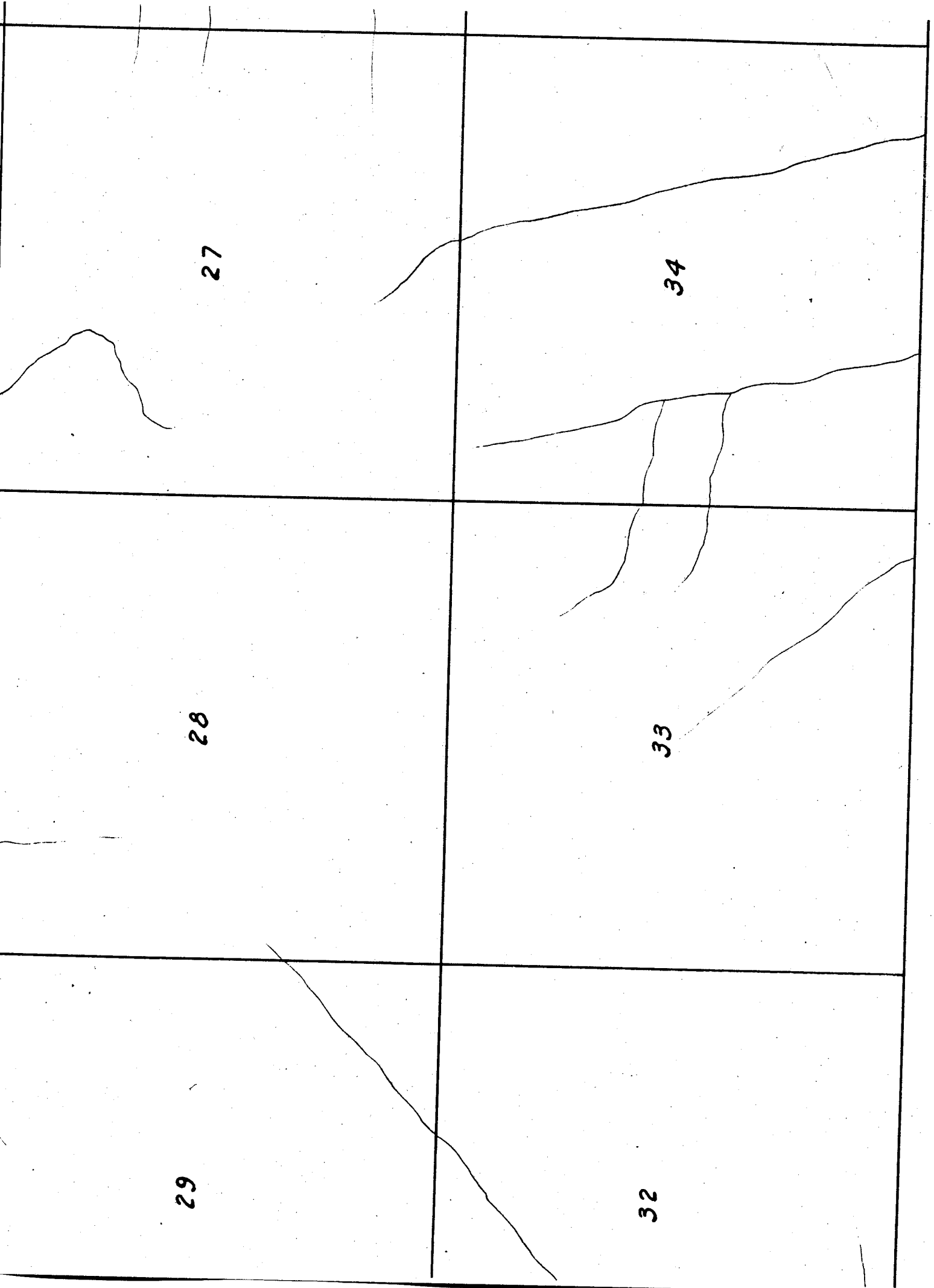

27

34

28

33

29

32

Township 1

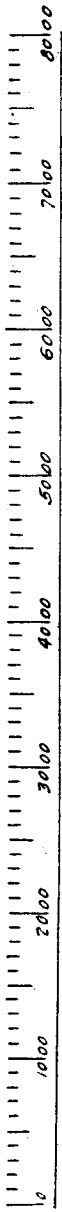

Scale of Feet.

6

5

4

N. FORK BEAR CREEK

7

8

9

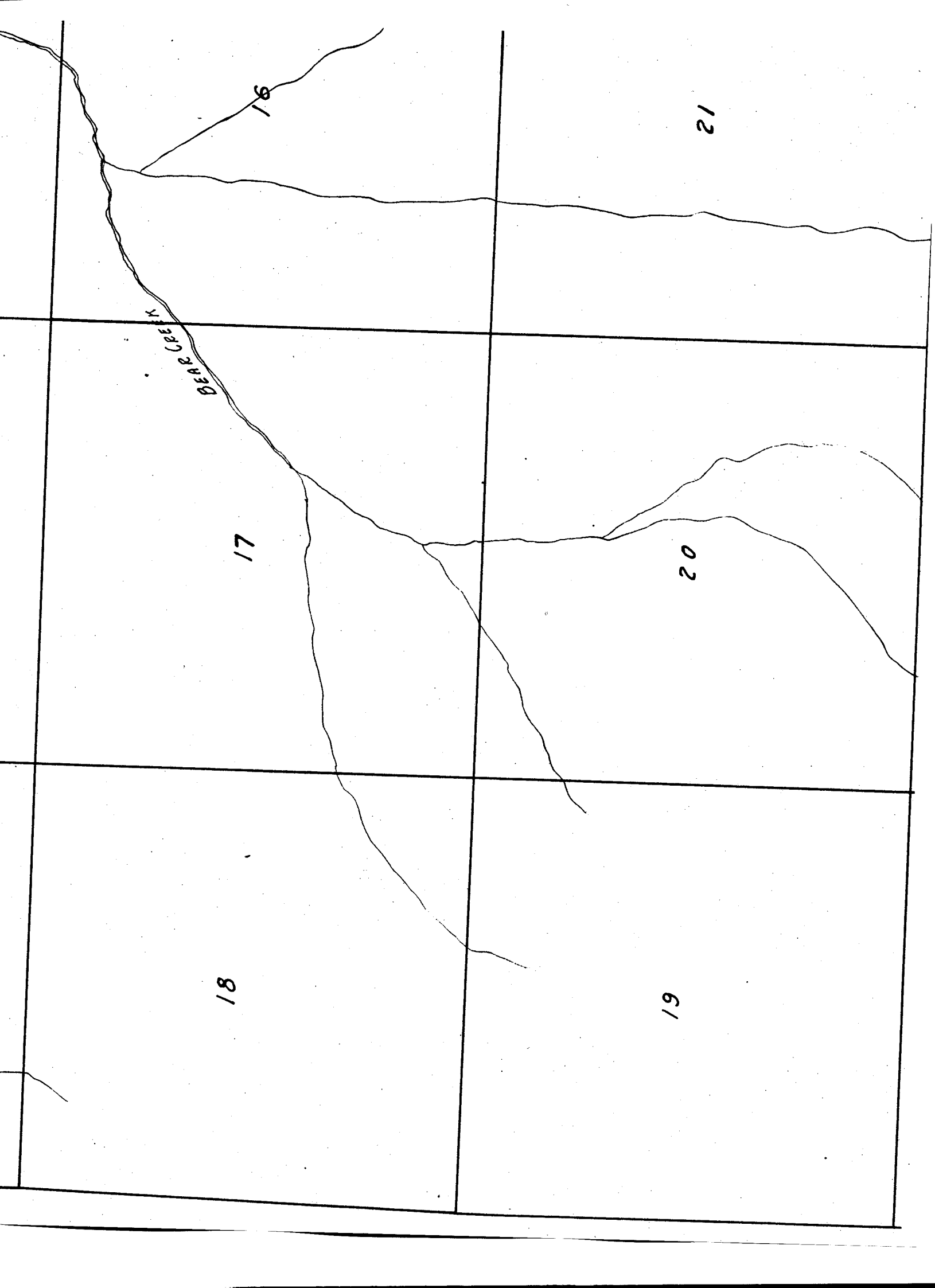

16

21

DARR CREEK

17

20

18

61

Jefferson Co.
Crook Co.

Whooler

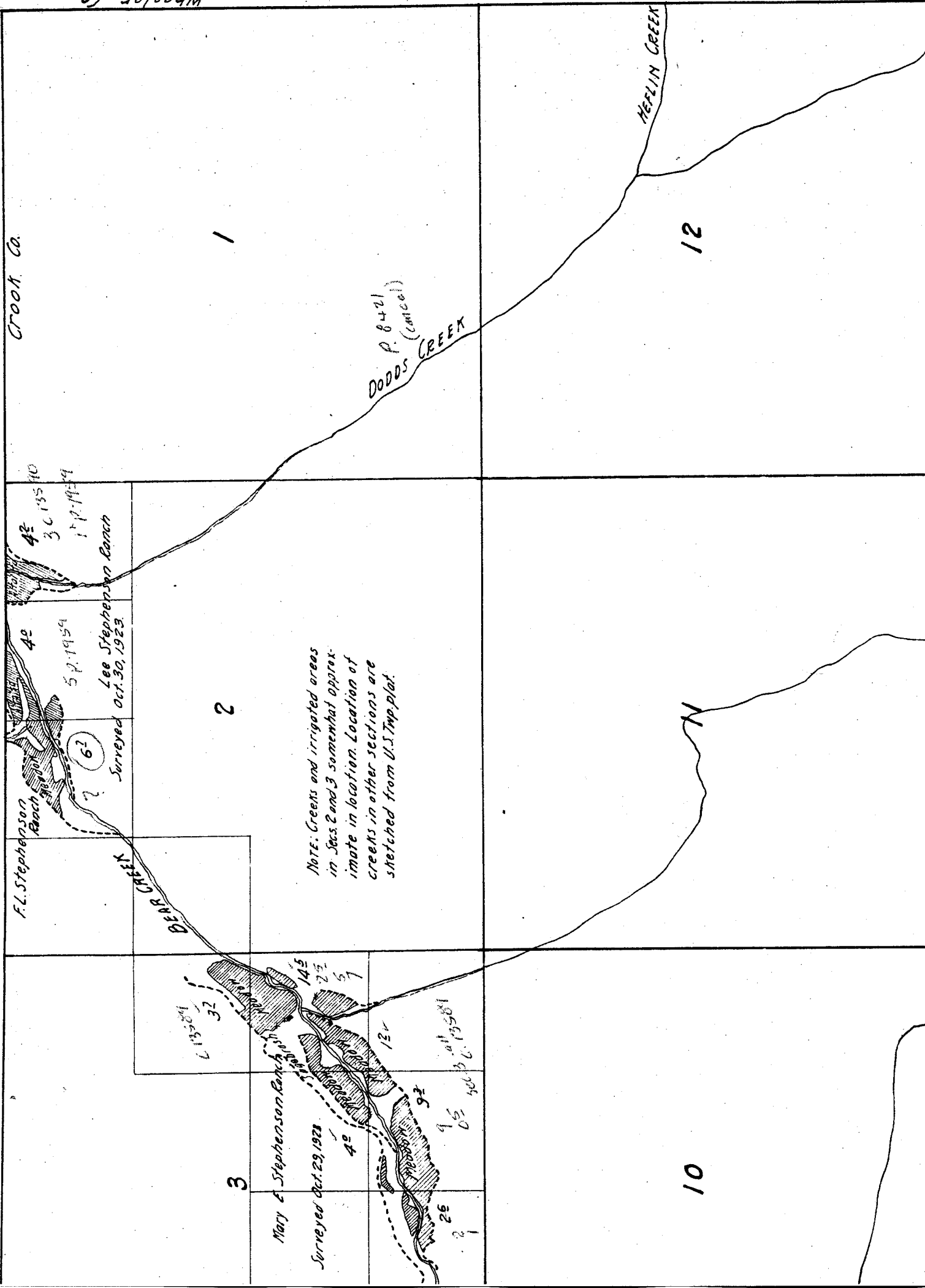

Note: Creeks and irrigated areas in Secs. 2 and 3 somewhat approximate in location. Location of creeks in other sections are sketched from U.S. Top. plat.

Lee Stephenson Ranch
Surveyed Oct. 30, 1923.

Mary E. Stephenson Ranch
Surveyed Oct. 29, 1921

F.L. Stephenson Ranch

DODDS CREEK
P. 8421
(cancel)

HEPLIN CREEK

F.L. STEPHENSON CREEK

13

24

14

23

15

22

14

23

13

24

Surveyed Oct 31, 1923

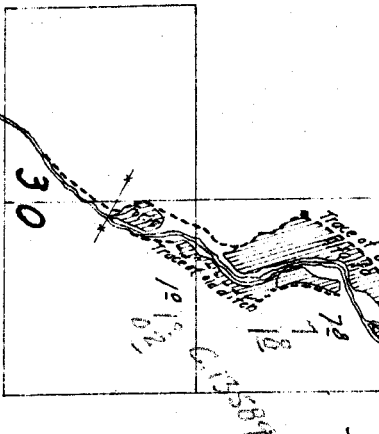

30

29

28

31

32

33

Oct 31, 1923

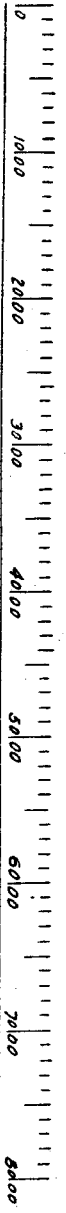

Scale of Feet

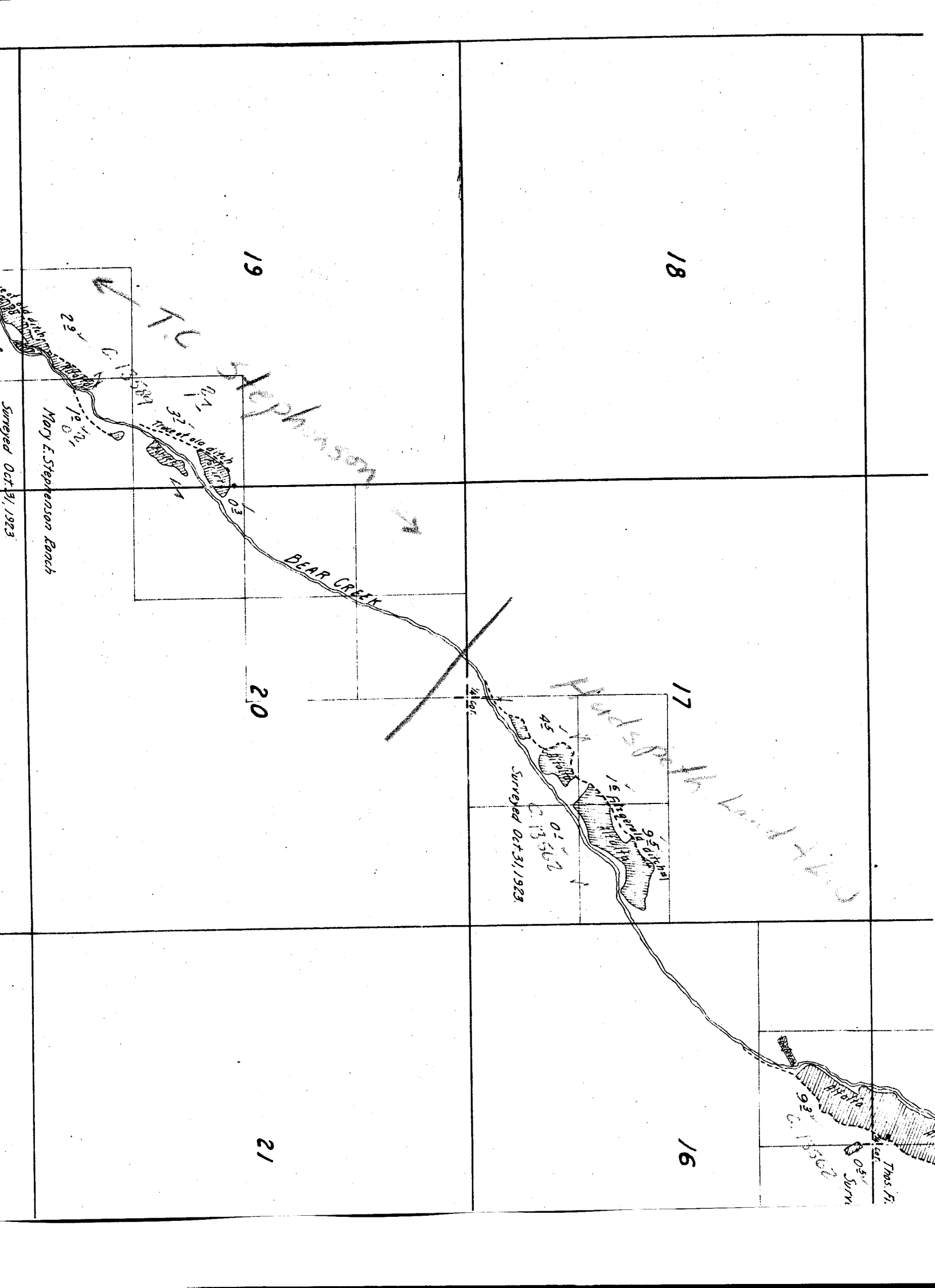

Township

11 S,

Range

20 E.

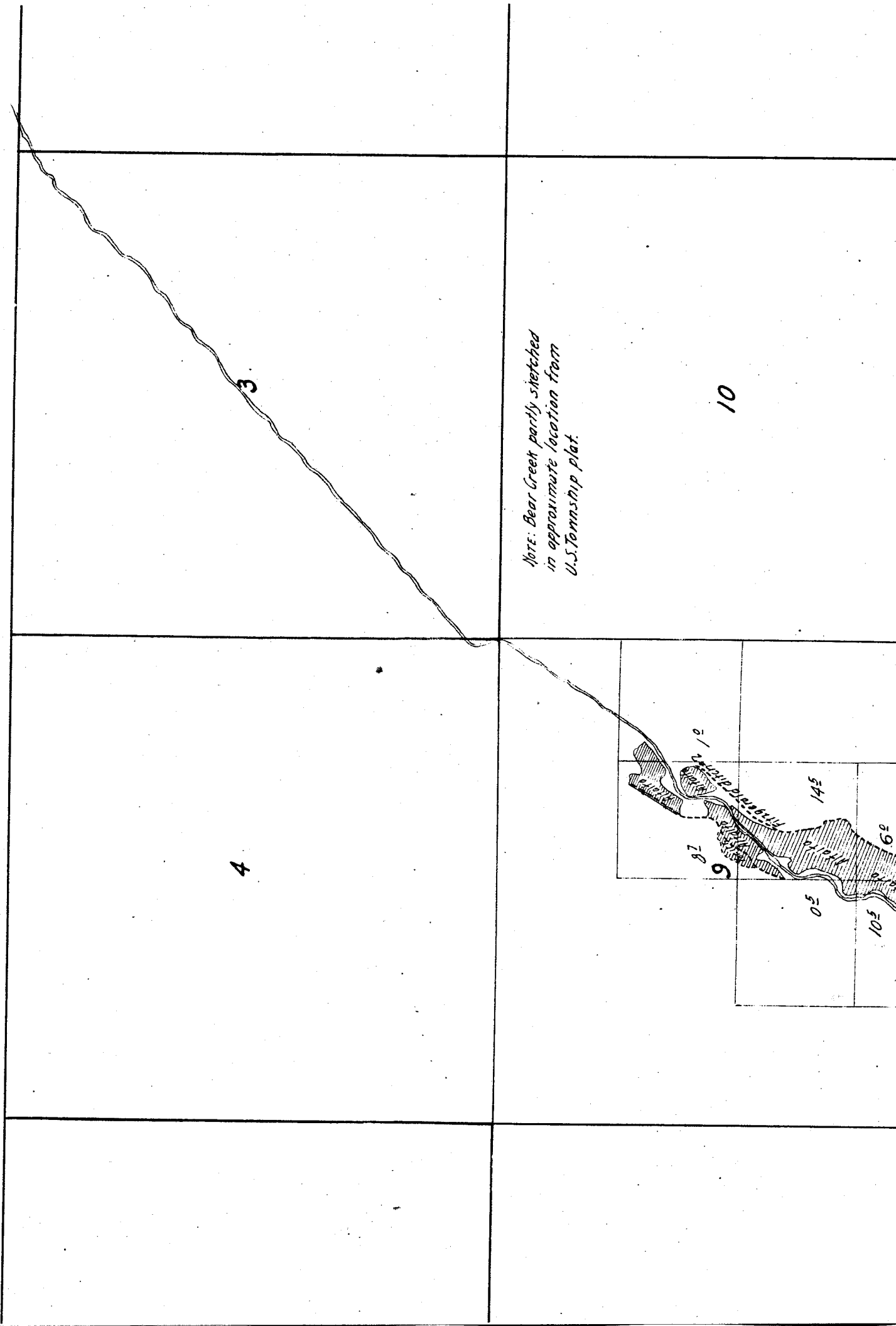

3

4

10

*Note: Bear Creek partly sketched
in approximate location from
U.S. Township plat.*

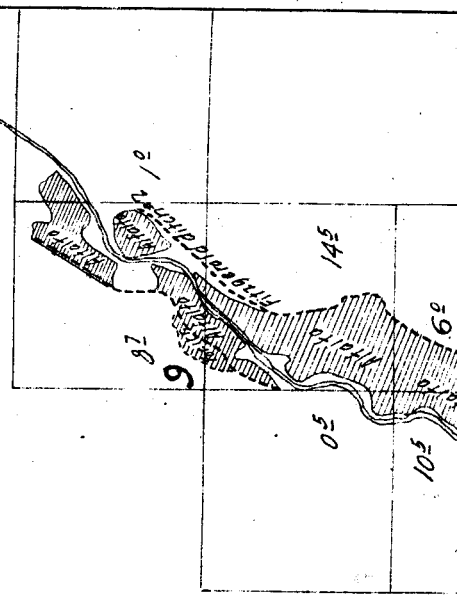

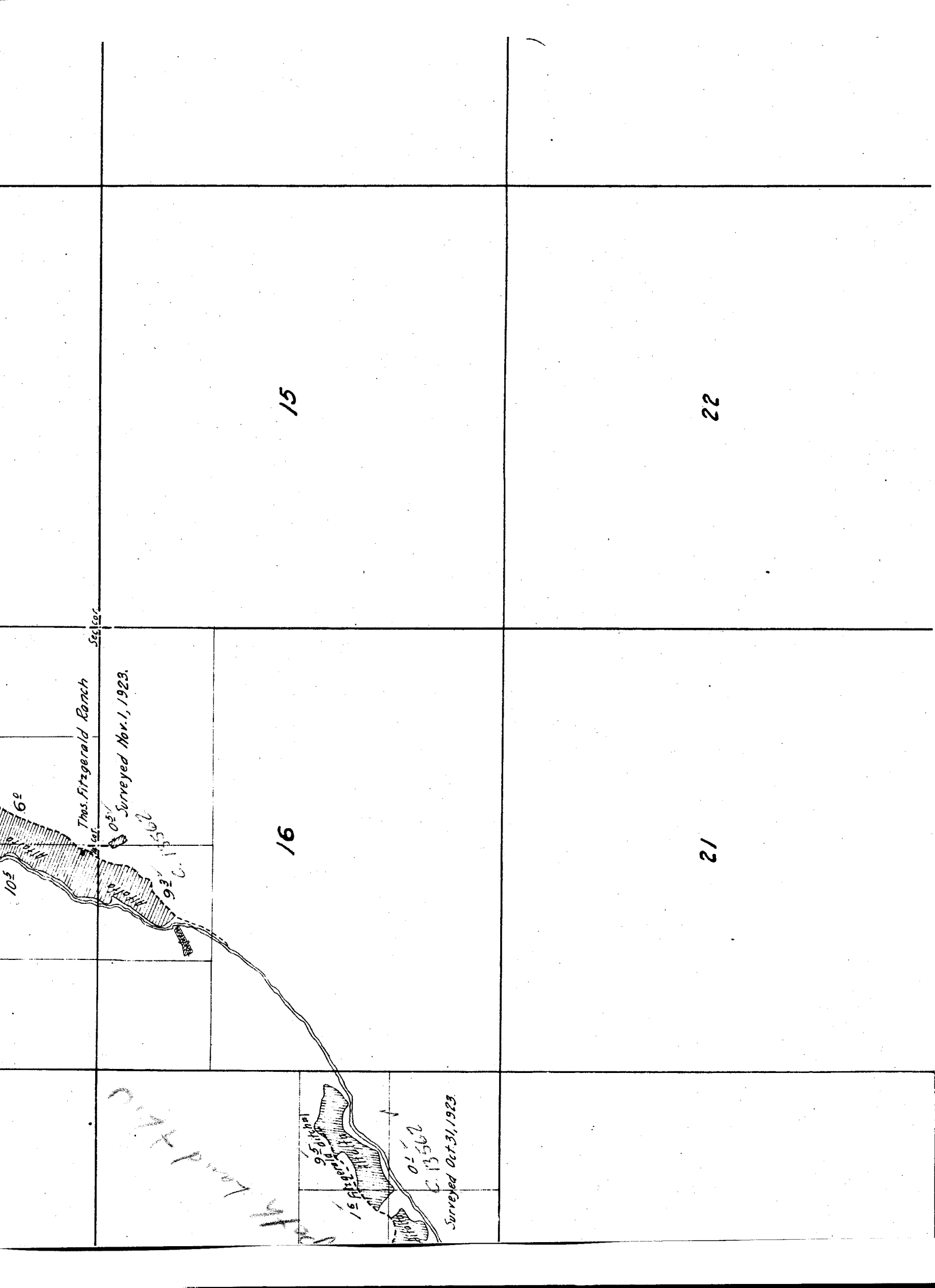

15

22

12

16

Thos. Fitzgerald Ranch

Surveyed Nov. 1, 1923.

10° 5'

6°

0° 5'

9° 2'

C. 13562

14

9° 5'

0° 1'

C. 13562

Surveyed Oct. 31, 1923

14

13

11

12

2

1

6

5

7

8

18

17

15 path land + 1/2 in
95 ditch

21

22

28

27

Dem
P. 4785

Dem
P. 3344

Dem
P. 3302

33

34

23

24

26

25

35

36

x Dom.
P. 21586