

TRANSFER APPLICATION
HISTORIC CHANGE IN POINT OF DIVERSION
ADDITIONAL POINT OF DIVERSION
CERTIFICATES 13893 & 7166
TOWNSHIP 39 SOUTH, RANGE 8 WEST, W.M.
JOSEPHINE COUNTY OREGON

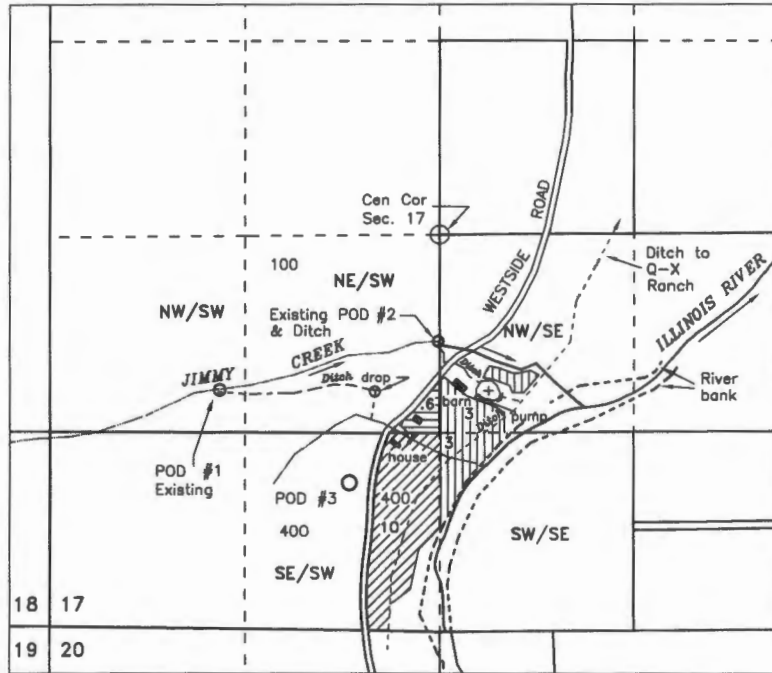

RECEIVED BY OWRD

AUG 31 2016

SALEM, OR

POD #1 (Authorized)- NW/SW SECTION 17, 1050 FEET SOUTH & 1500 FEET WEST FROM THE CENTER CORNER OF SECTION 17 T.39S. R.8W., WM*

POD #2 (Additional)- NE/SW SECTION 17, 730 FEET SOUTH & 15 FEET WEST FROM THE CENTER CORNER OF SECTION 17 T.39S. R.8W., WM

POD #3 - SE/SW SECTION 17, 1020 FEET NORTH, 600 FEET WEST FEET WEST FROM THE SOUTH 1/4 CORNER OF SECTION 17 (From application S- 7473 and map. Does not exist;there is no stream here)

*POD 1 is assumed to be the original diversion for both certificates

RECEIVED BY OWRD

SEP 30 2016

SALEM, OR

C-13893



Irrigation of 6.0 Acres (1888)
POD not shown on Adjudication Map

C-13893



Remaining Right (BLM)
Irrigation of 0.6 Acres (1888)

C-7166



Irrigation of 10.0 Acres (8/18/1920)
POD not listed on certificate

Applicant:

James B. and Jennifer Darby
3561 Eastwind Drive
Anchorage, AK 99516



BASE MAP:

2005 FSA and 7/27/2015 Oregon Map aerial photos over County GIS tax lots - adjusted & Oriented to 10/30/1981 BLM survey for assumed best fit

POD 2 based on BLM bearing tree 9/18/84

This map is not intended to provide legal dimensions or locations of property ownership lines

Scale

1 inch = 1320 feet



Drawn 7/25/2016 n.e.d.

1 12495

