

11 883  
11/11/12  
map 1 of 3

MAP

To accompany the application of Cornelius Lynch.

#1 of 3 maps - A-15692  
Q-11883

I, R.H. Rogers, of Lakeview, Oregon, do hereby certify that this map was made from notes taken during an actual survey made by me on May 23, 1935 and that it correctly represents the works described in the accompanying application together with the location of streams and other ditches in the immediate vicinity.

*R.H. Rogers*  
REGISTERED PROFESSIONAL ENGINEER,  
OREGON NUMBER 789,  
DECEMBER 31, 1919.

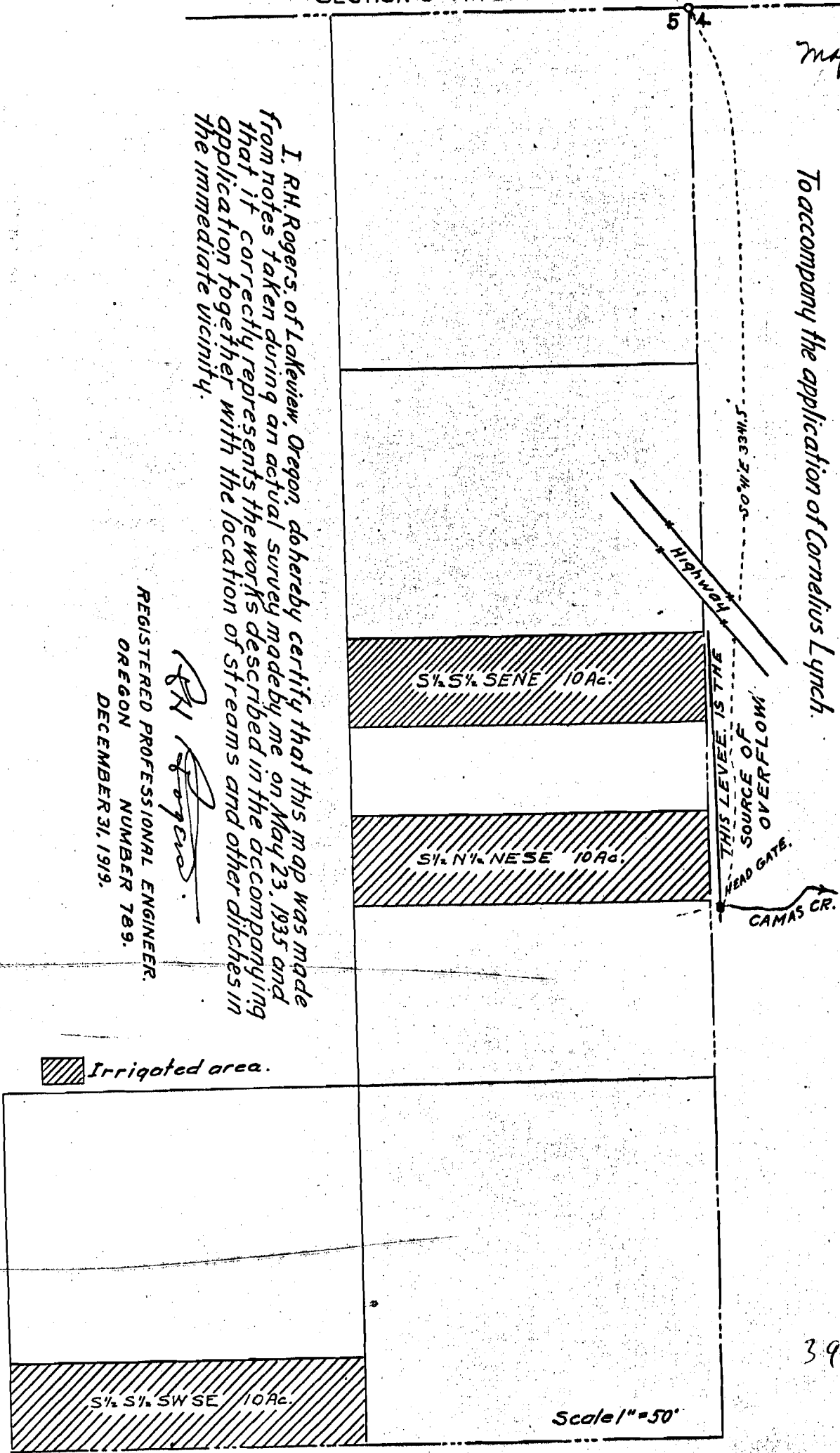

Irrigated area.

Scale 1" = 50'

39-21 ✓

NA