

SECTION

NW 1/4, SE 1/4 NW 4
S. 15
Lot # 6
Tract E-1

Corrected by A. W. Hunter

C-14155

RECEIVED

SEP 25 1937
STATE ENGINEER
SALEM, OREGON

TOWNSHIP 23 S, RANGE 6 E, W. M.

North

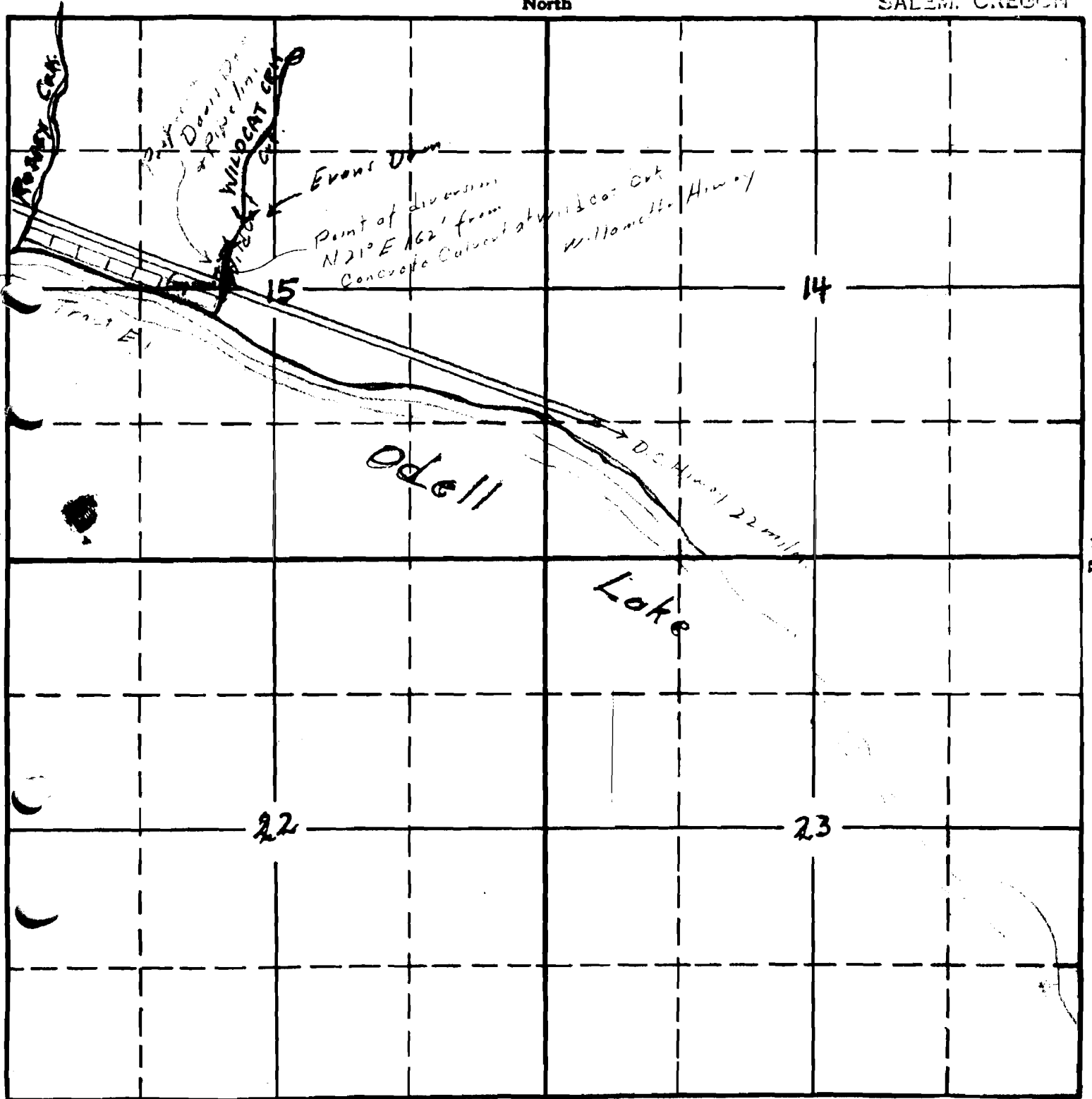

South

RECEIVED
SEP 16 1937
STATE ENGINEER
SALEM, OREGON

RECEIVED
SEP 16 1937
STATE ENGINEER
SALEM, OREGON

APPLICATION No. 17096
PERMIT No. 12770

12770