

SECTION

20

TOWNSHIP 35S, RANGE 3W, W. M.

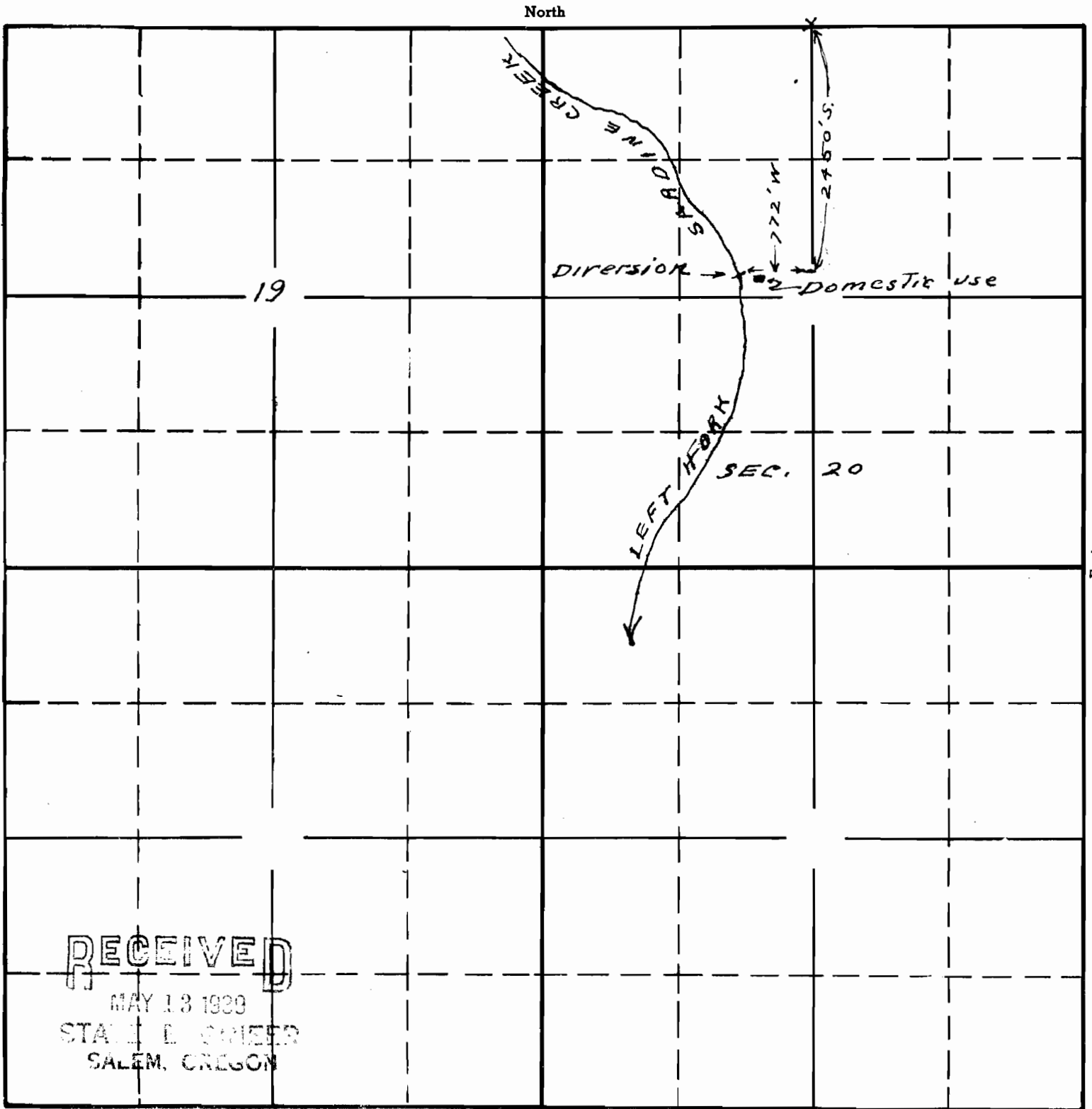

RECEIVED

MAY 18 1939  
STANLEY D. SHEER  
SALEM, OREGON

18039 ac  
15-76

APPLICATION No. 18039

PERMIT No. 13844

Sketch showing point of diversion and place of use to accompany application of Mrs Irene Moreland for use of waters of Left Fork of Sardine Creek.

Measurements furnished by Mrs I.M.

This office 5/11/39 *[Signature]*