

Township 2 S.

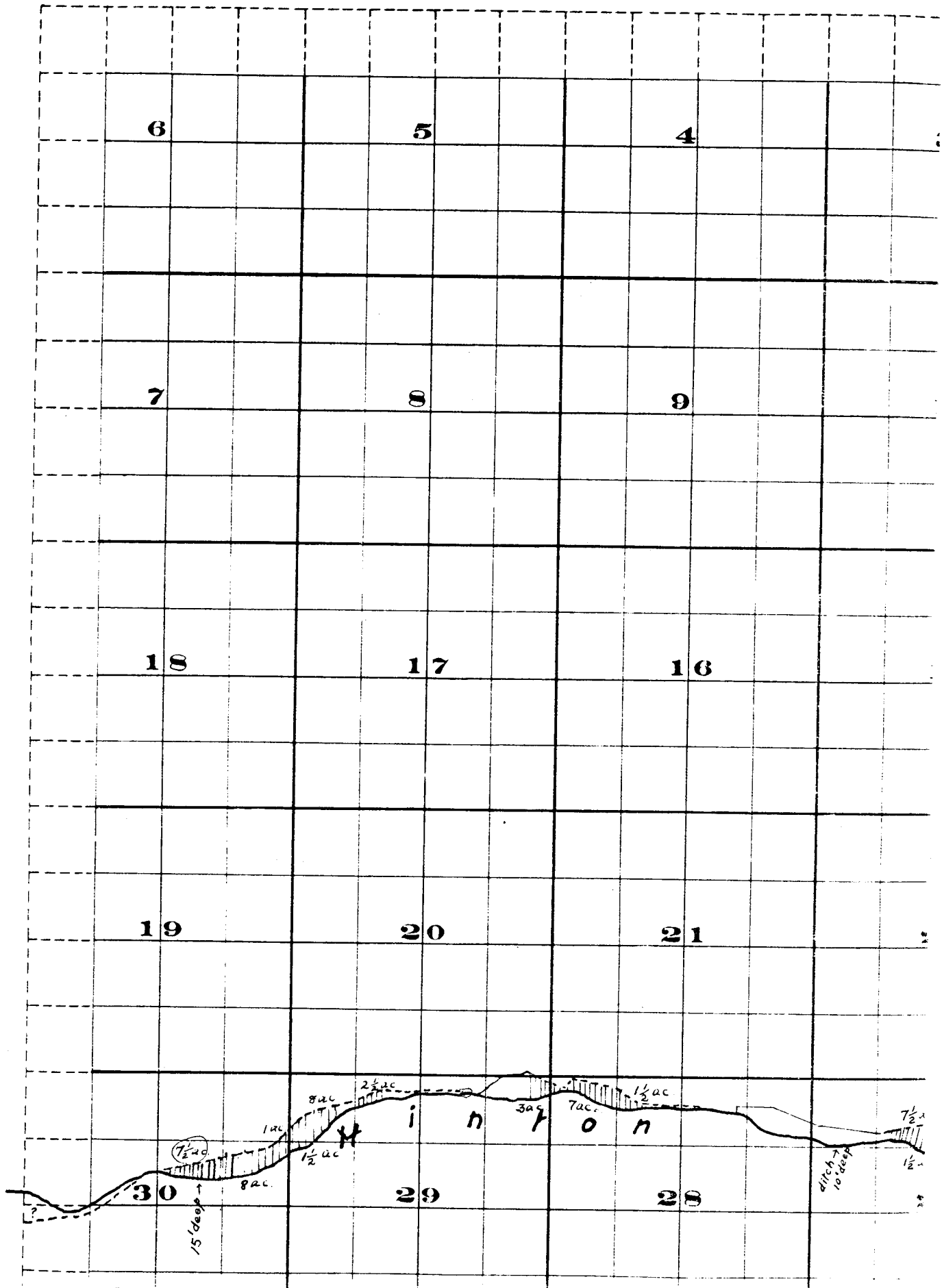

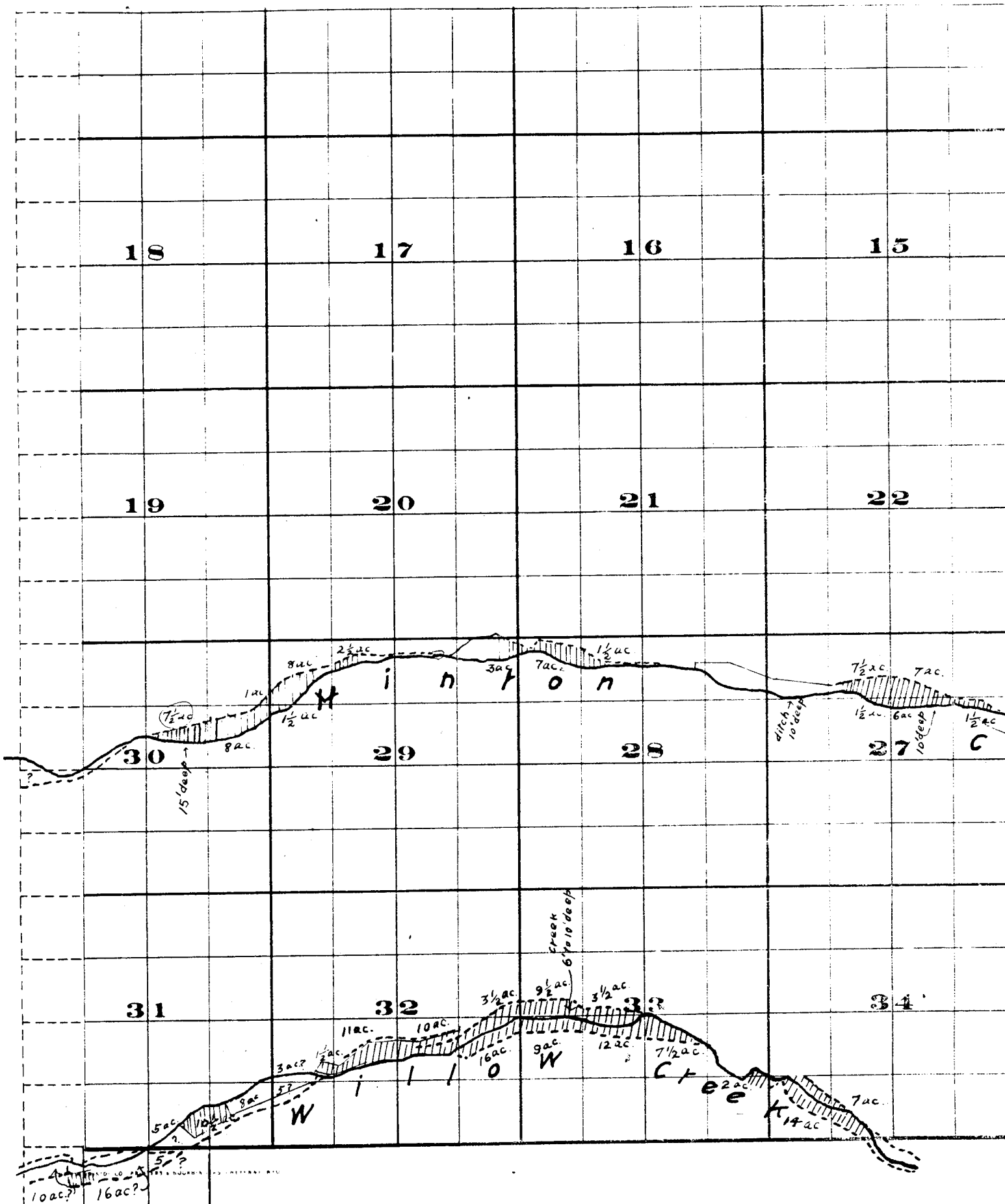

Surveyed by H. K. Donnelly & D. D. Cooper July
 John H. Lewis - State Engineer
 Examined July 14, 1909.

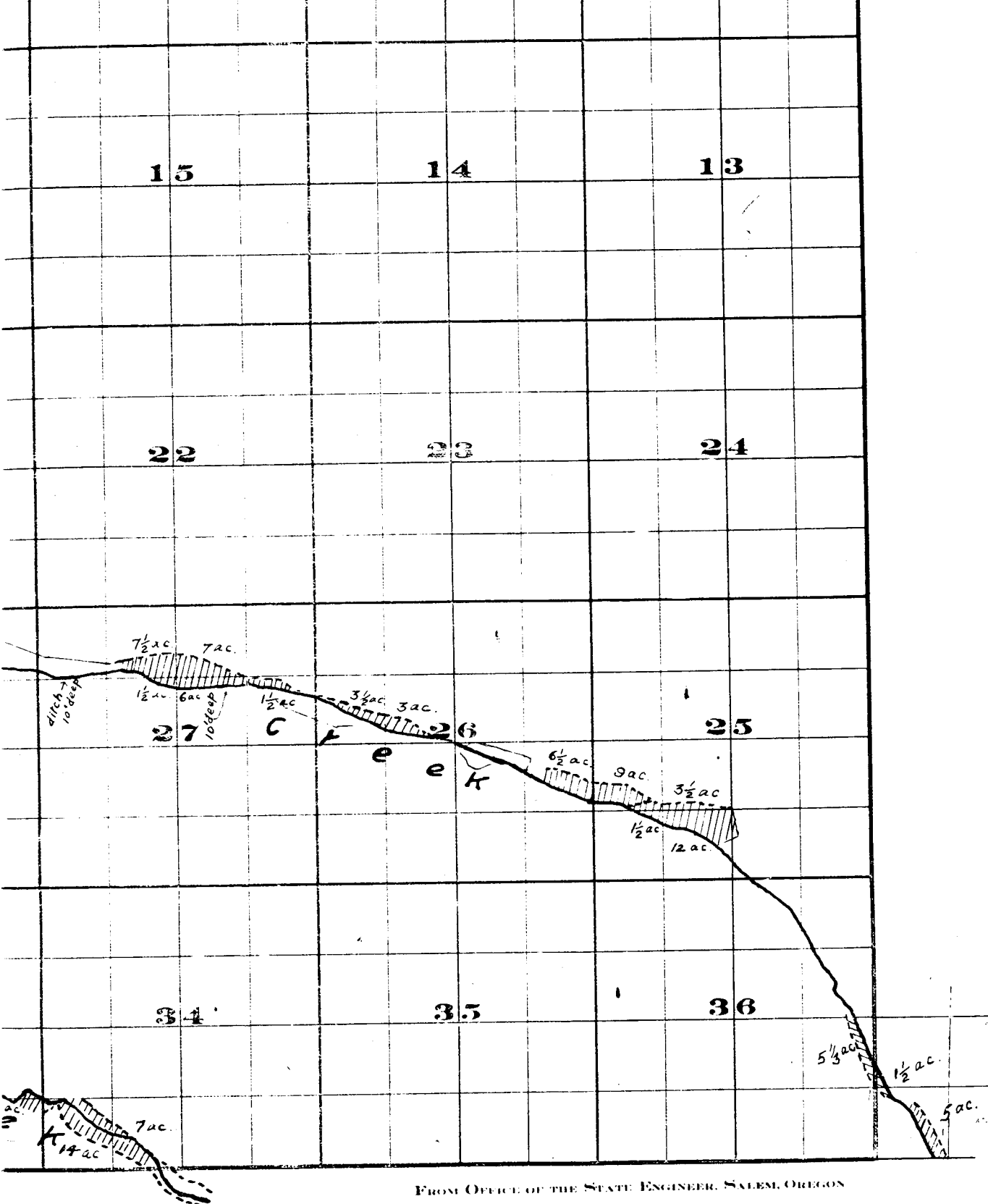

FROM OFFICE OF THE STATE ENGINEER, SALEM, OREGON

per
the Engineer

July 1909

Willow Creek Adjudication

25.27 L
Part 2 S. 28 E
Part 3 S. 27 E

31

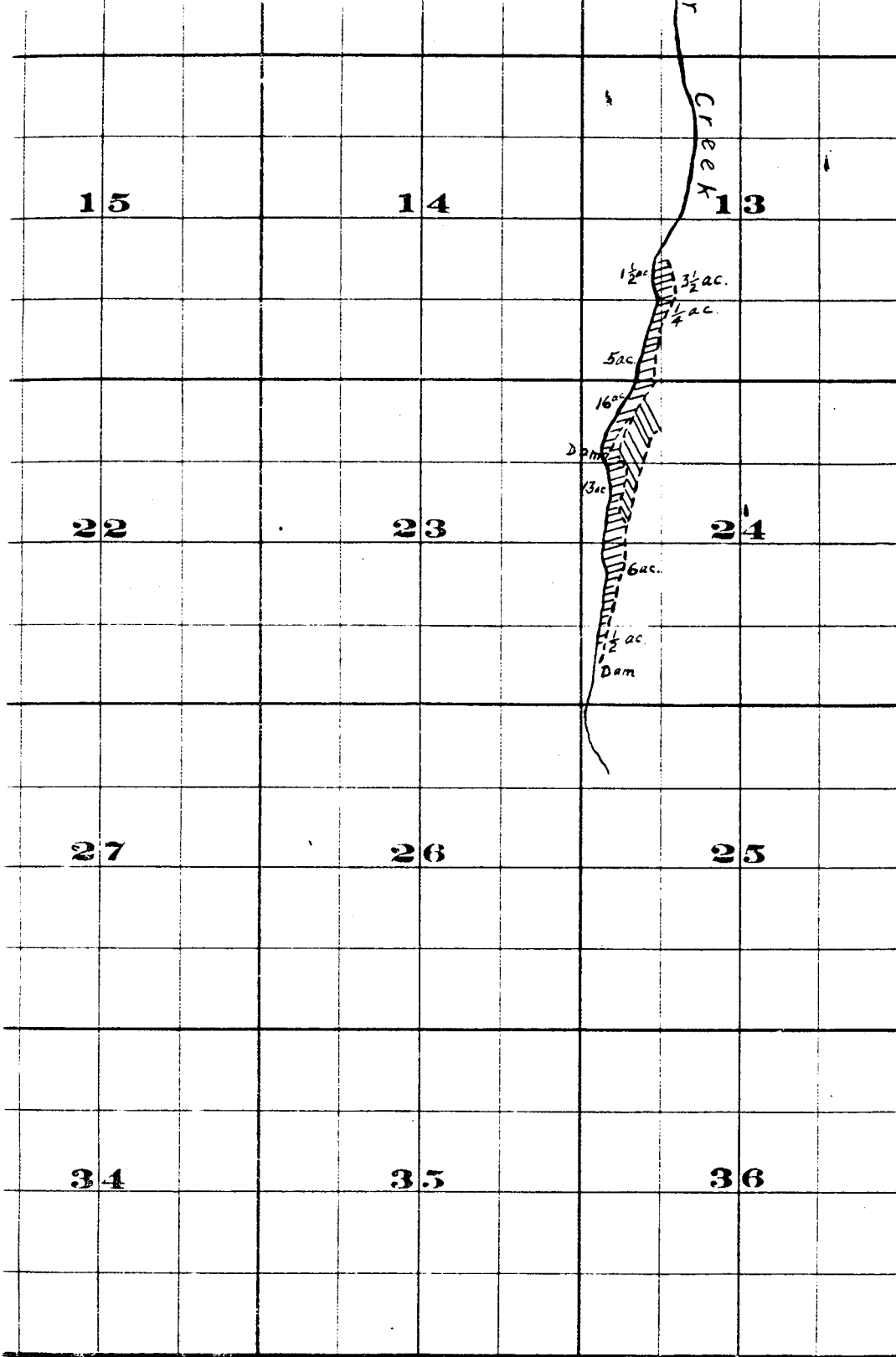

FROM OFFICE OF THE STATE ENGINEER, SALEM, OREGON
Willow Creek Adjudication

35.27E.

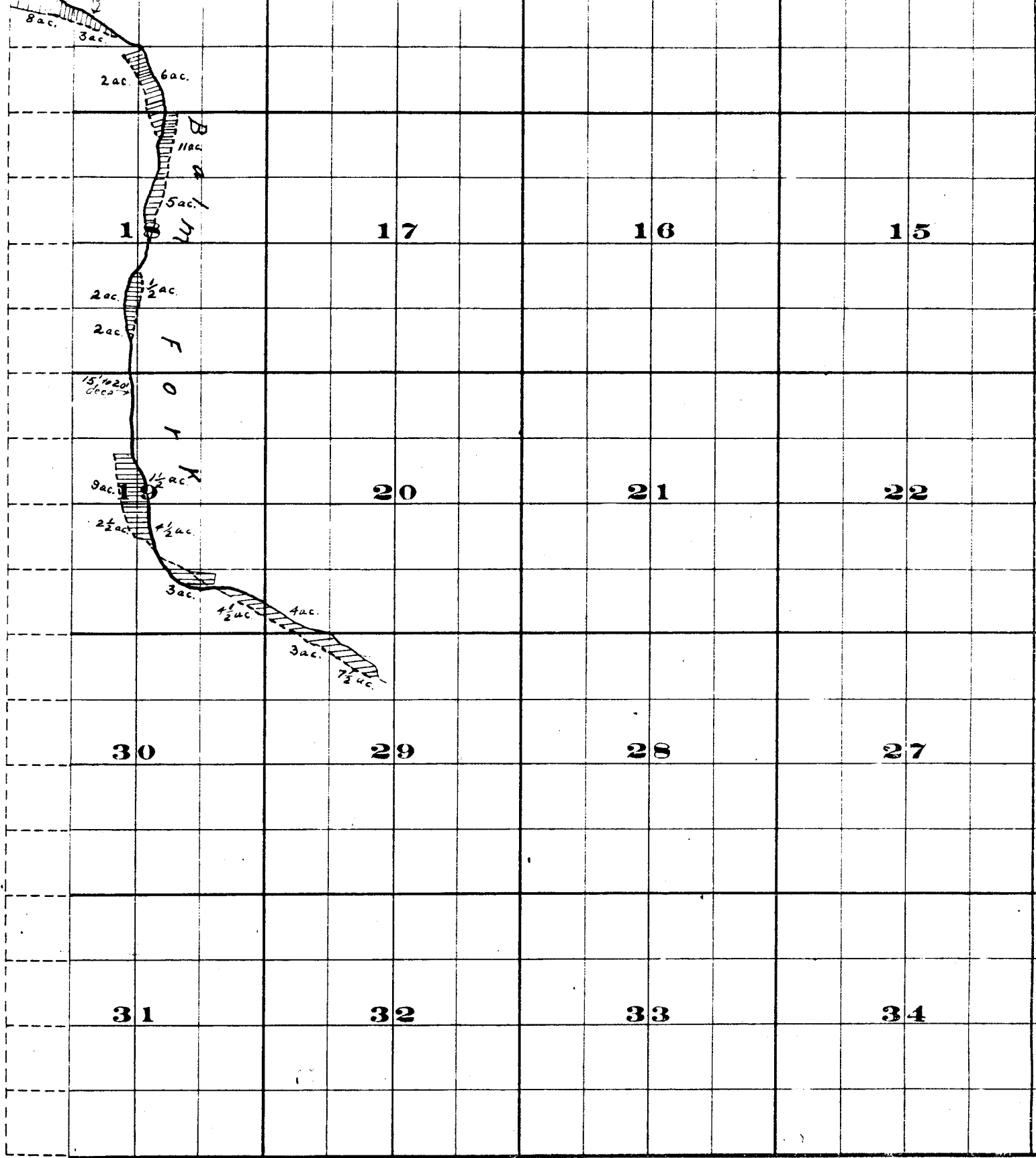

THE SA BRISTOL CO. PRINTERS & BOUNDERS CHIFFENEL WYV

Surveyed by H.K. Donnelly July 1909
 Surveyed by R.D. Cooper July 1909
 John H. Lewis - State Engineer
 Examined, July 14, 1909.

Township 37

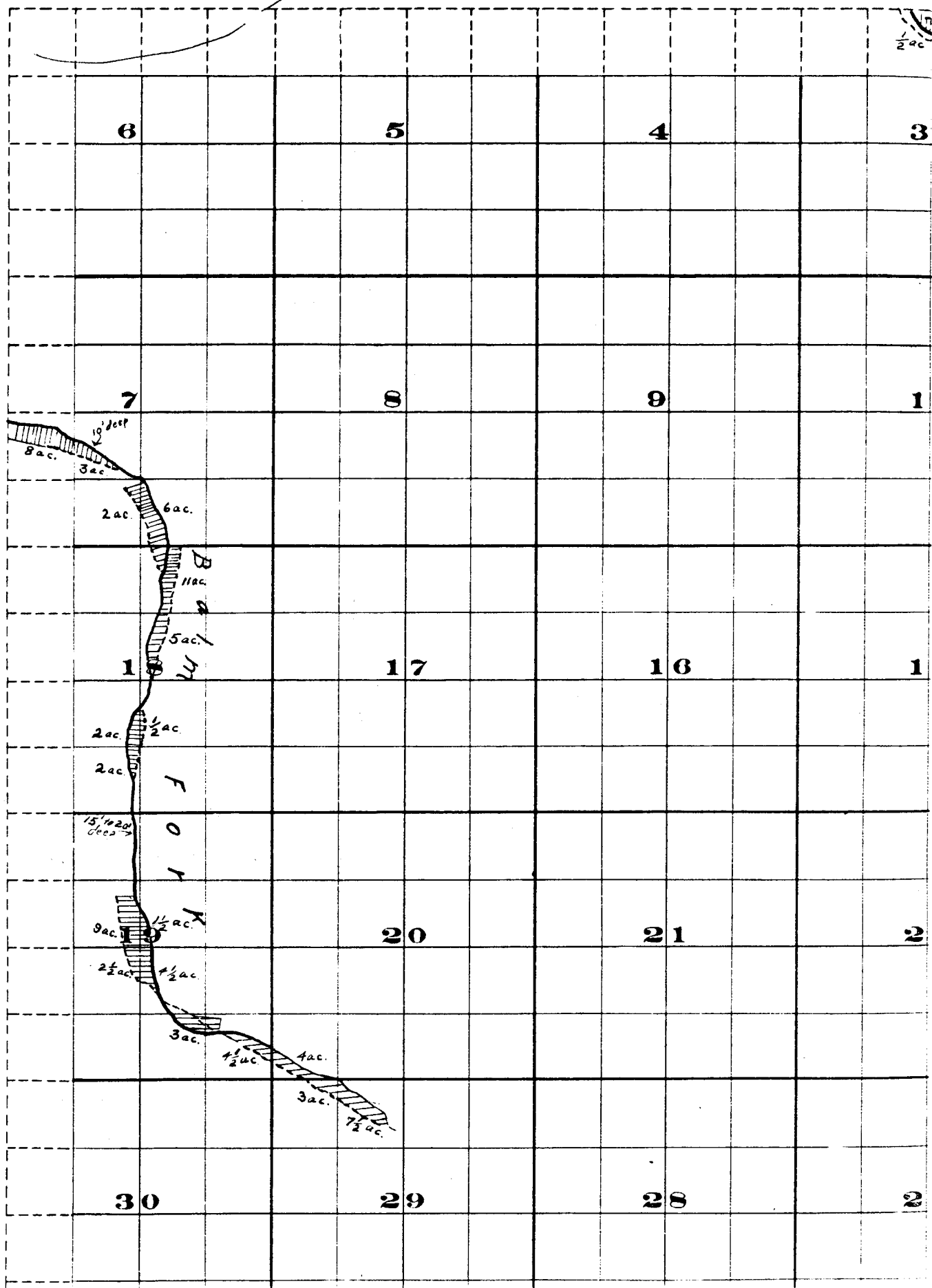

, Range 27 E.W.M.

