

22

TOWNSHIP 36 S, RANGE 7 W, W. M.

North

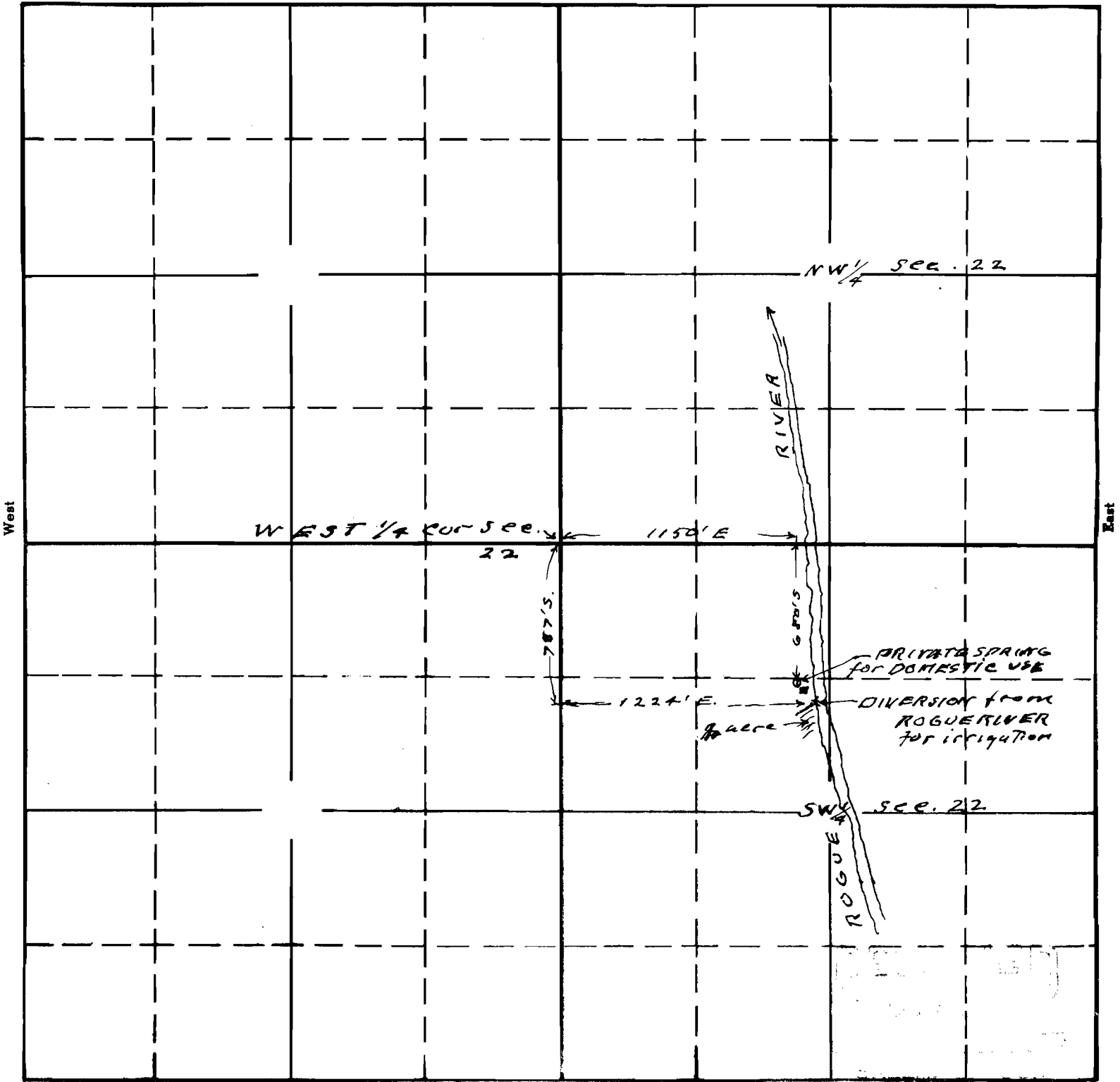

South

21370 15-600-180

APPLICATION No. 21370

PERMIT No. 16798

Map to accompany application of
 Richard S Dunforth for use of waters
 of Rogue River for irrigation and
 private spring for domestic purposes.

This office 1/1, 1924