

T.3S.R.5W.W.M.

8.T.

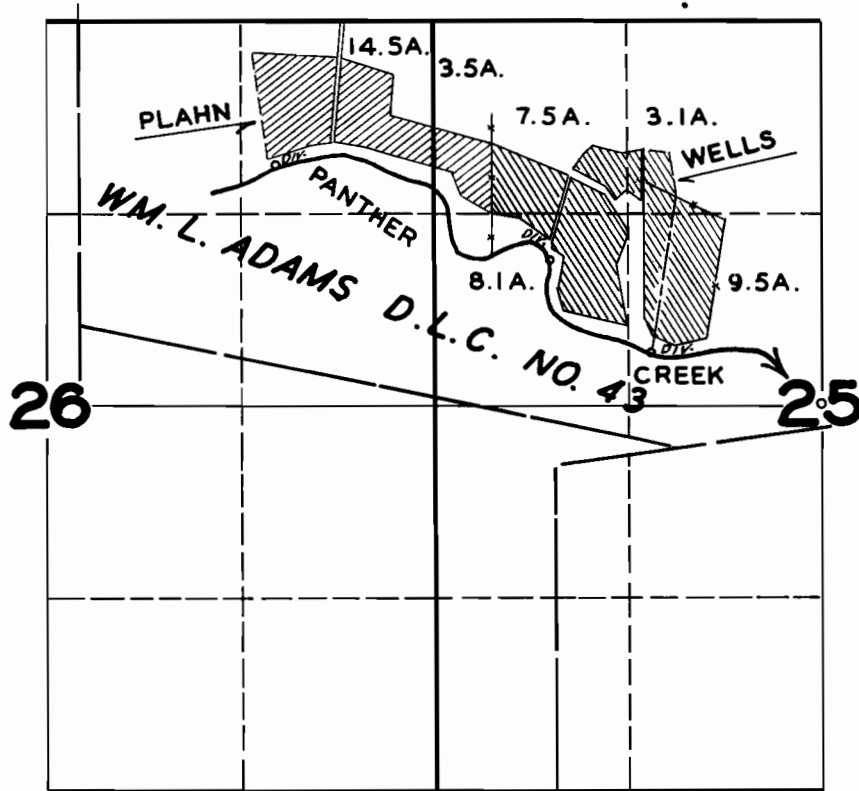

FINAL PROOF SURVEY UNDER

Application No. 17624 Permit No. 13311
IN NAME OF

JAMES W. & GRACE V. PLAHN-HOBART A. & MAUDE G. WELLS

Surveyed MAY 1 1947, by JAS. E. BUNNELL