

T.3S.R.5W.W.M.

8.T.

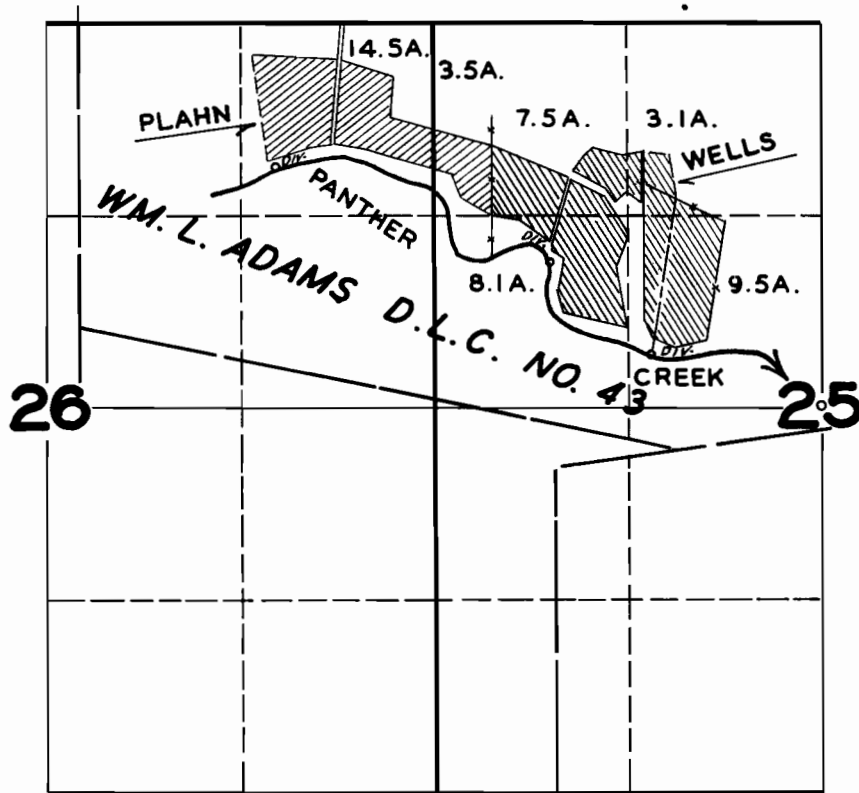

FINAL PROOF SURVEY UNDER

Application No. **17624** Permit No. **13311**
IN NAME OF

JAMES W. & GRACE V. PLAHN-HOBART A. & MAUDE G. WELLS

Surveyed **MAY 1** 1947, by **JAS. E. BUNNELL**